

ORIA BR08

ORIA Bluetooth 5.3 Transmitter Receiver (Model BR08) User Manual

Model: BR08

1. INTRODUCTION

The ORIA Bluetooth 5.3 Transmitter Receiver (Model BR08) is a versatile 2-in-1 wireless audio adapter designed to enhance your audio experience. It functions as both a Bluetooth transmitter and a receiver, allowing you to connect various audio devices wirelessly. This manual provides detailed instructions for setup, operation, maintenance, and troubleshooting to ensure optimal performance.

2. PRODUCT OVERVIEW

Familiarize yourself with the components and controls of your ORIA BR08 adapter.

Product Introduction



Image: ORIA BR08 Bluetooth Adapter Components. This diagram illustrates the various parts of the adapter, including LED indicators for Bluetooth connections, the mode switch, microphone, multifunction button, and the USB-C charging port.

Package Contents:

- 1 x ORIA Bluetooth Adapter (BR08)
- 1 x Type-C Charging Cable
- 1 x Airplane Adapter
- 1 x User Manual

3. SETUP

The ORIA BR08 operates in two modes: Transmitter (TX) and Receiver (RX). Select the appropriate mode using the TX/RX switch on the side of the device.

3.1 Transmitter (TX) Mode Setup

In TX mode, the adapter transmits audio from a non-Bluetooth device (e.g., TV, airplane entertainment system) to Bluetooth headphones or speakers.

1. **Switch to TX Mode:** Slide the TX/RX switch to the "TX" position.
2. **Connect to Audio Source:** Plug the 3.5mm audio jack of the adapter into the audio output port of your TV, computer, or in-flight entertainment system. For airplane use, attach the included airplane adapter to the 3.5mm jack before plugging it into the dual-pin airplane audio port.
3. **Power On:** Long press the multifunction button for 3 seconds to turn on the adapter. The LED indicator(s) will flash, indicating it's in pairing mode.
4. **Pair with Bluetooth Headphones/Speakers:** Put your Bluetooth headphones or speakers into pairing mode. The ORIA BR08 will automatically search for and connect to nearby devices. Once connected, the LED indicator will turn solid blue.

Convenient Connection

RX Mode



Step 1:
Switch the button to RX



Step 2:
Plug the adapter into your headphones or speakers and hold down for 3s to turn it on

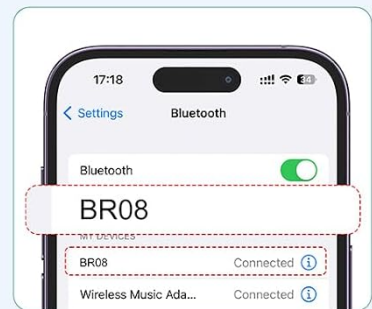

Step 3 □
Turn on your phone's Bluetooth function, search "BR08" and connect

TX Mode

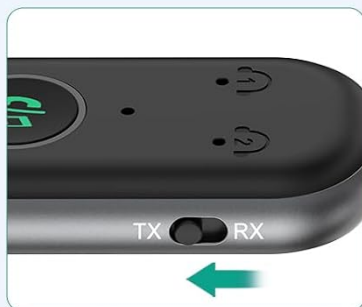

Step 1:
Switch the button to TX



Step 2:
Plug the adapter into your TV or desktop computer and hold it down for three seconds to turn it on



Step 3:
Turn on the Bluetooth headset for pairing

Notice: Turn off other Bluetooth devices to avoid interference

Image: Convenient Connection Setup. This image illustrates the step-by-step process for connecting the ORIA BR08 in both Receiver (RX) and Transmitter (TX) modes.

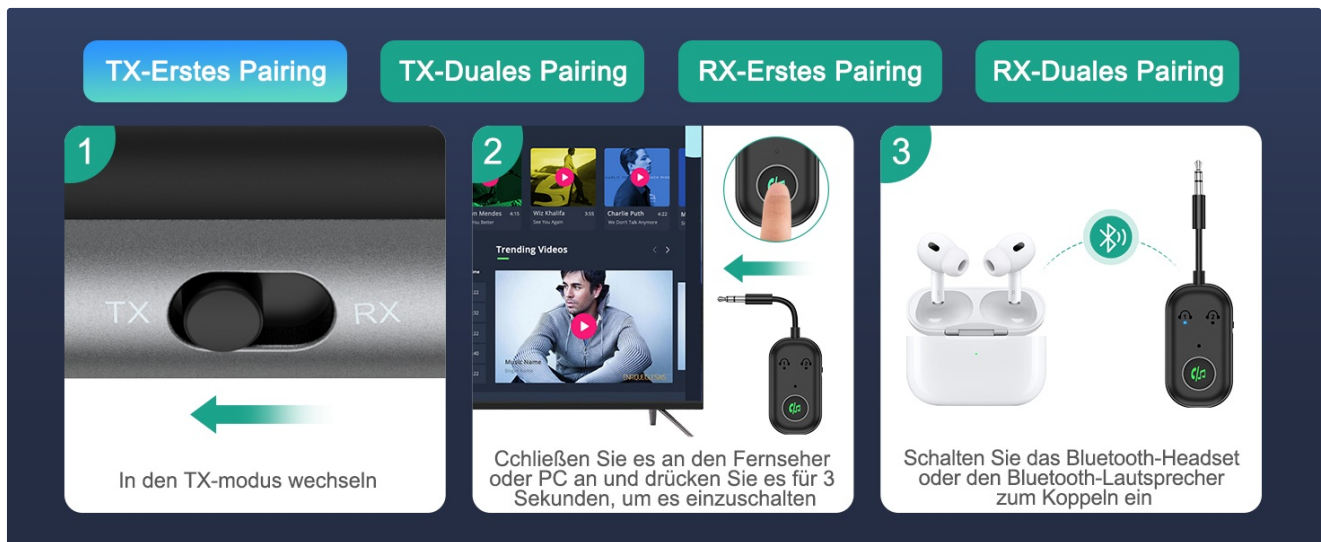

Image: TX Mode First Pairing. This diagram details the initial pairing process for the ORIA BR08 in Transmitter mode, connecting to a single Bluetooth audio device.

3.2 Receiver (RX) Mode Setup

In RX mode, the adapter receives audio from a Bluetooth-enabled device (e.g., smartphone, tablet) and outputs it to a non-Bluetooth audio system (e.g., wired speakers, car stereo).

- 1. Switch to RX Mode:** Slide the TX/RX switch to the "RX" position.
- 2. Connect to Audio System:** Plug the 3.5mm audio jack of the adapter into the AUX input port of your wired speakers, car stereo, or amplifier.
- 3. Power On:** Long press the multifunction button for 3 seconds to turn on the adapter. The LED indicator(s) will flash, indicating it's in pairing mode.
- 4. Pair with Bluetooth Device:** On your smartphone, tablet, or other Bluetooth device, enable Bluetooth and search for "BR08". Select it to connect. Once connected, the LED indicator will turn solid blue.



Image: RX Mode First Pairing. This diagram illustrates the initial pairing process for the ORIA BR08 in Receiver mode, connecting to a smartphone or tablet.

Important Note: Turn off other Bluetooth devices nearby to avoid interference during the pairing process.

4. OPERATING INSTRUCTIONS

4.1 Basic Functions

- **Power On/Off:** Long press the multifunction button for 3 seconds.
- **Play/Pause Music:** Short press the multifunction button.
- **Answer/End Call:** Short press the multifunction button (in RX mode, if connected to a phone).

4.2 Dual Pairing (Connect Two Devices Simultaneously)

The ORIA BR08 supports connecting two Bluetooth headphones/speakers in TX mode, or two Bluetooth source devices in RX mode.

TX Mode Dual Pairing:

1. Connect the first Bluetooth headphone/speaker as described in Section 3.1.
2. Once the first device is connected (LED 1 solid blue), short press the multifunction button again. LED 2 will flash, indicating it's searching for a second device.
3. Put your second Bluetooth headphone/speaker into pairing mode. The adapter will connect to it automatically. Once both are connected, both LED 1 and LED 2 will be solid blue.

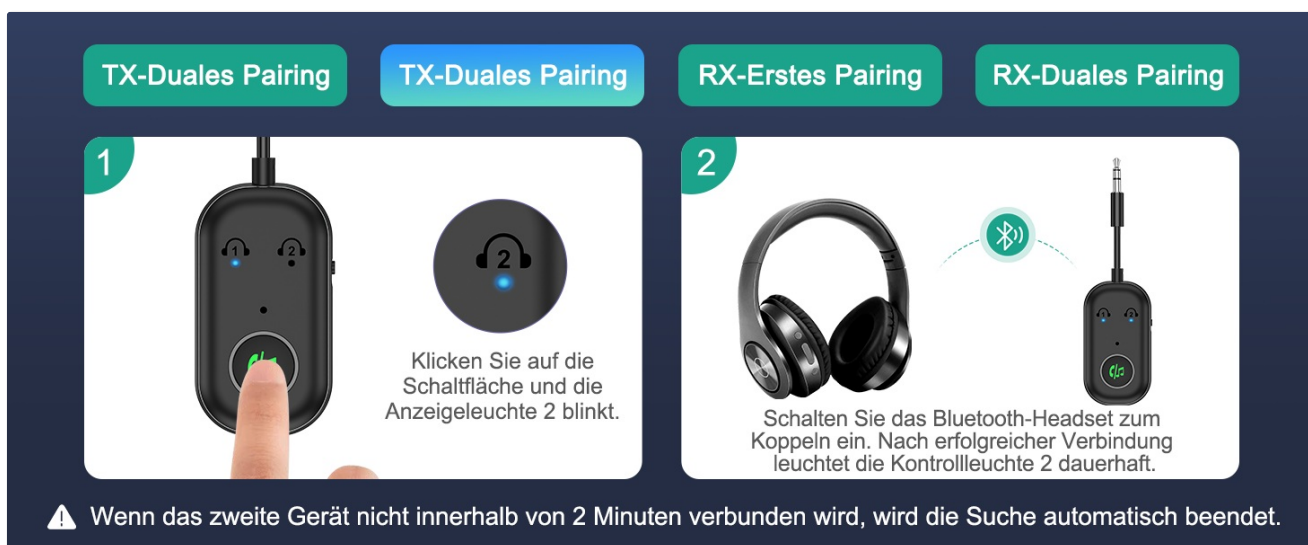

Image: TX Mode Dual Pairing. This diagram illustrates how to connect two Bluetooth headphones or speakers simultaneously in Transmitter mode.

RX Mode Dual Pairing:

1. Connect the first Bluetooth source device (e.g., smartphone) as described in Section 3.2.
2. Once the first device is connected (LED 1 solid blue), short press the multifunction button again. LED 2 will flash, indicating it's searching for a second device.
3. On your second Bluetooth source device, enable Bluetooth and search for "BR08". Select it to connect. Once both are connected, both LED 1 and LED 2 will be solid blue.

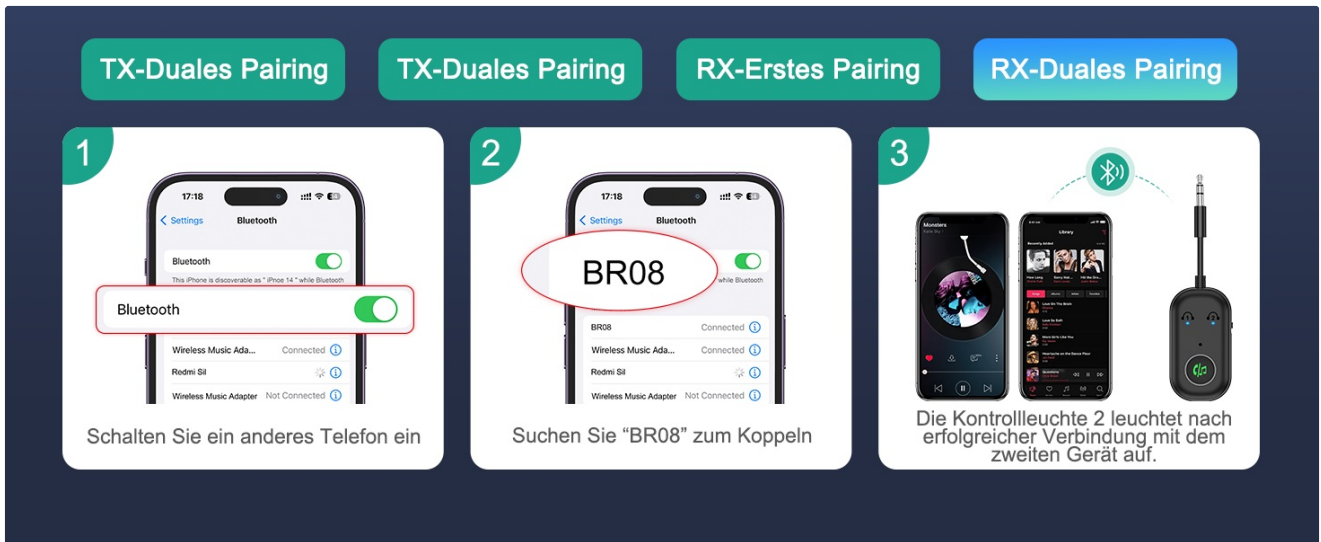

Image: RX Mode Dual Pairing. This diagram illustrates how to connect two Bluetooth source devices simultaneously in Receiver mode.

5. MAINTENANCE

Proper care ensures the longevity of your ORIA BR08 adapter.

- **Cleaning:** Use a soft, dry cloth to clean the device. Do not use liquid cleaners or aerosols.
- **Storage:** Store the adapter in a cool, dry place away from direct sunlight and extreme temperatures.
- **Charging:** Use the provided Type-C charging cable. A full charge takes approximately 1 hour. The device can be used while charging.
- **Battery Life:** Up to 16 hours in TX mode, and up to 13 hours in RX mode on a single charge.



Image: Long Battery Life. This image highlights the extended battery performance of the ORIA BR08, showing its charging port and estimated usage times for both TX and RX modes.

6. TROUBLESHOOTING

If you encounter issues, refer to the following common problems and solutions:

Problem	Solution
---------	----------

Problem	Solution
Device does not power on.	Ensure the device is charged. Connect it to a power source using the Type-C cable.
Cannot pair with a Bluetooth device.	<ul style="list-style-type: none"> • Ensure the ORIA BR08 is in the correct TX/RX mode. • Make sure both devices are in pairing mode. • Keep devices within 10 meters (33 feet) of each other. • Turn off other Bluetooth devices nearby to avoid interference. • Restart both the ORIA BR08 and the target Bluetooth device.
No audio or poor audio quality.	<ul style="list-style-type: none"> • Check if the 3.5mm audio cable is securely connected to both the adapter and the audio source/system. • Ensure the volume on both the adapter and the connected devices is turned up. • Verify that the correct input/output is selected on your audio source/system. • Move closer to the connected device to improve signal strength. • The device features CVC noise reduction; ensure it's enabled if applicable (usually automatic).
Connection drops frequently.	<ul style="list-style-type: none"> • Reduce the distance between the ORIA BR08 and the connected Bluetooth device. • Remove any obstacles (walls, large objects) between the devices. • Avoid strong electromagnetic interference from other electronics.
Loud connection message (as reported by some users).	This is a known characteristic of some Bluetooth adapters. There is no direct control to disable or lower the volume of voice prompts on the device itself. Consider connecting the adapter before putting on headphones or adjusting the volume on the receiving device after the connection is established.

7. SPECIFICATIONS

- **Model Number:** BR08
- **Brand:** ORIA
- **Bluetooth Version:** 5.3
- **Interface:** 3.5mm Audio, Bluetooth 5
- **Data Link Protocol:** Bluetooth
- **Compatible Devices:** Smartphone, Smart TV, Laptop, Wired Speakers, Car Audio Systems, Bluetooth Headphones
- **Battery:** 1 Lithium-ion (included)
- **Charging Time:** Approximately 1 hour
- **Operating Time (TX Mode):** Up to 16 hours
- **Operating Time (RX Mode):** Up to 13 hours
- **Range:** Up to 10 meters (without obstacles)
- **Noise Reduction:** CVC Technology
- **Color:** Black
- **Number of Units:** 1 Total

Fortschrittliche Bluetooth 5.3-Technologie

- Geringe Latenz
- Stabile Verbindung
- Große Übertragungsbereichweite



Image: Advanced Bluetooth 5.3 Technology. This image visually represents the core technology of the ORIA BR08, emphasizing its stable connection and extended transmission range.

8. WARRANTY AND SUPPORT

ORIA is committed to providing high-quality products and customer satisfaction.

- **Manufacturer Warranty:** 2 years
- **Free Replacements:** 90 days
- **Free Returns:** 30 days
- **Customer Support:** 24/7 availability
- **Technical Support:** Lifetime

For any questions, technical assistance, or warranty claims, please contact ORIA customer support through the retailer's platform or the official ORIA website.



Image: ORIA Customer Support. This graphic outlines the comprehensive support services offered by ORIA, including warranty, replacement, return policies, and customer assistance.

