

AGM M6

AGM M6 Feature Phone User Manual

Model: M6 | Brand: AGM

1. PRODUCT OVERVIEW

The AGM M6 is a rugged 4G LTE feature phone designed for durability and essential communication. It features a large button and font interface, an ultra-loud speaker, and robust protection against water, dust, and drops, making it suitable for outdoor and demanding environments.



Image: Front and back view of the AGM M6 Feature Phone, highlighting its robust design and large rear speaker.

Key Features:

- **4G LTE Dual SIM:** Supports T-Mobile network with dual Nano SIMs for reliable connectivity.
- **Military-Grade Durability:** IP68/IP69K waterproof and dustproof, MIL-STD-810H certified, withstands 2-meter drops and submersion up to 1.5 meters for 30 minutes.
- **User-Friendly Design:** 2.4-inch screen with large font and buttons, including a clear 21-key layout and a dedicated green call key.
- **Minimalist Operating System:** Runs on Mocom RTOS, focusing on core phone functions like calls, texts, and FM radio, without GPS, apps, or Wi-Fi.
- **Ultra-Loud Speaker:** Equipped with a 3.5W 35mm 109dB speaker for clear calls and powerful audio.
- **Long-Lasting Battery:** 2500mAh removable battery provides up to 360 hours of standby time, with Type-C charging and optional desktop dock support.
- **Integrated Flashlight:** Top-mounted LED flashlight activated by an orange side-key.

No Break! No Water Ingress! No Dust Invasion!

Rugged feature. IP68/69K, MIL-STD-810H, 2 meter drop proof, 30 mins in 1.5 meter depth water, blocking 99% of the dusts and small particles.



Image: Demonstrates the phone's IP68/IP69K waterproof, 2-meter drop-proof, and 99% dust-proof features, with the phone submerged in water, dropped, and covered in dust.

2. WHAT'S IN THE BOX

Upon unboxing your AGM M6 Feature Phone, please ensure all the following items are present:

- AGM M6 Rugged Feature Phone
- Power Adapter
- USB Cable (Type-C)

3. SETUP GUIDE

3.1. Installing SIM Card and Battery

1. **Open the Battery Cover:** Locate the notch on the bottom edge of the phone. Carefully pry open the battery access panel. This may require a thin, non-metallic tool to avoid damage.
2. **Insert SIM Card(s):** The AGM M6 supports dual Nano SIM cards. Insert your primary 4G Nano SIM into SIM slot 1 and an optional 2G Nano SIM into SIM slot 2, ensuring the gold contacts face downwards and the cut corner aligns with the slot.
3. **Insert MicroSD Card (Optional):** If you wish to expand storage, insert a MicroSD card (up to 128GB) into the dedicated slot.
4. **Install Battery:** Align the 2500mAh battery contacts with the phone's terminals and gently press it into place.
5. **Close Battery Cover:** Securely close the battery cover until it clicks into place, ensuring a tight seal for water and dust resistance.

3.2. Charging the Phone

Before first use, fully charge the phone's battery.

- Connect the provided USB Type-C cable to the charging port on the phone. The Type-C port is reversible, allowing connection from either side.
- Connect the other end of the USB cable to the power adapter.
- Plug the power adapter into a wall outlet.
- The phone will indicate charging status on the screen.
- For convenient charging, an optional desktop charging dock is available (sold separately). Simply place the phone into the dock to charge.

No Confusion! No Worries!

Charge with either side of the reversible type-C cable.

If you cannot find the port, no worries!

Just put it into the charging dock, it can charge all day long.



Image: Illustrates the Type-C charging port on the phone and the phone placed in its optional desktop charging dock.

4. OPERATING INSTRUCTIONS

4.1. Power On/Off

- **To Power On:** Press and hold the Power/End Call button (red button) until the screen lights up.
- **To Power Off:** Press and hold the Power/End Call button until the power-off options appear, then select "Power Off".

4.2. Making and Receiving Calls

- **To Make a Call:** Dial the number using the keypad and press the Green Call button.
- **To Answer a Call:** Press the Green Call button when the phone rings.
- **To End a Call:** Press the Red End Call button.

4.3. Sending Text Messages

- Navigate to "Messages" from the main menu.
- Select "Write Message" or "New Message".
- Enter the recipient's number or select from contacts.
- Type your message using the keypad. The phone supports smart typing.
- Press "Send".



Big Font! Big Buttons!

2.4-inch screen, big font, big green call button, like it is supposed to be. Type at will with the smart typing keyboard.

Image: A hand holding the AGM M6, demonstrating the large font on the screen and the prominent, easy-to-press buttons on the keypad.

4.4. Using the Flashlight

The AGM M6 features a powerful LED flashlight located at the top of the device.

- To turn on the flashlight, press the dedicated orange side-key located on the right side of the phone.
- Press the orange side-key again to turn off the flashlight.

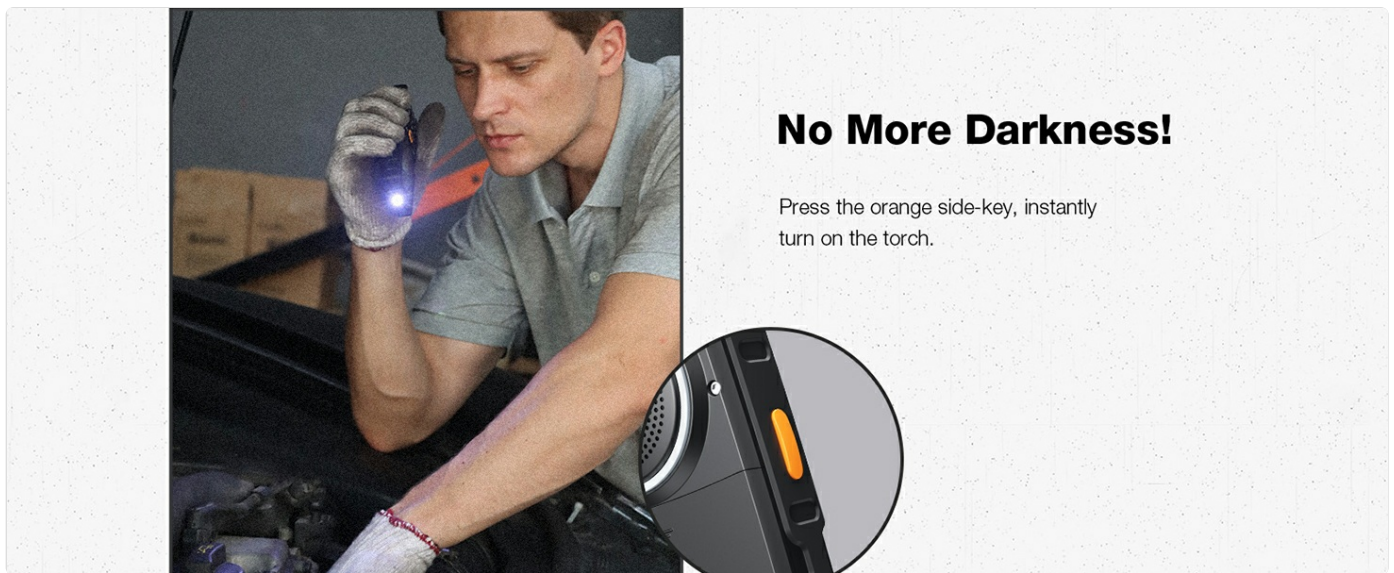

Image: A person using the AGM M6's top-mounted LED flashlight in a dark environment, highlighting its utility.

4.5. FM Radio

The phone includes a built-in FM radio. No headphones are required as the loud speaker can be used.

- Navigate to "FM Radio" from the main menu.
- Use the navigation keys to scan for stations or manually tune to a frequency.
- Adjust volume using the dedicated volume keys on the side.

4.6. Camera and Storage

The AGM M6 features a 0.3MP camera for basic photo capture and supports expandable storage up to 128GB via MicroSD card.

- To access the camera, navigate to "Camera" from the main menu.
- Press the center navigation key to take a photo.
- Photos are saved to the phone's internal memory or the inserted MicroSD card.

5. MAINTENANCE

Proper maintenance ensures the longevity and optimal performance of your AGM M6 phone, especially given its rugged nature.

5.1. Cleaning Your Phone

- After exposure to dust, dirt, or mud, wipe the phone with a soft, damp cloth.
- If exposed to saltwater or chemicals, rinse the phone thoroughly with fresh water. Ensure all ports (USB-C, speaker) are closed before rinsing.
- Dry the phone completely with a clean, dry cloth before charging or opening any ports.
- Do not use harsh chemicals, cleaning solvents, or strong detergents.

5.2. Battery Care

- Avoid exposing the battery to extreme temperatures (below -4°F or above 140°F) as this can reduce its lifespan.
- For optimal battery health, avoid frequently draining the battery completely or keeping it at 100% charge for extended periods.

- If the phone will not be used for an extended period, charge the battery to about 50% before storing it.

5.3. Storage

- Store the phone in a cool, dry place away from direct sunlight and extreme temperatures.
- Ensure the battery cover is securely closed to maintain its waterproof and dustproof integrity during storage.

6. TROUBLESHOOTING

This section addresses common issues you might encounter with your AGM M6 phone.

Problem	Possible Cause	Solution
Phone does not power on.	Low battery; Battery not installed correctly; Software issue.	Charge the phone for at least 30 minutes. Ensure the battery is properly seated. Perform a soft reset by removing and reinserting the battery.
Cannot make or receive calls.	No network signal; SIM card not inserted correctly; SIM card not activated.	Check network signal strength. Reinsert the SIM card(s). Contact your T-Mobile service provider to ensure your SIM is active. Move to an area with better reception.
Charging issues.	Cable or adapter faulty; Charging port obstruction; Battery issue.	Try a different USB Type-C cable and power adapter. Check the charging port for debris and clean carefully if necessary. Ensure the battery is securely connected.
Speaker volume is low or distorted.	Volume settings; Speaker obstruction; Software glitch.	Increase volume using the side volume keys. Check the speaker grille for any blockages and clean gently. Restart the phone.
Difficulty opening battery cover.	Tight seal for water/dust proofing.	Use a thin, non-metallic tool (e.g., a plastic pry tool or guitar pick) to carefully pry down the battery panel from the designated notch. Apply firm, even pressure.

7. SPECIFICATIONS

Detailed technical specifications for the AGM M6 Feature Phone.

Feature	Specification
Model Name	M6
Brand	AGM
Operating System	RTOS
Wireless Carrier	T-Mobile (4G LTE)
Connectivity Technologies	4G
Screen Size	2.4 Inches
Resolution	240 x 320

Feature	Specification
Battery Capacity	2500 Milliamp Hours (removable)
Standby Time	Up to 360 hours
RAM Memory Installed Size	48 MB
Memory Storage Capacity	0.12 GB (expandable up to 128GB via MicroSD)
Camera	0.3MP Rear
Special Features	Dual SIM, Expandable Memory, Rugged Body, Water Resistant, 109dB Speaker, LED Flashlight
Durability Rating	IP68/IP69K Waterproof/Dustproof, MIL-STD-810H Drop-Proof
Item Weight	10 ounces
Package Dimensions	5.6 x 2.4 x 0.73 inches
Color	Black

8. WARRANTY AND SUPPORT

AGM is committed to providing reliable products and excellent customer service.

8.1. Product Warranty

For detailed warranty information, please refer to the warranty card included with your product or visit the official AGM website. AGM offers hassle-free replacement for eligible products.





8.2. Customer Support

Our dedicated team of experts is available 24/7 to assist you with any questions or issues regarding your AGM M6 phone. You can reach professional support through the contact information provided on the official AGM website or through your purchase platform.

For more information and support, visit the [AGM Official Store on Amazon](#).

Related Documents - M6

	<p>AGM H6 Smartphone Quick Start Guide</p> <p>Comprehensive quick start guide for the AGM H6 smartphone, detailing setup, features, SIM/SD card installation, battery charging, and essential functions. Includes waterproof warnings and compliance information.</p>
---	---

	<p><u>AGM M9 4G Rugged Smartphone Quick Start Guide</u></p> <p>A concise guide to setting up and using the AGM M9 4G rugged smartphone, covering features, installation, charging, and common functions.</p>
	<p><u>AGM M6/M6 SE/M6 PRO User Manual and Safety Information</u></p> <p>Comprehensive user manual for the AGM M6, M6 SE, and M6 PRO feature phones, covering setup, functions, safety warnings, and FCC compliance information.</p>
	<p><u>AGM H6 Quick Start Guide: Features, Setup, and Usage</u></p> <p>Comprehensive quick start guide for the AGM H6 smartphone, covering device features, initial setup, battery charging, essential functions, and important warnings. Learn how to install SIM/SD cards and use Google apps.</p>
	<p><u>AGM M9 2G Quick Start Guide</u></p> <p>A concise guide to getting started with the AGM M9 2G feature phone, covering setup, basic functions, and important warnings.</p>
	<p><u>AGM M7/M7 SE/M7 PRO User Manual and Safety Information</u></p> <p>Comprehensive guide to the AGM M7, M7 SE, and M7 PRO rugged smartphones, covering setup, functions, safety warnings, and FCC compliance.</p>