

[Manuals.plus](#) /

> [CAFELFFE](#) /

> CAFELFFE MK-611 3-in-1 Capsule Coffee Machine User Manual

CAFELFFE MK-611

CAFELFFE MK-611 3-in-1 Capsule Coffee Machine User Manual

Model: MK-611 | Brand: CAFELFFE

1. IMPORTANT SAFETY INSTRUCTIONS

Please read all instructions carefully before using the appliance. Keep this manual for future reference.

- Ensure the voltage matches your power supply before connecting the machine.
- Do not immerse the machine, power cord, or plug in water or other liquids.
- Unplug from the outlet when not in use and before cleaning. Allow to cool before handling parts.
- Do not operate any appliance with a damaged cord or plug, or after the appliance malfunctions or has been damaged in any manner.
- Use only manufacturer-recommended accessories.
- Do not place on or near a hot gas or electric burner, or in a heated oven.
- Always ensure the water tank is filled above the minimum level before brewing.
- Avoid contact with hot surfaces. Use handles or knobs.
- This appliance is for household use only.

2. PRODUCT OVERVIEW

The CAFELFFE MK-611 is a versatile 3-in-1 capsule coffee machine designed for convenience and quality. It supports Nes Original capsules, DG pods, and ground coffee, offering both hot and cold brewing options.



Image: The CAFELFFE MK-611 coffee machine in operation, brewing coffee into a glass cup.

Key Features:

- **3-in-1 Compatibility:** Brews Nes Original capsules, DG pods, and 15g ground coffee using dedicated adapters.
- **19 Bar Professional Extraction:** Ensures optimal pressure for rich crema and full-bodied espresso.
- **Hot and Cold Brewing:** Offers both hot coffee ($92^{\circ}\text{C} \pm 1^{\circ}\text{C}$) and cold coffee (room temperature extraction) options.
- **Adjustable Cup Holder:** 3-level adjustable cup support (7-11 cm height) to accommodate various cup sizes.
- **Customizable Cup Sizes:** Two programmable cup sizes (70 ml Ristretto, 110 ml Lungo) with automatic memory function.
- **Fast Heating:** Ready to brew in approximately 45 seconds.
- **Automatic Shut-off:** Energy-saving feature activates after 15 minutes of inactivity.
- **600 ml Water Tank:** Transparent, BPA-free water reservoir.

PACKING LIST

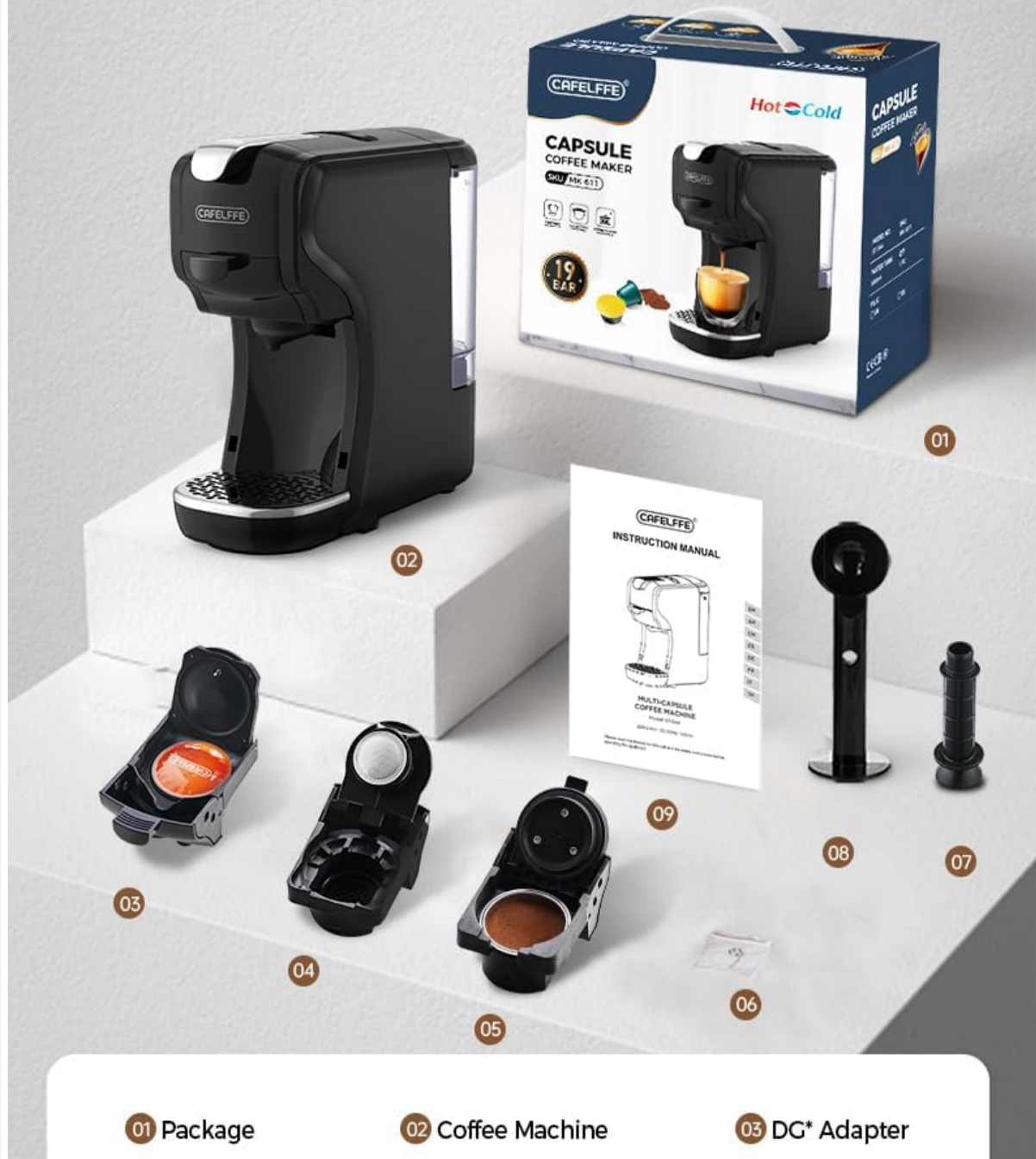

Image: Visual representation of the 3-in-1 extraction system, showing adapters for Nes capsules, DG pods, and ground coffee.

3. SETUP

1. **Unpacking:** Carefully remove all packaging materials and place the machine on a stable, flat, heat-resistant surface. Ensure all components are present as per the packing list.

Image: The CAFELFFE MK-611 machine and its accessories, including various capsule adapters and the instruction manual.

2. **Clean the Water Tank:** Wash the removable water tank and lid with warm, soapy water, then rinse thoroughly.
3. **Fill the Water Tank:** Fill the water tank with fresh, cold drinking water up to the MAX level. Place the tank back onto the machine securely.
4. **Initial Rinse Cycle:** Before first use, perform a rinse cycle without any coffee. Plug in the machine and press the power button. Once the indicator light stops flashing (indicating preheating is complete), place a large cup under the dispenser. Press the large cup button to run water through the system. Repeat this process 2-3 times to clean the internal components.

4. OPERATION

General Brewing Steps:

1. Ensure the water tank is filled with fresh water.
2. Plug in the machine and press the power button. The indicator light will flash during preheating and become solid when ready (approx. 45 seconds).
3. Select the appropriate adapter for your coffee type (Nes, DG, or ground coffee).
4. Insert your coffee (capsule, pod, or ground coffee) into the adapter.
5. Place the filled adapter into the machine and close the lever firmly.
6. Place your cup on the drip tray. Adjust the cup holder height if necessary.



Image: The adjustable cup holder of the CAFELFFE MK-611, showing three height settings for different cup sizes.

7. Select your desired brewing mode (Hot or Cold) and cup size (Small or Large).

8. Press the corresponding button to start brewing. The machine will stop automatically.
9. Carefully remove your cup. Open the lever and dispose of the used capsule/pod/grounds.

Hot and Cold Extraction Mode:

The machine offers both hot and cold brewing. To switch modes, refer to the control panel. The hot mode brews at approximately 92°C, while the cold mode extracts at room temperature for refreshing iced beverages.



Image: Control panel showing temperature indicators for Hot Drink Mode (90-93°C) and Cold Drink Mode (25°C).

Customizing Cup Sizes:

The machine comes with pre-programmed cup sizes (70 ml for small, 110 ml for large). You can customize these:

1. Place a cup under the dispenser.
2. Insert your coffee capsule/pod/grounds.
3. Press and hold the desired cup size button (Small or Large).
4. Release the button when your cup reaches the desired fill level. The machine will remember this setting for future brews.



Image: The CAFELFFE MK-611 machine with two cups, indicating the 70ml small cup and 110ml large cup options.

5. MAINTENANCE

Regular cleaning ensures optimal performance and extends the lifespan of your coffee machine.

Daily Cleaning:

- **Water Tank:** Empty and rinse the water tank daily. Refill with fresh water before each use.
- **Drip Tray and Grid:** Remove and empty the drip tray after each use or when full. Wash with warm, soapy water and

rinse thoroughly.

- **Capsule/Ground Coffee Adapters:** After each use, remove and rinse the adapter under running water. Ensure no coffee grounds or residue remain.
- **Exterior:** Wipe the exterior of the machine with a soft, damp cloth. Do not use abrasive cleaners or scouring pads.

Descaling:

Descaling is recommended every 3-6 months, depending on water hardness and usage, to remove mineral buildup. Use a descaling solution specifically designed for coffee machines and follow the product's instructions. Always perform a rinse cycle with fresh water after descaling.

6. TROUBLESHOOTING

If you encounter issues with your CAFELFFE MK-611, refer to the following table for common problems and solutions.

Problem	Possible Cause	Solution
Machine does not turn on.	No power supply.	Check if the power cord is securely plugged into a working outlet.
No coffee is dispensed.	Water tank is empty; Air in the system; Clogged nozzle.	Fill the water tank; Run a rinse cycle without coffee; Descale the machine.
Coffee is too weak or watery.	Insufficient coffee grounds/incorrect capsule; Too much water; Clogged nozzle.	Ensure correct capsule/pod is used or sufficient ground coffee is added and tamped; Adjust programmed cup size; Descale the machine.
Water leaks from the machine.	Water tank not properly seated; Drip tray full.	Ensure the water tank is correctly positioned; Empty the drip tray.
Indicator light keeps flashing.	Machine is preheating; Water tank is empty.	Wait for the light to become solid; Fill the water tank.

7. SPECIFICATIONS

Feature	Specification
Model Number	MK-611
Brand	CAFELFFE
Power	1450 Watts
Voltage	230 Volts
Pressure	19 Bar
Water Tank Capacity	600 Milliliters
Dimensions (L x W x H)	27.5 x 11 x 25 cm
Weight	2.75 Kilograms
Material	Polycarbonate
Automatic Shut-off	Yes (after 15 minutes)

8. WARRANTY AND SUPPORT

This product comes with a standard manufacturer's warranty. For specific warranty details, please refer to the documentation included with your purchase or contact CAFELFFE customer support.

If you require assistance, have questions, or need to report a problem, please contact CAFELFFE customer service through the retailer where the product was purchased or visit the official CAFELFFE website for support contact information.