

ikasus AUTO-QJ0119X-WJYQ-03

ikasus 9-inch Android 14 Car Stereo Instruction Manual

Model: AUTO-QJ0119X-WJYQ-03

Compatible with Nissan Murano Z51 (2008-2014)

1. INTRODUCTION

This manual provides detailed instructions for the installation, operation, and maintenance of your ikasus 9-inch Android 14 Car Stereo. Please read this manual thoroughly before using the product to ensure proper function and safety. This unit is designed to enhance your driving experience with advanced features such as wireless Carplay, Android Auto, GPS navigation, Bluetooth connectivity, and support for an AHD backup camera.

2. WHAT'S IN THE BOX

Verify that all components are present before beginning installation.

- 1 x Vehicle Navigation Unit (ikasus 9-inch Android 14 Car Stereo)
- Wiring Harnesses (specific to Nissan Murano Z51 2008-2014)
- GPS Antenna
- USB Cables
- AHD Backup Camera (if included in package)
- External Microphone



Image: Overview of the ikasus car stereo unit and its included accessories, including wiring and antennas.

3. SPECIFICATIONS

Feature	Specification
System	Android 14
Chipset	8227L-DEMO
Screen Size	9 inches
Memory (RAM+ROM)	4GB RAM + 64GB ROM
Screen Resolution	1024x600
Power Output	4x45W
Radio Band	FM/RDS
Reversing Input	AHD/CVBS
Connectivity	Wireless Carplay, Android Auto, Bluetooth, GPS, WiFi, Dual USB
Supported Features	Steering Wheel Control (SWC), Video Output, External Microphone, Split Screen
Pre-installed Maps	Built-in offline maps (requires internet for data download)
Factory Setting Keyword	8888

4. INSTALLATION GUIDE

4.1 Pre-Installation Check

Before installation, ensure your vehicle is compatible and all components are present. This unit is designed for Nissan Murano Z51 models from 2008-2014 (left-hand drive).



Image: Comparison of the Nissan Murano dashboard before and after the ikasus car stereo installation, showing the integrated 9-inch display.

4.2 Wiring Connections

Carefully connect the wiring harnesses to the vehicle's existing connections. Ensure all plugs are securely seated.

RDS FM Radio Bluetooth Handsfree/Music



Image: Detailed view of the rear of the car stereo unit, illustrating the multiple wiring harnesses and ports for connection.

4.3 Important Installation Note: Camera Input

The white plug for the camera input cable must be connected to the main device. Failure to connect this plug may result in loss of Bluetooth and Wi-Fi signals.



Attention during installation

The white plug must be connected to the main device, or you can't get bluetooth and wifi signals.

(The following camera input cable is inside the package.)



Camera Input

Image: A specific camera input cable with a white connector, emphasizing the critical connection point for proper wireless functionality.

5. OPERATING INSTRUCTIONS

5.1 Bluetooth Connection

To connect your mobile device via Bluetooth:

1. On the car stereo, navigate to the "BT" or "Bluetooth" icon on the main screen.
2. Go to Bluetooth settings on your mobile phone and enable Bluetooth.
3. Search for available devices and select "CarBT" from the list.
4. Enter the PIN "0000" if prompted.
5. Once connected, "phone audio, music audio" will be displayed under "Paired devices". If not, restart the Bluetooth on both devices.

Your browser does not support the video tag.

Video: Demonstrates the process of connecting a mobile phone to the car stereo via Bluetooth for audio and calls.

5.2 Wireless Carplay / Android Auto (ZLINK Connection)

The ZLINK application facilitates wireless Carplay and Android Auto. Ensure your phone's Bluetooth is connected first.

1. Open the "ZLINK" app on the car stereo.
2. The system will attempt to connect to your phone.
3. If the connection is not successful, you may need to manually connect to the car stereo's Wi-Fi hotspot.
4. To manually connect Wi-Fi: Go to "Settings" > "Android Settings" > "Network & Internet" > "Hotspot & tethering" > "Wi-Fi hotspot". Turn on the hotspot and note the network name (e.g., AndroidAP_B442) and password.
5. On your phone, connect to this Wi-Fi network.
6. After manually connecting to the Wi-Fi, delete the history record of the Wi-Fi connection on your phone, then reopen the ZLINK app on the car stereo.
7. For subsequent connections, only connecting via Bluetooth should automatically establish the ZLINK connection.

This feature allows you to access phone contacts, emails, notifications, online maps, music, and videos directly on the car stereo screen, with voice control capabilities.



Image: The car stereo displaying the Carplay and Android Auto interfaces, highlighting navigation and music playback.

5.3 GPS Navigation & Wi-Fi Connection

The car stereo supports both online and offline navigation. Built-in offline maps are available, but require an internet connection to download data. You can also use online map applications like Google Maps, Waze, and Here WeGo after connecting to Wi-Fi.

Built-in GPS&WiFi

Support online and offline maps&WiFi, compatible with Waze, Google, Sygic, HereWeGo and etc.

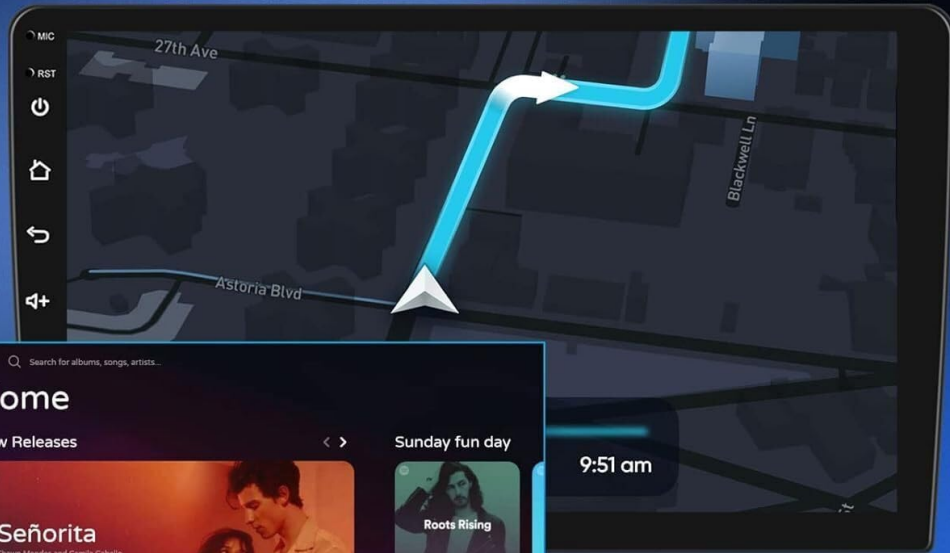
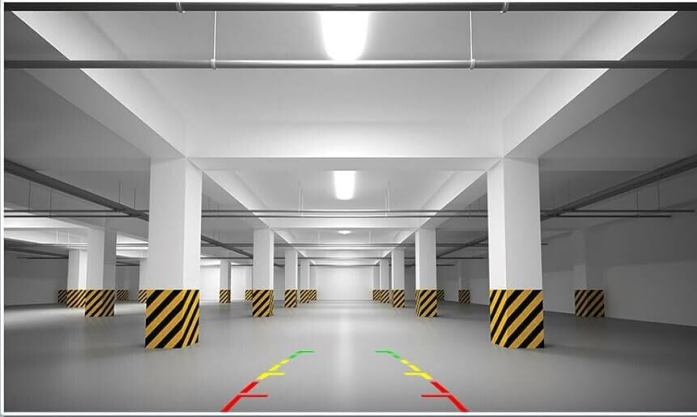

Image: The car stereo displaying GPS navigation, with icons for various applications including music streaming services.

5.4 FM/RDS Radio

Access the FM/RDS radio function to listen to local broadcasts, news, and traffic updates. The RDS (Radio Data System) provides additional information such as station name and program type.

AHD Backup Camera



1080P FULL HD

AHD

Night vision



Waterproof



Wide-angle



SWC



Image: The car stereo's FM radio interface, showing frequency tuning and a separate screen for Bluetooth hands-free calling.

5.5 AHD Backup Camera

The unit supports an AHD rear camera input, providing a clear 170° wide-angle view with superior night vision. The backup camera automatically activates when the vehicle is in reverse, enhancing safety during parking and maneuvering.

Waterproof AHD Backup Camera

170° wide view AHD camera will present superior night vision for you.



Our AHD Camera



Other



Steering Wheel Control

if the original car has buttons, you can use the steering wheel buttons to control the radio making the operation more convenient.

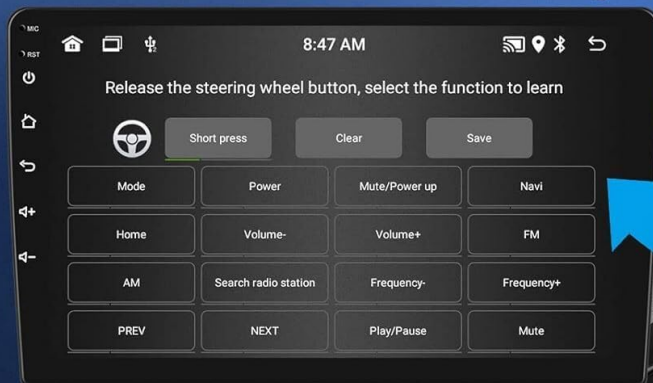

Image: A comparison showing the superior clarity and wide-angle view of the AHD backup camera on the car stereo screen, including parking assist lines.

5.6 Steering Wheel Control (SWC)

If your vehicle has original steering wheel buttons, you can configure them to control the car stereo. This allows for safer and more convenient operation without taking your hands off the wheel.

Built-in GPS&WiFi

Support online and offline maps&WiFi, compatible with Waze, Google, Sygic, HereWeGo and etc.

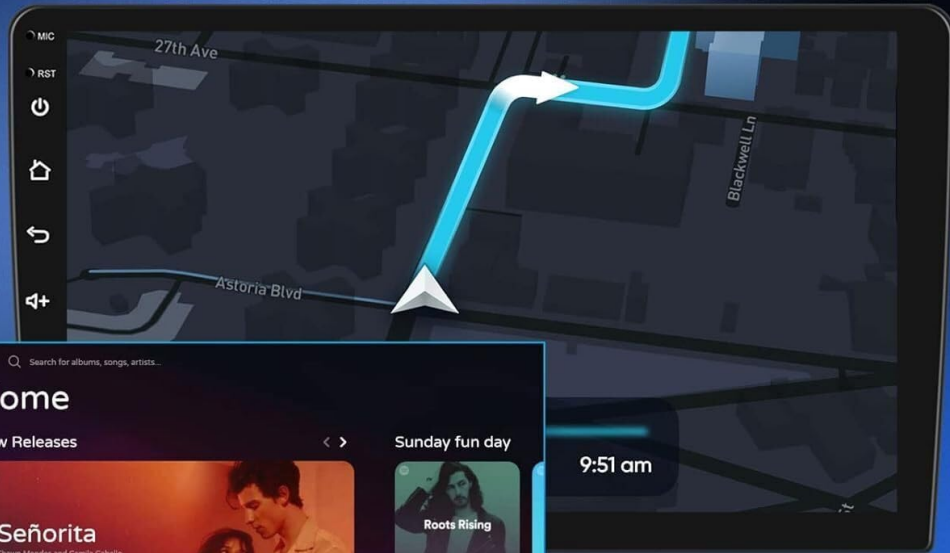

Image: The car stereo's interface for programming steering wheel controls, demonstrating how to assign functions to physical buttons.

6. MAINTENANCE

- **Screen Cleaning:** Use a soft, lint-free cloth to clean the touchscreen. Avoid abrasive cleaners or solvents.
- **Software Updates:** Periodically check for software updates to ensure optimal performance and access to new features. Connect the unit to Wi-Fi to download updates.
- **Temperature:** Avoid exposing the unit to extreme temperatures, both hot and cold, for extended periods.
- **Power Cycle:** If the unit experiences minor glitches, try restarting it by turning off your vehicle's ignition and then restarting.

7. TROUBLESHOOTING

- **No Power:**
 - Check all power connections to ensure they are secure.

- Verify the vehicle's fuse for the stereo is intact.
- **No Sound:**
 - Check volume levels on both the stereo and your connected device.
 - Ensure speaker wires are correctly connected.
 - Verify audio output settings in the stereo's menu.
- **Bluetooth/Wi-Fi Connection Issues:**
 - Ensure the white camera input plug is securely connected (refer to Section 4.3).
 - Restart Bluetooth/Wi-Fi on both the stereo and your mobile device.
 - Forget the device on your phone and re-pair.
 - For Wi-Fi, ensure the hotspot password is correct and the signal is strong.
- **Carplay/Android Auto Not Connecting:**
 - Ensure Bluetooth is connected first.
 - If using wireless, ensure Wi-Fi is also connected to the car stereo's hotspot.
 - Try clearing the ZLINK app data or reinstalling it if issues persist.
- **Backup Camera Not Displaying:**
 - Check the camera's power and video signal connections.
 - Ensure the vehicle is in reverse gear.
 - Verify camera input settings in the stereo's menu.

8. WARRANTY AND SUPPORT

For warranty information, technical support, or service inquiries, please refer to the contact information provided with your purchase or visit the official ikasus website. Keep your purchase receipt as proof of purchase for warranty claims.

Note: Unauthorized modifications or improper installation may void the product warranty.