

## Replacement Power Adapter for Dreame T10, T20, P10, V9, V10, V11, V12, R10, U10, U20 Series

# Instruction Manual

### GENERIC REPLACEMENT POWER ADAPTER FOR DREAME CORDLESS VACUUMS

Compatible with Dreame T10, T20, T20-Pro, P10, P10-Pro, V9, V10, V10-Pro, V11, V12, R10, R10-Pro, U10, U20 Series

## 1. Important Safety Instructions

Please read and understand all safety instructions before using this product. Failure to follow these instructions may result in electric shock, fire, or serious injury.

- **Indoor Use Only:** This charger is designed for indoor use in dry locations. Do not expose to rain, moisture, or extreme temperatures.
- **Proper Voltage:** Ensure the power outlet voltage matches the charger's input requirements (100-240V 50/60Hz).
- **Avoid Damage:** Do not use the charger if the cord or plug is damaged. Do not modify or disassemble the charger.
- **Ventilation:** Ensure adequate ventilation around the charger during use. Do not cover the charger.
- **Children and Pets:** Keep the charger out of reach of children and pets.
- **Disconnect Power:** Always unplug the charger from the power outlet before cleaning or if not in use for an extended period.
- **Safety Protection:** This charger features built-in intelligent chip protection against overcurrent, overvoltage, overcharge, overheating, short circuit, and overloading.

# Safety Protection

Built-in intelligent chip provide multiple safety protection



Overcurrent  
Protection



Overvoltage  
Protection



Overcharge  
Protection



Overheating  
Protection



Short circuit  
Protection



Over loading  
protection

Image: Visual representation of the charger's multiple safety protection features, including overcurrent, overvoltage, overcharge, overheating, short circuit, and overloading protection.

## 2. Product Overview

This product is a replacement AC/DC power adapter designed to charge specific Dreame cordless vacuum cleaners. It features a durable design and safety mechanisms to ensure reliable charging.

### What's in the Box:

- 1 x AC/DC Power Adapter

### Key Features:

- **Durable Construction:** PC+ABS shell designed to withstand impacts.
- **Premium Cable:** Features a flexible PVC jacket and copper wire for efficient power delivery.
- **Safety Protections:** Built-in intelligent chip for overcurrent, overvoltage, overcharge, overheating, short circuit, and overloading protection.

# Premium Cable

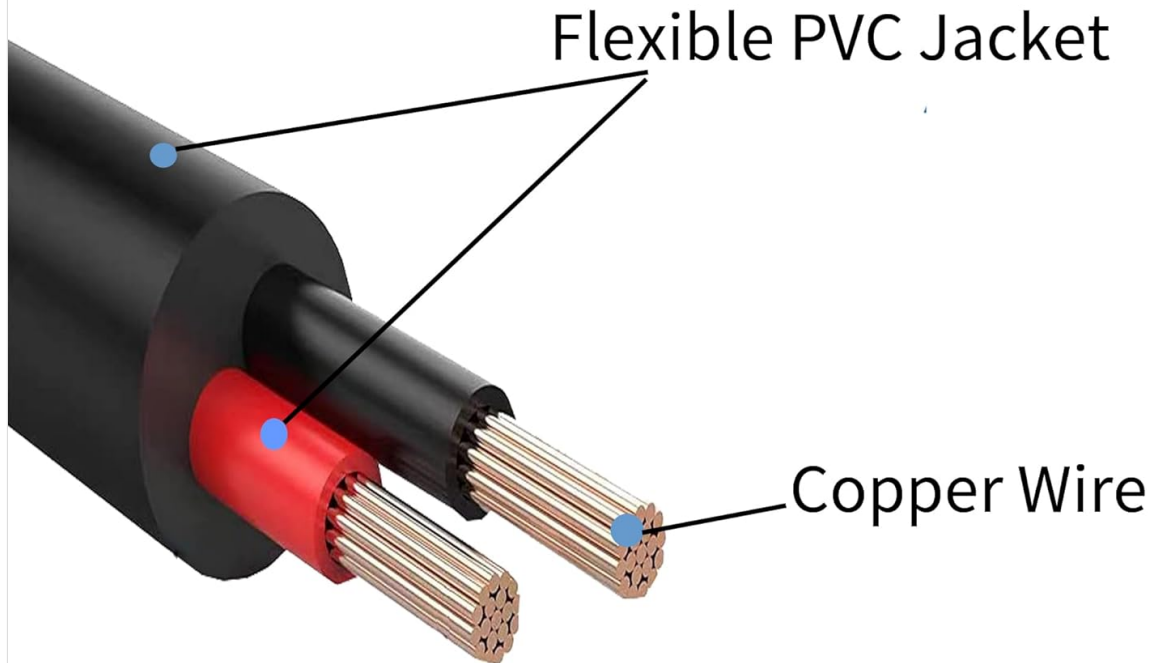

Image: Diagram illustrating the internal structure of the charger's cable, highlighting the flexible PVC jacket and copper wire components.

### 3. Setup

Follow these steps to set up your new power adapter:

1. **Unpack:** Carefully remove the power adapter from its packaging.
2. **Inspect:** Check the charger and cable for any visible damage. Do not use if damaged.
3. **Connect to Vacuum:** Insert the barrel connector end of the charger cable into the charging port of your compatible Dreame cordless vacuum cleaner.
4. **Connect to Power Outlet:** Plug the AC adapter into a standard 100-240V wall power outlet.



Image: A Dreame cordless vacuum cleaner connected to the charger, which is plugged into a wall socket, demonstrating the setup for charging in a home environment.

#### 4. Operating Instructions

Once connected, the vacuum cleaner should indicate that it is charging. Refer to your vacuum cleaner's manual for specific charging indicator lights and behaviors.

- **Charging Time:** Charging time will vary depending on the vacuum's battery level and model.
- **Full Charge:** Disconnect the charger once the vacuum's battery is fully charged to conserve energy and prolong battery life.
- **Normal Operation:** The charger may become slightly warm during operation; this is normal.

#### 5. Compatibility

This power adapter is specifically designed for certain Dreame cordless vacuum cleaner models with a 25.2V Li-ion battery. Please verify your vacuum's battery specifications before use.

**Compatible Models:**

- Dreame T10, T20, T20-Pro
- Dreame P10, P10-Pro
- Dreame V9, V10, V10-Pro, V11, V12
- Dreame R10, R10-Pro
- Dreame U10, U20

**Important:** Only compatible with cordless vacuums equipped with a **25.2V / 25.9V 7-Cell Li-ion battery**.

# Compatible Battery Type

Only compatible with cordless vacuum with  
**25.2V / 25.9V 7 Cell**  
 li-ion battery

NOT FOR vacuum with  
**21.6V / 22.2V / 29.6V**  
 li-ion battery

Check the battery details on your battery label

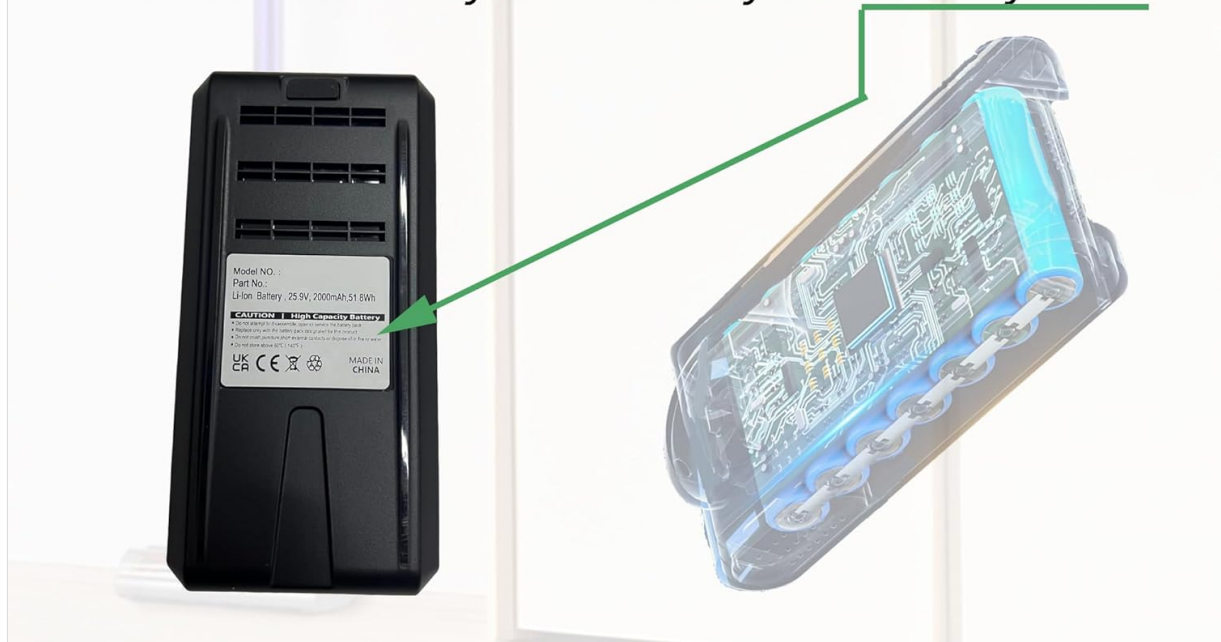

Image: A visual guide to compatible and incompatible battery types for the charger, emphasizing the need to check the battery label for 25.2V / 25.9V 7-cell Li-ion batteries.

## Incompatibility:

**NOT for Dreame R20 T30 cordless vacuum with 29.6V Li-ion battery (requires a 36V charger).**

This charger is **NOT compatible** with vacuums requiring 21.6V, 22.2V, or 29.6V Li-ion batteries.

**Output Voltage Compatibility:** This charger provides 31V (compatible with 30V) output. Ensure your vacuum requires this voltage.

# Power Spec

## Compatible Output

31V 0.5A ✓

30V 0.8A ✓

## INCOMPATIBLE

36V 0.5A ✗

26V 0.5A ✗

You can check the power spec on your charger lable



Image: A guide to compatible and incompatible power specifications, advising users to check their original charger label for output voltage and amperage.

## 6. Maintenance

Proper maintenance ensures the longevity and safe operation of your charger.

- **Cleaning:** Disconnect the charger from the power outlet and the vacuum before cleaning. Wipe the exterior with a soft, dry cloth. Do not use liquid cleaners or abrasive materials.
- **Storage:** Store the charger in a cool, dry place away from direct sunlight and extreme temperatures when not in use. Avoid wrapping the cable too tightly.
- **Inspection:** Periodically inspect the charger cable and plug for any signs of wear or damage. Replace if necessary.

## 7. Troubleshooting

If you encounter issues with your charger, consider the following:

- **Vacuum Not Charging:**

- Ensure the charger is securely plugged into both the vacuum and the wall outlet.
  - Verify the wall outlet is functional by plugging in another device.
  - Confirm that your vacuum model and battery voltage are compatible with this charger (refer to Section 5).
  - Check the charger cable and connector for any visible damage.
- **Battery Depletion vs. Charger Malfunction:** Rechargeable batteries typically last 1-3 years. If your vacuum fails to hold a charge, it may indicate natural battery depletion rather than a charger malfunction. For accurate diagnosis, consider using a voltage tester to identify if it's battery aging or a device failure.
  - **Overheating:** If the charger feels excessively hot, unplug it immediately. Ensure it is in a well-ventilated area and not covered. If overheating persists, discontinue use and contact support.

## 8. Specifications

Detailed technical specifications for the power adapter:

Feature	Specification
Brand	Generic
Input Voltage	100-240V AC
Input Frequency	50/60Hz
Output Voltage	31V (Compatible with 30V)
Output Current	0.5 Amps
Connector Type	Barrel Connector
Charging Cord Length	5.9 ft (approximately 1.8 meters)
Color	Black
Material	Polycarbonate (PC+ABS shell)
Item Weight	2.56 ounces
Special Features	Short Circuit Protection, Overcurrent Protection, Overvoltage Protection, Overcharge Protection, Overheating Protection, Overloading Protection
Power Plug Type	Type A - 2 pin (North American)
Certification	FCC

# Adapter Spec

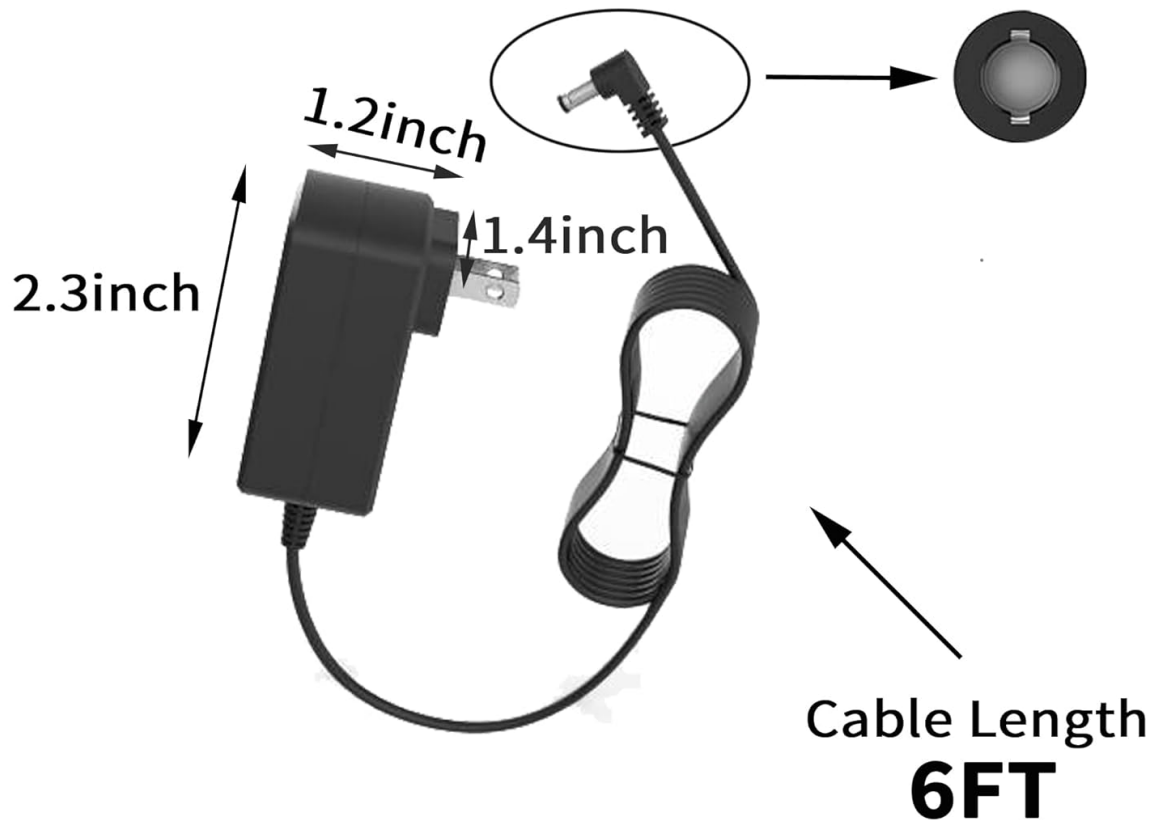

Image: A diagram detailing the physical dimensions of the power adapter and its 6-foot cable length.

## 9. Warranty and Support

This product comes with a manufacturer's warranty and support information.

- **Warranty:** 1 Year Manufacturer Warranty.
- **Manufacturer:** Chapeli
- **Customer Support:** For any questions, issues, or warranty claims, please contact the seller or manufacturer through the platform where the product was purchased.