

## MAIJOFO YYK-Q16S AI

# MAIJOFO YYK-Q16S AI Translation Earbuds User Manual

Model: YYK-Q16S AI | Brand: MAIJOFO

## INTRODUCTION

The MAIJOFO YYK-Q16S AI Translation Earbuds are designed to facilitate seamless communication across language barriers and enhance your audio experience. These earbuds offer 4-in-1 functionality, including real-time translation, music playback, call connectivity, and intelligent meeting transcription. With support for over 144 languages and accents, a 0.2-second response time, and 99.9% accuracy, they are an ideal companion for travel, business, and learning.

## WHAT'S IN THE BOX

- 2 x Translation Earbuds
- 1 x Charging Case
- 1 x Charging Cable
- 1 x User Manual
- 1 x Box

## PRODUCT OVERVIEW



Image: The MAIJOFO YYK-Q16S AI Translation Earbuds resting in their charging case, displaying the battery level on the LED screen.

The YYK-Q16S AI Translation Earbuds feature an open-ear design for comfort and situational awareness. The compact charging case provides extended battery life and includes an LED display to show the charge status. Each earbud is equipped with advanced AI chips and high-precision microphones for optimal performance.

## AI Voice Smart Dialogue

Use real-time voice interaction to ask **Nebula** questions



Image: A visual breakdown of the earbuds' features, including crystal-clear AAC sound, advanced air conduction technology, 80 hours total playtime, IP68 waterproof protection, safe and reliable usage, and open-ear comfort design.

## SETUP

### 1. Charging the Earbuds and Case

Before first use, fully charge the earbuds and the charging case.

- Place the earbuds into the charging case. Ensure they are correctly seated.
- Connect the charging cable (Type-C) to the charging case and a power source.
- The LED display on the charging case will indicate the charging status. A full charge provides up to 80 hours of total playtime with the case, and 6 hours of single playtime for the earbuds.

# 1.5H Fast Charging with Type-C

**80** Hours   
Total with Case

**6** Hours   
Single Playtime



Image: The charging case with earbuds, illustrating the 80 hours of total battery life with the case and 6 hours of single playtime.

## 2. Wearing the Earbuds

The earbuds feature an open-ear ergonomic design for comfortable and secure fit without entering the ear canal.

- Gently hook the earbud over your ear, ensuring the speaker portion is positioned near your ear canal.
- Adjust for a snug and comfortable fit. The design allows you to remain aware of your surroundings while enjoying audio.

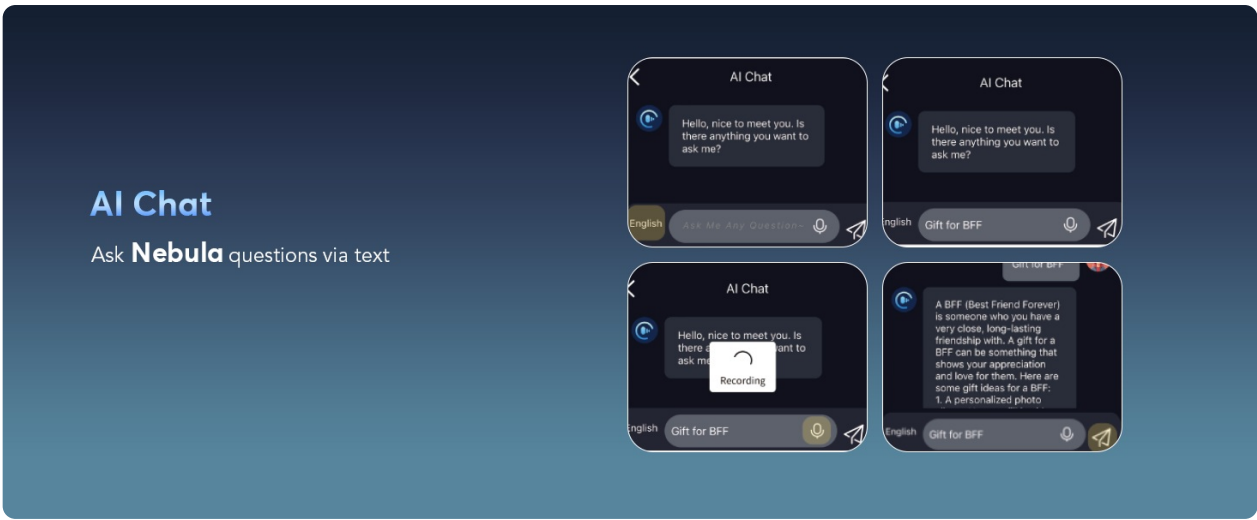

Image: A visual guide demonstrating the correct way to wear the open-ear earbuds for a secure and comfortable fit.

### 3. Connecting to the "NebulaBuds" App

The earbuds require connection to the dedicated "NebulaBuds" app for full translation functionality.

1. **Download the App:** Scan the QR code provided in the user manual or on the charging case to download the "NebulaBuds" app.
2. **Enable Bluetooth:** Turn on Bluetooth on your smartphone (iOS or Android).
3. **Open App & Grant Permissions:** Launch the "NebulaBuds" app. It will prompt you to allow access to Bluetooth and local network devices. Grant the necessary permissions.
4. **Connect Earbuds:** The app will automatically detect the earbuds. Select "YYK-Q16S AI" from the list and confirm to establish the connection.

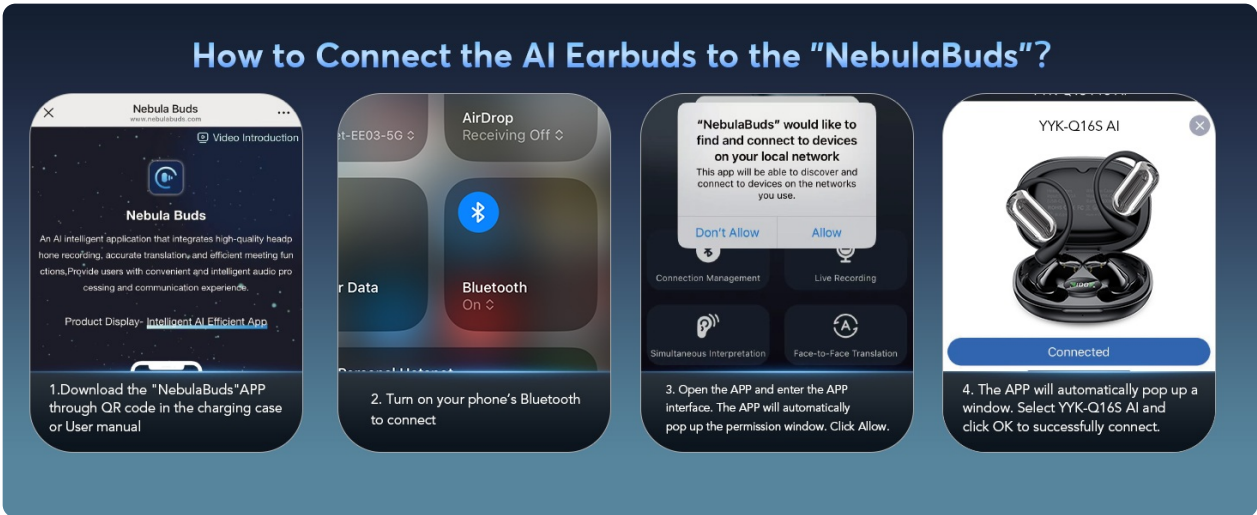

Image: A step-by-step visual guide on connecting the earbuds to the "NebulaBuds" app, including app download, Bluetooth activation, permission granting, and final connection confirmation.

## OPERATING INSTRUCTIONS

### 1. Basic Touch Controls

The earbuds feature intuitive touch controls for managing audio and calls. Refer to the app or the included quick start guide for specific tap functions (e.g., play/pause, answer/end call, activate voice assistant).

### 2. Real-Time Translation Modes



The "NebulaBuds" app offers various translation modes to suit different communication scenarios.

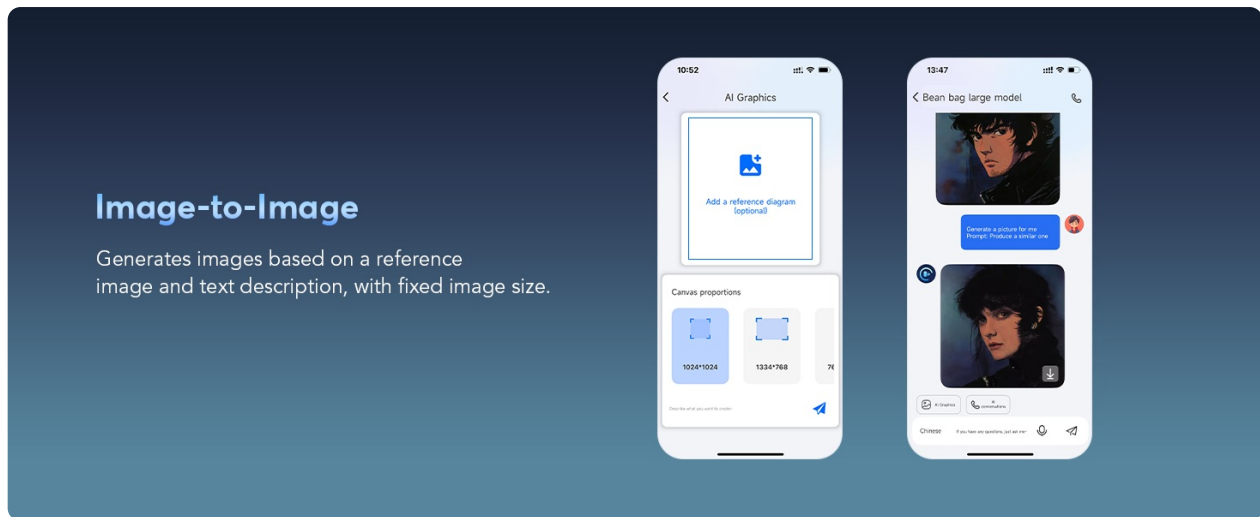

Image: A screenshot demonstrating the real-time translation feature within the app, showing spoken phrases being translated and displayed.

- **Free Talk Mode:** For continuous, natural conversation.
- **Touch Mode:** Tap an earbud to speak, release to translate.
- **Speaker Mode:** One person speaks into the phone, the other listens via earbuds.
- **Audio Transcription:** Converts spoken language into text.
- **Photo Translation:** Translates text from images.
- **Simultaneous Interpretation:** Ideal for conferences, providing real-time voice translation.

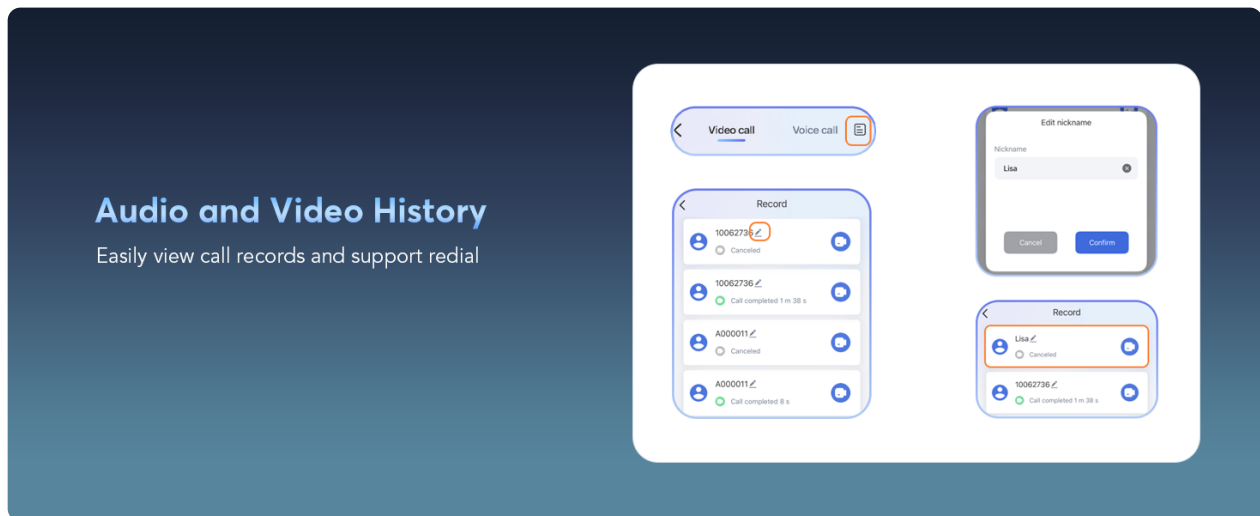

Image: Screenshots illustrating the simultaneous interpretation mode, showing real-time translation of spoken words for international conferences.

- **Face-to-Face Translation (Earphones + Mobile Phone):** Use one earbud and the mobile phone for two-way translation.

## Text-to-Image

Generates images based on provided text descriptions.  
You can choose the size and save the image.

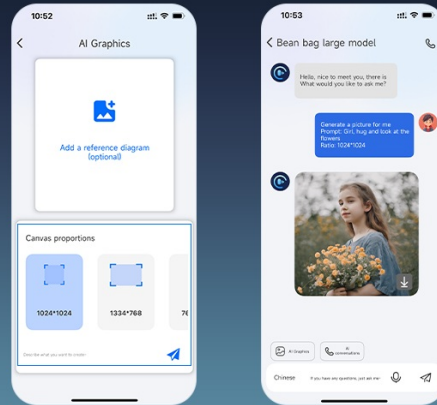

Image: A diagram depicting face-to-face translation where one person uses an earbud and the other uses the mobile phone for two-way communication.

- **Face-to-Face Translation (Dual-Ear Mode):** Share earbuds with another person for simultaneous two-way conversation.

## Summary & Playback

Historical recordings AI  
Summary&Speaker Identification

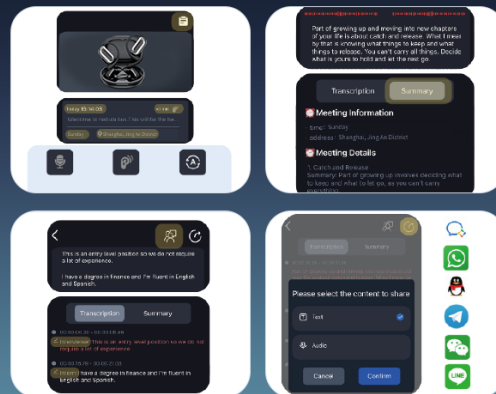

Image: A diagram illustrating the dual-ear mode for face-to-face translation, where two individuals each wear an earbud to communicate simultaneously.

## 3. Audio Playback and Calls

The earbuds function as standard Bluetooth headphones for music and calls.

- **Music Playback:** Stream audio from your connected device.
- **Phone Calls:** Answer, end, or reject calls using the touch controls. The advanced microphone system ensures clear voice pickup.

## 4. AI Features and Smart Functions

The "NebulaBuds" app integrates various AI-powered features:

- **Live Recording & Transcription:** Record conversations and meetings, then convert them into text for easy review and summary.

## Audio and Video Call

Online calls with real-time translation.  
No app needed for the other party, chat effortlessly.

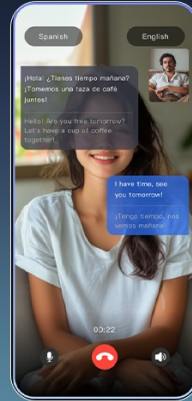

Image: Screenshots demonstrating the live recording feature, showing how recordings are converted to text for meeting notes and can be summarized.

- **AI Voice Smart Dialogue:** Interact with the AI using real-time voice for various queries.

## Real Time Translation

The headset provides a variety of innovative translation modes, including Free Talk Mode, Touch mode, Speaker Mode, Audio Transcription and Photo Translation.



Image: Screenshots illustrating the AI Voice Smart Dialogue feature, where users can interact with the AI using voice commands.

- **AI Chat:** Engage in text-based conversations with the AI for information or assistance.

## Live Recording

Convert recording to text for meeting notes

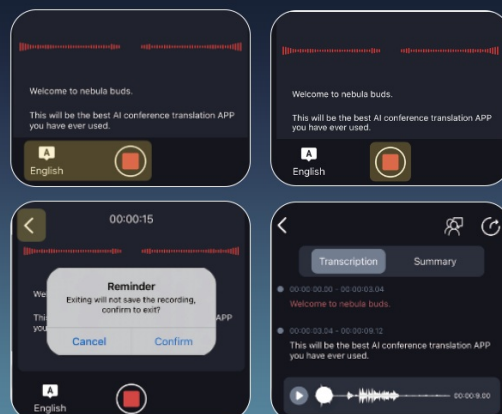

Image: Screenshots showing the AI Chat interface, allowing users to ask questions via text.

- **AI Assistant:** Access over 200 AI small applications for various tasks, such as one-click writing or



generating presentation outlines.

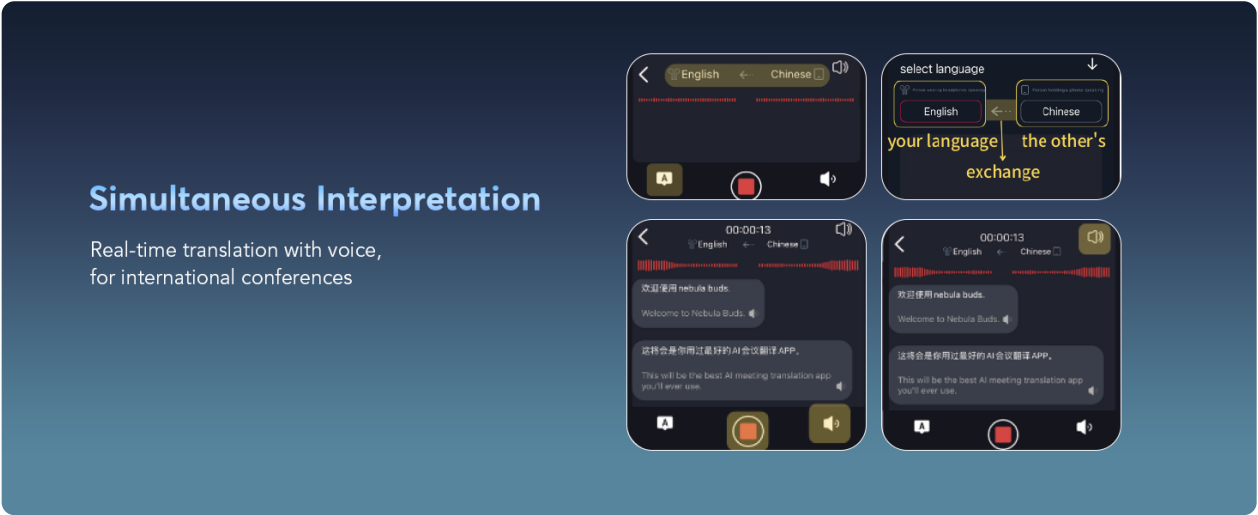

Image: Screenshots displaying the AI Assistant feature, highlighting various AI applications like one-click writing and PPT courseware outline generation.

- **Text-to-Image:** Generate images based on provided text descriptions.



Image: Screenshots demonstrating the Text-to-Image feature, where users can generate images from text descriptions and save them.

- **Image-to-Image:** Generate new images based on a reference image and text description.

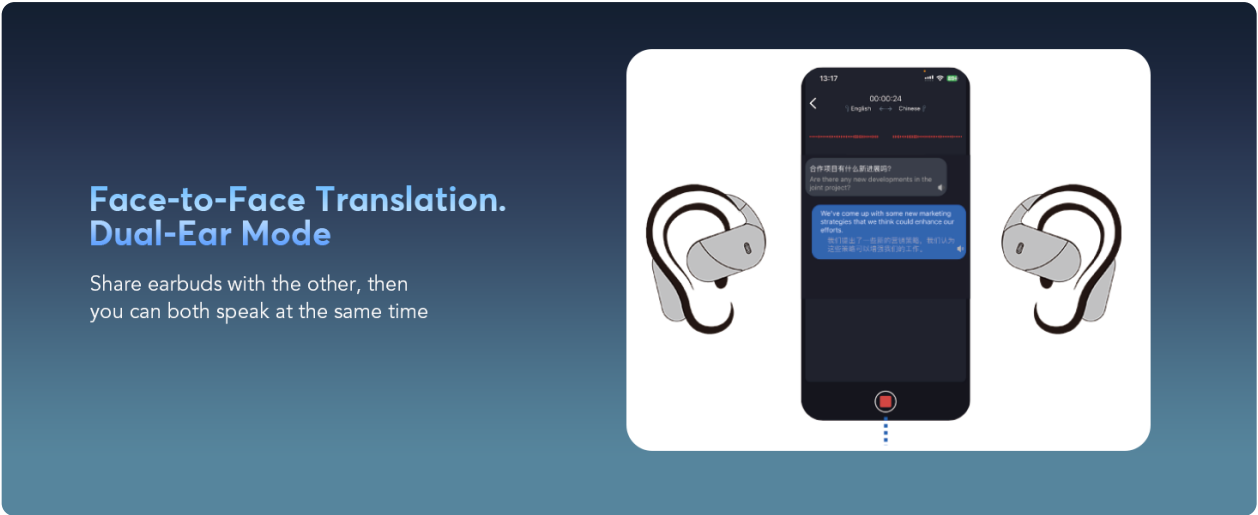

Image: Screenshots showing the Image-to-Image feature, allowing users to generate new images from a reference image and text description.

- **Audio and Video Call with Real-Time Translation:**Conduct online calls with integrated real-time translation, without requiring the other party to have the app.



Image: A screenshot of the app's audio and video call interface, demonstrating real-time translation during a call.

- **Audio and Video History:** Easily view call records and support redial functionality.



Image: Screenshots showing the audio and video call history within the app, allowing users to review past calls and redial.

## MAINTENANCE

- **Cleaning:** Use a soft, dry cloth to clean the earbuds and charging case. Avoid using liquids or abrasive cleaners.
- **Storage:** When not in use, store the earbuds in their charging case to protect them and ensure they remain charged. Store in a cool, dry place away from direct sunlight and extreme temperatures.
- **Water Resistance:** The earbuds are IP68 rated for water protection. While they can withstand splashes and sweat, avoid submerging them in water for extended periods.

## TROUBLESHOOTING

Issue	Possible Cause	Solution
-------	----------------	----------

Issue	Possible Cause	Solution
Earbuds not connecting to phone/app	Bluetooth off, earbuds not charged, app permissions denied, incorrect pairing.	Ensure Bluetooth is on. Check earbud and case battery levels. Verify app permissions. Forget device in phone's Bluetooth settings and re-pair.
Translation not working or inaccurate	No internet connection, incorrect language settings, background noise, speaking too fast/unclearly.	Ensure stable internet connection. Verify source and target languages in the app. Speak clearly and at a moderate pace. Reduce background noise.
No audio from earbuds	Earbuds not connected, low battery, volume too low, audio source issue.	Check Bluetooth connection. Charge earbuds. Increase volume on both earbuds and connected device. Test with a different audio source.
Earbuds falling out	Improper fit.	Adjust the earbuds according to the wearing instructions to ensure a secure fit over the ear.







## SPECIFICATIONS

Feature	Detail
Model Name	OWS 4-in-1 Translation Headphones
Connectivity Technology	Wireless (Bluetooth)
Bluetooth Version	5.4
Audio Driver Type	14.2mm Bio-Carbon Fiber Dynamic Driver
Frequency Range	50Hz - 5kHz
Battery Life (Earbuds)	6 Hours (single playtime)
Total Playtime (with Case)	80 Hours
Charging Time	1.5 Hours (Fast Charging with Type-C)
Control Method	App, Smart Touch Controls
Special Features	AI Real-Time Translation (144+ languages), 4-in-1 Functionality, Advanced Microphone System, IP68 Water Protection
Compatible Devices	Smartphones (iOS and Android)
Material	Carbon Fiber
Item Weight	0.2 Grams (earbuds) / 0.007 ounces (total)
Product Dimensions	5 x 4 x 1 inches

## WARRANTY AND SUPPORT

For warranty information and customer support, please refer to the contact details provided with your purchase documentation or visit the official MAIJOFO website. Keep your purchase receipt as proof of purchase for any warranty claims.

## Related Documents - YYK-Q16S AI

  <small>WhatsApp Support WhatsApp ID: 983602461144 E-mail Support: support@vormor.cn</small> <small>Please read this instruction manual carefully and keep it properly before you use the product.</small>	<a href="#">Vormor AI Voice Translator User Manual &amp; Features Guide</a> Comprehensive user manual for the Vormor AI Voice Translator. Learn about its AI-powered features, setup, online/offline translation, recording, photo translation, group chat, real-time modes, specifications, and safety.
	<a href="#">T9 Voice Translator: User Manual and Instructions for Use</a> Comprehensive guide for the T9 Voice Translator, an AI-powered device for instant voice and photo translation. Learn how to use its features, connect to networks, and understand important warnings and warranty information.
	<a href="#">CheetahTALK AI Translator App: Download &amp; Translate Languages</a> Download the CheetahTALK app for free to get instant, accurate translations in 42 languages, including English, Spanish, Chinese, Japanese, and Korean. Enhance global communication.
	<a href="#">Ear Dance User Manual: Instant Translation Earphones</a> Comprehensive user manual for Ear Dance instant translation earphones, detailing setup, pairing, authorization, and intelligent translation modes. Supports 134 languages for seamless communication.
	<a href="#">AI Simultaneous Language Translator: Instruction Manual and Features</a> A comprehensive guide to the AI Simultaneous Language Translator, detailing its various modes including voice translation (online and offline), photo translation, recording, and simultaneous interpretation. Learn about its features, language support, and troubleshooting.
	<a href="#">Smart Translator T22 User Manual and Features</a> Comprehensive guide to the Shenzhen MSAI Technology Smart Translator T22, covering features like real-time translation, offline modes, photo translation, and AI capabilities.