

## Manuals+

[Q & A](#) | [Deep Search](#) | [Upload](#)

[manuals.plus](#) /

› [DOILIESE](#) /

› [DOILIESE Handheld Shower Head SK-HS-6-AJC-001 Instruction Manual](#)

## DOILIESE SK-HS-6-AJC-001

# DOILIESE Handheld Shower Head Instruction Manual

Model: SK-HS-6-AJC-001

## INTRODUCTION

---

This manual provides detailed instructions for the installation, operation, and maintenance of your DOILIESE Handheld Shower Head. Please read this manual thoroughly before installation and use to ensure proper function and longevity of the product. Keep this manual for future reference.

## SAFETY INFORMATION

---

- Ensure all connections are tight to prevent leaks.
- Do not use excessive force when tightening components, as this may cause damage.
- Always check water temperature before use, especially when bathing children or pets, to prevent scalding.
- If you experience low water pressure, consider removing the flow restrictor as described in the installation section.

## PACKAGE CONTENTS

---

Verify that all components are present before beginning installation:

- Handheld Shower Head x 1
- 79-inch Stainless Steel Shower Hose x 1
- Overhead Bracket x 1
- Installation Manual x 1
- Washers x 3 (2 pre-installed in hose connections)

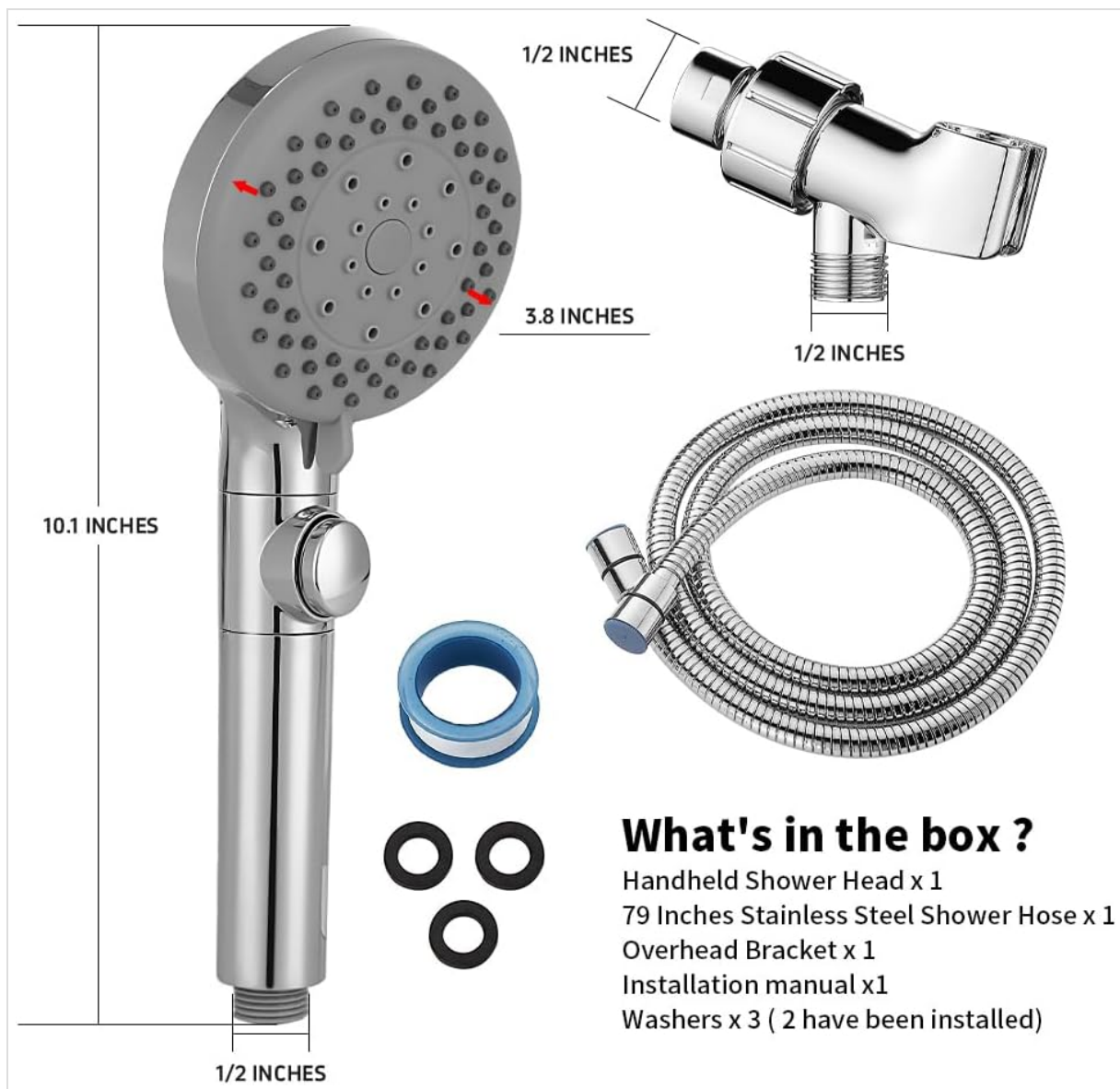

**Figure 1: Package Contents and Dimensions.** This image displays the handheld shower head, the 79-inch stainless steel hose, the overhead bracket, and the washers. Key dimensions for the shower head (10.1 inches long, 3.8 inches wide) and bracket (1/2 inch connections) are also indicated.

## INSTALLATION INSTRUCTIONS

The DOILIESE Handheld Shower Head is designed for easy, tool-free installation. Follow these steps:

1. **Prepare Existing Setup:** Turn off the main water supply to your shower. Remove your existing shower head and clean any old sealant or debris from the shower arm threads.
2. **Install Overhead Bracket:** Apply plumber's tape (not included) to the threads of your shower arm. Screw the new overhead bracket onto the shower arm. Hand-tighten until secure.
3. **Connect Hose to Bracket:** Ensure a washer is seated inside one end of the 79-inch stainless steel hose. Connect this end to the overhead bracket. Hand-tighten.
4. **Connect Hose to Shower Head:** Ensure the second washer is seated inside the other end of the hose. Connect this end to the handheld shower head. Hand-tighten.
5. **Place Shower Head:** Insert the handheld shower head into the holder on the overhead bracket.
6. **Check for Leaks:** Turn on the main water supply and check all connections for leaks. If leaks occur, tighten connections slightly or reapply plumber's tape.



**Figure 2: Easy Installation Steps.** This visual guide illustrates the process of connecting the overhead bracket to the shower arm, then attaching the hose to both the bracket and the handheld shower head. Washers are shown pre-installed in the hose connections.

### Flow Restrictor Removal (Optional)

Your shower head comes with a pre-installed flow restrictor to meet water conservation standards (1.8 GPM). If you experience very low water pressure and desire a higher flow rate (up to 2.5 GPM), you may remove this restrictor. To do so, carefully unscrew the shower head from the hose. Locate the small plastic restrictor inside the shower head's base and gently remove it using pliers or tweezers. Reassemble the shower head and hose, ensuring the washer is properly seated.

## OPERATING INSTRUCTIONS

### Adjusting Spray Modes

The DOILIESE Handheld Shower Head offers 7 distinct settings, including 6 spray modes and a pause function. To change the spray mode, rotate the dial on the shower head face. The available modes are:

- **Spa:** A gentle, wide spray for relaxation.
- **Rain + Spa:** Combines the wide Spa spray with a traditional Rain shower.
- **Massage:** A focused, pulsating stream designed to relieve muscle tension.

- **Rain + Massage:** Blends the Massage stream with the standard Rain shower.
- **Rain:** A classic, full-coverage shower experience.
- **Pause:** Temporarily stops water flow without changing temperature settings.



**Figure 3: Spray Mode Selection.** This image illustrates the various spray patterns available by rotating the shower head's dial, including Spa, Rain+Spa, Massage, Rain+Massage, Rain, and a Stop function.

### **On/Off Pause Switch**

The integrated on/off switch on the handle allows you to completely stop the water flow. This feature is useful for conserving water while lathering or when bathing children or pets, as it maintains the water temperature without needing to adjust the faucet.



**Figure 4: On/Off Pause Switch.** This image highlights the button on the shower head handle that provides a complete stop of water flow, useful for tasks like bathing pets or children without adjusting the main water controls.

### **Powerful Wash Mode**

For targeted cleaning, the shower head features a Powerful Wash Mode. To activate this, detach the shower head face by rotating it. This exposes a concentrated jet ideal for cleaning bathroom surfaces, toilets, or pet bathing areas.

# Powerful Wash Mode



For Pets



For Bathroom



For Toilet



For Sewer

**Figure 5: Powerful Wash Mode.** This image shows how to detach the shower head face to access a powerful, concentrated water stream, suitable for cleaning various areas such as pet fur, bathroom surfaces, toilets, and drains.

## MAINTENANCE

### Cleaning the Shower Head

To maintain optimal performance and prevent mineral buildup, regularly clean the shower head nozzles. The grey silicone nozzles are designed to be anti-clog and easy to clean:

- Gently rub the silicone nozzles with your finger or a soft brush to dislodge any mineral deposits.
- For more stubborn buildup, soak the shower head in a solution of equal parts white vinegar and water for 30 minutes, then scrub and rinse thoroughly.
- Avoid using abrasive cleaners or harsh chemicals, as these can damage the finish.

# Grey Surface Easy to Clean



**Figure 6: Anti-Clog Nozzles.** This image provides a close-up view of the shower head's grey silicone nozzles, emphasizing their anti-clog design for easy cleaning and maintenance.

## Hose Care

The 79-inch stainless steel hose is designed to be anti-rust and anti-twist. To prolong its life, avoid kinking or sharply bending the hose during use or storage.

## TROUBLESHOOTING

Problem	Possible Cause	Solution
Low Water Pressure	Flow restrictor installed; mineral buildup in nozzles.	Remove flow restrictor (see Installation); clean nozzles (see Maintenance).
Leaks at Connections	Loose connections; missing or worn washers; insufficient plumber's tape.	Tighten connections; ensure washers are properly seated; reapply plumber's tape.
On/Off Switch Stuck	Mineral buildup; internal mechanism issue.	Soak shower head in vinegar solution; if issue persists, contact customer support.

Problem	Possible Cause	Solution
Inconsistent Spray Pattern	Clogged nozzles.	Clean nozzles (see Maintenance).

## SPECIFICATIONS

---

- **Brand:** DOILIESE
- **Model:** SK-HS-6-AJC-001
- **Style:** 6 Modes and Power Wash
- **Color:** Chrome
- **Shape:** Round
- **Material:** Shower Head: Premium ABS; Bracket: Brass and ABS; Hose: Stainless Steel and Brass
- **Finish Type:** Polished
- **Installation Type:** Wall Mounted
- **Flow Rate:** 1.8 GPM (with restrictor), 2.5 GPM (without restrictor)
- **Product Dimensions:** 10.1"L x 3.8"W
- **Item Weight:** 1.43 pounds
- **Hose Length:** 79 Inches
- **Special Features:** Detachable, Kink Free Hose, Shower Head with On/Off Switch

## WARRANTY AND SUPPORT

---

For warranty information or technical support, please refer to the contact details provided with your purchase documentation or visit the official DOILIESE website. Please have your model number (SK-HS-6-AJC-001) available when contacting support.