

## Manuals+

[Q & A](#) | [Deep Search](#) | [Upload](#)

manuals.plus /

› [TODAAIR](#) /

› [TODAAIR Outdoor WiFi Extender AC1200 Instruction Manual](#)

## TODAAIR AC1200

# TODAAIR Outdoor WiFi Extender AC1200 Instruction Manual

Model: AC1200

## INTRODUCTION

This manual provides detailed instructions for the installation, configuration, and operation of your TODAAIR Outdoor WiFi Extender AC1200. This device is designed to extend your existing Wi-Fi network coverage outdoors, providing stable and high-speed internet access in various environments. Please read this manual thoroughly before use to ensure proper setup and optimal performance.

## PACKAGE CONTENTS

Verify that all items listed below are included in your package:

- Outdoor WiFi Extender \*1
- Quick Installation Guide \*1
- Power Adapter 12V/1A \*1
- Plastic Cable Tie \*1
- Stainless Steel Tie \*1

## PRODUCT FEATURES

The TODAAIR Outdoor WiFi Extender AC1200 offers a range of features designed for robust outdoor wireless connectivity:

- **Dual-Band Connectivity:** Supports both 2.4GHz (up to 300Mbps) and 5GHz (up to 867Mbps) frequencies for flexible and high-speed network access.
- **Enhanced Security:** Compatible with WPA-PSK/WPA2-PSK and WPA/WPA2 wireless security protocols to protect your network.
- **Extensive Coverage:** Extends Wi-Fi range up to 2000 sq ft and can connect up to 30 devices, including laptops, smartphones, and IoT devices.
- **Multiple Operating Modes:** Functions as both a Repeater and an Access Point (AP) to suit various network requirements.

- **IP65 Weatherproof Design:** Features a durable housing with lightning protection, resistance to water, dust, freezing temperatures, high temperatures, and corrosion, ensuring stable operation in harsh outdoor conditions.
- **Ethernet Port:** Includes one Ethernet port for wired connections to devices such as computers or IP cameras.

## Outdoor AP/Repeater Dual Band Rate up to 1200Mbps

Extremely fast Internet access and elimination of signal dead zones. Enhance WiFi experience across the board

**1200Mbps**  
2.4G+5G

**300FT**  
Coverage

Todaair

The extender provides up to 1200Mbps dual-band speed and extends coverage up to 300 feet.

# Continuous network connectivity, rain or shine

Resistant to rain and stable in storms



The IP65 weatherproof design ensures continuous network connectivity in various weather conditions.

## PRODUCT OVERVIEW

Familiarize yourself with the physical components and ports of the TODAAIR Outdoor WiFi Extender.

Supports WiFi extension and Ethernet port,  
network coverage without dead angle



Connect the Computer



Connect the Camera



This image displays the bottom of the extender, highlighting the Reset (RES), LAN (Ethernet), and DC Power ports. The LAN port allows for wired connections to devices like computers or cameras.

- **RES (Reset) Button:** Used to restore the device to factory default settings. Press and hold for approximately 10 seconds.
- **LAN (Ethernet) Port:** Connects to wired devices such as computers, smart TVs, or IP cameras.
- **DC Power Port:** Connects to the provided 12V/1A power adapter.

## SETUP INSTRUCTIONS

### Physical Installation

The TODAAIR Outdoor WiFi Extender is designed for outdoor mounting. Choose a location that provides optimal signal coverage between your main router and the desired extended area. It can be mounted on a pole using the provided ties or on a wall.



The extender is shown mounted outdoors, illustrating its intended use for extending Wi-Fi coverage around a property.

### **Configuration Steps**

Follow these steps to configure your WiFi Extender using a mobile device or computer:

# Complete the connection in one minute.

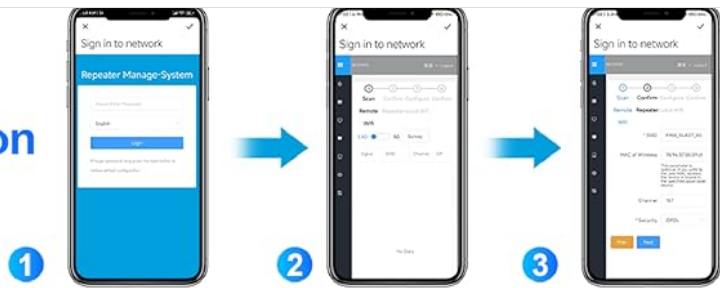

**Step 1:** Connect "TDair" Network, Enter password in the login interface.

**Step 2:** Select the type of network to expand and click on the "Survey" button, Select the network that needs to be expanded.

**Step 3:** If the network requires a password, enter it here. if there is no password, click "Next".

**Step 4:** On the page, set up your SSID and Password and click Confirm, then you can use high-speed extender WiFi!

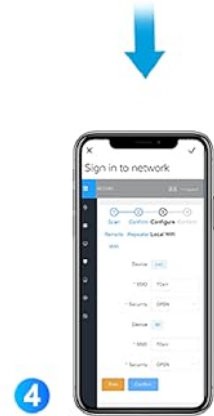

This image illustrates the four-step process for connecting and configuring the extender using a mobile device's web interface.

- Step 1:** Power on the extender. On your mobile device or computer, connect to the extender's default Wi-Fi network, typically named "TDairNetwork". Open a web browser and enter the default IP address (e.g., 192.168.10.1) to access the login interface.
- Step 2:** Once logged in, select the desired network type (Repeater or AP mode) and click the "Survey" button to scan for available Wi-Fi networks. Select the network you wish to extend or connect to.
- Step 3:** If the selected network requires a password, enter it in the provided field. If it is an open network, proceed to the next step.
- Step 4:** On the next page, set up a new SSID (network name) and password for your extended Wi-Fi network. Click "Confirm" to save your settings. Your extender will then restart, and you can connect to the new extended Wi-Fi network.

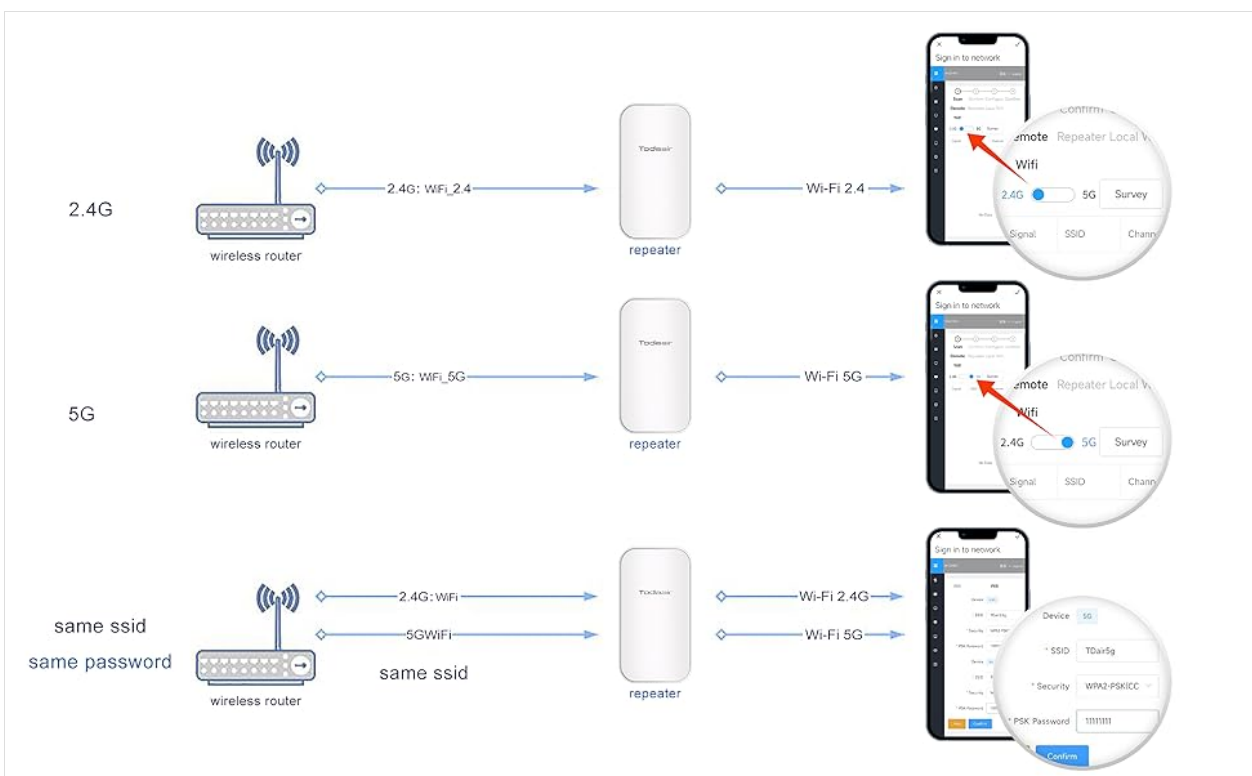

This diagram illustrates how the extender connects to your existing 2.4GHz or 5GHz wireless router and creates an extended Wi-Fi network.

## OPERATING MODES

The TODAAIR Outdoor WiFi Extender AC1200 supports two primary operating modes:

### 1. Repeater Mode

In Repeater Mode, the device extends the range of an existing wireless network. It receives the Wi-Fi signal from your main router and re-broadcasts it under a new or existing network name, effectively expanding coverage to areas with weak or no signal.

### 2. AP (Access Point) Mode

In AP Mode, the device converts a wired internet connection into a wireless access point. This is useful for creating a new Wi-Fi network in an area where only a wired connection is available, such as an Ethernet port in a remote building.



This diagram visually explains both Repeater mode (extending a wireless signal) and AP mode (converting a wired connection to wireless).

## Ethernet Port Functionality

The integrated Ethernet port allows for stable wired connections. In Repeater mode, it can provide network access to a wired device. In AP mode, it receives the internet connection from your main network.



The extender can connect to outdoor wired devices, such as security cameras, providing them with network access.

## MAINTENANCE

To ensure the longevity and optimal performance of your TODAAIR Outdoor WiFi Extender, consider the following maintenance tips:

- **Cleaning:** Periodically clean the exterior of the device with a soft, dry cloth. Avoid using liquid cleaners or solvents.
- **Ventilation:** Ensure that the device's ventilation areas are not obstructed to prevent overheating.
- **Firmware Updates:** Regularly check the official TODAAIR website for any available firmware updates. Keeping the firmware updated can improve performance and security.
- **Cable Connections:** Periodically inspect all cable connections (power, Ethernet) to ensure they are secure and free from damage.

## TROUBLESHOOTING

---

If you encounter issues with your TODAAIR Outdoor WiFi Extender, refer to the following common problems and solutions:

### No Power

Ensure the power adapter is securely connected to the device and a working power outlet. Verify the power outlet is functional by plugging in another device.

### No Internet Connection

Verify that your main router has an active internet connection. Check the extender's configuration to ensure it is properly connected to your main Wi-Fi network. Try restarting both the router and the extender.

### Weak Signal or Slow Speed

Adjust the extender's physical position to be within optimal range of your main router and the desired coverage area. Ensure there are no major physical obstructions (e.g., thick walls, metal objects) between the extender and your devices or the main router. Consider interference from other electronic devices.

### Cannot Access Setup Page

Ensure your device (computer/phone) is connected to the extender's default Wi-Fi network (e.g., "TDairNetwork"). Double-check the IP address entered in the browser. If issues persist, try resetting the extender to factory defaults by pressing the reset button for 10 seconds.

### Device Not Detected

Confirm the extender is powered on and its indicator lights are active. If the device is still not detected, try a different power outlet or contact technical support.

## TECHNICAL SPECIFICATIONS

---

Detailed specifications for the TODAAIR Outdoor WiFi Extender AC1200:

Feature	Detail
Product Dimensions	9 x 3 x 4 inches
Item Weight	15.5 ounces
Wireless Communication Standard	802.11a/b/g/n/ac
Data Transfer Rate	1200 Megabytes Per Second
Frequency Band Class	Dual-Band (2.4GHz & 5GHz)
Special Feature	IP65 Waterproof, Repeater & AP Mode
Model Number	AC1200
Manufacturer	TODAAIR

## WARRANTY AND SUPPORT

---

The TODAAIR Outdoor WiFi Extender AC1200 comes with a standard manufacturer's warranty. For detailed warranty information, please refer to the product packaging or the official TODAAIR website.

For technical assistance, troubleshooting, or customer support, please visit the TODAAIR support page or

contact their customer service department. You can find more information and contact details by visiting the official TODAAIR store:

[Visit the TODAAIR Store on Amazon](#)