

**SOULION C40**

# SOULION 2.0 Computer Speakers

Model: C40  
Brand: SOULION

## INTRODUCTION

Thank you for purchasing the SOULION 2.0 Computer Speakers. This manual provides detailed instructions for the setup, operation, maintenance, and troubleshooting of your new speakers. Please read this manual thoroughly before use to ensure proper functionality and to maximize your listening experience.



Image: SOULION 2.0 Computer Speakers positioned on a desktop, demonstrating their compact form factor and integrated LED lighting.

## PACKAGE CONTENTS

Please verify that all items are present in the package:

- SOULION 2.0 Computer Speakers (Left and Right units)
- Integrated Control Pod with USB-A and 3.5mm audio cables
- Power Cable (integrated with USB-A cable)

## PRODUCT OVERVIEW

The SOULION 2.0 Computer Speakers are designed to provide clear audio with dynamic LED lighting. Key features include:

- **Dual 5W Speakers:** Delivers 10W total output with independent diaphragms for enhanced sound clarity.
- **Mirror-Like LED Light Effects:** Features 5 dynamic lighting modes to complement your desktop environment.

- **Versatile Connectivity:** Supports both USB wired connection (plug and play) and Bluetooth wireless connection.
- **Easy-Control Pod:** A dedicated multi-function pod for convenient control of power, volume, LED modes, and Bluetooth reset.
- **Compact Design:** Space-saving form factor suitable for various desktop setups.



Image: A detailed view of the SOULION 2.0 Computer Speakers, highlighting the speaker units and the connected control pod with its USB power and audio cables.



Image: An illustration detailing the physical dimensions of a single speaker unit and an exploded diagram showcasing its internal acoustic components, including the 5W speaker driver and independent diaphragms.

## SETUP

The SOULION speakers offer both USB wired and Bluetooth wireless connection options.

### Wired Connection (USB Mode)

1. Connect the USB-A cable from the control pod to an available USB port on your computer (PC, laptop).
2. Ensure the 3.5mm audio cable from the control pod is connected to the 3.5mm audio output (headphone jack) on your computer.
3. The speakers are plug-and-play and should be recognized automatically by your operating system.
4. Use the control pod to power on the speakers and adjust volume.

### Bluetooth Connection (Bluetooth Mode)

*Note: Bluetooth mode requires the speakers to be USB powered.*

1. Connect the USB-A cable from the control pod to a USB power source (e.g., computer USB port, USB



wall adapter).

2. Long press the Power Switch button on the control pod to turn on the speakers.
3. Toggle the Connect Mode Switch on the control pod to Bluetooth mode (BT). The LED indicator will show Bluetooth pairing status.
4. On your device (smartphone, tablet, Bluetooth-enabled PC), search for Bluetooth devices and select "SOULION C40" to pair.
5. Once paired, the speakers will emit a confirmation sound.

## USB & Bluetooth, Easy Connection

### Just Plug and Play



**Bluetooth Mode**  
(require usb powered)

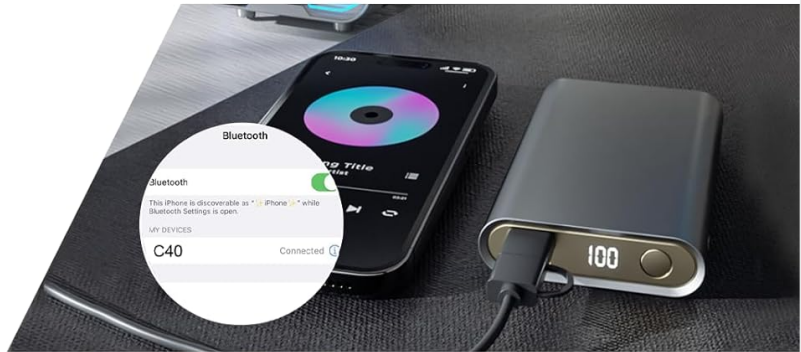

**USB Mode**



**TYPE-C Mode**



Image: Visual guide demonstrating how to connect the SOULION speakers via Bluetooth to mobile devices and via USB to laptops or desktops, including a Type-C mode illustration.

## OPERATING INSTRUCTIONS

The SOULION speakers are controlled via the multi-function control pod.

# All-in-One Control

## Easy-control Pod

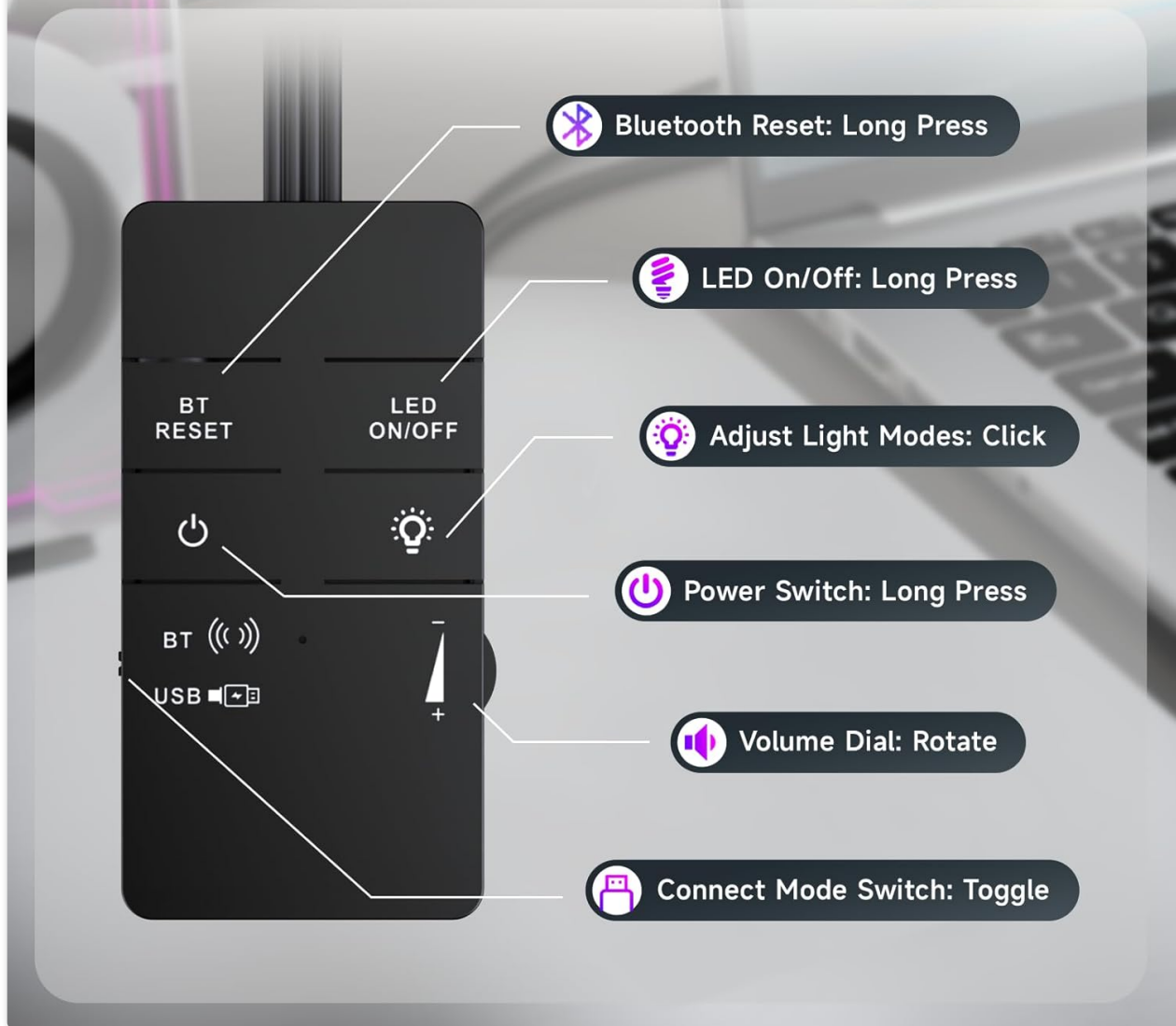

Image: An annotated diagram of the Easy-Control Pod, clearly labeling each button and its corresponding function for intuitive operation.

- **Power On/Off:** Long press the **Power Switch** button (🔌) to turn the speakers on or off.
- **Volume Control:** Rotate the **Volume Dial** (🔊) clockwise to increase volume and counter-clockwise to decrease volume.
- **LED Light On/Off:** Long press the **LED On/Off** button (💡) to toggle the LED lights on or off.
- **Adjust Light Modes:** Click the **Adjust Light Modes** button (💡) to cycle through the 5 available LED lighting modes (LED, Breathing Light, Fixed Color, Flowing Light, Dual Color).
- **Connect Mode Switch:** Toggle the **Mode Switch** (BT/USB) to switch between Bluetooth and USB wired connection modes.
- **Bluetooth Reset:** Long press the **BT Reset** button (🔗) to reset the Bluetooth connection and enter pairing mode.

# Mirror-Like Lighting, Stunning Visuals

## 5 Dynamic Light Modes



LED



Breathing Light



Fixed Color



Flowing Light



Dual Color



Image: The SOULION speakers illuminating a desktop setup with their mirror-like LED lighting, showcasing the visual impact of the 5 dynamic light modes.

## MAINTENANCE

To ensure the longevity and optimal performance of your SOULION speakers, follow these maintenance guidelines:

- **Cleaning:** Use a soft, dry cloth to wipe down the speaker surfaces. Avoid using abrasive cleaners, solvents, or strong chemicals, as they may damage the finish.
- **Dust Removal:** Gently remove dust from speaker grilles and crevices using a soft brush or compressed air.
- **Placement:** Place the speakers on a stable, flat surface away from direct sunlight, heat sources, and excessive moisture. Ensure adequate ventilation around the speakers.
- **Cable Care:** Avoid bending or crimping the cables excessively. Store cables neatly to prevent damage.
- **Storage:** If storing the speakers for an extended period, disconnect them from power and store them in a cool, dry place.

# TROUBLESHOOTING

If you encounter issues with your SOULION speakers, refer to the following common problems and solutions:

Problem	Possible Cause	Solution
No sound from speakers	Speakers not powered on Incorrect input mode selected Volume too low Cables not properly connected Device audio output settings	Long press Power Switch on control pod. Toggle Mode Switch to correct mode (USB/BT). Increase volume using the dial or device. Ensure USB and 3.5mm cables are securely connected. Check your computer/device's audio output settings.
Bluetooth pairing failure	Speakers not in pairing mode Device Bluetooth off Interference Already connected to another device	Long press BT Reset button to enter pairing mode. Ensure Bluetooth is enabled on your device. Move speakers closer to the device, away from other wireless devices. Disconnect from previous device or reset Bluetooth.
LED lights not working	LEDs turned off Power issue	Long press LED On/Off button. Ensure speakers are properly powered via USB.
Sound distortion or static	Volume too high Poor audio source quality Cable interference	Reduce volume. Test with a different audio source. Ensure cables are not near power cords or other electronics.

If the issue persists after trying these solutions, please contact SOULION customer support for further assistance.

# SPECIFICATIONS

Feature	Detail
Model Name	C40BK
Speaker Type	2.0 Channel Computer Speakers
Speaker Maximum Output Power	10 Watts (2 x 5W)
Connectivity Technology	USB, Bluetooth
Wireless Communication Technology	Bluetooth
Bluetooth Range	10 Meters
Frequency Response	20 KHz
Signal-to-Noise Ratio	40 dB
Impedance	4 Ohm



Feature	Detail
Input Voltage	5 Volts
Power Source	Corded Electric (USB Powered)
Product Dimensions (each speaker)	4"D x 3.5"W x 5.5"H
Item Weight	1.96 pounds
Material	Composite
Color	Black
Control Method	Button, Dial
Compatible Devices	Desktop, Laptop, PC, Smartphone, Tablet

## WARRANTY AND SUPPORT

SOULION provides an extended warranty for this product. For specific warranty terms and conditions, please refer to the documentation included with your purchase or visit the official SOULION website.

For technical support, troubleshooting assistance, or inquiries regarding your SOULION 2.0 Computer Speakers, please contact SOULION customer service through their official channels. Contact information can typically be found on the product packaging or the SOULION brand website.





## IMPORTANT SAFETY INFORMATION

- Do not expose the speakers to water or excessive moisture.
- Do not disassemble or attempt to repair the speakers yourself. This may void the warranty and pose a safety risk.
- Keep the speakers away from strong magnetic fields.
- Ensure the power source meets the specified voltage requirements (5 Volts).
- Avoid placing heavy objects on the speakers or cables.

## VIDEO RESOURCES

No official product videos from the seller were available in the provided data for embedding in this manual.

### Related Documents

	<a href="#">Soulion R100 Bluetooth Computer Speakers User Manual</a> User manual for the Soulion R100 Bluetooth computer speakers, detailing setup instructions for USB and Bluetooth modes, specifications, features, and customer service information.
	<a href="#">Soulion C40 User Manual - USB and Bluetooth Speakers</a> User manual for the Soulion C40 speakers, detailing setup instructions for PC, Laptop (USB mode), and Cellphones/iPad (Bluetooth mode). Includes product specifications, features, and customer service information.
	<a href="#">SOULION R90 Bluetooth Soundbar User Guide</a> Learn how to set up and use the SOULION R90 Bluetooth soundbar for your PC, laptop, or mobile devices. This guide covers AUX and Bluetooth modes, features, and customer support.
	<a href="#">SOULION R60 Bluetooth Computer Speakers User Manual - Setup, Features, and Specifications</a> Comprehensive user manual for the SOULION R60 Bluetooth computer speakers. Learn how to set up PC, Bluetooth, and Aux modes, explore features like dynamic lighting and rotary controls, and view detailed specifications. Includes customer support information.

Documents - SOULION – C40

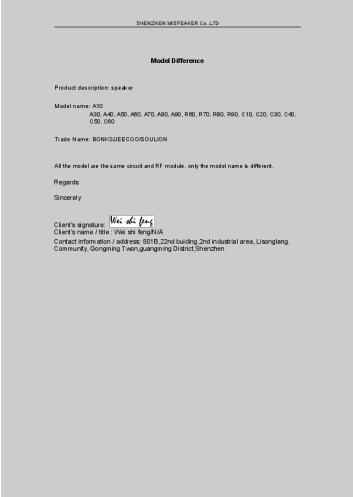

[pdf]

tom Model different SHENZHEN MISPEAKER Co LTD A10 speaker 2BEDF 2BEDFA10 a10  
SHENZHEN MISPEAKER Co.,LTD Model Difference Product description: speaker  
Model name: A10 A30, A40, A50, A60, A70, A80, A90, R60, R70, R80, R90, C10,  
C20, C30, **C40**, C50, C60 Trade Name: BONKS/JEECOO/SOULION All the model  
are the same circuit and RF module, only the model name is different. Regards Si...  
lang:nl **score:24** filesize: 56.28 K page\_count: 1 document date: 2024-01-04

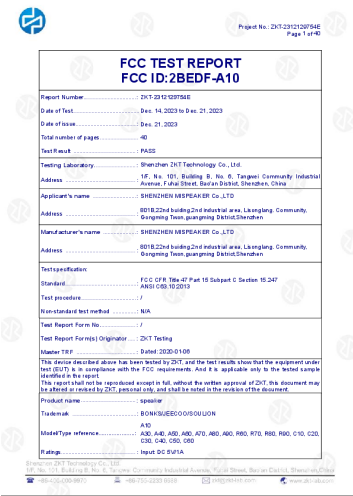

[FCC Test Report for SHENZHEN MISPEAKER A10 Speaker | FCC ID: 2BEDF-A10](#)  
Official FCC test report for the SHENZHEN MISPEAKER A10 speaker, detailing compliance with FCC Part 15 regulations. Includes test results for conducted and radiated emissions, power spectral density, occupied bandwidth, and more.  
lang:en **score:12** filesize: 3.29 M page\_count: 40 document date: 2024-01-04

[Soulion C40 User Manual - USB and Bluetooth Speakers](#)

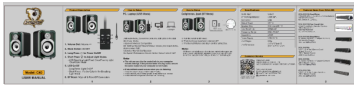

User manual for the Soulion C40 speakers, detailing setup instructions for PC, Laptop (USB mode), and Cellphones/iPad (Bluetooth mode). Includes product specifications, features, and customer service information.

lang:en score:10 filesize: 7.92 M page\_count: 1 document date: 2025-04-27

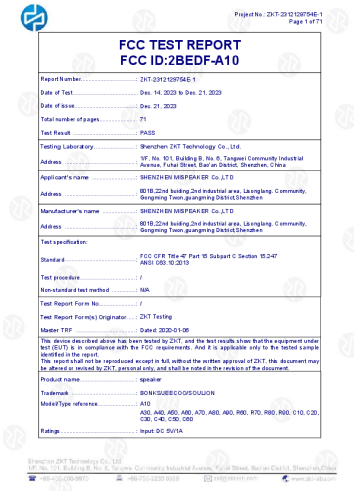

[\[pdf\] Specifications Test Report](#)

55013 Jade Test Report SHENZHEN MISPEAKER Co LTD A10 speaker 2BEDF 2BEDFA10 a10

Project No.: ZKT-2312129754E-1 Page 1 of 71 FCC TEST REPORT FCC ID:2BEDF-A10 Report Number..... : A10 A30, A40, A50, A60, A70, A80, A90, R60, R70, R80, R90, C10, C20, C30, **C40**, C50, C60

Ratings..... : Input: DC 5V/1A Project ...

lang:en score:10 filesize: 3.27 M page\_count: 71 document date: 2024-01-04