

## Ailltopd C5

# Portable Carpet & Upholstery Spot Cleaner User Manual

Brand: Ailltopd | Model: C5

## INTRODUCTION

---

This manual provides essential information for the safe and effective operation, maintenance, and troubleshooting of your Ailltopd Portable Carpet & Upholstery Spot Cleaner. Please read this manual thoroughly before first use and retain it for future reference.

The Ailltopd Portable Carpet & Upholstery Spot Cleaner is designed for deep stain cleaning on various fabric surfaces, including carpets, car seats, pet areas, stairs, and couches. It features powerful 15Kpa suction and a dual-tank system for efficient cleaning.

## WHAT'S IN THE BOX

---

Carefully unpack all components and ensure everything listed below is present and undamaged.

- Main Body (Portable Carpet & Upholstery Spot Cleaner)
- Large Brush Head
- Small Brush Head
- Self-Cleaning Hose Tool
- Power Cord Hook
- Brush Hook
- Hose Hook
- Cleaning Solution (Sample)
- User Manual

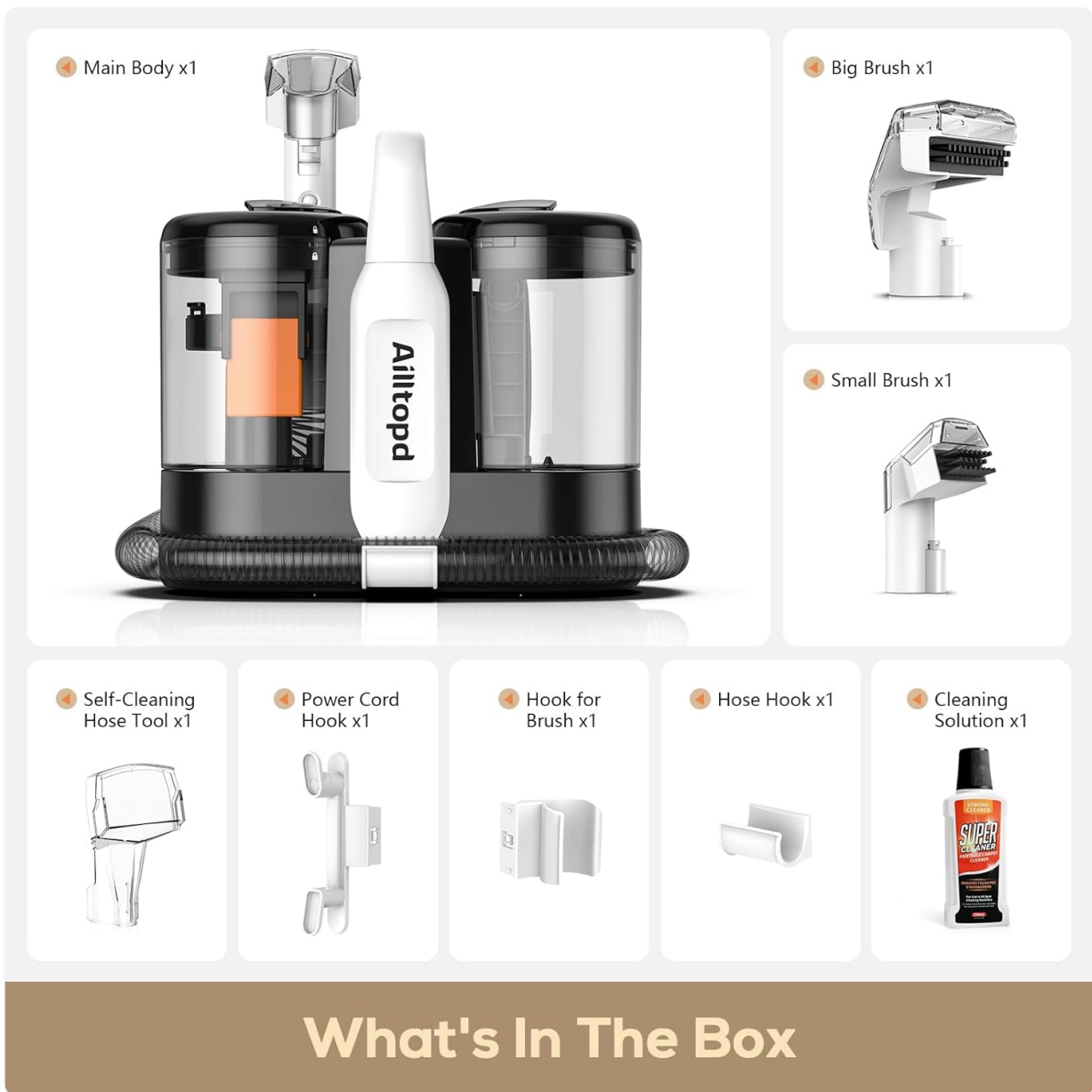

Figure 1: Included Components

## SETUP

1. **Prepare the Clean Water Tank:** Locate the clean water tank (1.5L capacity) on the right side of the unit. Twist the cap to open. Fill the tank with clean water. For enhanced cleaning, add the provided cleaning solution according to the instructions on the solution bottle. **Important: Do not exceed the MAX line indicated on the tank.**
2. **Attach the Desired Brush Head:** Select either the large or small brush head based on the cleaning area. Align the brush head with the end of the hose and push firmly until it clicks into place.
3. **Connect Power:** Plug the power cord into a suitable electrical outlet.

# Removable Large Capacity Water Tank

TIPS: DO NOT EXCEED THE MAX LINE



Figure 2: Dual Tank System

## OPERATING INSTRUCTIONS

### Basic Cleaning

Follow these steps for effective spot cleaning:

1. **Power On:** Press the power button located on the top of the unit to turn on the cleaner.
2. **Spray:** Position the brush head over the stained area. Press the spray trigger on the handle to release the cleaning solution onto the stain.
3. **Brush:** Gently scrub the stained area with the brush head to agitate the stain and allow the solution to penetrate.
4. **Suction:** Release the spray trigger and slowly pull the brush head across the treated area to suction up the dirty water and cleaning solution. Repeat as necessary until the stain is removed and the water being extracted appears clean.



Figure 3: Clean Messes in 3 Easy Steps

## Cleaning Stubborn Stains

For heavily soiled or stubborn stains, allow the cleaning solution to sit on the stain for a few minutes after spraying before scrubbing and suctioning. Multiple passes may be required. For best results, pre-treat severe stains with a suitable spot remover before using the cleaner.

## Muti-Purpose Cleaning



## MAINTENANCE

---

Regular maintenance ensures optimal performance and longevity of your cleaner.

### Cleaning Tanks

1. **Empty Dirty Water Tank:** The dirty water tank (0.8L capacity) is located on the left side. When the suction power decreases or the tank is full, remove it from the unit. Open the tank and dispose of the dirty water. Rinse the tank thoroughly with clean water.
2. **Refill Clean Water Tank:** Refill the clean water tank as needed following the setup instructions.



Figure 5: Easy Tank Management

### Cleaning Hose and Brush Heads

- **Brush Heads:** Detach the brush heads after each use and rinse them under running water to remove any debris or residue.
- **Self-Cleaning Hose Tool:** The unit includes a self-cleaning hose tool. Attach this tool to the hose and run clean water through it to flush out any remaining dirt or solution from the hose.

# Remove for Brush Cleaning & Self-Cleaning Hose Tool

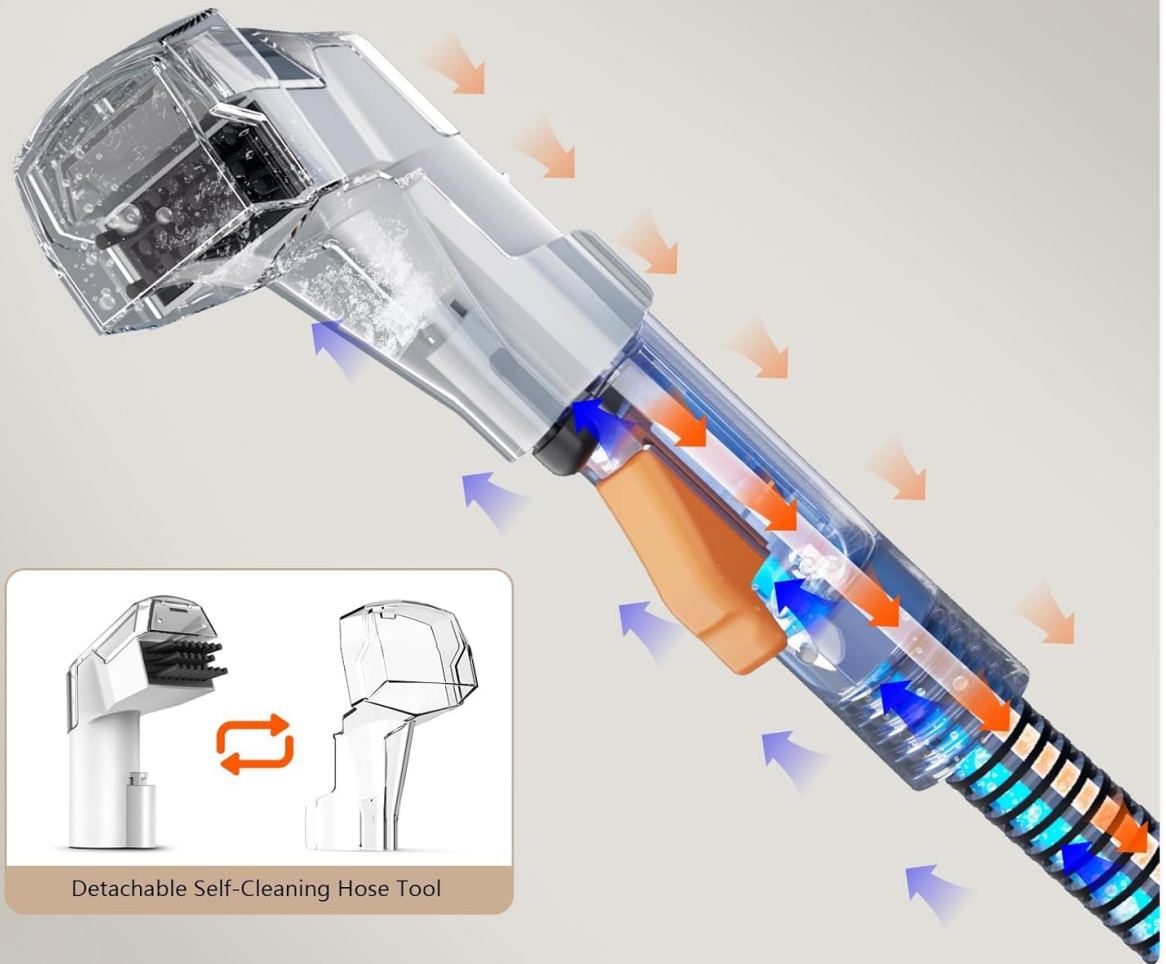

Figure 6: Self-Cleaning Hose Tool

## TROUBLESHOOTING

If you encounter issues with your Ailltopd Spot Cleaner, refer to the following common problems and solutions:

Problem	Possible Cause	Solution
No Suction or Weak Suction	Dirty water tank is full; Clean water tank is empty; Hose or nozzle is clogged; Tank not properly sealed.	Empty and rinse dirty water tank; Refill clean water tank; Clear any blockages in the hose or nozzle; Ensure tanks are securely latched.
No Spray or Weak Spray	Clean water tank is empty; Spray nozzle is clogged; Tank not properly seated.	Refill clean water tank; Clean the spray nozzle; Ensure clean water tank is correctly installed.



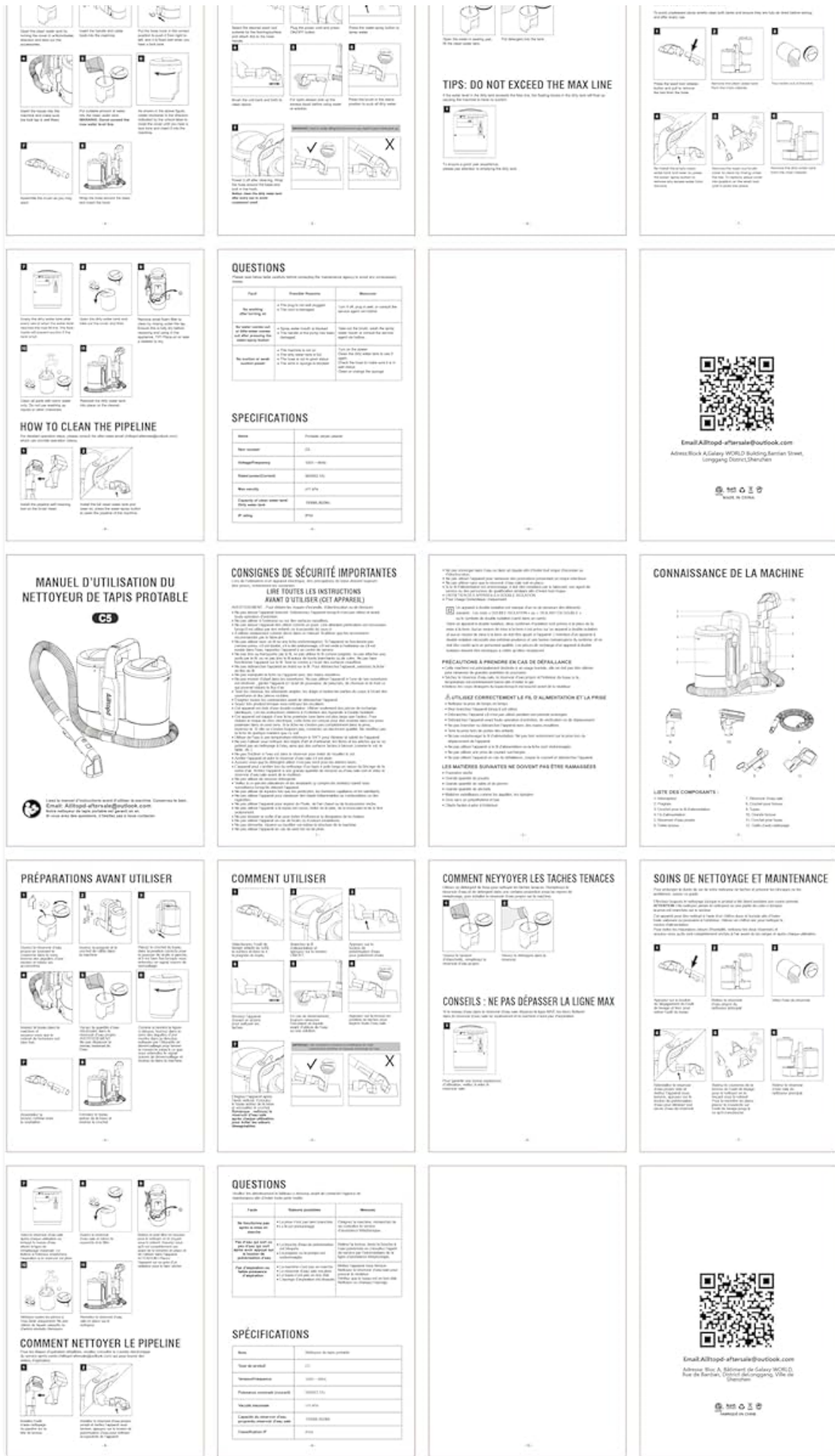

Figure 7: Excerpt from Physical User Manual with QR Code

