

Rapoo MT760 PRO

Rapoo MT760 PRO Wireless Mouse User Manual

Model: MT760 PRO

Brand: Rapoo

1. INTRODUCTION

The Rapoo MT760 PRO is a versatile wireless mouse designed for enhanced productivity and comfort. It features advanced NearLink and Bluetooth 5.0 multi-device connectivity, high-precision tracking, and programmable buttons to streamline your workflow across various operating systems and devices.

2. PACKAGE CONTENTS

Please verify that all items are present in your package:

- 1 x Rapoo MT760 PRO Wireless Mouse
- 2 x NearLink USB Dongles
- 1 x USB-C Charging Cable (USB-A to USB-C)
- 1 x User Manual

3. PRODUCT OVERVIEW

The Rapoo MT760 PRO mouse is engineered for ergonomic comfort and advanced functionality. Below is an image illustrating the mouse design and its various components.



Figure 1: Rapoo MT760 PRO Wireless Mouse. This image displays the top-down view of the matte black mouse, highlighting its ergonomic shape, main scroll wheel, and side scroll wheel, along with two USB dongles.

The mouse features 11 programmable buttons, including the main left/right clicks, two scroll wheels (vertical and horizontal), forward/back buttons, and a DPI switch. An on-board memory allows for saving custom settings directly to the mouse.

11 Programmable Buttons

Customize shortcuts and function keys to streamline your work and boost productivity.



Figure 2: Diagram of 11 Programmable Buttons. This image labels the various buttons on the mouse, including Left, Middle, Right, Roller Left, Roller Right, Roller Forward, Roller Back, Forward, Back, DPI, and DIY (Polling rate switch).

4. SETUP

4.1 Charging the Mouse

The MT760 PRO mouse is equipped with a built-in Lithium Polymer battery. To charge, connect the provided USB-C cable to the mouse and a power source. A 5-minute quick charge can provide a full day of use. The mouse also supports Qi wireless charging with compatible mouse pads (P3 Wireless Charging Module sold separately).

120 Days Battery Life, Works with Wireless Charging System

Add P5 Wireless Charging Module* for continuous wireless charging while at use. Never worry about battery power any more.



P5 Wireless Charging Module sold separately.

Figure 3: Mouse Charging Setup. This image shows the Rapoo MT760 PRO mouse docked on a wireless charging base, indicating its compatibility with wireless charging systems and its long battery life.

4.2 Connecting to Devices

The MT760 PRO offers multiple connectivity options, allowing connection to up to 7 devices simultaneously.

1 mouse , 7 devices.

Connect up to 7 devices
(3*NearLink, 3*Bluetooth, 1*Wired).



Figure 4: Multi-Device Connectivity. This image illustrates the mouse connected to multiple devices, including a desktop monitor, laptop, and tablet, highlighting its ability to connect to up to 7 devices via NearLink, Bluetooth, and wired options.

4.2.1 NearLink USB Connection

1. Locate one of the two NearLink USB dongles provided. One is typically stored in the mouse's bottom compartment, and another is in the package.
2. Plug the NearLink USB dongle into an available USB port on your computer.
3. Ensure the mouse is powered on and set to a NearLink channel (indicated by a specific LED color, usually green for 2.4G).
4. The mouse should automatically connect to the dongle.



Figure 5: NearLink USB Connection. This diagram shows the mouse connecting to a laptop via a 2.4G USB receiver, indicating the channel selection process.

4.2.2 NearLink Wireless Direct Connection

This mode allows direct connection without a USB dongle, typically assigned to Channel 3.



Figure 6: NearLink Wireless Direct Connection. This diagram illustrates the mouse connecting directly to a NearLink enabled device on Channel 3.

4.2.3 Bluetooth Connection

1. Switch the mouse to one of the Bluetooth channels (e.g., BT1, BT2, BT3). The LED indicator will change color.
2. On your device, navigate to Bluetooth settings and enable Bluetooth.
3. Select "Rapoo MT760 PRO" from the list of available devices to pair.

4.2.4 Wired Connection

Connect the mouse to your device using the provided USB-C cable. The wired connection takes priority over NearLink and Bluetooth modes.

4.3 Driver Installation

For full functionality, including programmable buttons and M+ Cross-Computer technology, install the Rapoo mouse driver. The driver can typically be downloaded from the official Rapoo website. Note that M+ Cross-Computer functionality is compatible only with Windows systems.

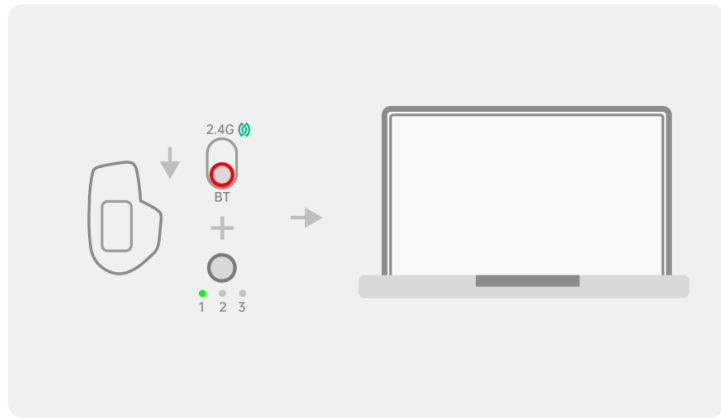

Figure 7: Rapoo Mouse Driver Interface. This image shows the software interface for customizing mouse settings, including button assignments and DPI levels.

5. OPERATING INSTRUCTIONS

5.1 DPI Adjustment

The mouse features 7 adjustable DPI levels: 800, 1200, 1600, 2400, 3200, 6400, and 12000. You can switch between these preset values using the dedicated DPI button on the mouse. Finer adjustments (50 interval) can be made via the mouse driver.

7 Adjustable DPI Levels

7 preset DPI values (800, 1200, 1600, 2400, 3200, 6400, 12000), you can also adjust the DPI values in 50 intervals via the mouse driver.



Figure 8: 7 Adjustable DPI Levels. This diagram visually represents the range of DPI settings available, from 800 to 12000, and indicates that adjustments can be made via the mouse driver.

5.2 Programmable Buttons and On-Board Memory

Utilize the 11 programmable buttons to assign shortcuts, media keys, or macros. The on-board memory stores your settings directly on the mouse, eliminating the need for reconfiguration after rebooting or when switching computers, and reducing system resource usage.

5.3 M+ Cross-Computer Technology

This feature allows seamless control across multiple computers by simply moving the cursor to the edge of the screen. You can also transfer files, images, and text between connected computers by copying and pasting. This function requires the Rapoo driver and is compatible with Windows systems.

M+ Cross-Computer Technology

You can switch between different devices by simply moving the cursor to the edge of the screen.

Easily transfer text, images, and files.



Note: Need to install mouse driver first, this function is only compatible with Windows system.

Figure 9: M+ Cross-Computer Technology. This image demonstrates the ability to seamlessly move the mouse cursor and transfer files between a laptop and a desktop monitor.

5.4 Surface Compatibility

The MT760 PRO incorporates a high-performance laser sensor, providing precise and accurate tracking on a variety of surfaces, including wood, cloth, leather, resin, and paper.

Works on Most Surfaces

Adapts high-performance laser sensor, ideal for more sensitive precision work, provides finer and more accurate tracking on surfaces such as wood, cloth, leather, resin, paper, etc.



Figure 10: Mouse on Various Surfaces. This image shows the mouse operating effectively on different textures, illustrating its versatile surface tracking capabilities.

6. MAINTENANCE

6.1 Battery Life and Charging

The mouse offers up to 120 days of battery life due to NearLink's low-power access mode. Recharge using the USB-C cable or a compatible Qi wireless charging pad. Avoid using the mouse in wired mode while simultaneously attempting wireless charging, as this may interfere with charging efficiency.

6.2 Cleaning

To clean the mouse, use a soft, dry cloth. For stubborn dirt, a slightly damp cloth with mild soap can be used, ensuring no moisture enters the internal components. Avoid abrasive cleaners or solvents.

7. TROUBLESHOOTING

7.1 Connectivity Issues

- **No Connection (NearLink USB):** Ensure the USB dongle is securely plugged in and the mouse is set to the correct NearLink channel. Try a different USB port.

- **No Connection (Bluetooth):** Verify Bluetooth is enabled on your device and the mouse is in pairing mode on a Bluetooth channel. Remove previous pairings and try re-pairing.
- **Intermittent Connection:** Check for potential interference from other wireless devices. Ensure the mouse is within range of your device.

7.2 Tracking Issues

- **Inaccurate Tracking:** Clean the mouse sensor on the underside. Try using the mouse on a different surface or a mouse pad.
- **Cursor Lag:** Ensure the mouse battery is sufficiently charged. For NearLink, ensure the dongle is not obstructed. For Bluetooth, check for system resource usage on your device.

7.3 Software Issues

- **Driver Not Recognizing Mouse:** Reinstall the Rapoo driver from the official website. Ensure your operating system is up to date.
- **Custom Settings Not Applying:** Verify that the settings are saved to the mouse's on-board memory. Restart the driver software.

8. SPECIFICATIONS

Feature	Specification
Product Dimensions	6.73 x 4.4 x 0.1 inches
Item Weight	3.88 ounces
Item Model Number	MT760 PRO
Batteries	1 Lithium Polymer batteries required (included)
Connectivity Technology	Bluetooth, NearLink, USB
Special Features	11 Programmable Buttons with On-Board Memory, 120 Days Battery Life, NearLink Technology, Ultra-Low Latency, 7 Adjustable DPI Levels, Up to 7 Devices, M+ Cross-Computer Technology
Movement Detection Technology	Optical
Manufacturer	Shenzhen Rapoo Technology Co., Ltd.

9. OFFICIAL PRODUCT VIDEO

Your browser does not support the video tag.





Video 1: RAPOO MT760PRO Wireless Bluetooth Mouse Multi-Device 12K DPI. This video provides a visual overview of the Rapoo MT760 PRO mouse, demonstrating its multi-device capabilities, ergonomic design, DPI settings, programmable buttons, and M+ Cross-Computer functionality.

10. WARRANTY AND SUPPORT

For warranty information, technical support, or further assistance, please refer to the official Rapoo website or contact their customer service. Details regarding specific warranty periods and support channels are typically provided with your product documentation or on the manufacturer's website.

© 2025 Rapoo. All rights reserved.

Related Documents - MT760 PRO

	<p>Rapoo MT760 Multi-Device Wireless Mouse Configuration Guide</p> <p>A comprehensive guide to configuring the Rapoo MT760 Multi-Device Wireless Mouse, detailing driver installation, 2.4GHz pairing, button customization, multi-device switching, and factory reset options.</p>
	<p>Rapoo MT760L Multi-Mode Wireless Mouse User Manual</p> <p>This document provides instructions and specifications for the Rapoo MT760L Multi-Mode Wireless Mouse, covering setup, features, and troubleshooting.</p>
	<p>Rapoo MT760L/MT760M Multi-mode Wireless Mouse User Manual</p> <p>Comprehensive user manual for the Rapoo MT760L and MT760M multi-mode wireless mice. Learn about features, setup, connection modes (2.4GHz, Bluetooth), DPI settings, and ergonomic design for enhanced productivity.</p>
	<p>Rapoo MT560 Multi-Mode Wireless Mouse - Features and Specifications</p> <p>Discover the Rapoo MT560, a versatile multi-mode wireless mouse with 4000 DPI, rechargeable battery, and seamless device switching. Learn about its features, specifications, and system requirements.</p>

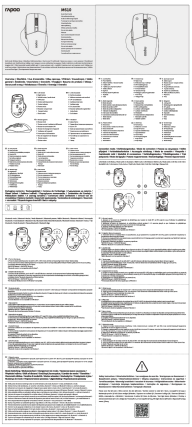
 <p>The image shows the top cover of the Rapoo V200 PRO 4K quick start guide. It features a top-down view of the white gaming mouse with its scroll wheel and buttons. The Rapoo logo is in the top left, and the model name 'V200 PRO 4K' is in the top right. Below the mouse image, there is a list of features and specifications in small text.</p>	<p>Rapoo V200 PRO 4K Wired/Wireless Gaming Mouse Quick Start Guide</p> <p>Official quick start guide for the Rapoo V200 PRO 4K gaming mouse, detailing setup, connection modes, indicator lights, and safety information. This guide covers wired and wireless connectivity, DPI adjustment, and essential product features.</p>
 <p>The image shows the cover of the Rapoo M610 multi-mode wireless mouse quick start guide. It features two side-by-side views of the white mouse. The left view shows the mouse from the side, highlighting the scroll wheel and buttons. The right view shows the mouse from the top. The Rapoo logo is in the top left, and the model name 'M610' is in the top right. Below the mouse images, there is a list of features and specifications in small text.</p>	<p>Rapoo M610 Multi-mode Wireless Mouse Quick Start Guide</p> <p>Concise guide to setting up and using the Rapoo M610 multi-mode wireless mouse, covering connection modes, device switching, and basic operation for optimal performance.</p>