

MeesMeek 5275

MeesMeek Indoor Thermometer Hygrometer Clock Model 5275 User Manual

Model: 5275 | Brand: MeesMeek

INTRODUCTION

This manual provides detailed instructions for the setup, operation, and maintenance of your MeesMeek Indoor Thermometer Hygrometer Clock Model 5275. This device accurately measures indoor temperature and humidity, displays time and date, and features a comfort level indicator and backlight for enhanced readability. Please read this manual thoroughly before using the product to ensure proper function and longevity.

WHAT'S IN THE BOX

- MeesMeek Thermometer Hygrometer Unit x 1
- AAA Batteries x 2
- User Manual x 1

PRODUCT FEATURES

- **Accurate Readings with Calibration:** Equipped with advanced sensors, pre-calibrated for accuracy of $\pm 2^{\circ}\text{F}$ and $\pm 3\% \text{ RH}$. User calibration function available.
- **Intuitive LCD Display:** A 3.7-inch screen shows current temperature, humidity, Max/Min records, air comfort indicator, clock time, and date.
- **Touch-Controlled Backlight:** A 15-second backlight for easy reading in low-light conditions.
- **24-Hour Max/Min Records:** Automatically tracks and resets daily high/low temperature and humidity. Manual reset option available.
- **Air Comfort Indicator:** A 3-color, 9-level bar visually represents air comfort (Dry, Comfort, Wet).
- **Versatile Mounting Options:** Features a foldable kickstand for tabletop use and a hanging hook for wall mounting.
- **Selectable Units:** Easily switch between $^{\circ}\text{F}/^{\circ}\text{C}$ for temperature and 12H/24H for time format.

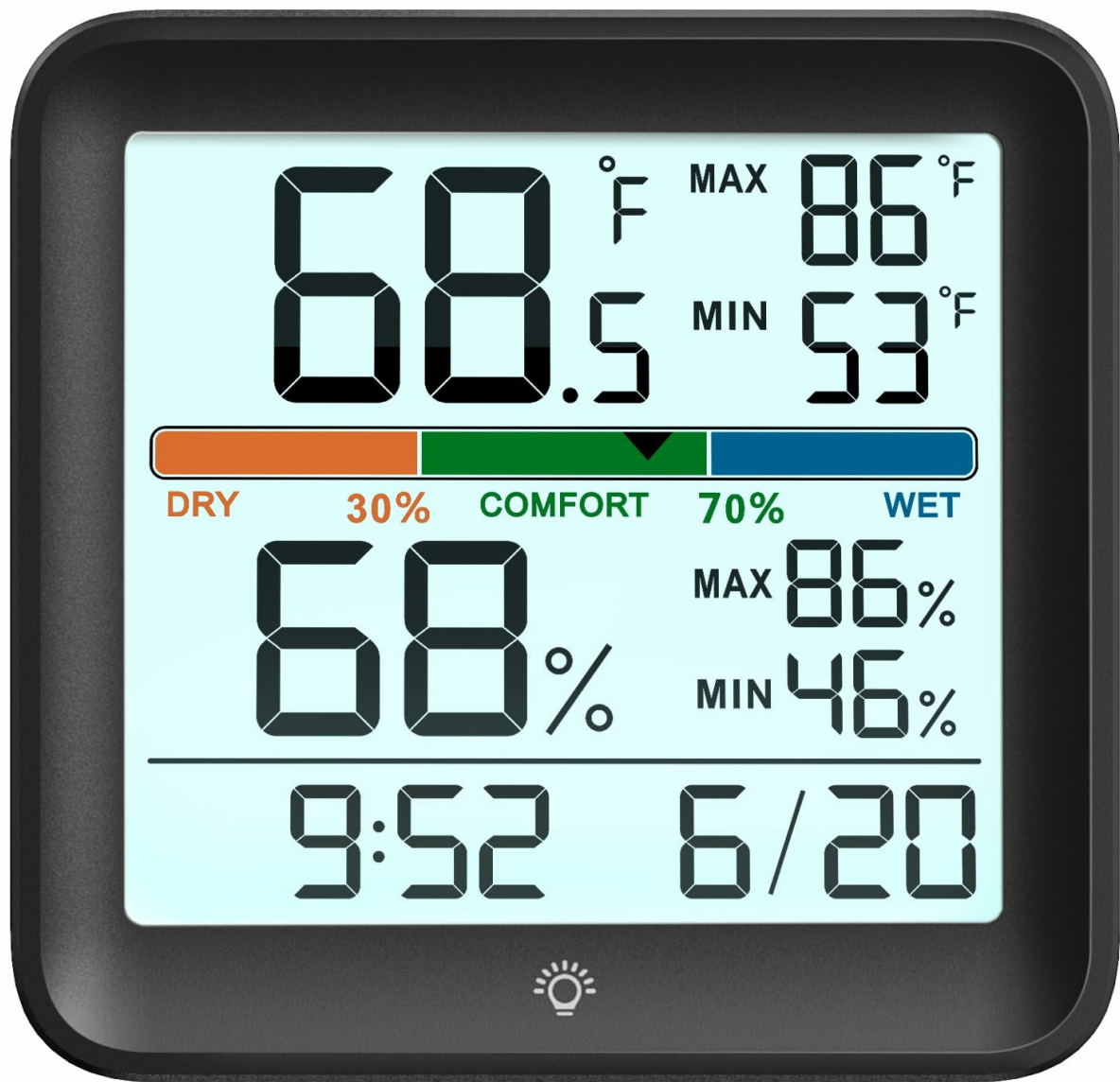

Image: Front view of the MeesMeek Indoor Thermometer Hygrometer Clock, displaying temperature, humidity, Max/Min records, comfort level, time, and date.

SETUP

1. Battery Installation

1. Locate the battery compartment on the back of the device.
2. Open the battery cover. (Note: The kickstand may need to be pulled out to access the cover.)
3. Insert two (2) AAA batteries, ensuring correct polarity (+/-).
4. Close the battery cover securely.



Image: Rear view of the device, highlighting the battery cover, foldable kickstand, and control buttons.

2. Initial Settings (Time, Date, Temperature Unit)

After battery installation, the device will power on. Use the buttons on the back to configure settings.

- **Setting Time and Date:** Press the "SET" button to enter time/date setting mode. Use the "+" and "-" buttons to adjust values. Press "SET" again to confirm each setting (Hour, Minute, Year, Month, Day).
- **Selecting Temperature Unit (°F/°C):** Press the "°F/°C" button to toggle between Fahrenheit and Celsius.
- **Selecting Time Format (12H/24H):** While in time setting mode, press the "°F/°C" button to switch between 12-hour and 24-hour formats.



Image: Close-up of the display showing the time and date, illustrating the clarity of the digits.



Image: Visual representation of switching between Fahrenheit and Celsius temperature units on the display.

3. Mounting the Device

- **Tabletop Placement:** Pull out the foldable kickstand on the back of the device to stand it on a flat surface.
- **Wall Mounting:** Use the integrated hanging hook on the back to mount the device on a nail or screw on a wall.

Ready for Home and Office

2 Mounting Ways



Image: The device shown in two mounting configurations: standing on a table with its kickstand and hanging on a wall using its hook.

OPERATING INSTRUCTIONS

1. Reading the Display

The large LCD screen provides the following information:

- **Current Temperature:** Large digits at the top.
- **Current Humidity:** Large digits in the middle.
- **MAX/MIN Records:** Small digits next to temperature and humidity, showing the highest and lowest values recorded within the last 24 hours.
- **Air Comfort Indicator:** A colored bar indicating Dry, Comfort, or Wet conditions.
- **Time and Date:** Displayed at the bottom.

2. Backlight Function

To activate the backlight, gently touch the light bulb icon at the bottom center of the front panel. The backlight will illuminate for 15 seconds and then automatically turn off to conserve battery life.



Image: Comparison of the device display with the backlight off (left) and on (right), demonstrating improved visibility in dim conditions.

3. Max/Min Records

The device automatically records the maximum and minimum temperature and humidity values over a 24-hour period. These records reset automatically at 00:00 (12:00 AM) daily, based on the device's set time. To manually reset the Max/Min records, press and hold the "CLEAR" button on the back of the device.

4. Air Comfort Indicator

The colored bar on the display provides a quick visual reference for indoor air comfort levels:

- **DRY (Orange):** Humidity below 30%
- **COMFORT (Green):** Humidity between 30% and 69%
- **WET (Blue):** Humidity 70% or above

9 Levels Air Comfort Indicator

Get to know your living environment better

Temperature Range: 14.2°F ~ 140°F (-9.9°C ~ 60°C)

Humidity Range: 10% ~ 95%

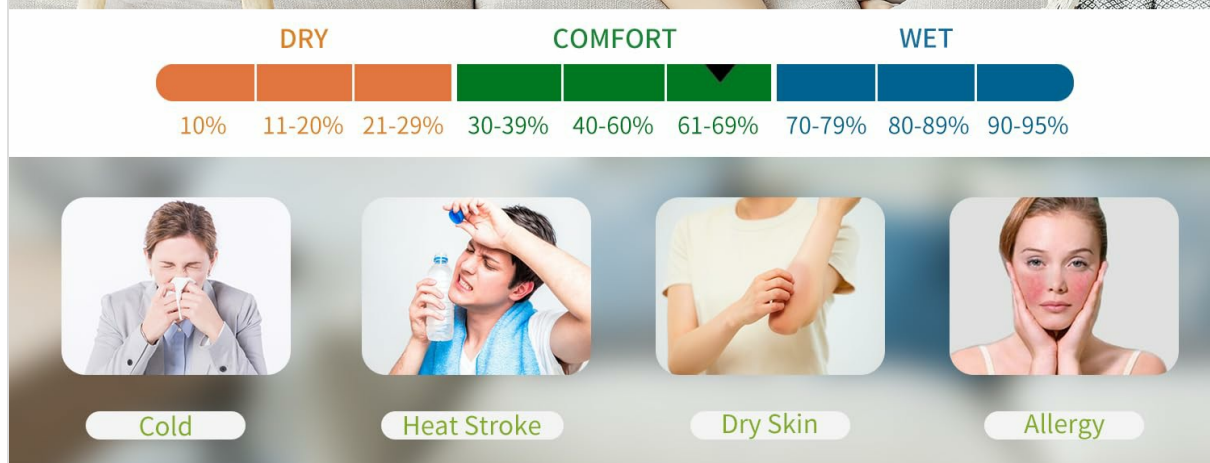

Image: The display showing the air comfort indicator bar, segmented into Dry, Comfort, and Wet zones with corresponding humidity percentages.

5. Calibration Function

The device is pre-calibrated, but you can fine-tune the temperature and humidity readings if needed. To enter calibration mode, press and hold both the "+" and "-" buttons simultaneously for a few seconds. Use the "+" and "-" buttons to adjust the temperature or humidity offset. Press "SET" to switch between temperature and humidity calibration, and again to confirm and exit calibration mode.

Calibrated before Shipment

Temperature

Accuracy: $\pm 1^{\circ}\text{C}$

Calibrate Range: $\pm 41^{\circ}\text{F}/\pm 5^{\circ}\text{C}$

Humidity

Accuracy: $\pm 3\%$

Calibrate Range: $\pm 10\%$



Image: Illustration of the calibration process, showing the device being compared to other measurement tools for accuracy adjustment.

MAINTENANCE

- **Cleaning:** Wipe the device with a soft, dry cloth. Do not use abrasive cleaners or immerse in water.
- **Battery Replacement:** Replace batteries when the low battery indicator appears on the display. Always use new AAA batteries.
- **Storage:** If storing the device for an extended period, remove the batteries to prevent leakage.
- **Environment:** Avoid placing the device in direct sunlight, near heat sources, or in areas with extreme temperature fluctuations or high humidity (e.g., bathrooms, saunas) to ensure accurate readings and prolong device life.

TROUBLESHOOTING

- **Display is blank or unreadable:**
 - Check if batteries are installed correctly with proper polarity.
 - Replace old batteries with new AAA batteries.
 - Ensure the battery cover is securely closed.

- **Inaccurate Temperature/Humidity Readings:**
 - Allow the device to acclimate to the room for at least 30 minutes after initial setup or relocation.
 - Ensure the device is not placed near heat sources, direct sunlight, or vents that could affect readings.
 - Use the calibration function to adjust readings if you have a known accurate reference.
- **Backlight not working:**
 - Ensure batteries have sufficient power. Replace if necessary.
 - Gently touch the light bulb icon on the front panel.
- **Max/Min records not resetting:**
 - Records automatically reset at midnight. To manually reset, press and hold the "CLEAR" button on the back.

SPECIFICATIONS

Model Number	5275
Product Dimensions	3.6" W x 3.4" H x 3.6" D (approx.)
Item Weight	101 Grams (3.56 ounces)
Temperature Range	14.2°F - 140°F (-9.9°C - 60°C)
Humidity Range	10% - 95% RH
Temperature Accuracy	±2°F (±1°C)
Humidity Accuracy	±3% RH
Power Source	2 x AAA Batteries (included)
Display Type	LCD with Backlight

WARRANTY AND SUPPORT

For warranty information, technical support, or customer service inquiries, please refer to the product packaging or visit the official MeesMeek website. Keep your purchase receipt for warranty claims.

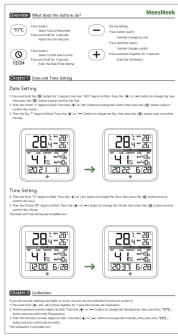

[MeesMeek Indoor Thermometer Hygrometer User Guide: Setup and Calibration](#)

Detailed instructions for setting up and calibrating your MeesMeek indoor thermometer and hygrometer, including button functions, date/time settings, and temperature/humidity calibration.



[MeesMeek Model 6201 Digital Travel Alarm Clock User Manual](#)

This manual provides comprehensive instructions for setting up and operating the MeesMeek Model 6201 Digital Travel Alarm Clock, covering time, date, alarm, backlight, and troubleshooting.

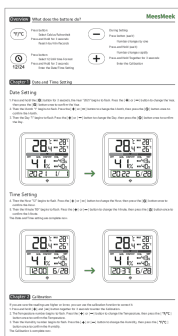

[MeesMeek Indoor Thermometer Hygrometer User Guide: Setup and Calibration](#)

Detailed instructions for setting up and calibrating your MeesMeek indoor thermometer and hygrometer, including button functions, date/time settings, and temperature/humidity calibration.

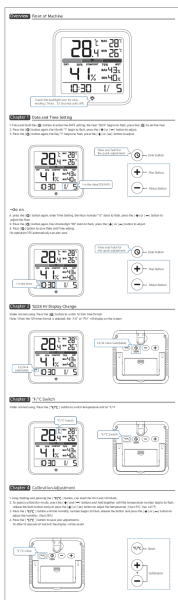

[NOKLEAD Digital Hygrometer Thermometer User Manual - Setup and Calibration Guide](#)

User guide for the NOKLEAD digital hygrometer thermometer, detailing setup, date/time setting, display format switching, temperature unit selection (°C/°F), and calibration procedures for accurate temperature and humidity readings.

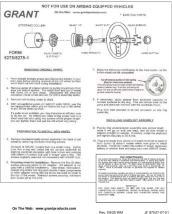
	<p>Cecotec Energysilence Aero 5275: Manual de Instrucciones y Seguridad</p> <p>Descubra el ventilador de techo Cecotec Energysilence Aero 5275. Este manual proporciona instrucciones detalladas de seguridad, funcionamiento, limpieza y mantenimiento para los modelos DarkWood, Black&WhiteWood, White&BlackWood y WhiteWood.</p>
	<p>GRANT Steering Wheel Installation Guide - Models 5275/5275-1</p> <p>Step-by-step instructions for installing a GRANT steering wheel, including removal of the original wheel and assembly of the new kit. Covers models 5275 and 5275-1. Includes warranty information and safety warnings.</p>

Documents - MeesMeek – 5275

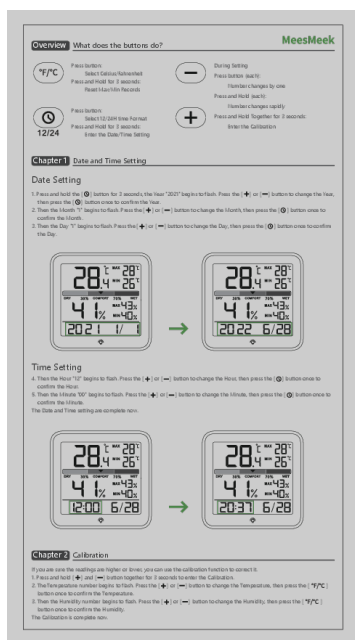

[MeesMeek Indoor Thermometer Hygrometer User Guide: Setup and Calibration](#)

Detailed instructions for setting up and calibrating your MeesMeek indoor thermometer and hygrometer, including button functions, date/time settings, and temperature/humidity calibration.

lang:en score:20 filesize: 404.37 K page_count: 1 document date: 2022-06-29