

Turtle Beach TBC-2003-55

Turtle Beach Rematch Core Wired Gaming Controller User Manual

Model: TBC-2003-55

INTRODUCTION

The Turtle Beach Rematch Core Wired Gaming Controller is designed to enhance your gaming experience on Xbox Series X|S, Xbox One, and Windows 10/11 PCs. This manual provides detailed instructions for setup, operation, maintenance, and troubleshooting to ensure optimal performance of your controller.



Front view of the Turtle Beach Rematch Core Wired Gaming Controller, showcasing its black and green design with the Xbox logo.

PACKAGE CONTENTS

- Turtle Beach Rematch Core Controller
- 8' / 2.5m USB Cable
- Quick Start Guide

SETUP

Follow these steps to connect your Turtle Beach Rematch Core controller to your gaming system.

1. **Connect the USB Cable:** Locate the USB-C port on the top of the controller. Insert the smaller end of the included 8-foot (2.5-meter) USB cable into this port.
2. **Connect to System:** Insert the larger USB-A end of the cable into an available USB port on your Xbox console (Xbox Series X|S, Xbox One) or Windows 10/11 PC.
3. **Power On:** Your controller should automatically power on and be recognized by your system. The Xbox

button on the controller will illuminate.

4. **Driver Installation (PC Only):** For Windows PCs, drivers should install automatically. If prompted, follow on-screen instructions.



Image illustrating the connection of the USB-C cable to the controller.

OPERATING INSTRUCTIONS

The Rematch Core controller offers several features to enhance your gaming experience.

Patented Audio Controls

Adjust your audio settings directly from the controller using the integrated D-pad controls. These controls allow for on-the-fly adjustments without interrupting your game.

- **Game/Chat Mix:** Use the D-pad to balance game audio and chat volume.
- **Master Volume:** Adjust the overall volume level.
- **Mic Mute:** A dedicated button allows for quick microphone muting.



Close-up view of the D-pad, highlighting the integrated audio control functions for game/chat mix, master volume, and mic mute.

Control Hub Companion App

For advanced configuration and diagnosis, download the Control Hub companion app. This app is available on Xbox consoles and Windows PCs.

- **Customization:** Personalize controller settings.
- **Diagnosis:** Perform diagnostic checks to identify and resolve potential issues.

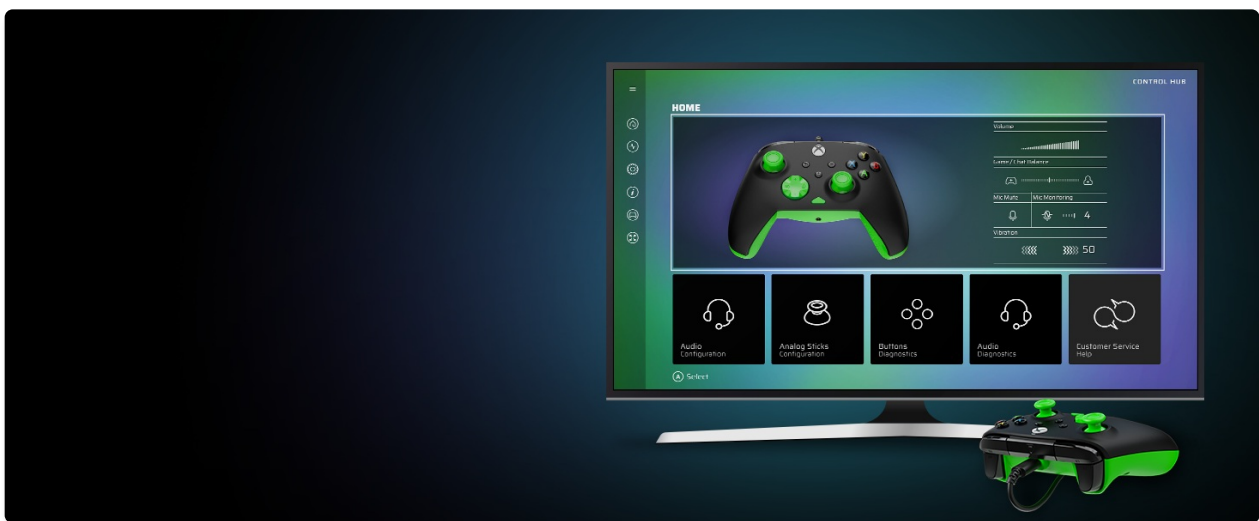

Screenshot of the Turtle Beach Control Hub companion app interface displayed on a monitor, with the Rematch Core controller positioned in front.

Immersive Gameplay

The controller features dual rumble motors and impulse triggers, providing responsive and immersive feedback during gameplay. These features enhance the tactile experience of in-game actions.



Close-up view of the controller's transparent triggers, illustrating the internal rumble motors that provide immersive feedback.

Ergonomic Design

The ergonomic shape and textured grips ensure a comfortable, fatigue-free experience even during extended gaming sessions.



A user's hands comfortably gripping the Turtle Beach Rematch Core controller, highlighting its ergonomic design.

MAINTENANCE

Proper care and maintenance will extend the life of your controller.

- **Cleaning:** Use a soft, dry cloth to wipe down the controller. For stubborn dirt, slightly dampen the cloth with water. Avoid harsh chemicals or abrasive cleaners.
- **Storage:** Store the controller in a cool, dry place away from direct sunlight and extreme temperatures when not in use.
- **Cable Care:** Avoid sharply bending or twisting the USB cable. Always grasp the connector, not the cable, when plugging or unplugging.

TROUBLESHOOTING

If you encounter issues with your controller, refer to the following common solutions.

- **Controller Not Responding:**
 - Ensure the USB cable is securely connected to both the controller and your console/PC.
 - Try connecting the controller to a different USB port on your console/PC.
 - Restart your console or PC.
- **Audio Issues (No Sound/Mic Not Working):**
 - Verify your headset is properly plugged into the controller's 3.5mm jack.
 - Check the audio controls on the D-pad to ensure master volume is up and the mic is not muted.
 - Confirm audio settings within your console or PC's system settings.
- **Control Hub App Connectivity:**
 - Ensure your controller is connected to the console/PC where the app is installed.
 - Update the Control Hub app to the latest version.
 - Restart the app and reconnect the controller.

For further assistance, utilize the diagnostic tools available within the Control Hub companion app or visit the Turtle Beach support website.

SPECIFICATIONS

Feature	Detail
Model Number	TBC-2003-55
Compatibility	Xbox Series X S, Xbox One, Windows 10/11 PCs
Connectivity	Wired USB-C (8ft / 2.5m cable included)
Audio Controls	Game/Chat Mix, Master Volume, Mic Mute (D-pad integrated)
Feedback	Dual Rumble Motors, Impulse Triggers
Companion App	Turtle Beach Control Hub (Xbox & Windows PCs)
Product Dimensions	2.6 x 6.3 x 4.7 inches (160 x 120 x 65 mm)
Product Weight	9.92 ounces (0.28 kg)
Manufacturer	Turtle Beach

WARRANTY AND SUPPORT

For warranty information and technical support, please visit the official Turtle Beach website or contact their customer service. Keep your proof of purchase for warranty claims.

Online Support: www.turtlebeach.com/pages/support



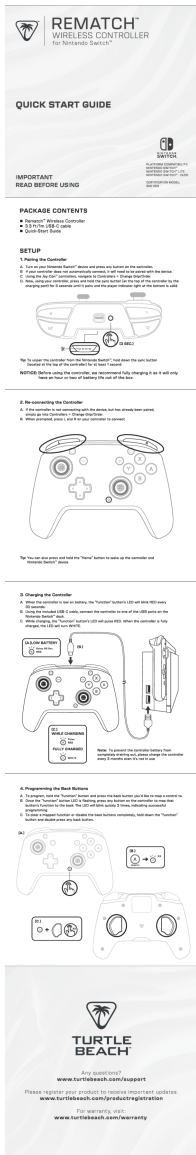

[Turtle Beach Rematch Wireless Controller for Nintendo Switch - Quick Start Guide](#)

Get started quickly with the Turtle Beach Rematch Wireless Controller for Nintendo Switch. This guide covers setup, pairing, charging, and programming back buttons for your controller.



[Turtle Beach Stealth™ Ultra Controller Product Guide](#)

Comprehensive guide to setting up and using the Turtle Beach Stealth™ Ultra wireless controller for Xbox, PC, and Android devices, covering features like Command Display, profiles, button mapping, and audio settings.

