



M100 Clip on Ear Headphones

M100 Clip on Ear Headphones User Manual

Model: M100 Clip on Ear Headphones

INTRODUCTION

Thank you for choosing the M100 Clip on Ear Headphones. These wireless earphones feature bone conduction technology, Bluetooth 5.4 connectivity, and an open-ear design for comfort and awareness. Equipped with a digital display and smart LED touch screen, they are designed for versatile use, from sports to daily activities. This manual provides essential information for setup, operation, and maintenance to ensure optimal performance and longevity of your device.



Image: The M100 Clip on Ear Headphones in purple, shown with their charging case featuring a digital display.

PACKAGE CONTENTS

- 1/2 pcs * Clip On Ear Headphones (depending on package)
- 1 * Charging Case
- 1 * User Manual
- 1 * USB Charging Cable (Type-C)

PRODUCT FEATURES

- **Smart LED Touch Screen:** Allows checking date, time, battery level, and Bluetooth connection status.
- **Unparalleled Comfort and Security:** Ergonomic design, lightweight (5.2 grams), suitable for all-day wear.
- **Clear Calls with Advanced Noise Reduction:** AI noise cancellation technology for clear conversations even in noisy

environments. Directional acoustic technology ensures sound clarity.

- **Quick Pairing with Wireless Bluetooth 5.4:** Automatic fast pairing upon opening the charging case, stable and faster connection.
- **Long-lasting Play Time:** Up to 50 hours of playback with the charging case, 6 hours on a single charge.

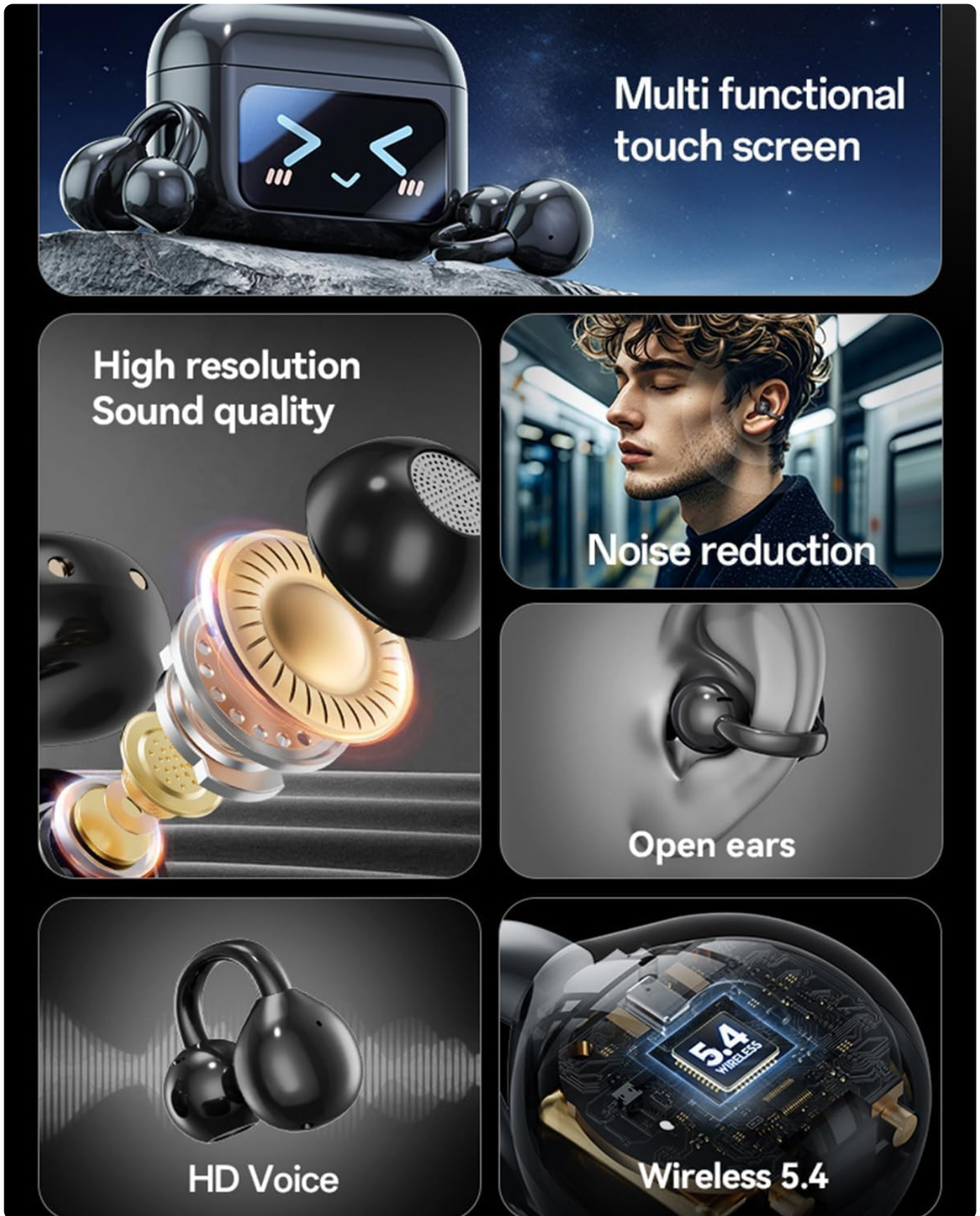

Image: Diagram illustrating key features including multi-functional touch screen, high resolution sound quality, noise reduction, open ear design, HD Voice, and Wireless 5.4 technology.

Smart Screen Touch IC

Lossless sound

Dual core 5.4

TYPE-C charge



Smart screen

Noise reduction

Image: Visual representation of the smart screen, touch IC, lossless sound, dual core 5.4, Type-C charging, Hi-Res Audio, and AI noise reduction capabilities.

SETUP

1. Initial Charging

Before first use, fully charge the M100 headphones and their charging case. Connect the provided USB Type-C cable to the charging port on the case and plug the other end into a USB power source (e.g., computer, wall adapter). The LED display on the case will indicate charging status and battery level.

2. Pairing with Your Device

1. Ensure the headphones are in the charging case and the case has sufficient power.
2. Open the charging case. The headphones will automatically enter pairing mode.
3. On your device (smartphone, tablet, computer), go to Bluetooth settings and turn Bluetooth on.

4. Search for available devices. Select "M100" from the list.

5. Once connected, the LED display on the case will show a successful Bluetooth connection status.

Note: The M100 headphones utilize Bluetooth 5.4 for a stable and fast connection.

Wireless V5.4 More stable

V5.4 chip module brings more stability

A smoother and faster transmission experience

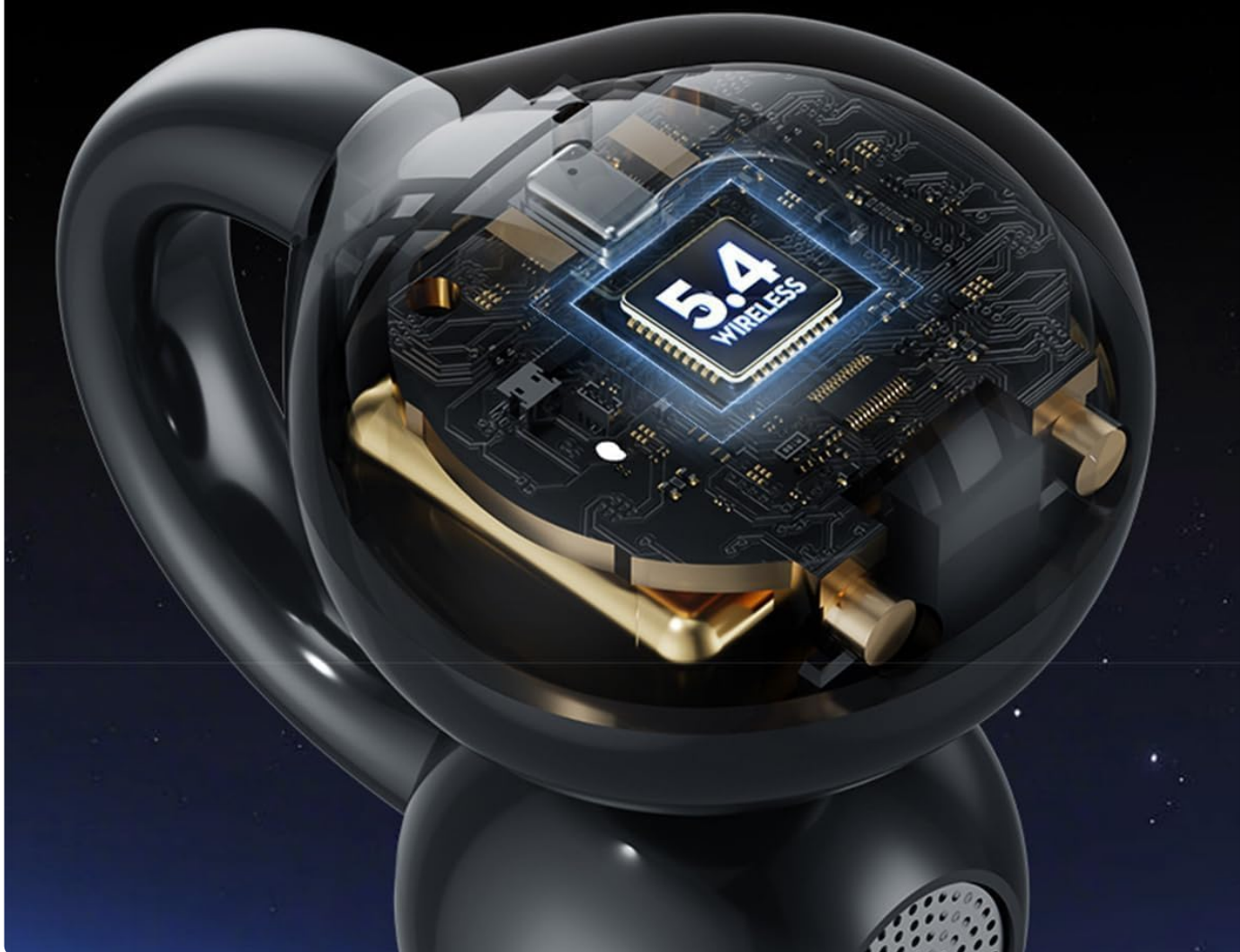

Image: Diagram highlighting the internal chip module and the benefits of Wireless V5.4 for more stable and faster transmission.

OPERATING INSTRUCTIONS

Smart LED Touch Screen Control

The M100 charging case features a full-color LCD touch screen for comprehensive control over various functions without needing to access your paired device.

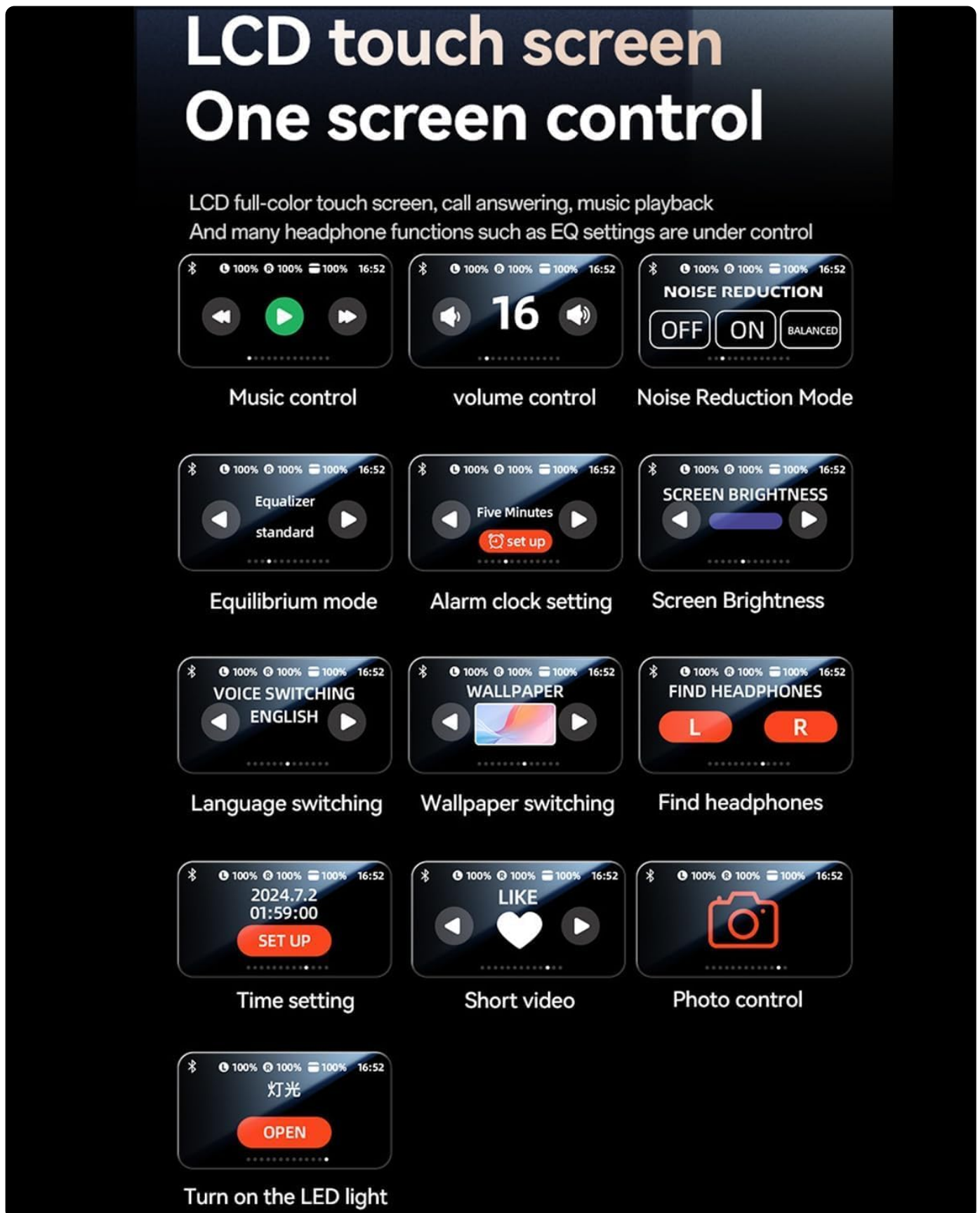

Image: Detailed view of the LCD touch screen interface, showing various control options such as music control, volume control, noise reduction mode, equalizer, alarm clock setting, screen brightness, language switching, wallpaper switching, find headphones, time setting, short video, photo control, and LED light control.

- **Music Control:** Play, pause, skip tracks directly from the screen.
- **Volume Control:** Adjust playback volume.
- **Noise Reduction Mode:** Toggle between Noise Reduction ON, OFF, or Balanced modes.
- **Equalizer:** Select different sound profiles (e.g., standard).
- **Alarm Clock Setting:** Set alarms directly from the case.
- **Screen Brightness:** Adjust the brightness of the LCD display.
- **Language Switching:** Change the display language.
- **Wallpaper Switching:** Customize the screen background.
- **Find Headphones:** Locate misplaced earbuds (L/R indicators).
- **Time Setting:** Adjust date and time displayed on the screen.
- **Short Video/Photo Control:** Control video playback or photo capture on a paired device (functionality may vary by device).
- **Turn on the LED light:** Activate the LED light feature.

Wearing the Headphones

The M100 headphones feature an open-ear clip design, providing comfort and allowing you to remain aware of your surroundings. Gently clip the headphones onto your ear, ensuring a secure yet comfortable fit. The lightweight design (5.2 grams per earbud) is suitable for extended wear.

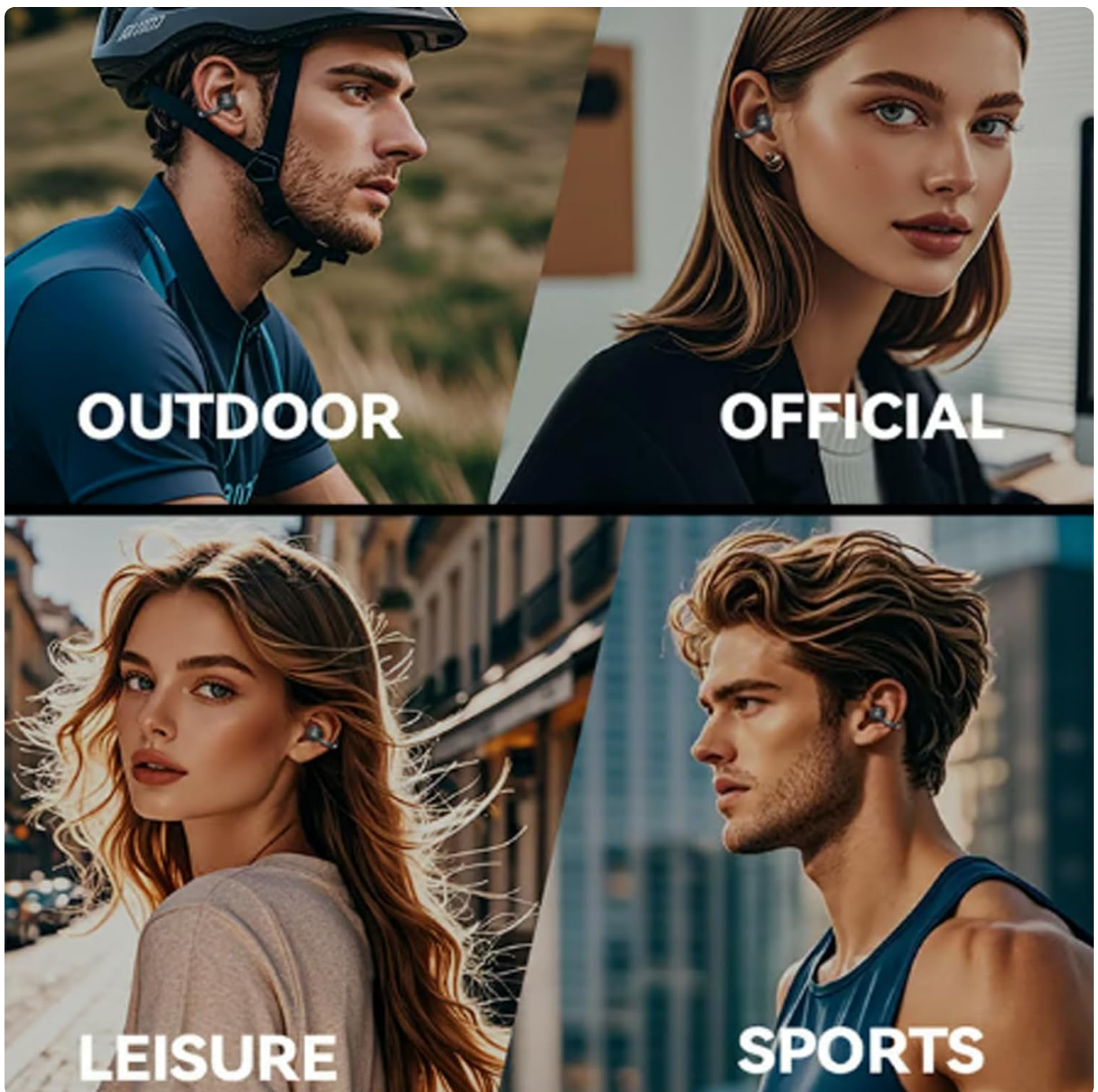

Image: Examples of M100 earbuds being worn in various scenarios: outdoor activities, official settings, leisure, and sports, demonstrating their versatile and comfortable fit.

MAINTENANCE

- **Cleaning:** Use a soft, dry, lint-free cloth to clean the headphones and charging case. Do not use abrasive cleaners, alcohol, or chemical solvents.
- **Storage:** When not in use, store the headphones in their charging case to protect them from dust and damage. Store in a cool, dry place away from direct sunlight and extreme temperatures.
- **Battery Care:** To prolong battery life, avoid fully discharging the headphones and case frequently. Charge them regularly, even if not used for extended periods.
- **Water Resistance:** The headphones are sport waterproof and sweatproof. However, they are not designed for submersion in water. Avoid exposing them to heavy rain or swimming.

TROUBLESHOOTING

Problem	Possible Cause	Solution
Headphones not pairing.	Bluetooth is off on device; headphones not in pairing mode; device too far.	Ensure Bluetooth is on. Place headphones in case, close, then open to re-enter pairing mode. Move device closer to headphones.
No sound from headphones.	Volume too low; headphones not connected; incorrect audio output selected.	Increase volume on both headphones (via touch screen) and device. Reconnect headphones. Check device's audio output settings.
Charging case not charging.	Cable not connected properly; faulty cable/charger; dirty charging port.	Ensure cable is securely connected. Try a different USB cable and power adapter. Clean charging port gently.
Intermittent connection.	Interference; device too far; low battery.	Move away from sources of interference (Wi-Fi routers, other Bluetooth devices). Keep device within 10m range. Charge headphones and case.

SPECIFICATIONS

Feature	Detail
Product Name	M100 Clip On Ear Headphones
Model Number	M100 Clip on Ear Headphones
Bluetooth Version	5.4
Transmission Range	Up to 10 meters (33 feet)
Play Time (Single Charge)	Up to 6 hours
Total Play Time (with Charging Case)	Up to 50 hours
Earbud Weight	Approx. 5.2 grams per earbud
Charging Port	USB Type-C
Display	Smart LED Touch Screen
Noise Cancellation	AI Noise Cancellation
Water Resistance	Sport Waterproof & Sweatproof

WARRANTY AND SUPPORT

For warranty information and customer support, please refer to the documentation included with your purchase or contact the retailer where you purchased the M100 Clip on Ear Headphones. Specific warranty terms and conditions may vary by region and retailer.

For further assistance or technical inquiries, please reach out to the manufacturer's customer service channels, if provided separately.

