

Tilta TBC-W235-GN

Tilta NP-W235 Portable Charging Station User Manual

Model: TBC-W235-GN

INTRODUCTION

The Tilta NP-W235 Portable Charging Station is designed for efficient charging of up to four NP-W235 batteries simultaneously. It supports USB-C Power Delivery (PD) for fast charging, offering a maximum of 45W. This station is compatible with Fujifilm, Tilta, and most third-party NP-W235 batteries, including those used in cameras such as the X-T5, X-T4, X-S20, GFX100 II, GFX100S, GFX100RF, GFX50S II, GFX50S, XH2S, and XH2. Its compact design also functions as a protective storage case for your batteries.



Image: The Tilta NP-W235 Portable Charging Station, featuring its robust green casing and transparent lid, designed to hold four batteries.

SETUP

1. **Unpack the Charging Station:** Carefully remove the charging station and the included USB-C charging cable from its packaging.
2. **Open the Lid:** Release the two latches on the sides of the charging station to open the clear lid.
3. **Insert Batteries:** Insert up to four compatible NP-W235 batteries into the designated slots. Ensure each battery clicks securely into place.
4. **Connect Power:** Connect one end of the USB-C charging cable to the USB-C port on the charging station. Connect the other end to a compatible USB-C Power Delivery (PD) charger (not included). For optimal fast charging performance, a 45W or higher PD charger and a compatible cable are required.



Image: Components of the charging station, including the main unit with four battery slots, the detachable lid, and the USB-C charging cable.

OPERATING INSTRUCTIONS

Charging Batteries

- Once batteries are inserted and the charging station is connected to a power source, charging will begin automatically.
- The station supports simultaneous charging of all four batteries.
- With a 45W PD charger, four batteries can be fully charged in approximately 3 hours.

Real-Time Indicator Lights

The charging station features real-time indicator lights for each battery slot, providing visual feedback on the charging status:

- **Red Light:** Indicates low battery (0%-30% charged).
- **Yellow Light:** Indicates medium battery (30%-90% charged).
- **Green Light:** Indicates high battery (90%-100% charged).

These lights display battery levels when inserted and automatically turn off after 5 seconds if not actively charging.

REAL-TIME INDICATOR LIGHTS

Displays battery levels when inserted, automatically turns off after 5 seconds without charging.



Image: Visual representation of the real-time indicator lights and their corresponding battery charge levels.

MAINTENANCE

- **Cleaning:** Use a soft, dry cloth to clean the exterior of the charging station. Avoid using harsh chemicals or abrasive materials.
- **Storage:** When not in use, store the charging station in a cool, dry place away from direct sunlight and extreme temperatures.
- **Battery Care:** For optimal battery health, it is recommended not to leave batteries unused in the station for more than three months without a charge cycle. The station features low power loss in sleep mode (approximately 0.1mAh natural discharge) to minimize battery drain anxiety.
- **Lid Security:** Ensure the lid is securely latched when transporting the station to protect the batteries from damage.



Image: The charging station in a natural setting, highlighting its energy management capabilities and suitability for storage.

TROUBLESHOOTING

- **Batteries Not Charging:**
 - Ensure the USB-C cable is securely connected to both the charging station and the power adapter.
 - Verify that the power adapter is functioning correctly and provides sufficient power (45W PD recommended).
 - Check if the batteries are inserted correctly into their slots.
 - Confirm that the batteries are compatible NP-W235 type.
- **Slow Charging:**
 - Ensure you are using a USB-C PD charger with a minimum output of 45W. Lower wattage chargers will result in slower charging times.
 - Use a high-quality USB-C cable that supports fast charging.
- **Indicator Lights Not Functioning:**
 - If the lights do not illuminate upon battery insertion, ensure the batteries are properly seated and have some charge.
 - If connected to power, check the power source and cable.

SPECIFICATIONS

Feature	Detail
Model Number	TBC-W235-GN
Product Dimensions	4.8 x 3.03 x 2.24 inches (12.2 x 7.7 x 5.7 cm)
Item Weight	6.1 ounces (0.17 kg)
Input Power	USB-C PD, up to 45W Max
Output Voltage	8.4 Volts
Battery Compatibility	NP-W235 (Fujifilm, Tilta, and most 3rd party)

Charging Slots	4
Material	Engineering PC+ABS plastic

WARRANTY AND SUPPORT

For warranty information and technical support, please refer to the official Tilta website or contact their customer service directly. Keep your purchase receipt as proof of purchase for any warranty claims.

Online Resources: Visit the official Tilta website for product updates, FAQs, and additional support resources.

Related Documents - TBC-W235-GN

	<p>TILTA TBC-W235 4-Channel Portable Charging Station for NP-W235 Batteries User Guide</p> <p>User guide for the TILTA TBC-W235 portable charging station, detailing its features, specifications, usage instructions, and safety precautions for charging NP-W235 camera batteries.</p>
	<p>Tilta TBC-FZ100 Portable Charging Station for NP-FZ100 Batteries - User Guide</p> <p>Comprehensive user guide for the Tilta TBC-FZ100 Portable Charging Station, detailing its features, specifications, and usage instructions for NP-FZ100 batteries.</p>
	<p>Tilta Camera Cage for RED KOMODO-X: Overview and Functions</p> <p>Comprehensive guide detailing the Tilta camera cage system for the RED KOMODO-X, including an overview of its components and a detailed breakdown of its functional features and mounting points.</p>
	<p>TILTA TBC-E6 Portable Charging Station for LP-E6 Batteries - User Manual</p> <p>User manual and guide for the TILTA TBC-E6 Portable Charging Station, compatible with LP-E6 series batteries. Features 4 channels, fast and regular charging, PD input, and battery level indicators.</p>

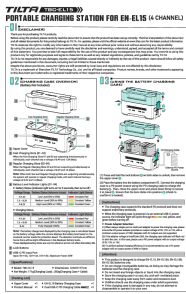

[TILTA TBC-EL15 Portable 4-Channel Battery Charging Station for EN-EL15 Batteries](#)

User manual and specifications for the TILTA TBC-EL15, a portable 4-channel charging station designed for Nikon EN-EL15 series batteries. Features fast and regular charging, PD input, and battery level indicators.

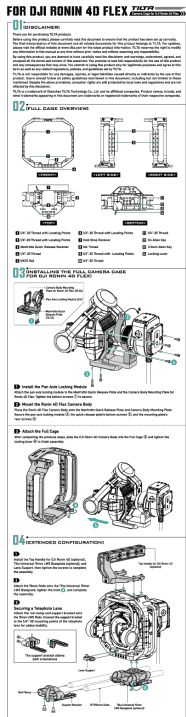

[DJI Ronin 4D Flex Camera Cage Installation and Configuration Guide](#)

A comprehensive guide to installing and configuring the Tilta Camera Cage for the DJI Ronin 4D Flex, including component overviews and extended setup options.