

[Manuals.plus](#) /

› [Chofit](#) /

› Chofit Smartwatch Charger Cable User Manual

Chofit Charger Cable Dock for Amazfit Bip 6 / Active 2

Chofit Smartwatch Charger Cable User Manual

Model: Charger Cable Dock for Amazfit Bip 6 / Active 2

1. PRODUCT OVERVIEW

This user manual provides instructions for the Chofit Smartwatch Charger Cable, designed for Amazfit Active 2 (A2437), Active 2 Square (A2434), and Bip 6 (A2435) smartwatches. This package includes two high-quality USB charger cables, engineered for stable, safe, and efficient charging.



This image displays the two Chofit smartwatch charger cables included in the package. Each cable features a standard USB-A connector on one end and a round magnetic charging dock on the other, designed for convenient and stable connection to your smartwatch.

Key Features:

- **Compatibility:** Specifically designed for Amazfit Active 2 (A2437), Active 2 Square (A2434), and Bip 6 (A2435) smartwatches.
- **Magnetic Connection:** Features a strong magnetic design for easy and stable attachment to your smartwatch.
- **Safety Protections:** Built-in overvoltage regulator, short circuit protection, and overcurrent protection ensure safe charging.
- **Durable Construction:** Made with high-quality materials, including a reinforced cable joint, gold-plated POGO pins, and flexible PVC cable for longevity.
- **Portable Design:** Compact and lightweight, ideal for use at home, office, or while traveling.

2. SETUP

Setting up your Chofit Smartwatch Charger Cable is straightforward. Follow these steps to begin charging your device.

2.1 Connecting the Charger

1. Identify the charging port on your Amazfit smartwatch.
2. Align the magnetic charging dock of the Chofit cable with the charging contacts on your smartwatch. The magnetic force will help the dock snap into place securely.
3. Connect the USB-A end of the charger cable to a compatible power source.

STRONG MAGNETIC ADSORPTION

Provides Stable Charging for Your Watch
and Universal to USB-C interface



This image demonstrates the strong magnetic adsorption feature of the charger. The magnetic force ensures the charging cable easily snaps onto your smartwatch, providing a stable and secure connection for efficient power transfer.

2.2 Compatible Power Sources

The Chofit charger cable is designed to be versatile and can be connected to various USB-enabled power sources:

- Computer USB ports (desktop or laptop)
- Power banks
- USB wall adapters (AC chargers)

- Car USB ports or car chargers

USB C Detachable Conversion Head

plug the USB part USB-enabled devices



Laptop



power bank



computer



car charger



This image illustrates the versatility of the Chofit charger. It can be conveniently plugged into various USB-enabled devices for charging, including laptops, power banks, desktop computers, and car chargers, offering flexible charging options.

3. OPERATING INSTRUCTIONS

Once connected, your smartwatch will begin charging automatically. Observe the charging indicator on your smartwatch screen.

3.1 Important Charging Notice:

- **Power Adapter Usage:** Do not use power adapters with an output above 5V/1A. Using higher voltage/current adapters may damage your device.
- **Recommended Charging Method:** For optimal safety and stability, it is highly recommended to charge your smartwatch using a computer's USB port, a laptop, or a power bank. These sources typically provide a more stable current.

SAFE CHARGING SYSTEM



**Short- Circuit
Protection**



**Over-Voltage
Protection**



**Over Current
Protection**



**Over-Charge
Protection**



This diagram illustrates the comprehensive safety features integrated into the Chofit charger. It includes protections against short-circuit, over-voltage, over-current, and over-charge, ensuring the safety of your smartwatch during the charging process.

4. MAINTENANCE

Proper care and maintenance will extend the lifespan of your Chofit Smartwatch Charger Cable.

4.1 General Care:

- Keep the charging contacts clean and free from dust or debris.
- Avoid bending the cable sharply, especially near the connectors, to prevent internal wire damage.
- Store the cable in a cool, dry place when not in use. The flexible PVC cable is designed for easy rolling and convenient storage.
- Do not expose the charger to extreme temperatures or direct sunlight for prolonged periods.

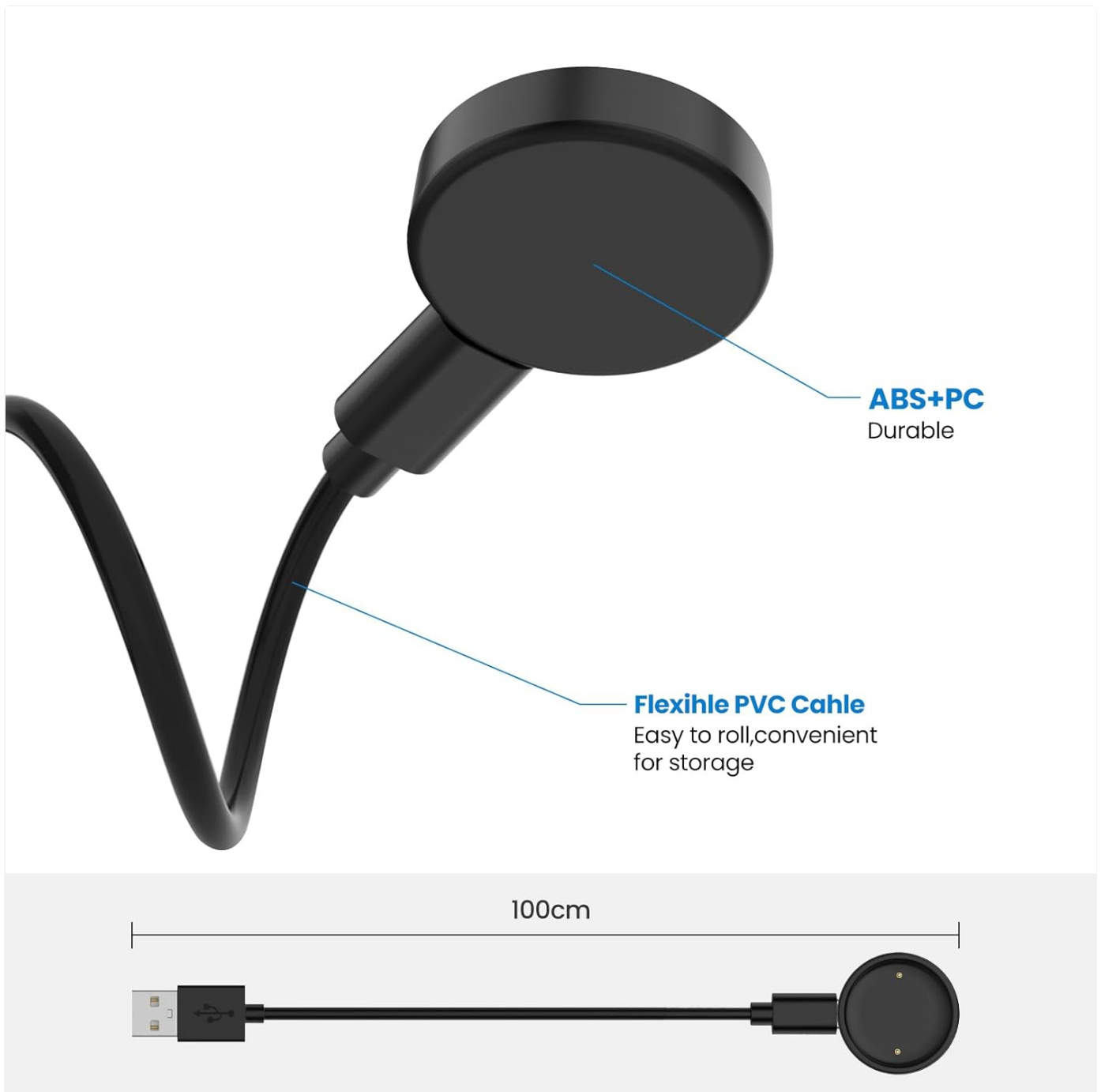

This diagram details the materials and dimensions of the Chofit charger. The charging dock is constructed from durable ABS+PC material, while the cable is made from flexible PVC, making it easy to roll and convenient for storage. The total cable length is approximately 100cm (3.3 feet).

4.2 Durability Features:

The Chofit charger is built with durability in mind:

- **Reinforced Cable Joint:** Designed to withstand repeated bending and reduce wear and tear.
- **Gold-Plated POGO Pins:** Provide corrosion resistance and reliable electrical contact.
- **High-Grade TPE Material:** Used for the protective plug, offering high toughness and durability.



REINFORCED CABLE JOINT

High toughness and durability

Longer lifespan

10000+



Gold-Plated POGO Pins



**High-grade TPE material
Solid Protective Plug**

Detail view highlighting the robust construction of the charger. It features a reinforced cable joint for enhanced durability, gold-plated POGO pins on the charging dock for reliable contact, and is made with high-grade TPE material for the solid protective plug, ensuring a longer lifespan of over 10,000 bends.

5. TROUBLESHOOTING

If you encounter issues while using your Chofit Smartwatch Charger Cable, refer to the following common problems and solutions:

Problem	Possible Cause / Solution
Smartwatch not charging.	<ul style="list-style-type: none">• Ensure the magnetic dock is securely attached to the smartwatch's charging contacts.• Verify the USB-A connector is fully inserted into the power source.• Try a different USB port or power source (e.g., another computer USB port, a different power bank).• Check if the smartwatch's charging contacts or the charger's POGO pins are clean.

Problem	Possible Cause / Solution
Charging is slow or inconsistent.	<ul style="list-style-type: none"> • Ensure the power source provides stable current (computer USB port is recommended). • Avoid using power adapters above 5V/1A, as this can sometimes trigger protection mechanisms or cause instability. • Disconnect and reconnect the charger to both the smartwatch and the power source.
Charger cable appears damaged.	<ul style="list-style-type: none"> • Inspect the cable for visible signs of fraying, cuts, or severe bends. • If damaged, discontinue use and replace the cable to prevent potential hazards.

6. SPECIFICATIONS

Feature	Detail
Brand	Chofit
Compatible Devices	Amazfit Active 2 (A2437), Amazfit Active 2 Square (A2434), Amazfit Bip 6 (A2435)
Connectivity Technology	USB
Connector Type	USB Type A (for power source)
Cable Length	Approx. 100 cm (3.3 feet)
Color	Black
Number of Items	2 (charger cables)
Special Feature	Shock-resistant, Magnetic Connection, Overvoltage Protection, Short Circuit Protection, Overcurrent Protection
Package Dimensions	4.69 x 4.06 x 1.14 inches
Item Weight	0.63 ounces
Manufacturer	Chofit

7. WARRANTY AND SUPPORT

For information regarding product warranty or technical support, please contact the manufacturer, Chofit, directly through their official channels or the retailer from whom the product was purchased.

Please retain your purchase receipt as proof of purchase for any warranty claims.



