

GREATEN AP 300 Pro

GREATEN AP 300 Pro Electronic Wind Instrument User Manual

Model: AP 300 Pro

1. INTRODUCTION

The GREATEN AP 300 Pro is an advanced electronic wind instrument designed for musicians seeking versatility and high-quality sound. It features a built-in LCD display, OTG recording capabilities, 108 global tones, and dual-mode Bluetooth connectivity for both audio and MIDI. Its intuitive design and multiple fingering options make it accessible for players with varying levels of experience.



Figure 1.1: The GREATEN AP 300 Pro Electronic Wind Instrument in use, showcasing its compact design and integrated features.

This manual provides comprehensive instructions for setting up, operating, maintaining, and troubleshooting your AP 300 Pro to ensure optimal performance and longevity.

2. WHAT'S IN THE BOX

Upon unboxing your AP 300 Pro, please verify that all the following components are present:

- AP 300 Pro EWI Instrument
- USB Cable
- Mouthpiece Cap
- Spare Mouthpiece
- Carrying Case
- Neck Strap

- Screwdriver
- User Manual (this document)



WHAT'S IN THE BOX

- AP 300 Pro EWI Instrument
- USB Cable
- Mouthpiece Cap
- Spare Mouthpiece
- Carrying Case
- Neck Strap
- Screwdriver
- User Manual



TWO MODES BLUETOOTH:
BLUETOOTH AUDIO/BLUETOOTH MIDI

Figure 2.1: Illustration of the items included with your AP 300 Pro Electronic Wind Instrument.

3. SETUP

3.1 Initial Charging

Before first use, fully charge the AP 300 Pro. Connect the provided USB cable to the instrument's USB port and the other end to a compatible USB power adapter (not included) or a computer's USB port. The LCD display will indicate charging status. A full charge provides up to 6 hours of use.

3.2 Attaching the Neck Strap

Attach the neck strap to the thumb hook on the back of the instrument for comfortable and secure playing. Ensure the strap is adjusted to a comfortable length.

3.3 Adjusting Thumb Hook and Key Positions

The AP 300 Pro features adjustable components for ergonomic comfort:

- **Thumb Hook:** The thumb hook can be moved up or down to suit your hand size and playing style. Use the provided screwdriver for adjustment.
- **Reversible Thumb Controller:** The thumb controller can be reversed for left-handed or right-handed players.
- **Adjustable Key Positions:** Certain key positions can be adjusted to optimize comfort and playability. Refer to the detailed diagram in Section 4.1 for specific adjustable keys.

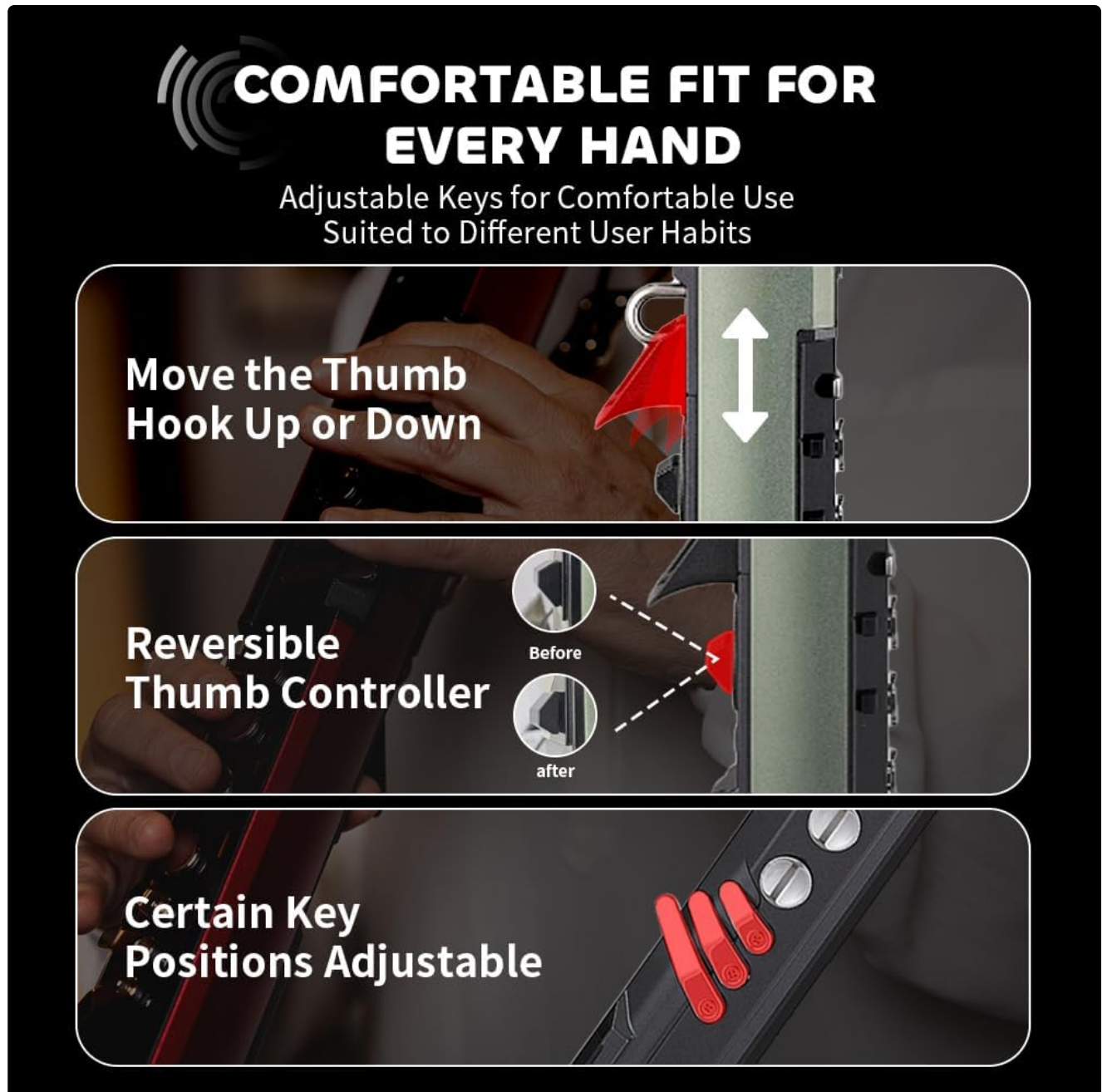

Figure 3.1: Customizing the AP 300 Pro for a comfortable playing experience.

4. OPERATING INSTRUCTIONS

4.1 Panel Descriptions and Controls

Familiarize yourself with the various controls and ports on your AP 300 Pro:

PANEL DESCRIPTIONS

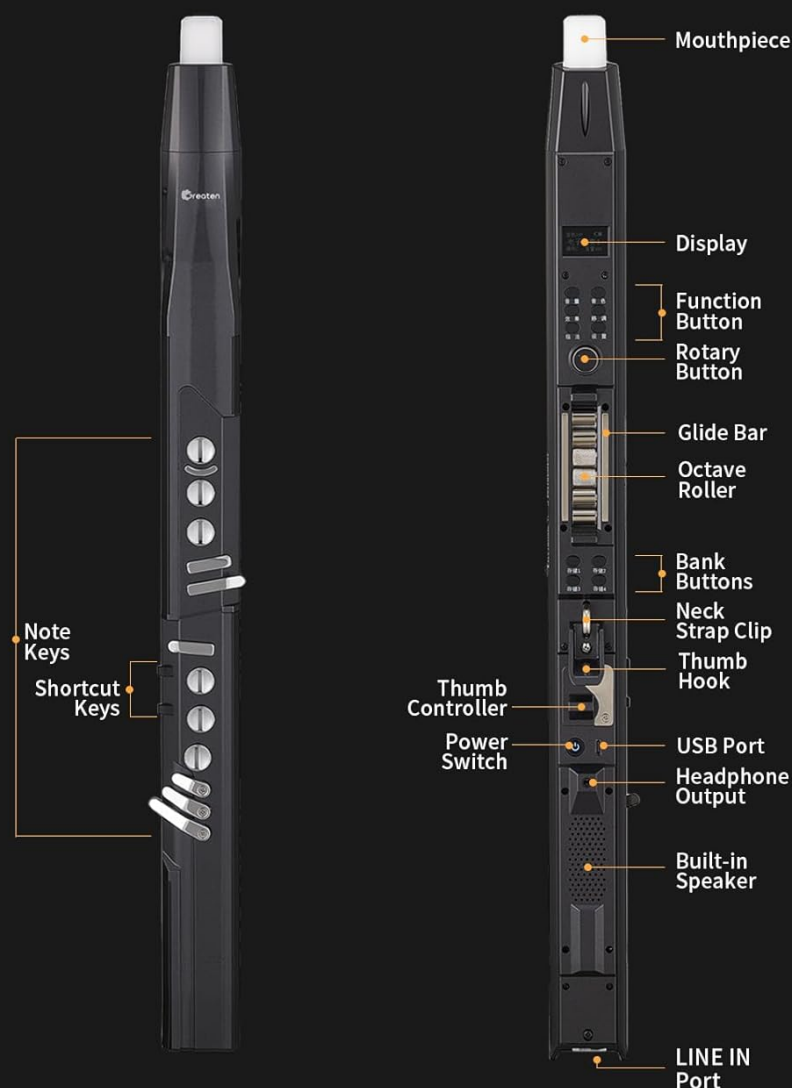

Figure 4.1: Front and side views of the AP 300 Pro with all controls and ports labeled.

- **Mouthpiece:** Food-grade silicone mouthpiece with a built-in sensor.
- **Display:** LCD screen showing selected parameters, tones, volume, and key settings.
- **Function Button:** Used to access menus and settings.
- **Rotary Button:** For navigating menus and adjusting values.
- **Glide Bar:** Allows for portamento effects by sliding your finger.
- **Octave Roller:** Easily switch between octaves.
- **Bank Buttons (1-4):** Store and recall up to four independent tone libraries/settings.
- **Thumb Controller:** Used for pitch bends and other expressive controls.
- **Power Switch:** Turns the instrument on/off.
- **USB Port:** For charging and OTG recording.
- **Headphone Output:** For silent practice.
- **Built-in Speaker:** For direct sound output.
- **LINE IN Port:** For connecting external audio sources.
- **Note Keys & Shortcut Keys:** Touch-sensitive keys for playing notes and accessing quick functions.

4.2 Powering On/Off

To power on the instrument, slide the Power Switch to the "ON" position. To power off, slide it to the "OFF" position.

4.3 Playing the Instrument

The AP 300 Pro features touch-sensitive keys and a built-in mouthpiece sensor. Simply blow into the mouthpiece and press the note keys to produce sound. The sensitivity of the mouthpiece sensor is adjustable via the settings menu.

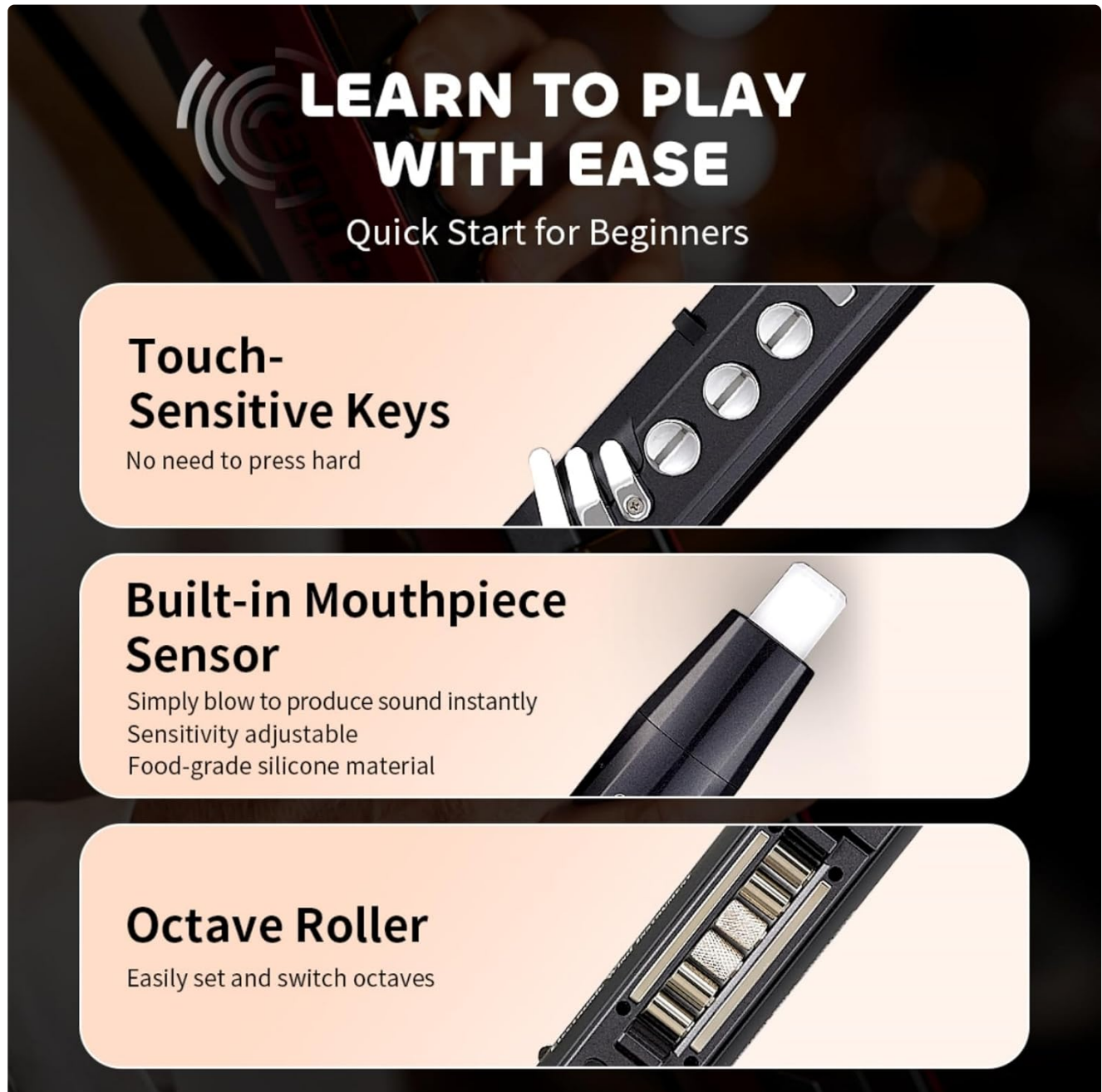

Figure 4.2: Key features for ease of play: touch-sensitive keys, mouthpiece sensor, and octave roller.

4.3.1 Fingering Options

The instrument supports 8 different fingering options, allowing users familiar with various wind instruments (e.g., standard, saxophone, flute, oboe, trumpet) to adapt quickly without extensive relearning.

NUMEROUS SOUNDS ONE INSTRUMENT

Learn One Fingering
Unlock Multiple Instruments

Multiple Fingering Options

Standard, Saxophone, Flute, Oboe, Trumpet

Figure 4.3: The AP 300 Pro offers multiple fingering options to accommodate various playing styles.

4.3.2 Octave Control

Use the Octave Roller to easily shift the instrument's pitch up or down by octaves.

4.3.3 Expressive Techniques

- **Portamento:** Slide your finger along the Glide Bar to achieve smooth pitch transitions between notes.



Figure 4.4: Using the Glide Bar for Portamento.

- **Pitch Bends:** Utilize the Thumb Controller to bend notes up or down, adding expressive nuances to your playing.



Figure 4.5: Using the Thumb Controller for Pitch Bends.

- **Vibrato:** Choose from three vibrato modes with adjustable sensitivity. This can be achieved through semi-auto (blow and hold a bite), full-auto (just blow), or by repeatedly biting the mouthpiece.



Figure 4.6: Vibrato techniques.

4.4 Sound and Settings Management

4.4.1 LCD Display Navigation

The LCD display provides a clear view of selected parameters such as chosen tones, remaining volume, and key settings. Use the Function and Rotary buttons to navigate through menus and adjust settings.

Clear LCD Display

Intuitive and comprehensive parameter visualization



Fast selection for saved Parameters

Save and retrieve up to 4 custom settings

Figure 4.7: The LCD display and bank buttons for quick access to settings.

4.4.2 Tone Selection

The AP 300 Pro offers 108 global tones. Navigate through the tone library using the Rotary button and select your desired instrument sound.

4.4.3 Saving Custom Settings (Bank Buttons)

The instrument allows for four independent tone libraries. Use the Bank Buttons (1-4) to store and quickly recall your preferred settings, including tones, fingerings, and effects.



Figure 4.8: Saving and recalling customized settings using the Bank Buttons.

4.5 Connectivity

4.5.1 Bluetooth Connectivity

The AP 300 Pro supports dual-mode Bluetooth for both audio and MIDI:

- **Bluetooth Audio:** Connect your phone or tablet to play backing tracks and perform along with seamless, zero-latency audio.
- **Bluetooth MIDI:** Allows wireless MIDI connections for expanded creative possibilities, such as controlling software instruments or recording MIDI data.

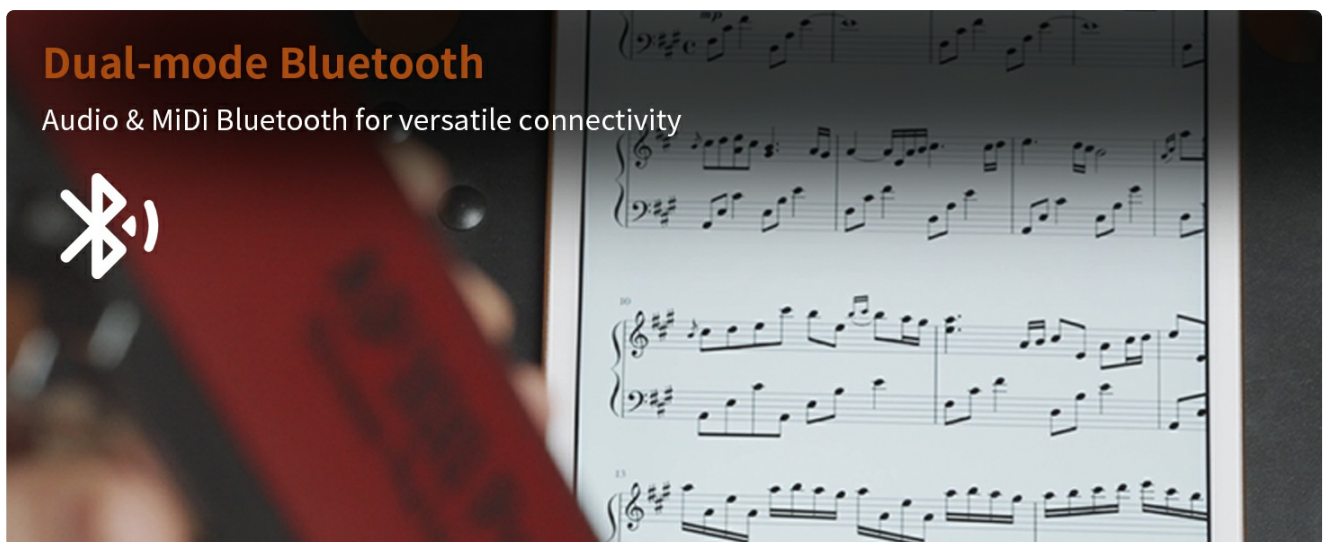

Figure 4.9: Dual-mode Bluetooth for versatile connectivity.

4.5.2 OTG Recording

The built-in OTG recording function allows for high-quality recording directly to a connected device (e.g., smartphone, tablet) via the USB port. This prevents external noise interference, ensuring clear captured sound.



Figure 4.10: Effortless recording with built-in OTG functionality.

4.5.3 Headphone and Amplifier Connection

For silent practice, connect headphones to the headphone output jack. To amplify your sound, connect the instrument to an external amplifier via the LINE IN port.

PRACTICE ANYTIME ANYWHERE

Suitable for Indoor and Outdoor Practice
Day or Night



Figure 4.11: Practice options: built-in speaker, headphone connection, and amplifier connectivity.

5. MAINTENANCE

5.1 Cleaning

- **Mouthpiece:** The mouthpiece can be removed for cleaning. Wash with mild soap and water, rinse thoroughly, and allow to air dry completely before reattaching.
- **Instrument Body:** Wipe the instrument's body with a soft, dry cloth. Avoid using abrasive cleaners or solvents, which may damage the finish.

5.2 Storage

When not in use, store the AP 300 Pro in its provided carrying case to protect it from dust, moisture, and physical damage. Store in a cool, dry place away from direct sunlight and extreme temperatures.

5.3 Battery Care

To prolong battery life, avoid fully discharging the battery frequently. If storing the instrument for an extended period, charge it to approximately 50% every few months.

6. TROUBLESHOOTING

This section addresses common issues you might encounter with your AP 300 Pro. If the problem persists, please contact GREATEN customer support.

Problem	Possible Cause	Solution
Instrument does not power on.	Low battery; Power switch in OFF position.	Charge the instrument fully. Ensure the power switch is set to ON.
No sound output.	Volume too low; Incorrect tone selected; Headphone connected; Speaker muted.	Increase volume. Select a valid tone. Disconnect headphones if using speaker. Check speaker settings.
Bluetooth connection issues.	Instrument not in pairing mode; Device out of range; Interference.	Ensure instrument is in Bluetooth pairing mode. Move device closer. Reduce interference from other wireless devices.
OTG recording has noise.	External noise interference.	Ensure recording environment is quiet. Verify USB connection is secure.
Difficulty with staccato notes.	Breath sensor sensitivity; Playing technique.	Adjust breath sensor sensitivity in settings. Practice tonguing techniques. Ensure proper mouthpiece embouchure.

7. SPECIFICATIONS

Feature	Detail
Model Number	AP 300 Pro
Dimensions	25.4 x 2.36 x 2.36 inches (645mm x 60mm x 60mm)
Weight	1.79 pounds (810g)
Body Material	Aluminum, Plastic, Copper
Color	Golden (as per current model)
Tones	108 Global Tones
Battery Capacity	6000mAh

Feature	Detail
Battery Life	Up to 6 hours
Connectivity	Dual-Mode Bluetooth (Audio & MIDI), USB (OTG Recording)
Display	LCD Screen
Fingering Options	8 different fingerings (Standard, Saxophone, Flute, Oboe, Trumpet, etc.)

8. WARRANTY AND SUPPORT

For warranty information, technical support, or any inquiries regarding your GREATEN AP 300 Pro, please contact GREATEN customer service. Refer to the contact information provided with your purchase or visit the official GREATEN website.

GREATEN is committed to providing high-quality products and excellent customer service. If you experience any issues not covered in this manual, our support team is available to assist you.

You may also find additional resources and FAQs on the [GREATEN Store on Amazon](#).

Related Documents

<div><div>AP300 PRO</div><div>User Guide</div><div>English</div><div>@reaten</div></div>	<div>Greaten AP300 Pro Electronic Wind Instrument User Guide</div> <div>Comprehensive user guide for the Greaten AP300 Pro Electronic Wind Instrument, covering setup, operation, features, and specifications. Learn to play, connect, and customize your musical experience.</div>
<div><div>AP300</div><div>User Guide</div><div>English</div><div>@reaten</div></div>	<div>Greaten AP300 Electronic Wind Instrument User Guide</div> <div>Comprehensive user guide for the Greaten AP300 Electronic Wind Instrument, covering setup, operation, features, and specifications. Learn how to play, connect, and customize your AP300.</div>