

[Manuals.plus](#) /

› [Active Pixel](#) /

› Active Pixel 4MP 4G Dual Lens PTZ Outdoor Security Camera G9 User Manual

Active Pixel G9

Active Pixel 4MP 4G Dual Lens PTZ Outdoor Security Camera G9 User Manual

Model: G9 (AP-4G-SG4.0MP-DUAL CAM-PRO-G9)

1. INTRODUCTION

This manual provides detailed instructions for the installation, operation, and maintenance of your Active Pixel 4MP 4G Dual Lens PTZ Outdoor Security Camera, Model G9. This camera is designed for outdoor surveillance, offering 4MP resolution, 10X optical zoom, dual lenses, 4G LTE connectivity, Pan-Tilt-Zoom (PTZ) functionality, PIR motion detection, and color night vision. It is built to withstand outdoor conditions with an IP66 waterproof rating.

VIVID AND CLEAR PICTURE DETAILS

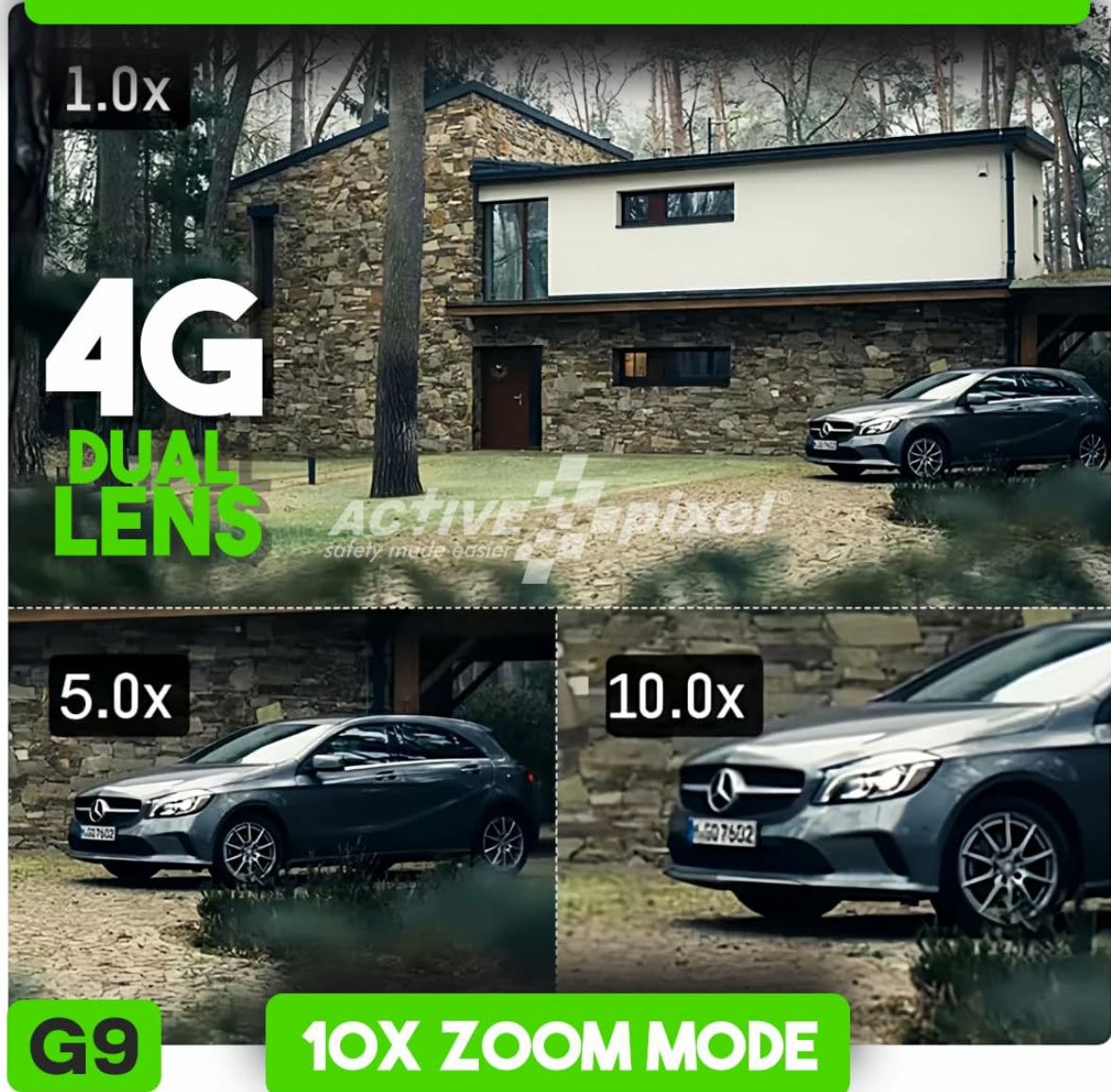

Image: Overview of the Active Pixel G9 4G Dual Lens PTZ Outdoor Security Camera.

2. PACKAGE CONTENTS

Before proceeding with installation, please verify that all components are present in the package:

- 1 x Active Pixel G9 Camera
- 1 x Solar Panel (if included in your specific kit)
- 1 x Panel Bracket
- 1 x User Manual (this document)
- Mounting Screws and Wall Plugs
- Power Adapter (if applicable)

3. SETUP GUIDE

3.1 SIM Card and SD Card Installation

1. **Power Off:** Ensure the camera is powered off before inserting or removing cards.
2. **Locate Slots:** Identify the SIM card slot and Micro SD card slot, typically found under a protective cover on the camera body.
3. **Insert SIM Card:** Insert a 4G LTE SIM card (supports VI and Airtel SIMs in India) into the designated slot with the correct orientation. Ensure it clicks into place.
4. **Insert Micro SD Card:** Insert a Micro SD card (up to 128GB, not included) into its slot for local storage of recordings.
5. **Secure Cover:** Replace the protective cover firmly to maintain the IP66 waterproof rating.

3.2 Power Connection

Connect the camera to a power source using the provided power adapter. If using a solar panel, connect it to the camera's power input. Ensure the connection is secure and protected from weather elements.

3.3 App Installation and Initial Pairing

To access and control your camera, download the dedicated mobile application. Search for "ACTIVE PIXEL 4G APP" in your smartphone's app store (Google Play Store for Android or Apple App Store for iOS).

1. **Download App:** Install the "ACTIVE PIXEL 4G APP" on your mobile device.
2. **Register Account:** Open the app and follow the on-screen instructions to register a new user account or log in if you already have one.
3. **Add Device:** Tap the "Add Device" or "+" icon within the app.
4. **Scan QR Code:** Scan the QR code located on your camera or its packaging.
5. **Follow Prompts:** Follow any additional prompts in the app to complete the pairing process. The camera should connect to the 4G network automatically once the SIM card is active.



Image: Illustration of connecting the Active Pixel G9 camera to the mobile application.

3.4 Mounting the Camera

Choose a suitable outdoor location for mounting, ensuring a clear field of view and good 4G signal reception. Use the provided mounting screws and bracket to securely attach the camera to a wall or ceiling. The camera supports ceiling mount installation.

ACTIVE pixel[®]
safety made easier

G9



Full HD



4G



IP66



Auto
Tracking



Remote
Viewing



Real-time
Alert



Dual Lens
3-Screen



Two-Way
Audio



IR/Color
Night Vision



SD Card
Slot

Image: Overview of the Active Pixel G9 camera highlighting its features and design.

4. OPERATING INSTRUCTIONS

4.1 Live View and PTZ Control

Open the Active Pixel 4G App and select your camera to view the live feed. Use the on-screen controls to:

- **Pan (355°):** Rotate the camera horizontally.
- **Tilt (90°):** Adjust the camera vertically.
- **Zoom (10X):** Utilize the 10X dual lens zoom feature to magnify specific areas of interest.

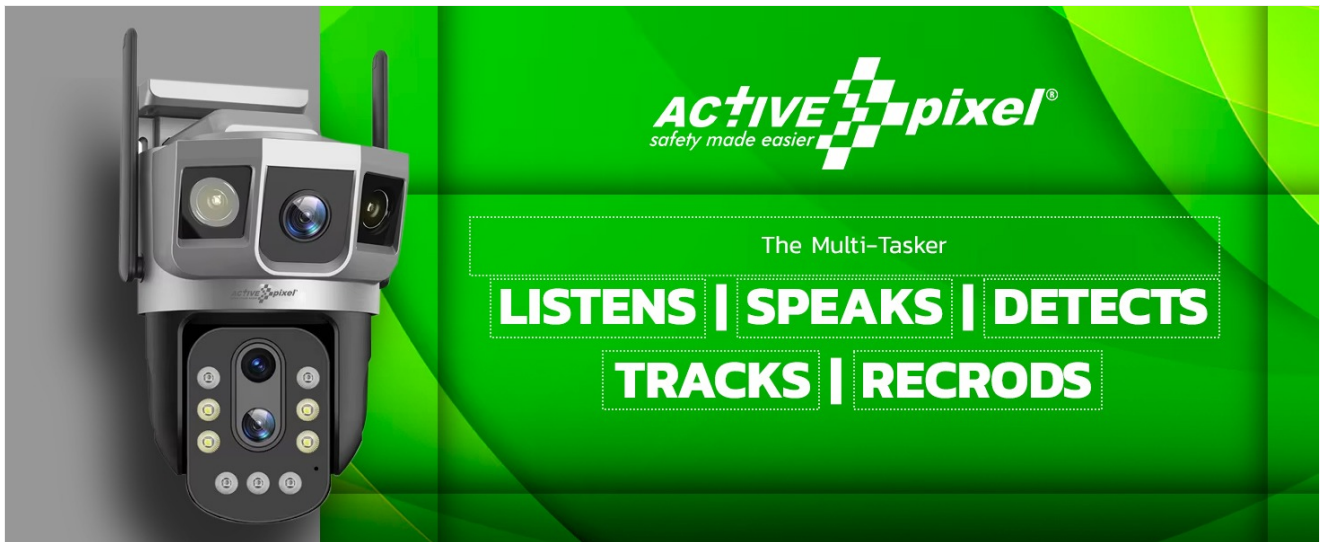

Image: Demonstrates the 10X zoom capability of the Active Pixel G9 camera, showing clear picture details at various zoom levels.

4.2 Dual Lens Functionality

The camera features dual lenses, providing a comprehensive view. The app allows for dual screen preview, ensuring clear and delicate image quality from each frame.

G9



Dual Lens

Dual Screen Preview

The color of the picture is full and the quality of each frame is clear and delicate.

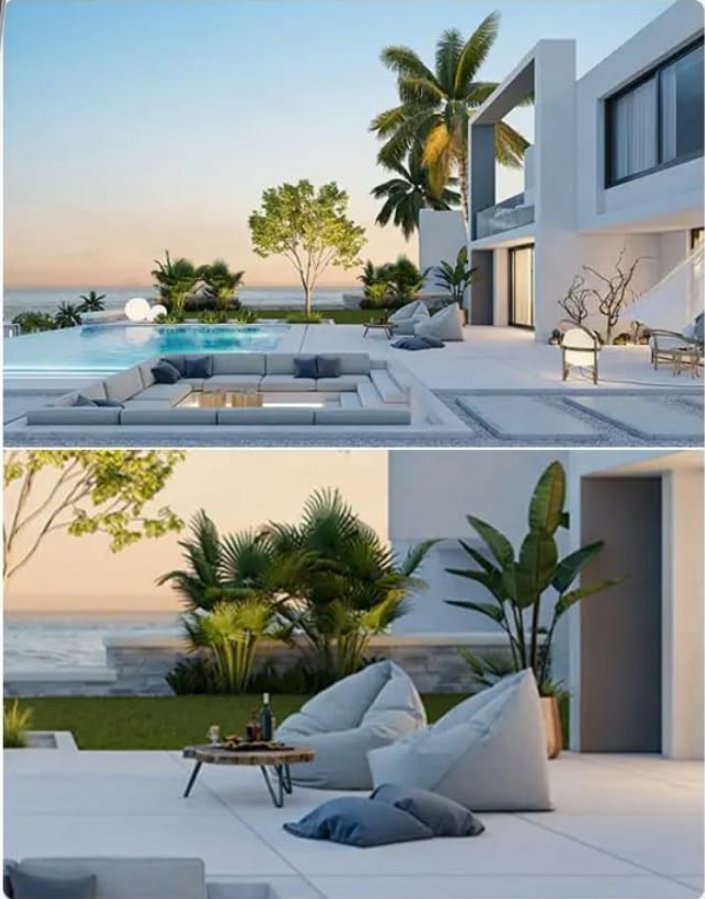

Image: Illustrates the dual lens capability of the Active Pixel G9, showing two distinct views simultaneously.

4.3 Motion Detection and Alerts

The camera is equipped with an updated PIR motion sensor and AI algorithms for smart human/animal detection. When motion is detected, the camera can:

- Send push notifications to your mobile app.
- Initiate automatic tracking of the detected subject.
- Begin recording footage to the SD card or cloud storage.

AI HUMANOID DETECTION

The cam supports humanoid detection and push alerts to APP



Image: Depicts the AI Humanoid Detection feature of the Active Pixel G9, showing a detected person and a notification on a smartphone.

4.4 Night Vision

The camera provides color night vision, ensuring clear surveillance even in low-light conditions.

4.5 Two-Way Talk

Utilize the built-in speaker and microphone for two-way audio communication through the app.

4.6 Data Storage

Recordings can be stored in two ways:

- **Local SD Card:** Supports up to 128GB Micro SD card (not included).
- **Cloud Service:** Optional cloud storage for remote access and backup (subscription may be required).

5. MAINTENANCE

5.1 Cleaning

Periodically clean the camera lens and housing with a soft, damp cloth to remove dust and dirt. Avoid using harsh chemicals or abrasive materials that could damage the lens or finish.

5.2 Weather Protection

The camera has an IP66 waterproof rating, making it suitable for outdoor use. However, ensure all cable connections are properly sealed and protected from direct exposure to heavy rain or extreme weather conditions to prevent water ingress.

5.3 SD Card Management

If using an SD card for storage, regularly check its capacity through the app. Format the SD card periodically to maintain optimal recording performance and prevent data corruption. Back up important footage before formatting.

6. TROUBLESHOOTING

Problem	Possible Cause	Solution
Camera not powering on	No power supply; Faulty adapter/cable	Check power connections; Test with another power source/adaptor.
No 4G network connection	SIM card not inserted correctly; SIM card not activated; Poor 4G signal	Reinsert SIM card; Contact your service provider to activate SIM; Relocate camera to an area with better signal.
Live view disconnects frequently	Weak 4G signal; Network congestion; App issues	Ensure strong 4G signal; Try viewing at a different time; Update the app to the latest version.
Image quality is poor/inverted	Lens obstruction; Incorrect camera orientation setting	Clean the lens; Check camera settings in the app for image rotation/flip options.
Motion detection not working	PIR sensor blocked; Sensitivity settings too low; Detection zone not configured	Ensure clear view for PIR sensor; Adjust motion detection sensitivity in app; Configure detection zones.
SD card not recording	SD card full; SD card faulty; Incorrect recording settings	Format or replace SD card; Check recording schedule and settings in the app.

7. SPECIFICATIONS

Feature	Detail
Model Name	G9
Item Model Number	AP-4G-SG4.0MP-DUAL CAM-PRO-G9
Video Capture Resolution	1440p (4MP)
Zoom	10X Dual Lens Zoom

Feature	Detail
Pan/Tilt Range	355° Pan, 90° Tilt
Connectivity	4G LTE (Supports VI and Airtel SIM)
Night Vision	Color Night Vision
Motion Detection	PIR Motion Sensor, AI Human/Animal Detection
Two-Way Audio	Yes
Storage	Micro SD Card (up to 128GB, not included), Cloud Service
Waterproof Rating	IP66
Power Source	Corded Electric
Item Weight	55 Grams
Product Dimensions	13 x 4 x 3.7 cm

8. WARRANTY AND SUPPORT

For warranty information and technical support, please contact the manufacturer directly.

- **Manufacturer:** Glorious Digital Solution Pvt Ltd, Mumbai, India
- **Customer Care:** [9321367328](tel:9321367328)