

Topeak E-Booster Digital (TDP-E01)

Topeak E-Booster Digital Electric Mini Pump

INSTRUCTION MANUAL

Introduction

Thank you for choosing the Topeak E-Booster Digital Electric Mini Pump. This portable inflator is designed for convenient and precise tire inflation, featuring a digital gauge, SmartHead valve compatibility, and USB-C recharging. Please read this manual thoroughly before use to ensure proper operation and maintenance.

Package Contents

Verify that all items are present in your package:

- Topeak E-Booster Digital Electric Mini Pump
- Extension Hose (for TPU valves)
- Silicone Protective Sleeve
- Storage Bag
- USB-C Charging Cable

Component Identification

Familiarize yourself with the main components of your E-Booster pump:



Figure 1: Front View of the E-Booster Pump. This image displays the main body of the Topeak E-Booster pump, showing the digital display, power button, and plus/minus buttons for pressure adjustment. The Topeak logo is visible on the side.

- **Digital Display:** Shows current pressure, target pressure, and battery level.
- **Power Button:** Turns the pump on/off.
- **+/- Buttons:** Adjust target pressure.
- **SmartHead Valve:** Integrated valve head for Presta and Schrader.
- **USB-C Port:** For charging the internal battery.



Figure 2: Top View of the E-Booster Pump. This image shows the top of the pump, highlighting the SmartHead valve mechanism with a slider to switch between Presta and Schrader modes.



Figure 3: E-Booster Pump with Extension Hose. This image illustrates the pump with the included extension hose connected, which is useful for accessing hard-to-reach valves or protecting sensitive TPU valves.

Setup

1. Initial Charging

Before first use, fully charge the E-Booster pump. Connect the supplied USB-C cable to the pump's USB-C port and to a standard USB power adapter (not included). The battery indicator on the digital display will show charging progress. A full charge takes approximately 45 minutes.

2. Attaching Silicone Sleeve

For added protection and grip, slide the included silicone protective sleeve onto the pump body.

Operating Instructions

1. Power On/Off

- Press and hold the Power button for 2 seconds to turn the pump on.
- Press and hold the Power button for 2 seconds to turn the pump off. The pump will automatically shut off after a period of inactivity.

2. Selecting Valve Type (SmartHead)

The SmartHead valve automatically adapts to Presta or Schrader valves. For Presta valves, ensure the valve core is unscrewed before attaching the pump head. For Schrader valves, simply attach the pump head directly.



Figure 4: Pump in Use with Digital Display. This image shows a hand holding the E-Booster pump connected to a bicycle tire valve, with the digital display clearly showing the pressure reading (e.g., 80.0 PSI).

3. Connecting to Tire Valve

- Push the SmartHead valve firmly onto the tire valve stem until it is securely seated.
- If using the extension hose, first screw the hose onto the pump's valve port, then attach the other end of the hose to the tire valve. This is recommended for sensitive TPU resin valves.



Figure 5: Connecting Pump with Extension Hose. This image depicts a user connecting the E-Booster pump, via its extension hose, to a bicycle tire valve, demonstrating the practical application of the hose for easier access.

4. Setting Target Pressure

- Once the pump is connected and powered on, the digital display will show the current tire pressure.
- Use the + and - buttons to set your desired target pressure. The display will flash the target pressure as you adjust it.
- The pump supports inflation up to 120 PSI (8 bar).

5. Starting Inflation

Press the Power button once to start inflation. The pump will automatically inflate the tire to the preset target pressure and then stop. The accuracy is within +/- 2 PSI.

6. Stopping Inflation

To manually stop inflation at any time, press the Power button once.

7. Disconnecting the Pump

Carefully remove the SmartHead valve or extension hose from the tire valve stem. A small hiss of air is normal.

Maintenance

Cleaning

Wipe the pump body with a soft, damp cloth. Do not use harsh chemicals or abrasive cleaners. Ensure the USB-C port is dry and free of debris.

Charging Best Practices

- Charge the pump regularly, even if not in frequent use, to maintain battery health.
- Avoid completely draining the battery before recharging.
- Use only the provided USB-C cable or a certified equivalent.

Storage

Store the pump in a cool, dry place, away from direct sunlight and extreme temperatures. Use the included storage bag for protection during transport.

Troubleshooting

- **Pump not turning on:** Ensure the battery is charged. Connect to a USB-C power source and allow it to charge for a few minutes before attempting to power on again.
- **Pump not inflating:**
 - Check if the valve head is securely attached to the tire valve.
 - Ensure the target pressure is set above the current tire pressure.
 - For Presta valves, confirm the valve core is unscrewed.
 - Check battery level; a low battery may prevent inflation.
- **Inaccurate pressure reading:** Ensure the valve connection is tight and there are no air leaks. Recalibrate by turning the pump off and on again.
- **Slow inflation:** This is a mini pump designed for portability. Inflation speed will be slower compared to a floor pump. Ensure the battery is fully charged for optimal performance.

Specifications

Model Name	E-Booster Digital
Model Number	TDP-E01
Maximum Pressure	120 PSI (8 bar)
Pressure Accuracy	+/- 2 PSI
Battery	7.4V / 600mAh
Charging Port	USB-C
Charging Time	Approx. 45 minutes
Valve Compatibility	Presta, Schrader (SmartHead)
Material	Aluminum, Polymer, Rubber
Item Weight	162g (5.76 ounces)
Dimensions	Approx. 5.9 x 3.5 x 8.6 cm (2.3 x 1.4 x 3.4 inches)

Warranty Information

The Topeak E-Booster Digital Electric Mini Pump comes with a 2-year manufacturer's warranty. Please retain your proof





of purchase for warranty claims. This warranty covers defects in materials and workmanship under normal use. It does not cover damage resulting from misuse, accidents, unauthorized modifications, or normal wear and tear.

Customer Support

For further assistance, technical support, or warranty inquiries, please contact Topeak customer service. Refer to the official Topeak website for the most current contact information.

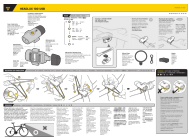
Website: www.topeak.com

Related Documents - E-Booster Digital (TDP-E01)

	<p>Topeak HeadLux 100 USB Bike Light - User Manual and Specifications</p> <p>Comprehensive guide for the Topeak HeadLux 100 USB bike light, covering mounting instructions, operating modes, charging, safety precautions, and warranty information. Includes detailed specifications.</p>
	<p>Topeak: Comprehensive Guide to Bike Maintenance Pumps, Stands, and Tools</p> <p>Explore Topeak's extensive range of high-performance bicycle maintenance equipment, including innovative pumps, robust repair stands, and essential tools designed for cyclists of all levels.</p>
	<p>Topeak TetraRack M2 HD: Heavy-Duty Rear Rack for Mountain Bikes</p> <p>Discover the Topeak TetraRack M2 HD, a versatile, heavy-duty rear rack designed for mountain and full-suspension bikes. Features QuickTrack® system compatibility, tool-free mounting, and a 20kg load capacity.</p>
	<p>Topeak BabySeat II Suspension Child Carrier User Manual</p> <p>Comprehensive user guide for the Topeak BabySeat II Suspension Child Carrier, covering installation, mounting, safety precautions, and maintenance. Includes detailed instructions and diagrams for attaching the seat to a bicycle rack.</p>

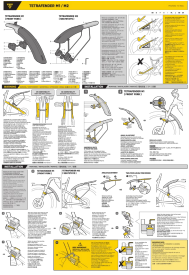

[Topeak TetraFender M1/M2 Bicycle Fender Installation Guide](#)

Comprehensive installation instructions and safety guidelines for the Topeak TetraFender M1 (front fork) and M2 (seatstays) bicycle fenders, ensuring proper fit, clearance, and protection.

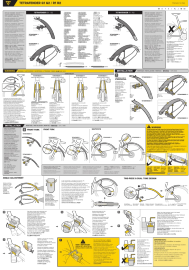

[Topeak TetraFender G1/G2/R1/R2 Installation Guide and Specifications](#)

Comprehensive installation guide and specifications for Topeak TetraFender bicycle fenders (models G1, G2, R1, R2). Includes detailed instructions, compatibility charts, angle adjustment tips, warnings, and warranty information.