

## Manuals+

[Q & A](#) | [Deep Search](#) | [Upload](#)

manuals.plus /

› [ELEGOO](#) /

› [ELEGOO Mini Air Purifier User Manual for Resin 3D Printers](#)

## ELEGOO ELEGOO Mini Air Purifier

# ELEGOO Mini Air Purifier User Manual

For LCD/DLP/MSLA Resin 3D Printers

## 1. INTRODUCTION

The ELEGOO Mini Air Purifier is designed to reduce and filter irritant resin odors produced during the 3D printing process. Utilizing an activated carbon filter, this device helps maintain a fresher and safer working environment when operating LCD, DLP, or MSLA resin 3D printers. This manual provides essential information for the proper setup, operation, and maintenance of your air purifier.

## 2. PACKAGE CONTENTS

Verify that all items are present in your package:

- 2 x ELEGOO Mini Air Purifiers (Rechargeable)
- 2 x Activated Carbon Filters (pre-installed)
- 2 x Spare Activated Carbon Filters
- 1 x USB Charging Cable
- 1 x Power Adapter



**Figure 2.1:** Contents of the ELEGOO Mini Air Purifier package, including two purifiers, a USB charging cable, and a power adapter, next to the product box.



**Figure 2.2:** Two ELEGOO Mini Air Purifiers and a power adapter neatly packed inside their cardboard box.

### 3. SETUP

Before initial use, ensure the activated carbon filter is properly installed and any protective packaging is removed.

1. **Unpack:** Carefully remove the air purifier from its packaging.
2. **Filter Preparation:** Open the cap of the purifier. Locate the activated carbon filter inside. Remove any protective plastic film or paper from the filter before use.
3. **Reassemble:** Place the activated carbon filter back into the purifier and securely close the cap.
4. **Placement:** Position the air purifier inside or near your resin 3D printer's enclosure to effectively absorb odors. For optimal results, place it close to the source of the resin fumes.

Please open the cap of the purifier and remove the protective paper before use.

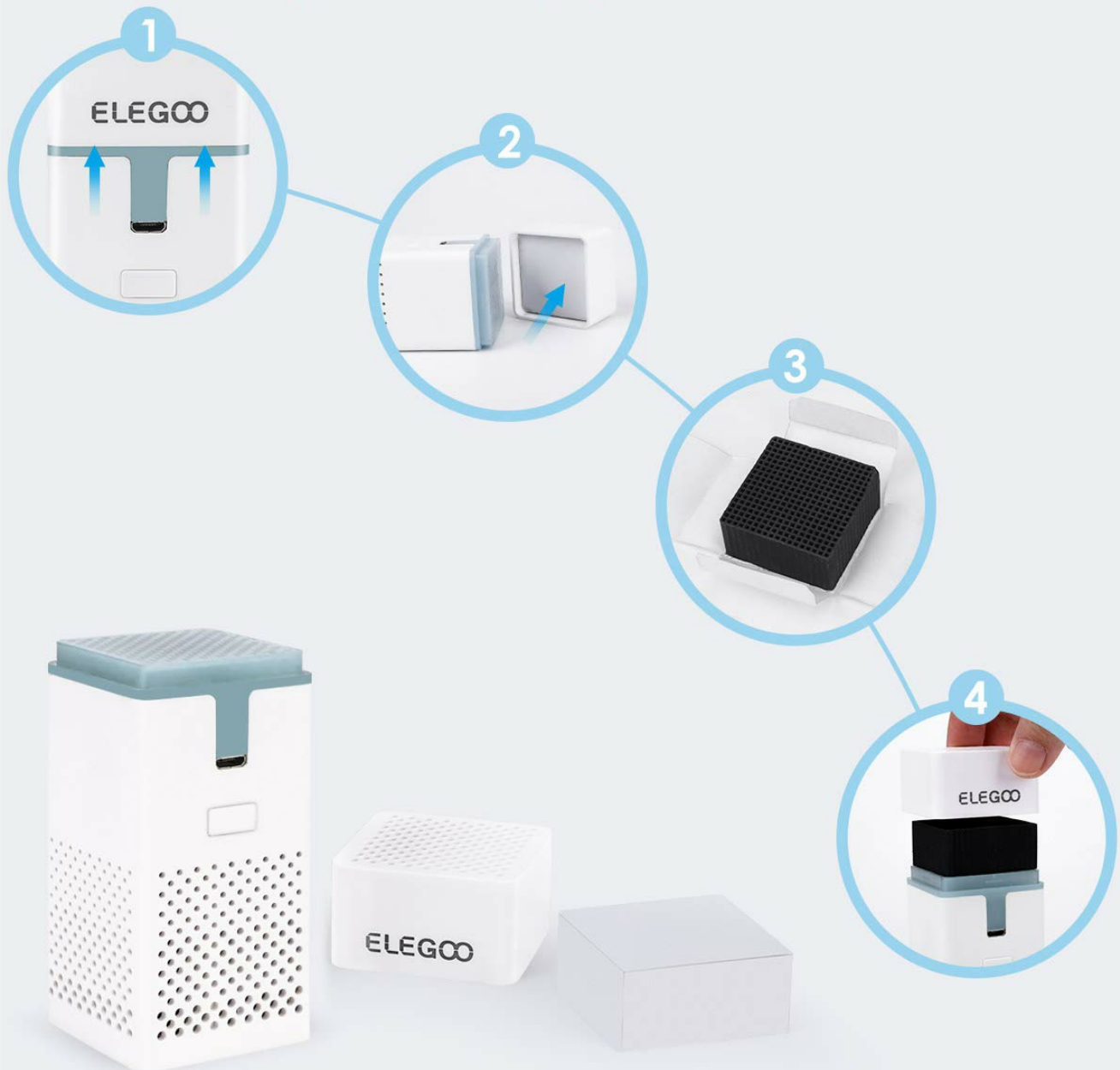

Figure 3.1: Diagram illustrating four steps to open the ELEGOO Mini Air Purifier, remove the protective paper, and install the activated carbon filter.

## 4. OPERATING INSTRUCTIONS

The ELEGOO Mini Air Purifier is designed for simple operation.

### 4.1 Power On/Off

The device features button control. Press the power button once to turn the purifier on. Press it again to turn it off.

## 4.2 Charging

The purifier is equipped with a 2000mAh battery, providing continuous operation for at least 24 hours on a full charge.

- Connect the provided USB charging cable to the purifier and the power adapter.
- Plug the power adapter into a standard electrical outlet.
- A red indicator light will illuminate while charging. The light will turn off once the device is fully charged.

Work continuously for at least 24H once fully charged.



**Figure 4.1:** ELEGOO Mini Air Purifier connected to a charging cable, with a red indicator light showing it is charging.

### 4.3 Usage with 3D Printers

Place the purifiers strategically within your 3D printer's enclosure. For larger enclosures or stronger odors, using both purifiers simultaneously is recommended. The activated carbon effectively absorbs and filters irritant resin odors, contributing to a more pleasant and safer printing experience.

Absorb and filter the irritant resin odor when printing, which gives you a fresh and safe user experience.



Figure 4.2: Three ELEGOO Mini Air Purifiers placed inside a resin 3D printer enclosure, illustrating their use for odor absorption.

## 5. MAINTENANCE

## 5.1 Activated Carbon Filter Replacement

The activated carbon filter has a limited lifespan and requires periodic replacement to maintain optimal odor absorption. Each filter typically lasts 3 to 6 months, depending on usage frequency and resin odor intensity.

- To replace the filter, open the cap of the purifier as shown in Figure 3.1.
- Remove the old activated carbon block.
- Insert a new activated carbon filter, ensuring it is seated correctly.
- Close the cap securely.

Replacement carbon filters can be purchased separately. Refer to the ELEGOO official website or authorized retailers for compatible replacement filters.

## 6. TROUBLESHOOTING

If you encounter issues with your ELEGOO Mini Air Purifier, refer to the following common solutions:

- **Purifier does not turn on:**
  - Ensure the device is fully charged. Connect it to the power adapter and check if the red charging indicator light appears.
  - Press the power button firmly.
- **No noticeable odor reduction:**
  - Verify the purifier is turned on. Although the fan is quiet, you should feel a slight airflow from the top.
  - Check if the activated carbon filter has been used beyond its lifespan (3-6 months). Replace the filter if necessary.
  - Ensure the protective film or paper has been removed from the activated carbon filter.
  - Confirm the purifier is placed optimally within the printer enclosure, close to the resin vat.
- **Charging indicator light does not work:**
  - Ensure the charging cable and power adapter are securely connected and functioning correctly. Try a different USB port or adapter if available.

If problems persist, please contact ELEGOO customer support for further assistance.

## 7. SPECIFICATIONS

Feature	Specification
Product Dimensions	1.73"D x 1.73"W x 4.21"H (4.4 x 4.4 x 10.7 cm)
Weight	4.22 ounces (120g) per unit
Battery Capacity	2000mAh
Operating Time	≥ 24 hours (fully charged)
Noise Level	10 dB
Filter Type	Activated Carbon

Feature	Specification
Filter Lifespan	3-6 months (approx.)
Control Type	Button Control
Color	White
Model Number	ELEGOO Mini Air Purifier

## 8. WARRANTY AND SUPPORT

ELEGOO products come with a standard manufacturer's warranty. For specific warranty details, registration, or technical support, please visit the official ELEGOO website or contact their customer service directly. Keep your purchase receipt as proof of purchase.

**ELEGOO Official Website:** [www.elegoo.com](http://www.elegoo.com)