

## YUHANUS YH-SP1203-AD124

# YUHANUS Smart Door Access Control System Electric Strike Lock Kit User Manual

Model: YH-SP1203-AD124

## 1. INTRODUCTION

This manual provides comprehensive instructions for the installation, operation, and maintenance of your YUHANUS Smart Door Access Control System Electric Strike Lock Kit. This system is designed to convert standard cylindrical lock sets into an electronic access-controlled locking system, offering enhanced security and convenience through remote access via the Tuya App and included remote controllers.

## 2. PRODUCT COMPONENTS

The YUHANUS Smart Door Access Control System Kit includes the following components:

- Electric Strike Lock (2200LBS holding force)
- Power Supply Controller (Input: AC100-240V, Output: DC12V/3A)
- Two Remote Controllers (supports up to 30pcs)
- Stainless Steel Exit Button
- Power Plug Connector
- Mounting Screws and Wall Anchors



Image 2.1: Overview of the YUHANUS Smart Door Access Control System Kit components, including the electric strike lock, power supply, exit button, remote controls, and power cord.

### 3. KEY FEATURES

- **Smart Door Access Control:** Integrated system for secure and convenient door access.
- **Tuya App Remote Control:** Unlock your door remotely from any location using the Tuya smartphone application.
- **Fail Safe & Fail Secure Modes:** The electric strike lock can be easily switched between Fail Safe (NC Mode - lock opens when power off) and Fail Secure (NO Mode - lock closes when power off) to suit specific security requirements.
- **Multiple Remote Controllers:** Includes two remote controllers, with support for adding up to 30 units for multi-user access management.
- **Durable Construction:** Features a stainless steel exit button and robust components for reliable long-term use.

- **Easy Installation:** Designed for compatibility with various door types in residential or commercial settings.

## 4. SETUP & INSTALLATION

Careful installation is crucial for optimal performance and safety. It is recommended that installation be performed by a qualified technician.

### 4.1 Electric Strike Lock Configuration (Fail Safe / Fail Secure)

The electric strike lock can operate in two modes:

- **Fail Secure Mode (NO Mode):** When power is off, the lock remains closed. This is the default setting upon receipt.
- **Fail Safe Mode (NC Mode):** When power is off, the lock opens.

To adjust the mode:

1. Unscrew Screw 2.
2. Loosen Screw 1, then slide the internal component to the other side.
3. Tighten Screw 1 and Screw 2.

You can revert to Fail Secure Mode by reversing these steps.

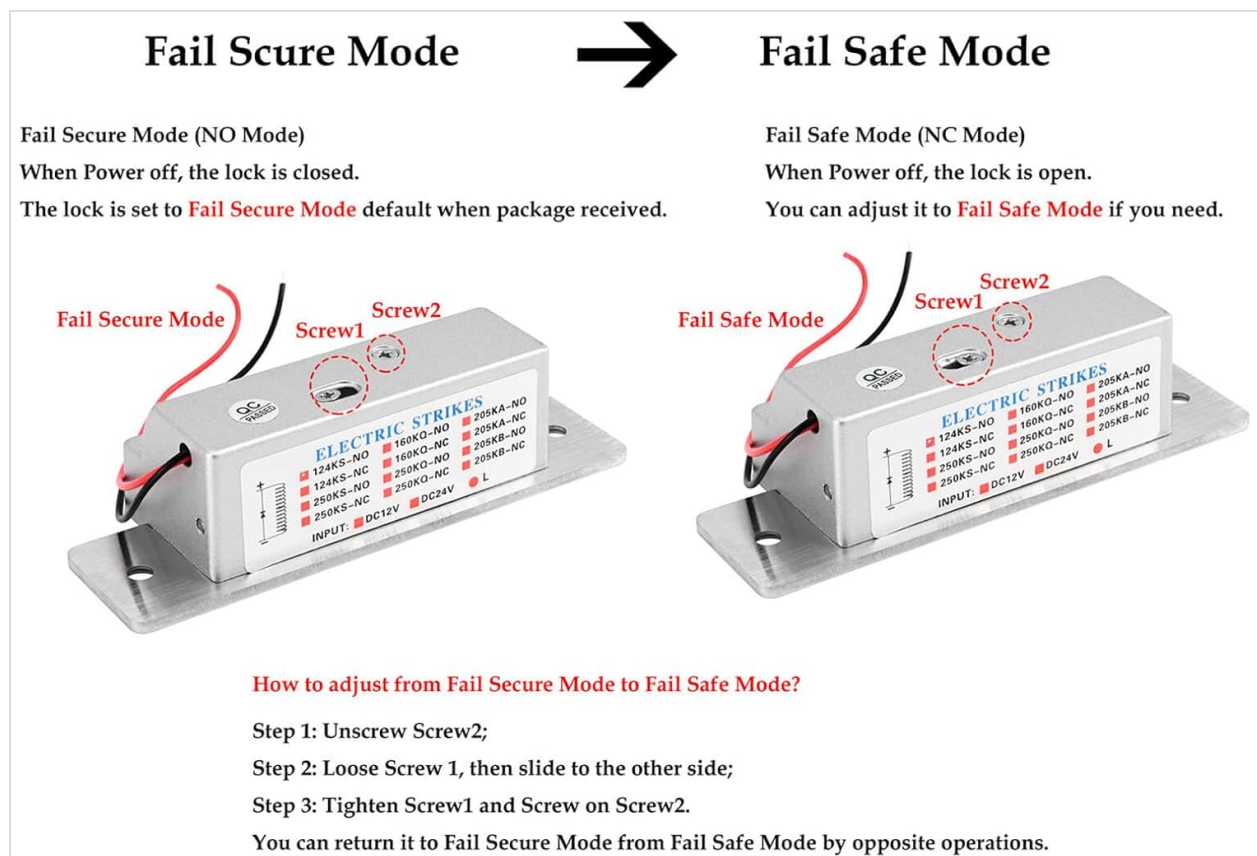

Image 4.1: Visual guide for adjusting the electric strike lock between Fail Secure and Fail Safe modes by manipulating internal screws.

### 4.2 Wiring Diagram

Follow the wiring diagram carefully to connect all components to the power supply controller. Ensure all connections are secure and correctly polarized.

# Wiring Diagram of the Access Control System

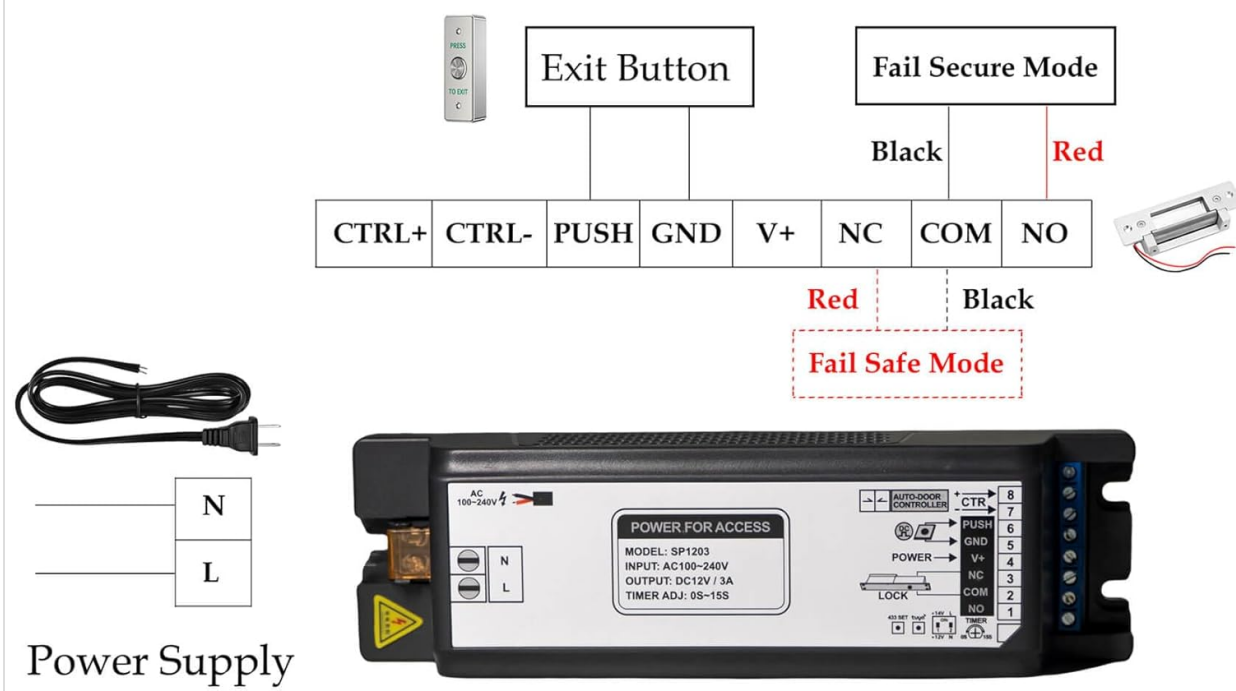

Image 4.2: Detailed wiring diagram illustrating connections between the power supply, exit button, and electric strike lock for both Fail Secure and Fail Safe configurations.

## 4.3 Power Supply Controller Connections

The power supply controller has clearly labeled terminals for various connections:

- **AC 100-240V:** Power input (L and N terminals).
- **DC12V/3A Output:** Power output for the lock and other components.
- **CTR, PUSH, GND, V+, V-, NC, COM, NO:** Terminals for connecting the exit button, electric strike lock, and other access control devices.

The timer adjustment knob allows setting the unlock delay from 0 to 15 seconds. Rotate clockwise to increase the delay.

CTR+	CTR-	PUSH	GND	V+	V-	NC	COM	NO
------	------	------	-----	----	----	----	-----	----



Delay Time Adjust:  
Clockwise rotation increases from 0s to 15s,  
with 0s on the far left and 15s on the far right.

Image 4.3: Close-up view of the power supply controller, highlighting the input/output terminals, control connections, and the timer adjustment knob.

## 4.4 Tuya App Setup

1. Download the Tuya Smart App from your device's app store (iOS or Android).
2. Register or log in to your Tuya account.
3. Follow the in-app instructions to add a new device. Ensure your smartphone is connected to a 2.4GHz Wi-Fi network during the pairing process.
4. Once paired, you can control the lock remotely.

## 5. OPERATING INSTRUCTIONS

### 5.1 Using the Tuya App

Open the Tuya Smart App on your smartphone. Select your access control system from the device list. Tap the 'Unlock' or 'Open' button within the app to remotely activate the electric strike lock.

### 5.2 Using Remote Controllers

Press the designated button on the remote controller to momentarily unlock the door. The remote controllers operate wirelessly and are pre-paired with the system. Additional remotes can be paired as needed (up to 30 total).

### 5.3 Using the Exit Button

From the inside, press the stainless steel exit button to momentarily unlock the door, allowing for easy egress.

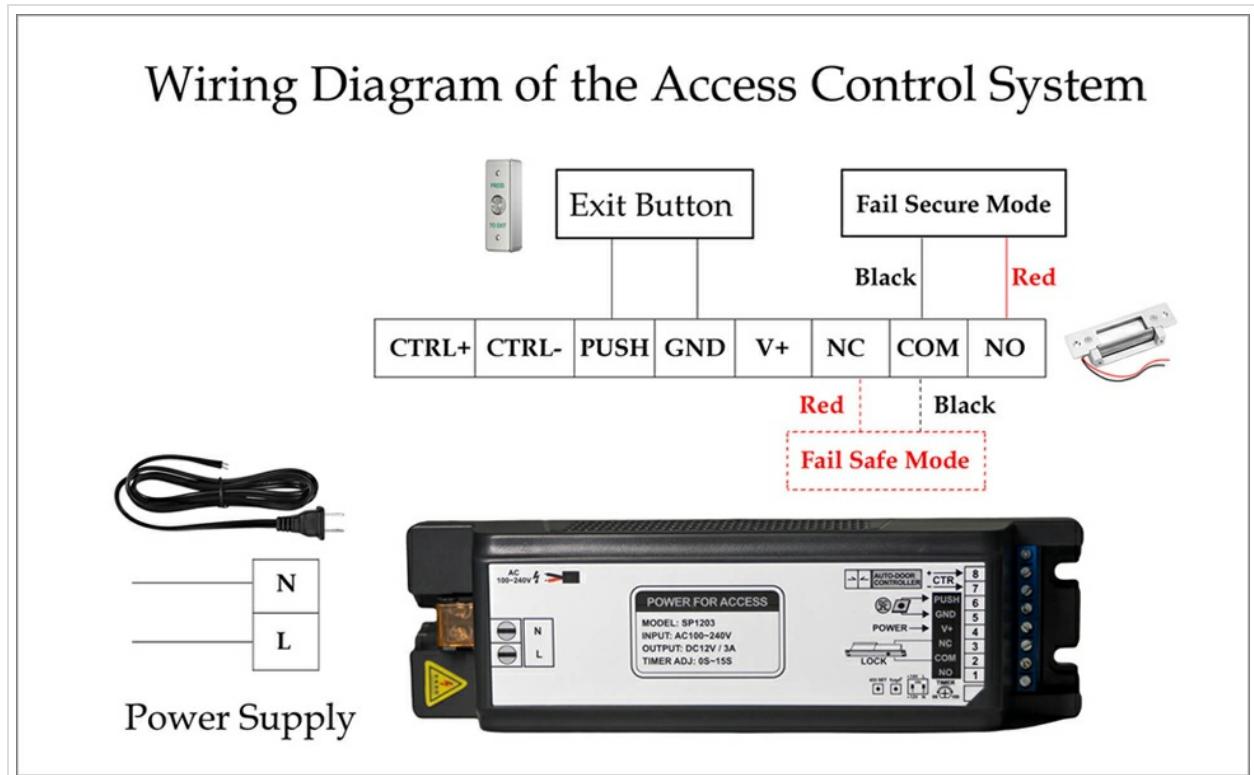

Image 5.1: Illustration of the access control system in operation, showing remote unlocking via smartphone app and physical remote control from both inside and outside the door.

## 6. MAINTENANCE

- **Cleaning:** Wipe components with a soft, dry cloth. Avoid abrasive cleaners or solvents.
- **Connections:** Periodically check all wiring connections to ensure they remain secure.
- **Remote Control Batteries:** Replace batteries in remote controllers as needed. The system itself is powered by AC.
- **Functionality Check:** Regularly test the system's unlocking and locking functions using the app, remote, and exit button.

## 7. TROUBLESHOOTING

- **System Not Responding:** Check if the power supply controller is receiving power. Verify all wiring connections.
- **Remote Control Not Working:** Ensure the remote control batteries are not depleted. Re-pair the remote if necessary.
- **Tuya App Connectivity Issues:** Confirm your smartphone has a stable internet connection. Ensure the access control system is connected to your Wi-Fi network (2.4GHz). Restart the app or re-pair the device if issues persist.
- **Door Not Unlocking/Locking:** Check the electric strike lock's Fail Safe/Fail Secure mode setting. Inspect the lock for any physical obstructions or damage.

## 8. SPECIFICATIONS



Brand	YUHANUS
Model Name	YH-SP1203-AD124
Material	Stainless Steel
Lock Type	Electric Strike Deadbolt
Special Feature	Auto-Lock, Tuya App Control
Power Supply Input	AC 100-240V
Power Supply Output	DC 12V / 3A
Timer Adjustment	0-15 seconds
Remote Control Capacity	Max 30 pieces
Item Dimensions (L x W x H)	8 x 6 x 2 inches
Item Weight	1 pound (16 ounces)
UPC	767637528887

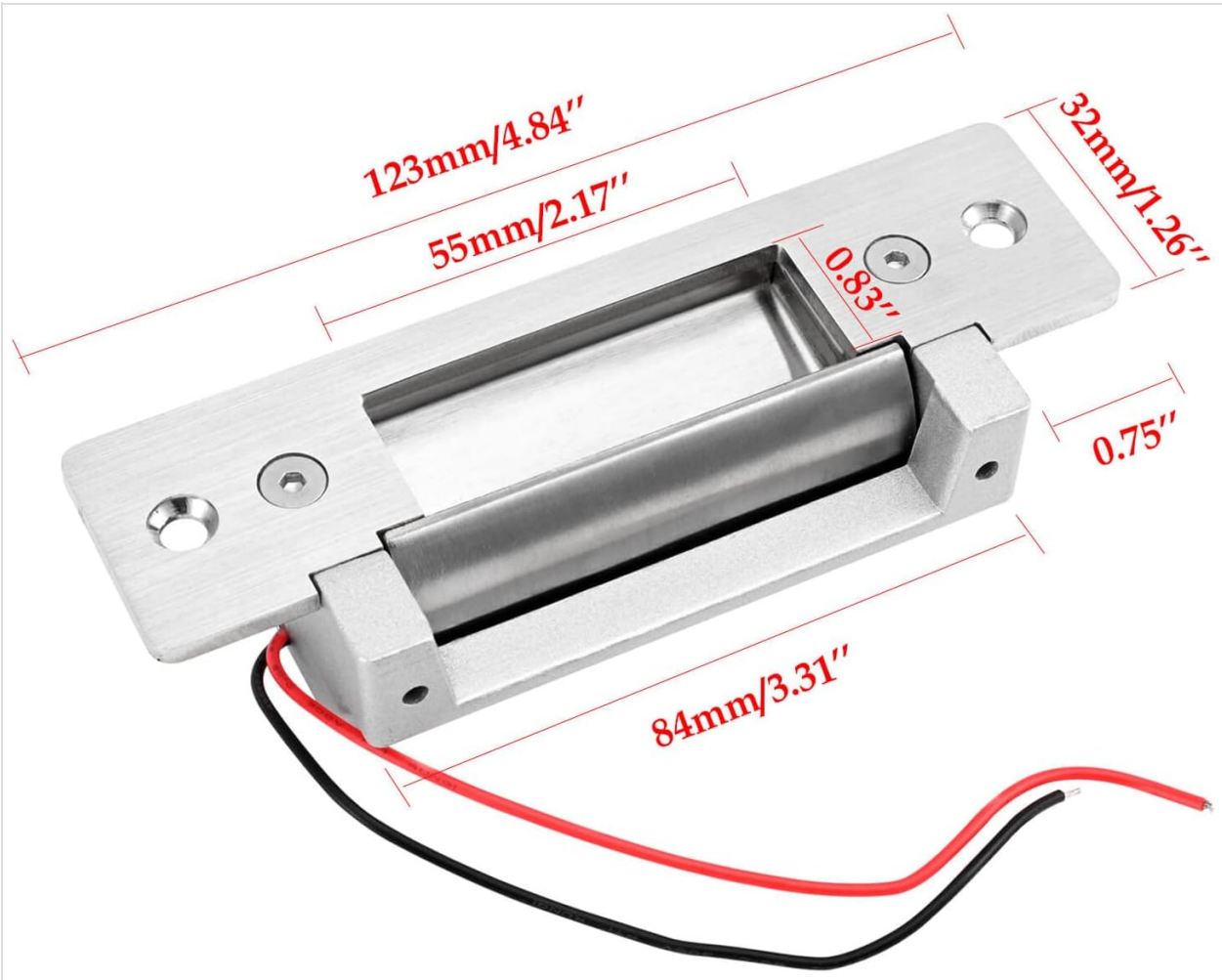

Image 8.1: Detailed dimensions of the electric strike lock component.







Image 8.2: Detailed dimensions of the stainless steel exit button.

## 9. SUPPORT

For technical assistance, troubleshooting beyond this manual, or warranty inquiries, please contact YUHANUS customer support through the retailer where the product was purchased or refer to the contact information provided with your product packaging.



Related Documents - YH-SP1203-AD124

	<p><a href="#">Shenzhen YuHan Bluetooth Smart Lock Model Differences - YUHANUS</a></p> <p>Details on model differences for Shenzhen YuHan's YUHANUS Bluetooth smart locks, including model numbers YH-D280, YH-D290, YH-D300, YH-D350, YH-D500, YH-D800, YH-ULock-01, YH-BikeLock-01, YH-BikeLock-02. All models share the same circuit and RF module.</p>
	<p><a href="#">VEVOR YHX-007 Coded Lock User Manual and Instructions</a></p> <p>Official user manual and instructions for the VEVOR YHX-007 Coded Lock. Learn how to set and reset your personal combination for secure storage.</p>
	<p><a href="#">VEVOR HS-OHS05-L Coupler Lock User Manual and Installation Guide</a></p> <p>This manual provides safety instructions, installation steps, and maintenance guidelines for the VEVOR HS-OHS05-L Coupler Lock. Ensure proper use and longevity of your trailer hitch lock.</p>
	<p><a href="#">VEVOR HS-OHS02-T Coupler Lock Installation and Maintenance Guide</a></p> <p>Official installation, safety, and maintenance instructions for the VEVOR HS-OHS02-T Coupler Lock. Learn how to properly use and care for your coupler lock for secure towing.</p>
	<p><a href="#">VEVOR Mechanical Keyless Door Lock OL-601D3-01 Installation and User Manual</a></p> <p>Comprehensive installation and user manual for the VEVOR Mechanical Keyless Door Lock, Model OL-601D3-01. Includes safety precautions, parts list, installation steps, password management, and troubleshooting.</p>



COUPLER LOCK  
MODEL: HS-OHS04-L

VEVOR Support Center



[VEVOR Coupler Lock HS-OHS04-L User Manual and Safety Instructions](#)

Comprehensive user manual for the VEVOR Coupler Lock, model HS-OHS04-L. Includes essential safety warnings, step-by-step installation guide, and maintenance recommendations for trailer coupler security.