

[Manuals.plus](#) /

› [HOMMOW](#) /

› HOMMOW 5-in-1 Baby Bassinet Bedside Sleeper Instruction Manual (Model C820)

HOMMOW C820

HOMMOW 5-in-1 Baby Bassinet Bedside Sleeper Instruction Manual

Model: C820 | Brand: HOMMOW

1. INTRODUCTION

The HOMMOW 5-in-1 Baby Bassinet Bedside Sleeper is designed for versatility and convenience, adapting to various stages of your child's early development. This multi-functional unit can serve as a bassinet, bedside sleeper, playard, cradle, and includes a detachable diaper changing station. This manual provides essential information for safe assembly, operation, and maintenance.



Figure 1: Overview of the HOMMOW 5-in-1 Baby Bassinet Bedside Sleeper with mosquito net and side organizer.

2. SAFETY INFORMATION

WARNING: Always ensure the safety of your child by following these guidelines:

- Always secure the safety strap to your bed when using the bassinet in bedside sleeper mode to prevent separation.

- Be cautious when moving the bassinet on wheels; ensure wheels are locked when stationary.
- Keep the bassinet away from young children to prevent accidents.
- Never leave an infant unattended in the changing unit.
- Ensure all components are correctly assembled and locked before placing a child in the bassinet or playard.
- Do not use additional mattresses or padding not supplied by the manufacturer, as this may cause suffocation.

3. SETUP AND ASSEMBLY

The HOMMOW bassinet is designed for quick and easy assembly. Follow the steps below for initial setup and configuration of different modes.

3.1. Unpacking and Initial Setup

1. Remove the bassinet from its carrying bag.
2. Unfold the main frame by pulling the short ends upwards until they click into place, then repeat for the long ends. Ensure all sides are locked.
3. Push down the center of the base until it lies flat and secure.

3.2. Bassinet Mode Assembly

1. Insert the support bars into the designated sleeves on the bassinet's upper level.
2. Place the mattress pad (Item 01) onto the installed support bars, ensuring it lies flat and secure.

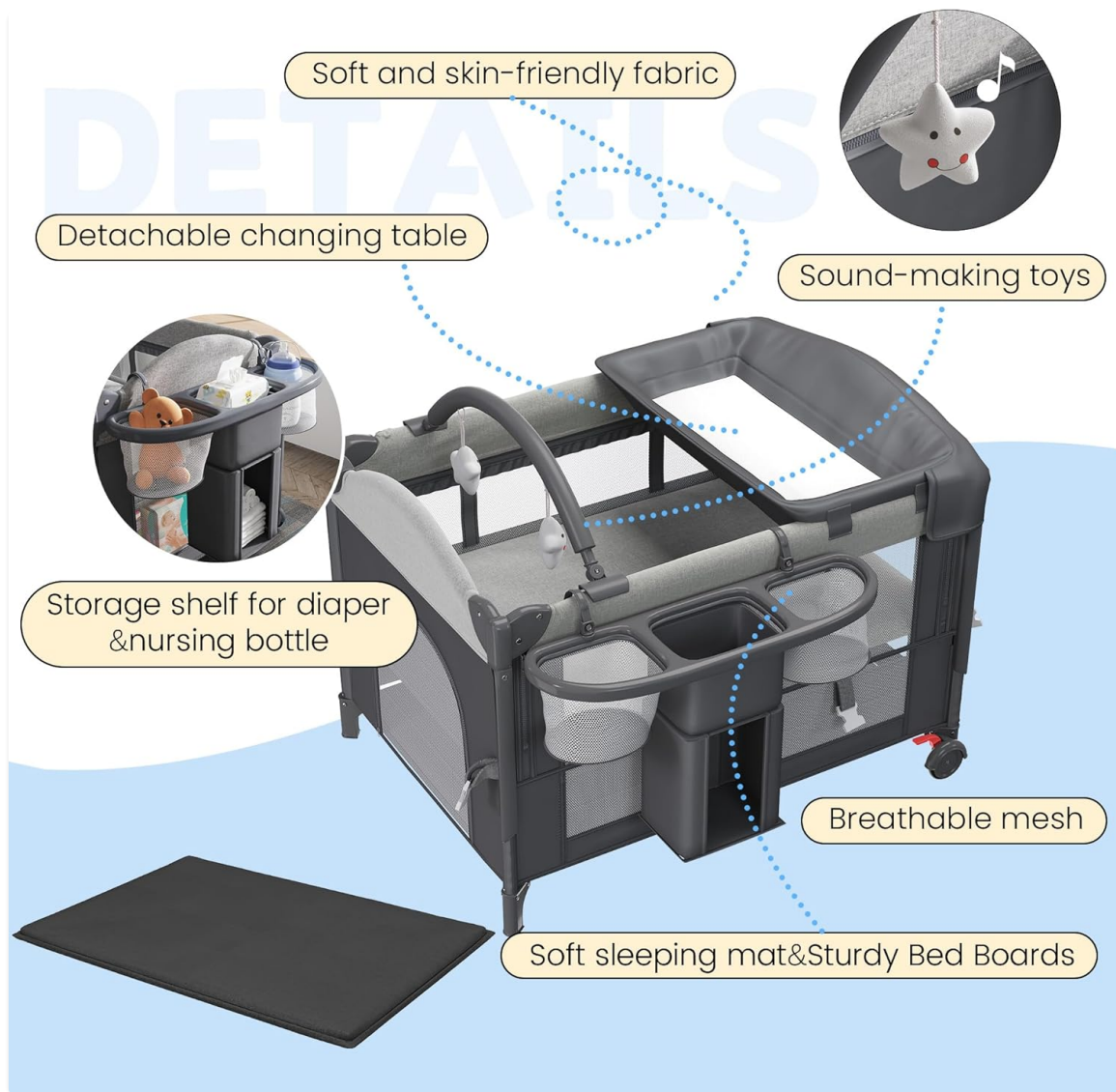

Figure 2: Detailed features including soft fabric, detachable changing table, and sound-making toys.

3.3. Detachable Diaper Changer and Organizer

1. Attach the changing table (Item 10) to the top rails of the bassinet using the provided clips. Ensure it is securely fastened.
2. Hook the side organizer (Item 11) onto the bassinet frame. This provides convenient storage for diapers, wipes, and other essentials.

3.4. Toy Bar and Mosquito Net Attachment

1. Assemble the toy bar (Item 14) by connecting its components.
2. Clip the assembled toy bar onto the bassinet rail.
3. Place the mosquito net (Item 09) over the bassinet, securing it around the edges to protect your baby from insects.

3.5. Folding for Storage

1. Remove all accessories (changing table, organizer, toy bar, mosquito net).
2. Remove the mattress pad and support bars from the upper level.
3. Pull the center handle at the bottom of the bassinet upwards.
4. Press the buttons on the side rails to unlock them, then fold the sides inwards.
5. Wrap the mattress pad around the folded frame and secure it with the attached straps. Place it

in the carrying bag.

3.6. Setup Videos

Your browser does not support the video tag.

Video 1: Detailed assembly and feature demonstration for the Portable Baby Bedside Sleeper.

Your browser does not support the video tag.

Video 2: Step-by-step installation guide for the 5-in-1 Pack and Play.

4. OPERATING MODES

The HOMMOW 5-in-1 Bassinet offers multiple configurations to suit your needs:

4.1. Bassinet Mode

For newborns and infants, the upper level provides a comfortable and secure sleeping space. Ensure the mattress is properly installed and secured with the Velcro straps.

4.2. Bedside Sleeper Mode

Adjust the bed height to one of the 4 available levels to align with your adult bed. Unzip one side of the bassinet and use the included safety strap to securely attach it to your bed frame. This allows for intimate moments and easy nighttime care.

Seamless connect to bed

For Safe and direct access during nighttime care



Figure 3: Bedside sleeper configuration with adjustable height and secure attachment to an adult bed.

4.3. Playard Mode

Once your child can sit up or pull themselves up, lower the mattress to the bottom level to create a spacious and safe play area. The zippered side door allows for easy entry and exit for older infants and toddlers.



**Bottom Play Area
with Door**

Spacious Storage Space for
Toys & Baby Care Products

Figure 4: Child enjoying the spacious bottom play area with convenient zippered access.

4.4. Cradle Mode

The bassinet's base is equipped with a swinging tube that can be pulled out to transform it into a gentle cradle, providing soothing motion for your baby.

Easily transform into a cradle bed

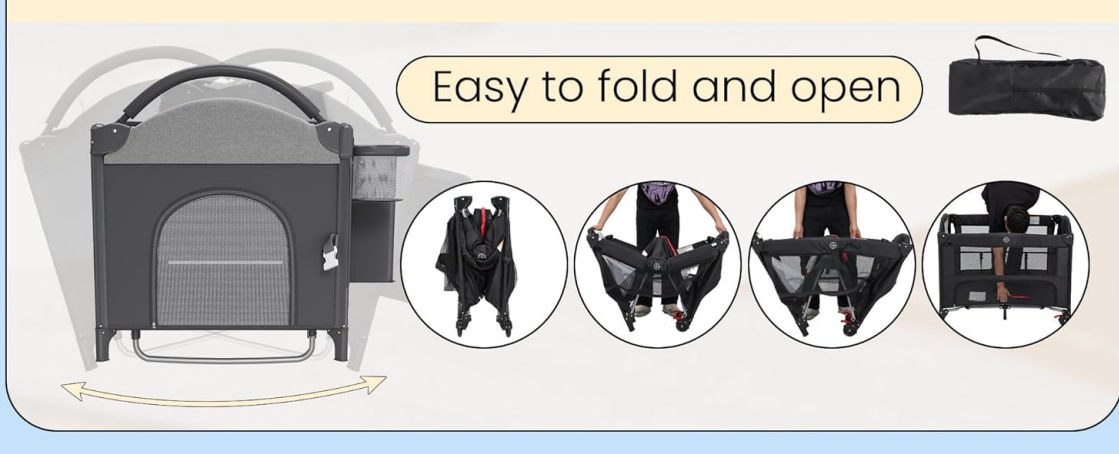

Figure 5: Transformation of the bassinet into a cradle and its compact folding mechanism.

4.5. Diaper Changer Mode

The detachable changing table features waterproof and easy-to-clean padding, making diaper changes efficient and hygienic. Utilize the side organizer for quick access to changing supplies.

Your browser does not support the video tag.

Video 3: Demonstration of various features and modes of the baby bassinet.

5. MAINTENANCE

Proper maintenance ensures the longevity and safety of your HOMMOW bassinet.

5.1. Cleaning Instructions

- The mattress and armrests are made of 150D cationic fabric. For general cleaning, wipe with a damp cloth and mild soap.
- The fabric components are machine washable. Refer to the care label for specific washing instructions.

- The waterproof changing table can be easily wiped clean with a damp cloth.
- Regularly inspect all parts for wear and tear. Replace any damaged components immediately.

6. TROUBLESHOOTING

If you encounter any issues with your bassinet, refer to the following common solutions:

- **Problem: Bassinet does not lock into place during setup.**
Solution: Ensure the center of the base is not pushed down before locking the side rails. Pull the short ends up first until they click, then the long ends. Finally, push the center down.
- **Problem: Mattress feels loose or shifts.**
Solution: Verify that the mattress pad is correctly placed on the support bars and that all Velcro straps underneath are securely fastened to the bassinet frame.
- **Problem: Wheels are not locking.**
Solution: Check that the brake levers on the wheels are fully engaged. Ensure no debris is obstructing the locking mechanism.
- **Problem: Difficulty folding the bassinet.**
Solution: Ensure all accessories and the mattress are removed. Pull the center handle upwards completely before attempting to unlock and fold the side rails.

7. SPECIFICATIONS

Feature	Specification
Brand	HOMMOW
Model Number	C820
Color	Grey
Product Dimensions	39"L x 27.5"W x 29"H
Item Weight	25.4 Pounds
Frame Material	Metal
Product Care Instructions	Machine Wash
Assembly Required	Yes (Instructions Included)

Size information



Figure 6: Key dimensions of the bassinet and mosquito net for reference.

8. WARRANTY AND SUPPORT

For warranty information or technical support, please contact HOMMOW customer service through the retailer where the product was purchased. Keep your purchase receipt as proof of purchase.

Online resources and FAQs may also be available on the HOMMOW brand website or the retailer's support pages.