

sarmert C2

Sarmert C2 4K Dual Dash Cam and Hardwire Kit User Manual

Model: C2

1. INTRODUCTION

Thank you for choosing the Sarmert C2 4K Dual Dash Cam and Hardwire Kit. This manual provides detailed instructions for the installation, operation, and maintenance of your new dash camera system. Please read this manual thoroughly before use to ensure proper functionality and to maximize the benefits of your device. This system is designed to provide reliable video recording for your vehicle, enhancing safety and security.

2. PRODUCT OVERVIEW

2.1 Package Contents

- Sarmert C2 4K Dual Dash Cam (Front Camera)
- Rear Camera
- USB C Hardwire Kit (11.5ft)
- 64GB MicroSD Card
- User Manual

2.2 Key Features

- **4K Ultra-Clear Sensor:** Provides high-resolution video capture for both front and rear views.
- **Super Night Vision:** Enhances low-light performance for clear recordings in dark conditions.
- **24/7 Parking Monitoring:** Continuous surveillance with motion detection and collision alerts (requires hardwire kit).
- **G-Sensor Protection:** Automatically locks and saves footage upon collision detection to prevent overwriting.
- **Low Voltage Protection:** Hardwire kit automatically cuts power to prevent car battery drain.
- **Built-in 2.4GHz & 5G WiFi:** For faster video download and app control.
- **Built-in GPS:** Tracks routes and speed, viewable via complimentary GPS player software.
- **Universal Compatibility (Hardwire Kit):** Compatible with most USB Type-C dash cams, GPS navigators, and radar detectors.
- **Multiple Safety Protections (Hardwire Kit):** Includes short circuit, overheating, adjustable low voltage, and

cable reversal prevention.

2.3 Product Components and Features Visuals



Figure 2.3.1: Overview of the Sarmert C2 4K Dual Dash Cam system components, including the front dash cam, rear camera, USB-C hardwire kit, and a 64GB microSD card.

UNIVERSAL COMPATIBILITY

Compatible with most dash cams with USB Type-C power connector on the market

Applicable: Sarmert Dashcam LS09 M571 M572

Automatically converts
12-24V to output 5V/2.5A

SUPPORTS MULTI INPUT POWER



Dash Cam



GPS



Radar

Figure 2.3.2: Illustration of the 24-hour parking monitor and G-sensor functionality, which activates and locks footage upon collision detection, theft, or vicious scratch detection.

Sarmert's Custom Designed

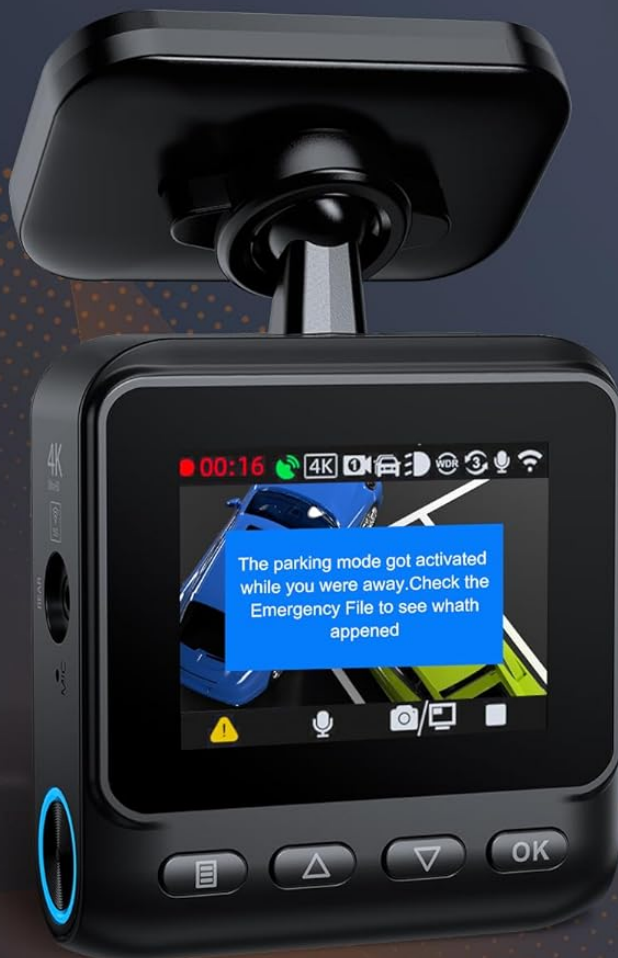

G-Sensor:

Dash cam activates & auto-LOCK recorded footage.
(If your parked car is struck and the impact meets the preset G-Sensor threshold)



Collision
Detection



Theft
Detection



Vicious Scratch
Detection



The Dash Cam will Notify You
Audibly with A Voice Alert.

24-Hour Parking Monitor **NEEDED** for Type C Hardwire Kit to function.
Type C Hardwire Kit is **NOT INCLUDED** in the packaging, Purchase separately.

Figure 2.3.3: The USB Type-C hardwire kit, demonstrating its universal compatibility with various USB Type-C powered devices such as dash cams, GPS units, and radar detectors, converting 12-24V to 5V/2.5A output.

Super Night Vision

The C2 4K DUAL DASH CAM is equipped with a 4K ultra-clear sensor and Super Night Vision technology. This feature enhances low-light performance, allowing for clear capture of details like license plates in darkness, ensuring high-quality images and videos at all times.



Figure 2.3.4: The C2 4K Dual Dash Cam's Super Night Vision technology, which enhances low-light performance for clear capture of details like license plates in darkness.

Built-in 2.4GHz & 5G WiFi, GPS, and Free APP

Free app, 5G wifi, easy control
compatible, share and download on the go



4x UP-TO
Faster
Transfer Speed



Dual Band WiFi

5G WIFI

2.4GHz WiFi

Faster Video Download Speed

OUR

✓ 5.0GHz WiFi Speed Up To 8MB/s

□ Other's 2.4GHz WiFi 2MB/s

Support One click
OTA firmware upgrade



GET IT ON
Google Play

Download on the
App Store

Connect your Sarmert C1-5K
dash cam to your iPhone, iPad,
or Android device via our
NEW APP - RoadRec.



GPS for Tracking
Routes and Speed

Easily view recordings
GPS logs, and G-Sensor data
on your PC or Mac using our
complimentary Sarmert
GPS PLAYER.



Figure 2.3.5: Features such as built-in 2.4GHz & 5G WiFi for faster video download and OTA firmware upgrades, along with built-in GPS for tracking routes and speed.

3. SETUP AND INSTALLATION

3.1 Dash Cam Installation

1. Clean the windshield area where the dash cam will be mounted.
2. Attach the front dash cam to the windshield using the provided adhesive mount, ensuring a clear view of the

road.

3. Route the power cable neatly along the windshield trim and dashboard.
4. Install the rear camera on the rear windshield, ensuring it has a clear view. Connect its cable to the main dash cam unit.

3.2 Hardwire Kit Installation

The hardwire kit enables 24-hour parking monitoring and protects your car battery from draining. Installation typically takes 10-25 minutes.

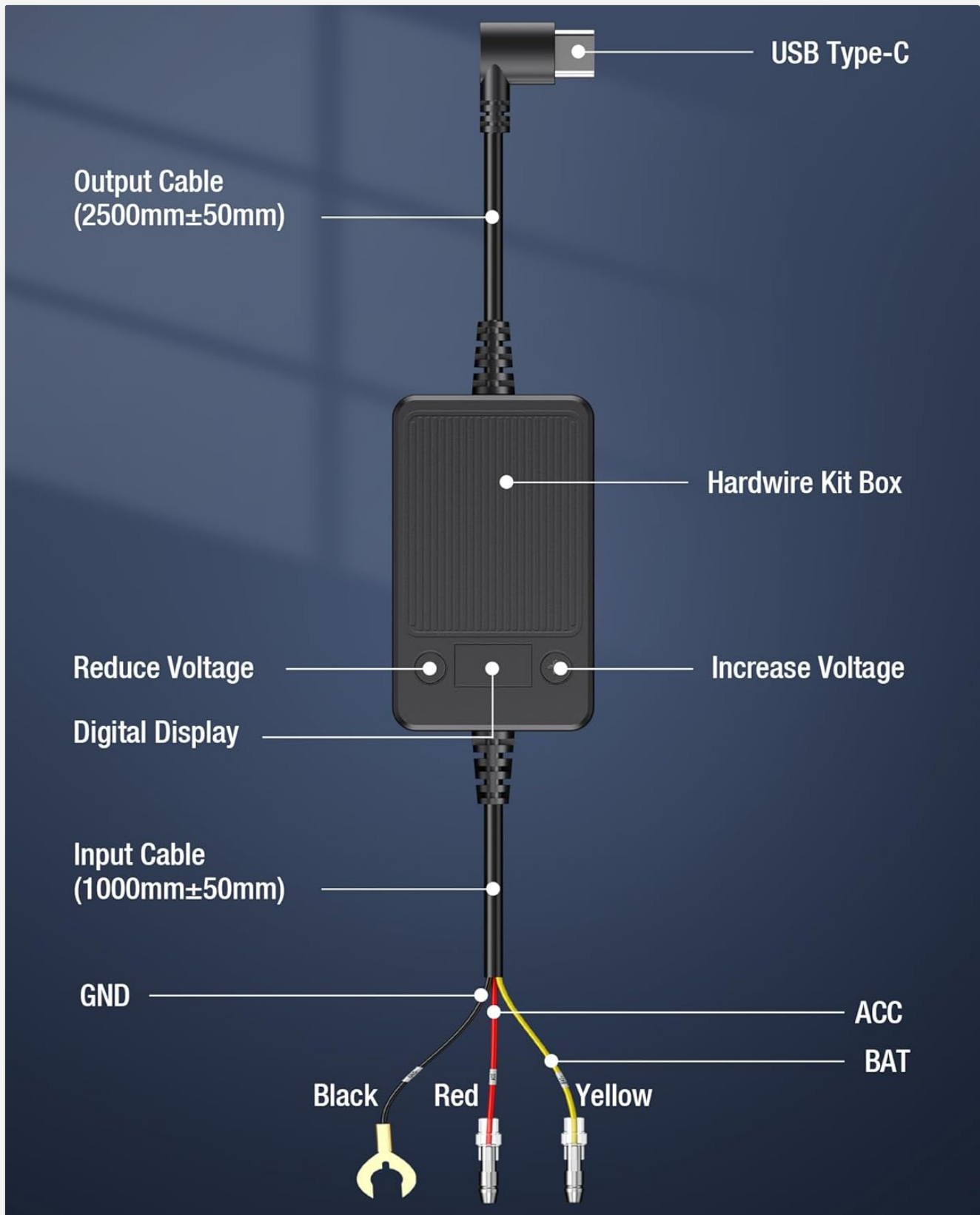

Figure 3.2.1: Detailed diagram of the hardwire kit, showing the USB Type-C output cable, hardwire kit box, input cable, and the three lead wires (GND, ACC, BAT+).

1. Locate your vehicle's fuse box. Refer to your vehicle's manual for its location.
2. **Connect the Black wire (GND):** Attach this wire to a metal bolt or screw on the vehicle's chassis for a ground connection.
3. **Connect the Red wire (ACC):** Connect this wire to a fuse in your fuse box that is only powered when the ignition is on (Accessory power).
4. **Connect the Yellow wire (BAT+):** Connect this wire to a fuse in your fuse box that has constant power, even when the ignition is off (Battery power).
5. Route the hardwire kit cable neatly and discreetly to the dash cam.
6. Plug the USB-C connector of the hardwire kit into the dash cam's power port.

***Note:** If you are not experienced with car electrical systems, it is highly recommended to seek professional installation to avoid damage to your vehicle or the device.*

3.3 Low Voltage Protection Settings

The hardwire kit features smart low voltage protection to prevent your car battery from draining. It automatically cuts off power after 60 seconds if the car battery drops to a preset voltage.

LOW VOLTAGE PROTECTION

Monitor the vehicle voltage status at all times, and automatically cut off the power supply of the dash cam when the voltage is too low.

For 12V Battery:
11.8V 12.0V 12.2V 12.4V

For 24V Battery:
23.6V 24.0V 24.4V 24.8V

Dash Cam Hardwire Kit

Input: DC12/24V Output: DC5V/2.5A
Adjustable Low Voltage Protection:
12V Power Supply: 11V-13.5V
24V Power Supply: 23V-25V
Press and hold any key for 3 seconds to show the display
Press "+", "-" key to adjust the protection voltage

CE UK CA IC FC RoHS
Made in China PSE

The BLACK wire(GND)

need to connect with metal bolt or screw

The RED wire(ACC)

need to connect with Fuse Box ACC

The YELLOW wire(BAT+)

need to connect with constant fuse

If you don't have the experience on installing the hardwire kit for dash cam, please ask for the professional.

Figure 3.3.1: Low voltage protection settings. For a 12V battery, cutoff options are 11.8V, 12.0V, 12.2V, 12.4V. For a 24V battery, options are 23.6V, 24.0V, 24.4V, 24.8V. Press and hold any key for 3 seconds to show the display, then use '+' or '-' to adjust the voltage.

To adjust the protection voltage:

1. Press and hold any key on the hardwire kit for 3 seconds to activate the digital display.
2. Use the '+' and '-' buttons to select your desired low voltage cutoff threshold.

3-LEAD HARDWIRE KIT

Provides power to your dashcam from your car's battery via fuse box to keep your dashcam continuously running even your engine is turned off.



ACC

GND

BAT+



Battery Drain
Protection



Over-current
Protection



Short-circuit
Protection



Reverse Connection
Protection



Overheat
Protection

Figure 3.3.2: The 3-lead hardwire kit provides multiple safety protections including battery drain prevention, over-current protection, short-circuit protection, reverse connection protection, and overheat protection.

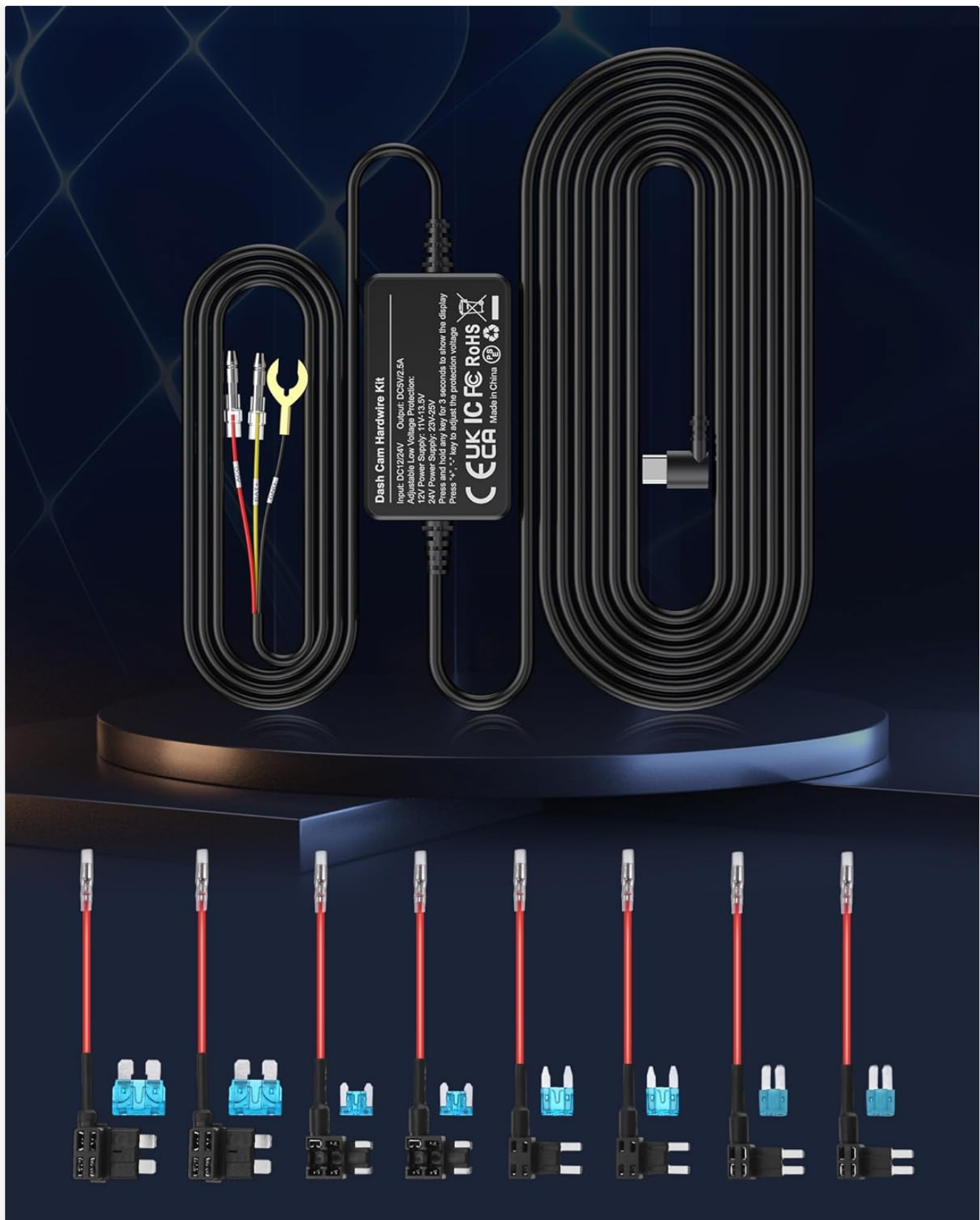

Figure 3.3.3: The complete hardwire kit package, including the main unit and various fuse taps for different vehicle fuse box types, ensuring broad compatibility.

4. OPERATING INSTRUCTIONS

4.1 Powering On/Off

- The dash cam will automatically power on and begin recording when your vehicle's ignition is turned on (if connected to ACC power).

- It will automatically power off shortly after the ignition is turned off.

4.2 Recording Modes

- **Loop Recording:** The dash cam continuously records video in short segments (e.g., 1, 3, or 5 minutes). When the memory card is full, it automatically overwrites the oldest unlocked footage.
- **G-Sensor (Emergency Recording):** In the event of a sudden impact or collision, the built-in G-sensor will detect the event and automatically lock the current video segment, preventing it from being overwritten by loop recording.
- **Parking Monitoring:** When the vehicle is parked and the hardwire kit is installed, the dash cam can monitor for motion or impacts. If an event is detected, it will automatically record and save the footage.

4.3 Using WiFi and App Control

The Sarmert C2 dash cam features built-in 2.4GHz and 5G WiFi for easy access to recordings and settings via a mobile application.

1. Download the official Sarmert app (e.g., 'RoadRec' or similar, check product packaging for exact app name) from the App Store or Google Play.
2. Enable WiFi on your dash cam through its menu settings.
3. On your smartphone, connect to the dash cam's WiFi network (SSID and password usually displayed on the dash cam screen).
4. Open the app to view live footage, playback recorded videos, download files to your phone, and adjust dash cam settings.

4.4 GPS Functionality

The built-in GPS module records your vehicle's driving route and speed. This data can be viewed using a complimentary GPS player software on your PC or Mac. Refer to the Sarmert website or app for details on downloading the GPS player.

5. MAINTENANCE

- **Cleaning:** Use a soft, dry cloth to clean the dash cam lens and screen. Do not use liquid cleaners or abrasive materials.
- **Memory Card:** Format the microSD card regularly (e.g., once a month) through the dash cam's settings to ensure optimal performance and prevent data corruption. Use a high-quality Class 10 or U3 microSD card.
- **Firmware Updates:** Check the Sarmert official website or app periodically for firmware updates. Keeping your dash cam's firmware updated can improve performance and add new features.
- **Temperature:** Avoid exposing the dash cam to extreme temperatures for prolonged periods.

6. TROUBLESHOOTING

6.1 Common Issues and Solutions

- **Dash Cam Not Powering On:**

Solution: Check the power connection. Ensure the hardwire kit is correctly installed and receiving power from the vehicle's fuse box. Verify the USB-C cable is securely plugged into the dash cam.

- **Parking Monitor Not Working:**

Solution: Ensure the hardwire kit is correctly installed with both ACC and BAT+ connections. Verify that

parking monitoring is enabled in the dash cam's settings. Check the low voltage protection setting to ensure it's not cutting power prematurely.

• **Video Footage is Blurry/Unclear:**

Solution: Clean the dash cam lens with a soft cloth. Ensure the protective film (if any) has been removed from the lens. Check if the windshield area in front of the camera is clean. Verify the video resolution settings in the dash cam menu.

• **Memory Card Error/Full:**

Solution: Format the microSD card through the dash cam's settings. If the issue persists, try a different high-quality microSD card (Class 10 or U3 recommended). Ensure loop recording is enabled.

• **WiFi Connection Issues:**

Solution: Ensure WiFi is enabled on the dash cam. Restart both the dash cam and your smartphone. Make sure you are connecting to the correct WiFi network broadcasted by the dash cam. Try reinstalling the mobile application.

7. SPECIFICATIONS

Feature	Specification
Model Name	C2
Video Capture Resolution	2160p (4K)
Connectivity Technology	USB-C, Wireless (WiFi)
Mounting Type	Dashboard Mount
Hardwire Kit Input Voltage	12V-24V
Hardwire Kit Output Voltage/Current	5V/2.5A
Display Type	LED
Included Components	Hardwire Kit
Color	Black
Vehicle Service Type	Car, Truck, Van, SUV, Motorcycle

8. WARRANTY AND SUPPORT

Sarmert products are designed for reliability and performance. For warranty information, technical support, or service inquiries, please refer to the contact details provided on the official Sarmert website or the product packaging. Please retain your proof of purchase for warranty claims.

For the latest information and support, visit the official Sarmert store:[Sarmert Store on Amazon](#)



