



Manuals.plus /

› Roinvou /

› Roinvou 2+64G Android Car Radio for KIA Picanto TA 2011-2016 with Wireless CarPlay and Android Auto Instruction Manual

Roinvou A7226A3796A4MI2EU31T

Roinvou 2+64G Android Car Radio Instruction Manual

For KIA Picanto TA (2011-2016) with Wireless CarPlay and Android Auto

[Introduction](#) [Setup](#) [Operation](#) [Maintenance](#) [Troubleshooting](#) [Specifications](#) [Warranty & Support](#)

1. INTRODUCTION

This manual provides detailed instructions for the installation, operation, and maintenance of your Roinvou 2+64G Android Car Radio. This unit is designed specifically for KIA Picanto TA models manufactured between 2011 and 2016, offering advanced features such as wireless CarPlay, Android Auto, GPS navigation, Bluetooth connectivity, and a 9-inch full HD touchscreen display.

Please read this manual thoroughly before installation and use to ensure proper function and to maximize your experience with the product. Keep this manual for future reference.

2. COMPATIBLE MODELS

This Roinvou Android Car Radio is compatible with the following vehicle model:

- KIA Picanto TA (2011-2016)

The unit features a 9-inch capacitive touchscreen with 2GB RAM and 64GB internal storage, running an updated Android system.

3. SETUP AND INSTALLATION

3.1. Package Contents

Verify that all items are present in the package before beginning installation:



Image showing the main head unit, power cable, RCA cable, USB cable, installation tool, GPS antenna, microphone, and rear camera.

- Roinvou Android Car Radio Head Unit (9-inch screen)
- Power Cable
- RCA Cable
- USB Cable
- Installation Tool
- GPS Antenna
- Microphone
- Rear Camera (AHD)
- Reverse Line
- Accessories (various connectors and mounting hardware)

3.2. Wiring and Connections

Refer to the wiring diagram for proper connection of all cables. Ensure all connections are secure before powering on the unit.



Diagram illustrating the wiring ports for the power cable, RCA cable, USB cable, camera input, and GPS antenna.

- **Power Cable:** Connect to the vehicle's power harness.
- **RCA Cable:** For audio/video input/output connections.
- **USB Cable:** For data transfer, charging, and Android Auto/CarPlay wired connections.
- **Camera Input:** Connect the provided AHD rear camera.
- **GPS Antenna:** Mount in a location with clear sky view for optimal signal reception.

3.3. Rear Camera Wiring

Properly connect the reversing camera as shown in the diagram. The reverse input cable must be plugged in even if

the camera is not used, as it affects Bluetooth and Wi-Fi signal reception.

Wiring Port

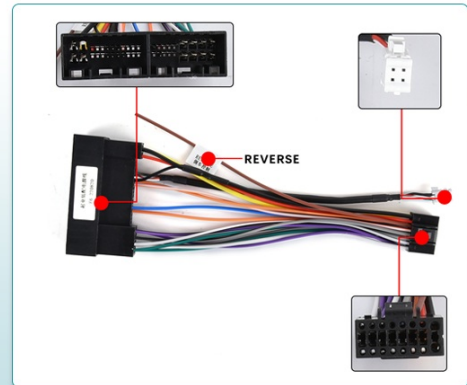
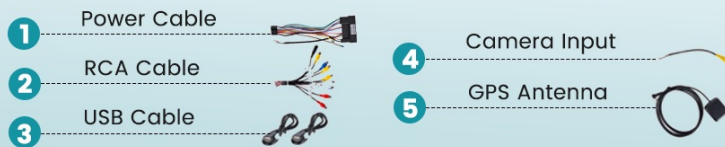

Diagram showing how to connect the red cable to the positive terminal of the car's reverse light cable and the black cable to the negative terminal. The other two red extension cables are not needed.

- **Red Cable (①):** Connects to the positive terminal of the car's reverse light cable.
- **Black Cable (②):** Connects to the negative terminal of the car's reverse light cable.
- **Note:** There is no need to connect the other two red extension cables (③ and ④).

3.4. CANBUS Connection (Steering Wheel Control)

The method for enabling steering wheel controls depends on whether your vehicle uses a CANBUS decoder.

How to Connect the Backup Camera ?

Tip: The reverse input cable must be plugged in even if the reverse camera is not being used. Otherwise it will affect Bluetooth and WiFi signal reception.

Reversing Camera Wiring

Red Cable ①: Connects to the positive terminal of the car's reverse light cable.

Black Cable ②: Connects to the negative terminal of the car's reverse light cable.

There is no need to connect the other two red extension cables ③ and ④.

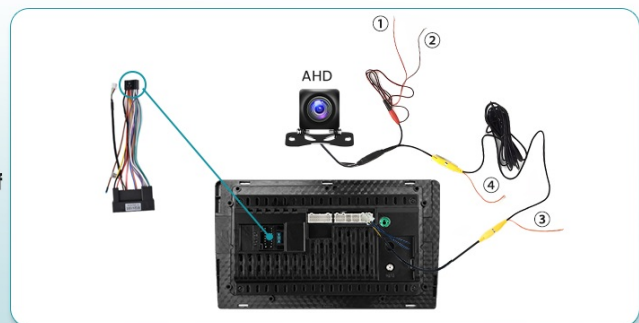

Instructions for connecting CANBUS, detailing steps for vehicles with and without a CANBUS decoder to enable steering wheel controls.

Without CANBUS Decoder:

Connect the plugs or the steering wheel control wires (Key1/Key2) in the power cable to the corresponding port or wire of your original car. Then, navigate to *Settings > Car Settings > General (Enter SWC setting interface)* and perform a manual match to activate the button functions.

With CANBUS Decoder:

Connect the CANBUS before powering on the machine. Then, navigate to *Settings > Car Settings > Factory (000000) > CarType Setting* to ensure SWC works properly. First, select the brand of the CANBUS decoder, then select the matching model and year according to the actual situation.

4. OPERATING INSTRUCTIONS

4.1. CarPlay & Android Auto & Mirror Link

The unit supports both wired and wireless connections for Apple CarPlay and Android Auto, as well as Mirror Link functionality.

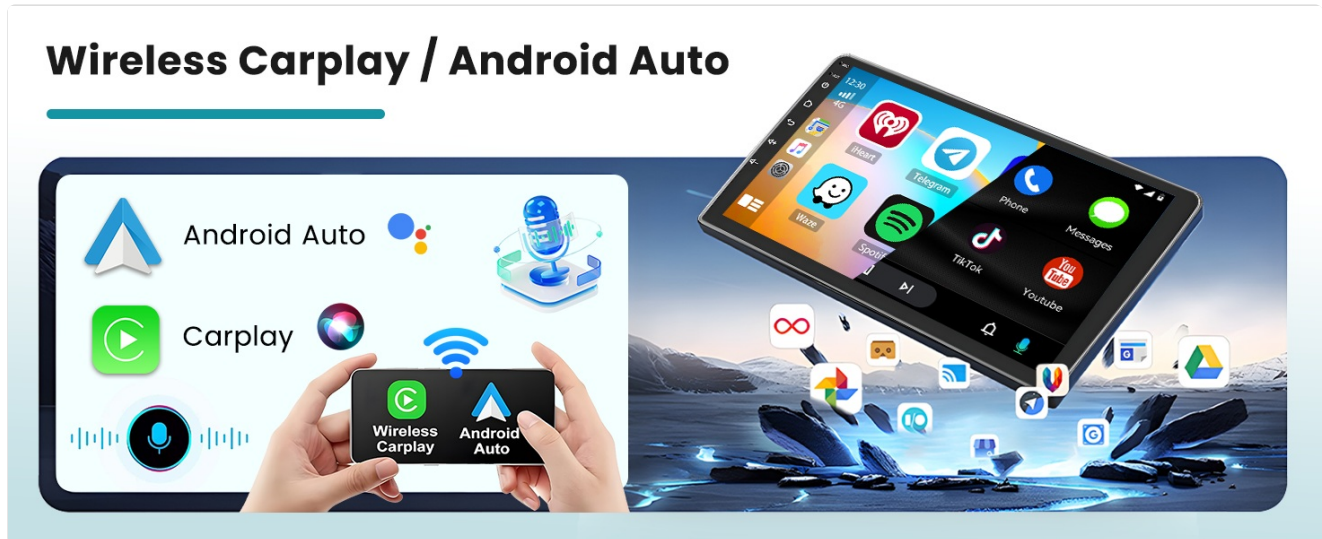

Image displaying the icons for Apple CarPlay, Android Auto, and Mirror Link, indicating support for both wireless and wired connections via Bluetooth and USB.

- **Apple CarPlay (Wireless/Wired):** Connect your iPhone via Bluetooth for wireless CarPlay or via USB for wired connection. Access navigation, music, calls, and messages.
- **Android Auto (Wireless/Wired):** Connect your Android phone via Bluetooth for wireless Android Auto or via USB for wired connection. Access navigation, music, calls, and Google Assistant.
- **Mirror Link:**
 - **iOS Phones:** Connect via Wi-Fi for one-way control projection (phone screen displayed on head unit).
 - **Android Phones:** Connect via USB and Wi-Fi for two-way control (control phone from head unit and vice-versa).

4.2. GPS Navigation & Wi-Fi Connection

The unit features integrated GPS for navigation and Wi-Fi for online services.

Steering Wheel Control & AHD Rear View Camera

Upgrade your driving with steering wheel control and AHD reversing screen display with precision and safety in your hands.

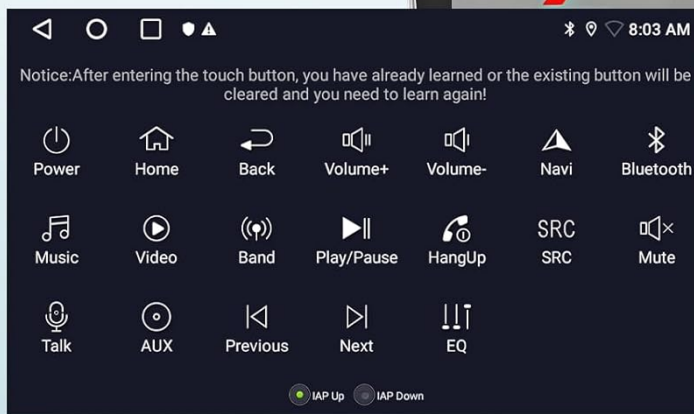
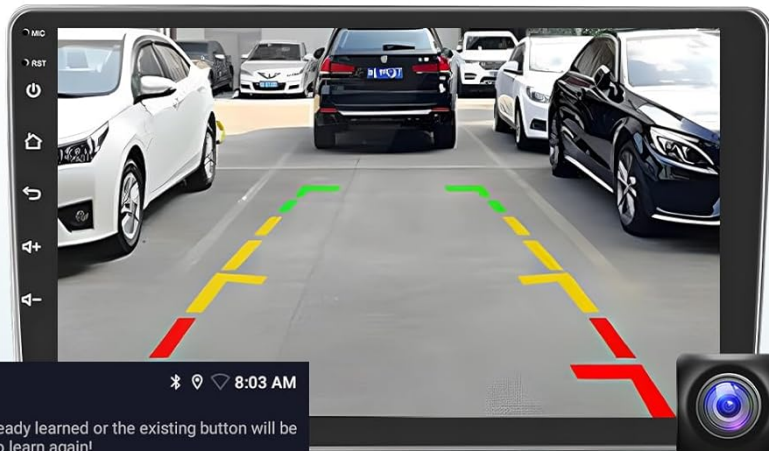
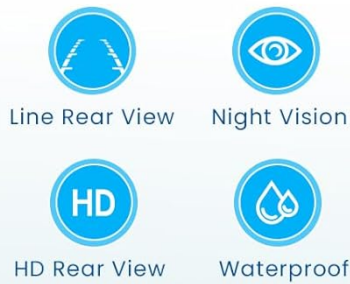

Image showing the car radio display with a navigation map, along with icons for music and video streaming, and a car driving on a road with GPS signals.

- **GPS Navigation:** Supports both online and offline navigation. You can download offline maps from the Play Store.
- **Wi-Fi:** Connect to a Wi-Fi hotspot to access online maps, download applications, stream music, and watch live TV programs.

4.3. Bluetooth & EQ Settings

Utilize Bluetooth for hands-free communication and customize your audio experience with the equalizer.

Hands-free Bluetooth & FM/RDS Radio

Support Bluetooth hands-free calling, Bluetooth music playback and auto-loading phone book. Stable FM/RDS radio provides channel broadcasting, weather forecasts, and real-time traffic conditions.



Image showing the car radio display during a Bluetooth call, a phone displaying a call, a Bluetooth logo, and an FM radio interface with EQ settings.

- **Bluetooth:**

- **Hands-Free Calling:** Make and receive calls directly from the unit with clear audio.
- **Music Streaming:** Stream audio from your paired device. Song titles and artist names will display on the touchscreen.
- **Phone Book:** Auto-loading phone book for easy access to contacts.

- **EQ (Equalizer):** Customize sound output with various preset sound modes (Classic, Pop, Rock, Jazz, etc.) or create your own custom settings.

4.4. Steering Wheel Control (SWC)

Once properly configured (refer to Section 3.4), your vehicle's steering wheel controls can be used to operate the car radio, enhancing driving safety.

GPS Navigation & WiFi Connection

You can purchase directly from play store for offline navigation. With wifi connected, Google Maps can be used perfectly, you can go anywhere you want and never get lost again.



Image showing a car radio display with a rear view camera feed, icons for various functions like volume, navigation, and Bluetooth, and a steering wheel with control buttons.

- Activate SWC in the settings menu to map your steering wheel buttons to functions like volume control, track skipping, and call management.

4.5. FM/RDS Radio

Enjoy high-quality radio broadcasts with FM/RDS functionality.

- **FM/RDS Reception:** Tune into your favorite FM stations. RDS (Radio Data System) provides additional information such as station name, song title, and traffic announcements where available.
- The radio offers optimized sound quality for an enhanced listening experience.

4.6. User Interface Themes

Personalize your car radio's appearance with a variety of user interface themes.

26UI Themes & EQ Settings

Support multiple EQ options and 26 desktop themes, allows you to enjoy a superior music listening experience and switch your favorite user interface style.



Image showcasing multiple desktop interface themes and detailed equalizer settings available on the car radio.

- The unit supports 26 different desktop interface themes, allowing you to select a style that suits your preference.
- **Split Screen:** The split-screen function allows simultaneous use of two applications, such as navigation and music playback.

5. MAINTENANCE

To ensure the longevity and optimal performance of your Roinvou Android Car Radio, follow these maintenance guidelines:

- **Screen Cleaning:** Use a soft, lint-free cloth to gently wipe the touchscreen. For stubborn smudges, slightly dampen the cloth with water or a screen-safe cleaner. Avoid abrasive materials or harsh chemicals.
- **Software Updates:** Periodically check for available software updates through the unit's settings menu. Updates can improve performance, add new features, and fix bugs.
- **Environmental Conditions:** Avoid exposing the unit to extreme temperatures, direct sunlight for prolonged periods, or excessive moisture.
- **Cable Connections:** Regularly check all cable connections to ensure they are secure and free from damage.

Loose connections can lead to intermittent issues.

- **Ventilation:** Ensure the unit's ventilation areas are not blocked to prevent overheating.

6. TROUBLESHOOTING

If you encounter issues with your car radio, refer to the following common problems and solutions:

Problem	Possible Cause	Solution
Unit does not power on.	Loose power connection, blown fuse, vehicle battery issue.	Check power cable connections. Inspect vehicle fuses. Ensure vehicle battery is charged.
No sound output.	Volume too low, mute activated, incorrect audio source, loose speaker wires.	Increase volume. Check if mute is active. Select correct audio source. Verify speaker wire connections.
GPS signal is weak or lost.	GPS antenna improperly installed or obstructed.	Ensure GPS antenna is mounted in a clear, unobstructed location. Check antenna connection.
Bluetooth/Wi-Fi issues.	Incorrect pairing, interference, reverse input cable not connected.	Re-pair device. Ensure no other devices are interfering. Verify the reverse input cable is connected (even if no camera is used).
Steering wheel controls not working.	Incorrect wiring, CANBUS settings not configured.	Refer to Section 3.4 for CANBUS and wiring instructions. Reconfigure SWC settings.
Touchscreen unresponsive.	Software glitch, screen damage.	Restart the unit. If issue persists, contact customer support.

If the problem persists after attempting these solutions, please contact Roinvou customer support for further assistance.

7. PRODUCT SPECIFICATIONS

Feature	Detail
Brand	Roinvou
Model Number	A7226A3796A4MI2EU31T
Compatible Car Models	KIA Picanto TA (2011-2016)
Screen Size	9 inches
Memory (RAM)	2GB
Storage (ROM)	64GB
Operating System	Android (updated system)
Connectivity Technology	Bluetooth, USB, Wi-Fi, FM RDS
Special Features	CarPlay, Android Auto, Mirror Link, EQ, GPS, SWC, 26 UI Themes, Touchscreen
Compatible Devices	Smartphone
Connector Type	RCA, USB Type A
Audio Output Mode	APE/FLAC/WAV/MP3/WMA
Surround Sound Channels	4
Video Encoding	MKV/RMVB/AVI/MP4/MDV
Output Power	45 Watts

8. WARRANTY AND SUPPORT

Roinvou provides comprehensive support for its products.

- **Manufacturer Warranty:** The product comes with a **24-month manufacturer warranty**.
- **Online Support:** Lifetime online assistance is available for inquiries.
- **Response Time:** Support inquiries are typically responded to within 24 hours.
- **Seller:** wenheyou (Fulfilled by Amazon)

For warranty claims or technical assistance, please contact the seller or Roinvou customer service directly.