

SSUPD Meshroom S V2 No PCIe

SSUPD Meshroom S V2 Mini-ITX Gaming PC Case User Manual

Model: Meshroom S V2 No PCIe

- Introduction
- Features
- Specifications
- Setup
- Operating
- Maintenance
- Troubleshooting
- Warranty & Support

1. INTRODUCTION

This manual provides comprehensive instructions for the SSUPD Meshroom S V2 Mini-ITX Gaming PC Case. It covers product features, specifications, setup procedures, operation guidelines, maintenance tips, and troubleshooting information to ensure optimal performance and longevity of your PC case.

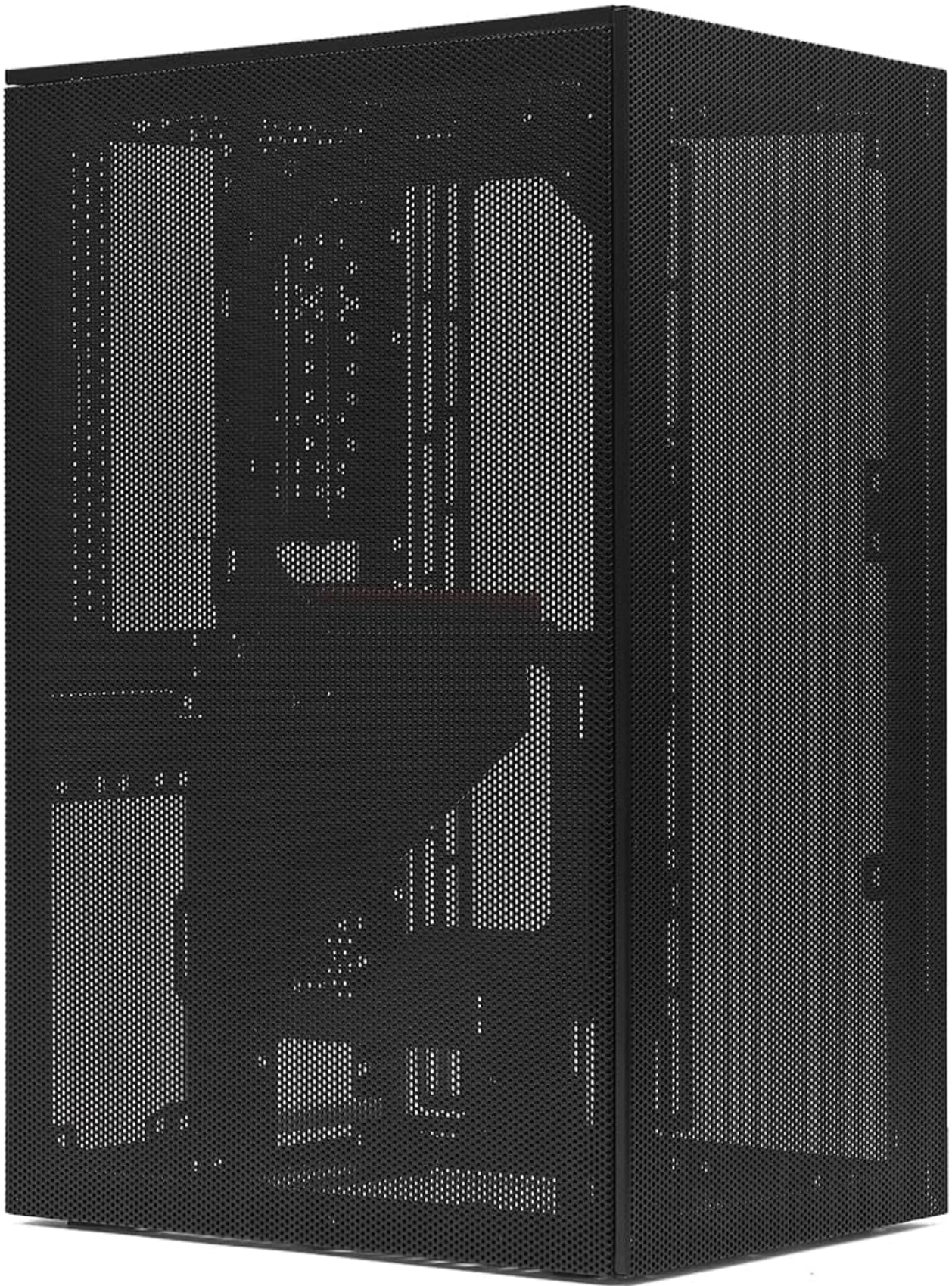

Figure 1.1: Front view of the SSUPD Meshroom S V2 PC Case, showcasing its full mesh design for superior airflow.

2. KEY FEATURES

- **Ultra-Compact 15L Design:** Maximizes performance within a minimal footprint, ideal for small form factor builds.
- **Flexible Motherboard Support:** Features an adjustable internal motherboard tray compatible with ITX, MATX, and ATX motherboards. Note: MATX and ATX setups may require an extra-length PCIe riser cable.

- **Extensive GPU Compatibility:** Supports 4-slot GPUs up to 152mm in width. With optional 30-50mm aluminum feet, it accommodates GPU lengths up to 353mm, suitable for high-end RTX 5090 and Radeon graphics cards.
- **Advanced Cooling Options:** Compatible with 240/280mm AIO liquid coolers on the front mounting bracket. Supports dual-radiator custom loop designs and DDC pumps. CPU cooler height is limited to a maximum of 74mm.
- **Versatile PSU Support:** Accommodates SFX, SFX-L, or ATX power supplies up to 170mm in length.
- **Superior Airflow:** Features fully breathable mesh panels on all sides to ensure excellent ventilation and thermal performance.
- **Tool-less Design:** External panels are tool-less for easy assembly and maintenance. Constructed from high-quality powder-coated SGCC steel.
- **Front I/O Ports (Variant B):** Includes 1x USB 3.2 Gen 2 Type-C (20 Gbps), 1x USB 3.0 Type-A (5 Gbps), and a power button for convenient connectivity.



Figure 2.1: Internal view of the Meshroom S V2, demonstrating component layout and fan mounting options.

3. SPECIFICATIONS

Attribute	Detail
-----------	--------

Attribute	Detail
Brand	SSUPD
Model Name	Meshroom S V2 No PCIe
Case Type	Mini-Tower (SFF)
Color	Black 2
Item Weight	9.79 pounds (4.45 Kilograms)
Package Dimensions	17.13 x 12.4 x 7.68 inches
Motherboard Compatibility	Mini ITX, Micro ATX, ATX
GPU Compatibility	4-Slot, up to 353mm length (with optional feet), 152mm width
CPU Cooler Height	Max 74mm
PSU Support	SFX, SFX-L, ATX (up to 170mm)
Cooling Method	Air, Water (240/280mm AIO support)
Front I/O Ports	1x USB 3.2 Gen 2 Type-C (20 Gbps), 1x USB 3.0 Type-A (5 Gbps), Power Button
Total Internal Bays	2



Figure 3.1: Detailed view of internal component placement, including GPU and cooling fans.

4. SETUP GUIDE

Follow these general steps to set up your SSUPD Meshroom S V2 PC case. Refer to your component manuals for specific installation details.

1. **Unpacking:** Carefully remove the PC case from its packaging. Inspect for any shipping damage.
2. **Panel Removal:** The external panels are tool-less. Gently pull them off to access the interior.
3. **Motherboard Installation:** Install your Mini-ITX, Micro-ATX, or ATX motherboard onto the adjustable motherboard tray. Secure it with screws. Adjust the tray position as needed for larger motherboards.

4. **CPU Cooler Installation:** Install your CPU cooler. Ensure it does not exceed the maximum height of 74mm.
5. **Power Supply Installation:** Mount your SFX, SFX-L, or ATX power supply (up to 170mm) in the designated area.
6. **GPU Installation:** Install your graphics card. The case supports 4-slot GPUs. If using a larger GPU or ATX motherboard, ensure you have the necessary PCIe riser cable (not included with this specific model).
7. **Storage Installation:** Install any SSDs or HDDs into the available internal bays.
8. **Cable Management:** Route all power and data cables neatly to ensure optimal airflow and a clean build.
9. **Cooling System Installation:** Install any additional fans or AIO liquid cooling systems. The front bracket supports 240/280mm AIOs.
10. **Panel Reinstallation:** Once all components are installed and cables managed, reattach the external mesh panels.



Figure 4.1: Example of a liquid cooling setup within the Meshroom S V2 case.

5. OPERATING INSTRUCTIONS

The SSUPD Meshroom S V2 PC case is designed for continuous operation once components are properly installed. Ensure the following for optimal performance:

- **Power On:** Connect the power cable to the power supply unit and press the power button on the front I/O panel.
- **Ventilation:** Due to its full mesh design, ensure the case has adequate clearance around all sides for unrestricted airflow. Avoid placing the case in enclosed spaces.
- **Temperature Monitoring:** Regularly monitor component temperatures using system monitoring software to

ensure efficient cooling.

- **Cable Management:** Proper internal cable management is crucial for maintaining good airflow and preventing overheating.



Figure 5.1: Different internal configurations possible with the Meshroom S V2, highlighting flexibility.

6. MAINTENANCE

Regular maintenance helps preserve the performance and appearance of your SSUPD Meshroom S V2 PC case.

- **Dust Cleaning:** Periodically clean dust from the mesh panels and internal components using compressed air or a soft brush. The mesh design allows for easy dust accumulation, but also easy cleaning.
- **External Cleaning:** Wipe the exterior surfaces with a soft, damp cloth. Avoid abrasive cleaners or solvents.
- **Fan Inspection:** Check cooling fans for dust buildup and ensure they are spinning freely. Clean or replace as necessary.
- **Cable Check:** Occasionally inspect internal cables to ensure they remain securely connected and properly routed.



Figure 6.1: Internal view showing the power supply and GPU, areas that benefit from regular dust removal.

7. TROUBLESHOOTING

This section addresses common issues you might encounter with your PC case.

Problem	Possible Cause	Solution
PC does not power on.	Loose power connections, faulty power supply, incorrect front panel header connection.	Check all power cables (wall outlet, PSU, motherboard). Ensure front panel power switch header is correctly connected to the motherboard. Test PSU if possible.
Overheating components.	Poor airflow, dust buildup, insufficient cooling.	Ensure case has adequate ventilation. Clean dust from mesh panels and fans. Verify all fans are operating correctly. Consider adding more fans or upgrading cooling solutions if temperatures remain high.
Front I/O ports not working.	Loose or incorrect internal cable connections.	Check the USB 3.0 and USB Type-C headers connected to the motherboard. Ensure they are fully seated and correctly oriented.
Difficulty installing large components (e.g., GPU, AIO).	Clearance issues, incorrect motherboard tray position, missing accessories.	Refer to the specifications for maximum component dimensions. Adjust the motherboard tray if necessary. Ensure you have the correct PCIe riser cable for larger GPUs or ATX motherboards.

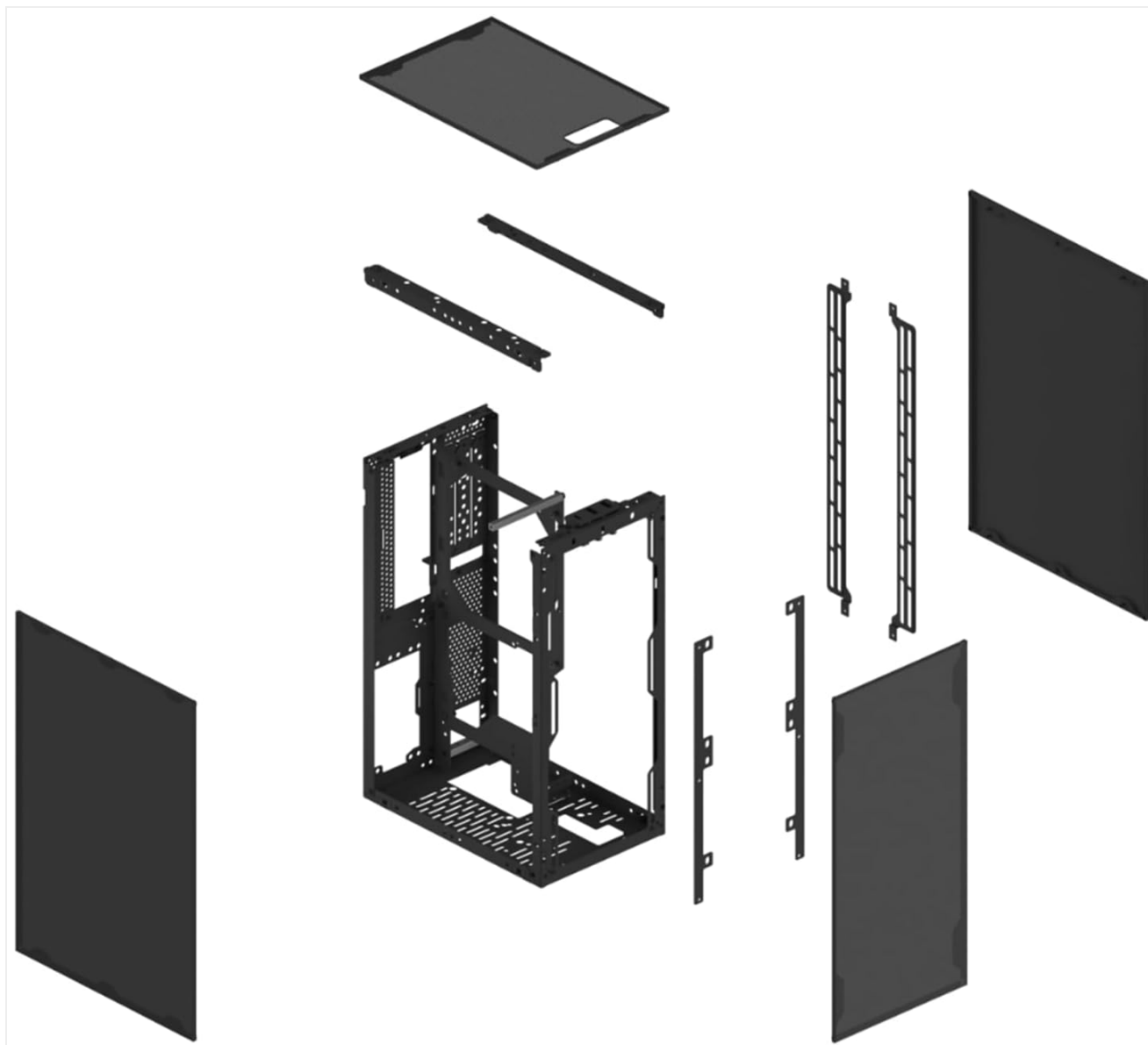





Figure 7.1: Exploded diagram showing the modular components of the Meshroom S V2, useful for assembly and troubleshooting.

8. WARRANTY & SUPPORT

For warranty information and technical support, please refer to the official SSUPD website or contact their customer service. Keep your proof of purchase for warranty claims.

Additional protection plans may be available for purchase. For details on these plans, please refer to the product listing on Amazon or contact Amazon customer service.

- **Manufacturer Support:** For product-specific inquiries, visit the [SSUPD Store on Amazon](#).
- **Protection Plans:** Information on available protection plans can be found on the product page or by searching for ASINs like [B07NTRRGKS \(3-Year Protection Plan\)](#) or [B07Q478Y95 \(4-Year Protection Plan\)](#).

	<p>SSUPD Meshroom S V2 PC Case User Guide</p> <p>User guide for the SSUPD Meshroom S V2 PC case. Features detailed specifications, component compatibility, and step-by-step build instructions for ITX and ATX/MATX configurations. Includes model numbers CS-MRS-P5-BK and CS-MRS-P5-WT.</p>
	<p>Meshroom D PC Case: User Guide for Variant A</p> <p>This user guide provides comprehensive information on the ssupd Meshroom D PC case, including detailed specifications, step-by-step build guides for ITX and MATX configurations with air or water cooling, case component overview, and accessory contents.</p>
	<p>SSUPD Meshroom D PC Case: User Guide & Build Instructions</p> <p>Explore the SSUPD Meshroom D PC case with this comprehensive user guide. Discover detailed specifications, compatibility, case overview, and build instructions for ITX and MATX systems, including air and water cooling setups.</p>
	<p>Meshroom S V2 Advance User Guide: Variant B</p> <p>Detailed installation and customization guide for the ssupd Meshroom S V2 PC case. Learn how to build high-performance PCs with custom water cooling, ATX/ITX motherboards, and various component configurations.</p>