

Letaya R694

Letaya Metal Storage Cabinet User Manual

Model: R694

1. INTRODUCTION

Thank you for choosing the Letaya Metal Storage Cabinet. This manual provides essential information for the safe and efficient assembly, operation, and maintenance of your new storage unit. Please read these instructions thoroughly before beginning assembly or use to ensure proper functionality and longevity of the product.

2. SAFETY INFORMATION

- Always assemble the cabinet on a flat, stable surface to prevent tipping.
- Ensure all screws and fasteners are securely tightened before use. Periodically check and re-tighten as necessary.
- Do not overload shelves. Adhere to the maximum weight capacity specified in the 'Specifications' section.
- Keep small parts and assembly tools away from children during assembly.
- When moving the cabinet, especially with contents, ensure the detachable wheels are securely locked or removed if not in use.
- Avoid placing heavy objects on the top of the cabinet that could cause instability.
- For added stability, consider mounting the cabinet to a wall using the pre-drilled holes on the back, especially in areas prone to seismic activity or if children are present.

3. PACKAGE CONTENTS

Before assembly, verify that all components are present and undamaged. If any parts are missing or damaged, please contact customer support.

- Storage Cabinet Panels (sides, top, bottom, back, doors)
- Adjustable Shelves (4 included)
- Detachable 360° Rolling Wheels (4 included)
- Locking Mechanism with 2 Keys
- Assembly Hardware (screws, nuts, bolts)
- Installation Tools (screwdriver, wrench)
- Detailed Assembly Instructions

4. ASSEMBLY INSTRUCTIONS

Assembly typically takes approximately 30 minutes. Follow the step-by-step instructions provided in the included assembly guide. It is recommended to have a second person assist with certain steps, especially when aligning larger panels.



This diagram illustrates the overall dimensions and individual shelf weight capacity of the cabinet, along with an estimated assembly time of 30 minutes.



An overview of the fully assembled cabinet, highlighting its spacious interior and the included detachable wheels.

Key Assembly Tips:

- Lay out all parts and identify them using the labels (A, B, C, D, etc.) before starting. If labels are missing, refer to the diagrams in the manual.
- Ensure panels are oriented correctly before tightening screws. Incorrect alignment can make subsequent steps difficult.
- While power tools can speed up assembly, use them with caution and low torque settings to avoid stripping screws or damaging the metal. The included manual screwdriver and wrench are sufficient.
- The most challenging part for some users is connecting the two side panels after attaching the back panel. It may be easier to stand the unit upright for certain screw placements.
- Install the doors as the final step of the main cabinet assembly.

5. PRODUCT FEATURES AND OPERATION

5.1 Durable Metal Construction

The cabinet is constructed from 0.8mm thick steel, providing ruggedness and resistance to deformation. The environmentally friendly powder-coated finish offers protection against moisture, corrosion, and rust, ensuring long-term durability.

5.2 Adjustable Shelves

The cabinet features four adjustable shelves, allowing you to customize the storage space to accommodate items of various heights. Each shelf can hold up to 180 lbs, providing robust support for tools, supplies, and other heavy items.



HEIGHT ADJUSTABLE STORAGE SHELVES

Adjust the cross bars according to different heights

This image demonstrates the adjustability of the shelves, allowing for flexible storage configurations.

5.3 Secure Locking System

An upgraded three-point lock system with thickened steel rods provides enhanced security for your valuables. The doors also feature anti-collision reinforcements, ensuring quiet operation and protecting the cabinet when opening or closing.

PRODUCT DIMENSION



Magnetic Door

easily to close



2 KEYS

Make it safer to use



Loading Capacity

Shelves Hold 120 LBS



Detachable 360° Rolling Wheels

The detachable wheels can be installed or removed as needed.



This graphic highlights the magnetic door for easy closure, the inclusion of two keys for the lock, the loading capacity of shelves, and the detachable 360° rolling wheels.

5.4 Detachable 360° Rolling Wheels

The cabinet is equipped with four detachable 360° rolling wheels, offering easy mobility. These wheels can be installed or removed based on your needs, providing flexibility for placement and rearrangement. The wheels are designed for quiet operation and compatibility with various floor types.



Detachable 360° Rolling Wheels

The detachable wheels can be installed or removed as needed.



A close-up view of the detachable 360° rolling wheels, emphasizing their lockable function for stability when stationary.



The wheels are detachable, allowing you to install or remove them based on your needs.

This image shows the cabinet being easily moved on its wheels, highlighting their practical utility in a dynamic environment.

6. USAGE AND PLACEMENT

The Letaya Metal Storage Cabinet is versatile and suitable for various environments, including homes, offices, garages, schools, shops, and warehouses. Its robust construction and adjustable shelving make it ideal for organizing tools, documents, supplies, and other items.



Multiple Function Storage Cabinet



This composite image demonstrates the cabinet's adaptability for use in diverse settings such as an office, living room, and garage.



The cabinet integrated into an office space, showcasing its utility for professional storage.

The cabinet positioned in a garage, demonstrating its capacity for organizing tools and workshop items.

7. MAINTENANCE AND CARE

- Cleaning:** Wipe the cabinet surfaces with a soft, damp cloth. Avoid abrasive cleaners or harsh chemicals that could damage the powder-coated finish.
- Rust Prevention:** While the cabinet is moisture-proof and rust-resistant, avoid prolonged exposure to excessive moisture or corrosive substances. Promptly clean any spills.
- Hardware Check:** Periodically inspect all screws and fasteners to ensure they remain tight. Re-tighten if any looseness is detected.
- Shelf Capacity:** Do not exceed the maximum weight capacity of 180 lbs per shelf to prevent bending or damage.

8. TROUBLESHOOTING

- Difficulty during Assembly:** If parts do not align easily, double-check the orientation of the panels against the assembly instructions. Ensure no screws are overtightened prematurely, which can cause misalignment.
- Cabinet Instability:** Ensure the cabinet is placed on a level surface. If using wheels, ensure all four wheels are locked when stationary. For permanent stability, consider wall mounting using the pre-drilled holes.
- Dings or Minor Imperfections:** The packaging includes foam and metal corners to protect against shipping damage. In the event of minor dings, these are typically cosmetic and do not affect the structural integrity or functionality of the cabinet.
- Doors Not Closing Properly:** Check that the cabinet is level and square. Ensure the magnetic door catches are clean and unobstructed. Verify the locking mechanism is properly installed and lubricated if necessary.

9. SPECIFICATIONS

Attribute	Detail
Brand	Letaya
Model Name	R673 (Cabinet), R694 (Item Model Number)
Color	Black
Product Dimensions (D x W x H)	15.75"D x 31.49"W x 75"H
Size (Specific Variant)	16"D x 32"W x 74.41"H
Material	Metal (0.8mm Steel)
Finish Type	Powder Coated
Number of Shelves	4 (Adjustable)
Shelf Weight Capacity	Up to 180 lbs per shelf
Item Weight	75 Pounds
Mounting Type	Floor Mount (Wall mountable with pre-holes)



Lock Type	Key (Three-point lock system)
Special Features	Adjustable Feet, Adjustable Shelf, Lockable, Detachable 360° Rolling Wheels

10. WARRANTY AND SUPPORT

Letaya is committed to providing high-quality products. For any questions, concerns, or assistance with your metal storage cabinet, please refer to the contact information provided with your purchase or visit the official Letaya website for customer support. Please retain your proof of purchase for any warranty claims.

This product is typically covered by a manufacturer's warranty against defects in materials and workmanship. Specific warranty terms and duration may vary; please consult your purchase documentation for details.

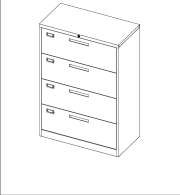
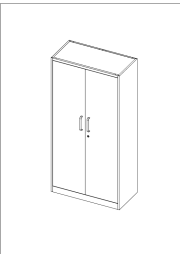
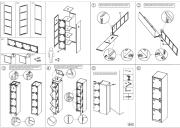
Related Documents - R694

<div><div>4 Drawer Lateral File Cabinet Installation Instructions</div></div>	<div>4 Drawer Lateral File Cabinet Installation Instructions</div> <div>Step-by-step instructions for installing a 4-drawer lateral file cabinet, including assembly, locking, and troubleshooting.</div>
<div></div>	<div>Letaya Metal Storage Cabinet Assembly Instructions Step-by-Step Guide</div> <div>Detailed, step-by-step assembly instructions for the Letaya Metal Storage Cabinet. Learn how to assemble your steel locker with this easy-to-follow guide, including parts list and visual descriptions.</div>
<div></div>	<div>Letaya Metal Storage Locker Assembly Instructions</div> <div>Step-by-step guide for assembling the Letaya Metal Storage Locker, including parts list and installation details for a secure and functional storage solution.</div>
<div><div>2 Drawer Lateral File Cabinet Installation Instructions</div></div>	<div>2-Drawer Lateral File Cabinet Installation Instructions</div> <div>Step-by-step guide for installing a 2-drawer lateral file cabinet, including assembly, locking mechanisms, and troubleshooting.</div>

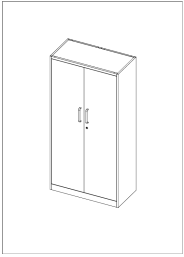

[Letaya Metal Storage Cabinet Assembly Instructions](#)

Comprehensive guide for assembling the Letaya Metal Storage Cabinet, including detailed steps, part identification, and hardware usage.

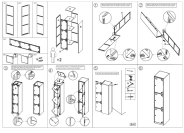

[Letaya Metal Locker 3-Door Installation Manual | 71" Steel Storage Cabinet](#)

Comprehensive installation guide for the Letaya 71-inch tall, 3-door metal locker. This steel storage cabinet is designed for school, office, gym, and home use. Follow these step-by-step instructions for proper assembly.