

ATOTOZONE CB6

ATOTOZONE CB6 AI Box Wireless CarPlay & Android Auto Adapter User Manual

1. INTRODUCTION

The ATOTOZONE CB6 AI Box is designed to upgrade your vehicle's wired CarPlay or Android Auto system to a wireless experience. It also integrates a full Android 13 operating system into your car stereo, providing access to various applications, GPS navigation, and 4G LTE connectivity. This manual provides detailed instructions for setup, operation, and maintenance of your CB6 device.

2. PRODUCT OVERVIEW

2.1 Package Contents

- CB6 AI Box Unit
- USB C-to-C Cable
- USB A-to-C Cable
- Y-shaped Cable (for specific vehicle models)
- SIM Eject Tool
- Online Resources Quick Guide
- Product Care Online Support Pamphlet

2.2 Device Features

The CB6 AI Box offers the following key features:

- **Wireless CarPlay & Android Auto:** Converts existing wired connections to wireless.
- **Integrated Android 13 OS:** Provides a full Android environment on your car stereo.
- **4G LTE Connectivity:** Supports internet access via an IoT SIM card (not included).
- **Dual Bluetooth:** Bluetooth 1 for phone connection, Bluetooth 2 for internet access and device connections.
- **Built-in GPS:** For navigation applications.
- **4GB RAM + 64GB Storage:** Ensures smooth operation and ample space for apps.

- **Expandable Storage:** Supports TF cards up to 256GB.
- **Custom Software:** Includes DriveChat (ChatGPT-powered voice assistant) and TrackHU (GPS tracker).
- **OTA Updates:** Continuous feature additions and system improvements.



Image 2.1: The ATOTOZONE CB6 AI Box, showcasing its compact design and the user interface on a car display, highlighting 4GB RAM and 64GB storage, along with icons for Wireless CarPlay, Wireless Android Auto, Android OS, and DriveChat.

3. SETUP GUIDE

3.1 Connecting the CB6 AI Box

1. **Connect to Vehicle:** Use the provided USB A-to-C or USB C-to-C cable to connect the CB6 AI Box to

your vehicle's USB port that supports wired CarPlay or Android Auto. For certain models (e.g., 2016-2020 Nissan, Isuzu, Camry, 2023 Toyota Crown, 2023 Lexus NX, Volkswagen Desay SV), the Y-shaped cable may be required for power supply.

2. **Power On:** The device will power on automatically once connected.

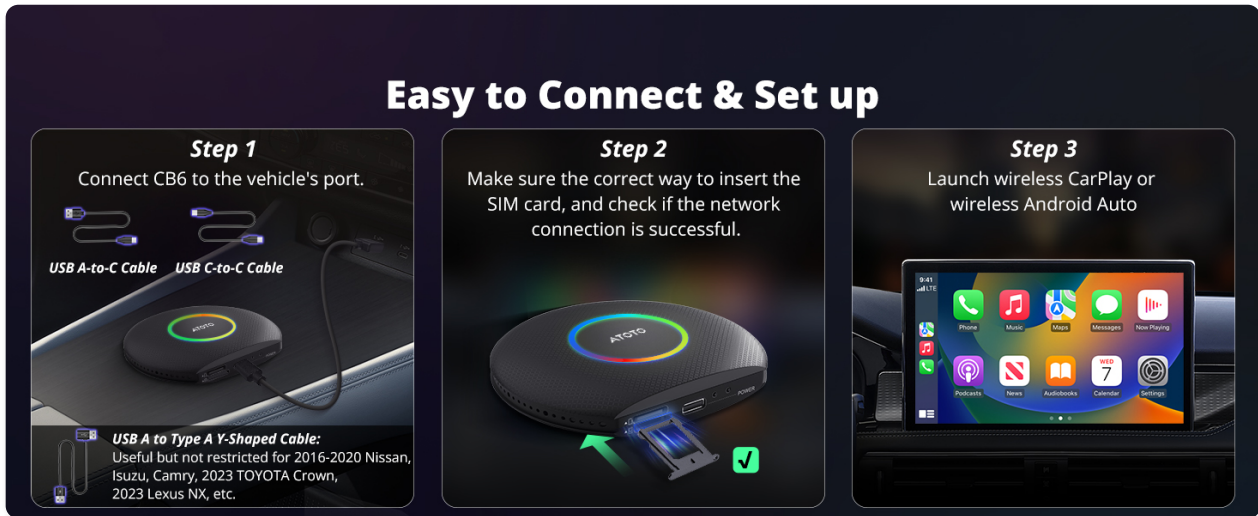

Image 3.1: Visual guide demonstrating the three easy steps to connect and set up the CB6 AI Box, including cable connection, SIM card insertion, and launching wireless CarPlay/Android Auto.

3.2 SIM Card Installation (Optional)

For 4G LTE connectivity, insert a Micro SIM card into the designated slot on the CB6 AI Box. Ensure the SIM card tray is inserted in the correct direction to prevent damage.

4G LTE - Insert A Micro SIM Card



Bluetooth Tethering



2.4&5.0 GHz WiFi



Image 3.2: Illustration detailing the proper method for inserting a Micro SIM card into the CB6 AI Box, emphasizing the correct orientation to avoid device damage.

3.3 Initial Wireless Connection

1. Once the CB6 is connected and powered on, your car stereo display should show the CB6 interface.
2. On your smartphone, enable Bluetooth and Wi-Fi.
3. Search for the CB6 device in your phone's Bluetooth settings and pair with it.
4. Follow the on-screen prompts on your car stereo and phone to establish the wireless CarPlay or Android Auto connection.
5. If your head unit only supports wireless CarPlay + wired Android Auto, you may need to press and hold the 'Reset' button on the CB6 to switch to the Android Auto channel.

4. OPERATION

4.1 Accessing Applications

The CB6 AI Box allows you to download and use various applications from Google Play Store or the pre-installed FindApps store. Navigate the interface using your car's touchscreen or controls.

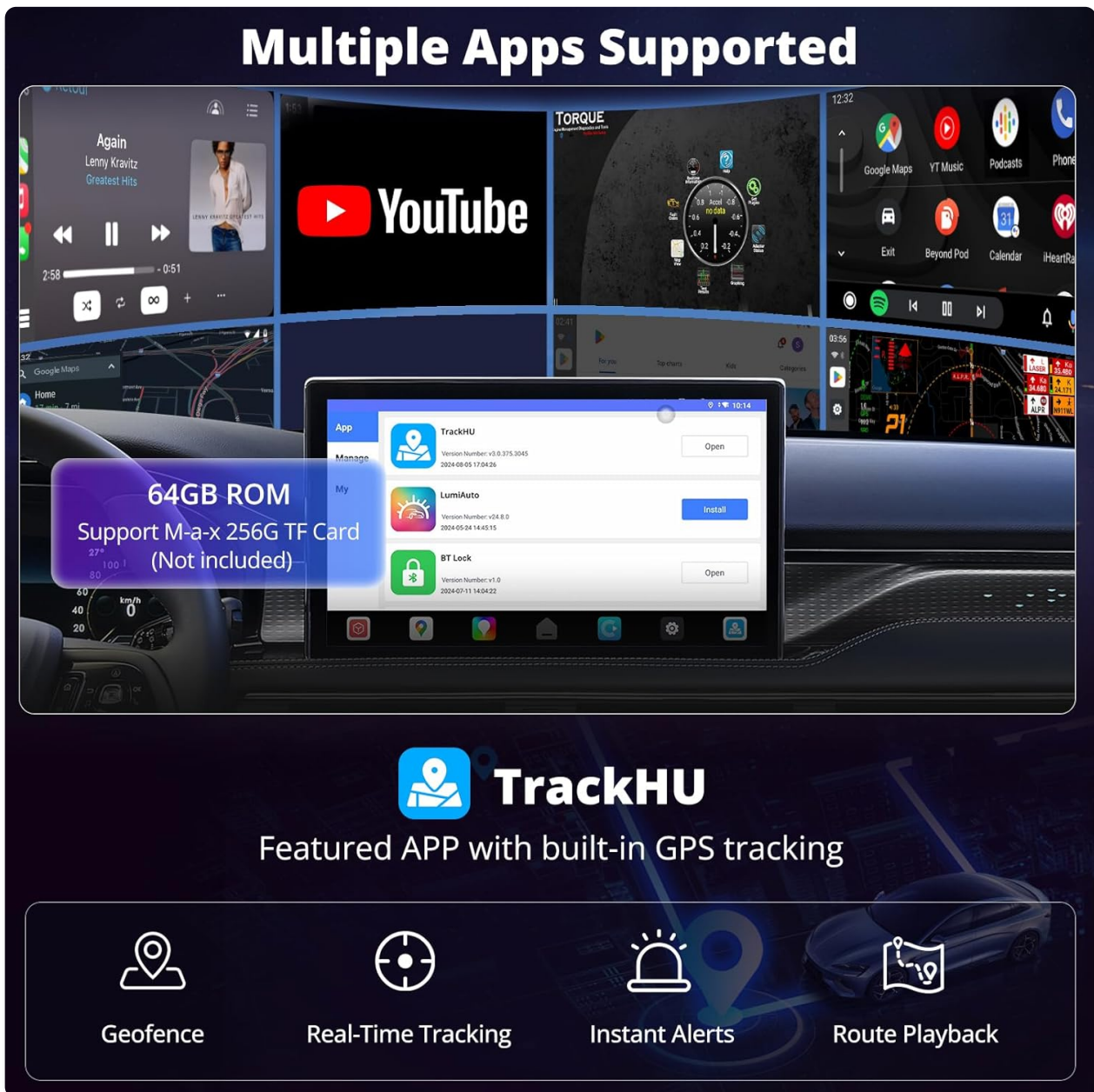

Image 4.1: A car's infotainment screen displaying multiple supported applications, including media players, navigation, and the TrackHU GPS tracking app, demonstrating the device's versatility.

4.2 Split Screen Functionality

The device supports split-screen mode, allowing you to run two applications simultaneously on your car's display. This is useful for navigation while also controlling media playback or other functions.

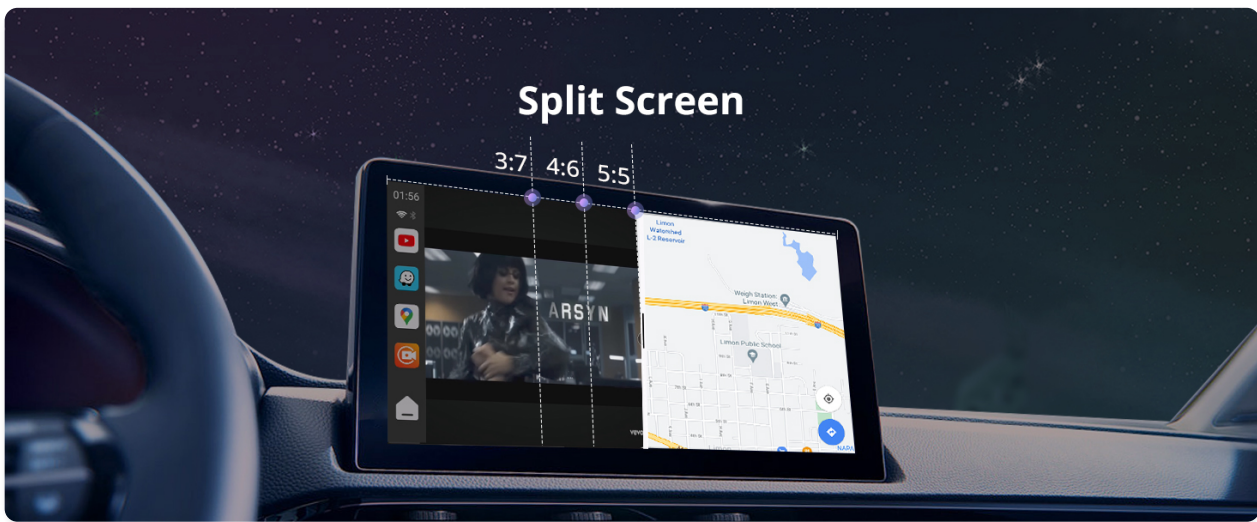

Image 4.2: An example of the split-screen feature on a car display, showing a video playing on one side and a navigation map on the other, with adjustable screen ratios.

4.3 LED Light Customization

The CB6 AI Box features customizable LED lights. You can personalize the colors and modes (Daytime, Night, Auto) through the device settings.



Image 4.3: The CB6 AI Box highlighting its customizable LED light ring, with options for different modes and a color palette for personalization.

5. CONNECTIVITY

5.1 Dual Bluetooth Functionality

The CB6 AI Box features two independent Bluetooth modules:

- **Bluetooth 1:** Primarily for phone connection, enabling wireless CarPlay and Android Auto.
- **Bluetooth 2:** Used for internet access via Bluetooth tethering from your phone and for connecting external Bluetooth devices like OBD diagnostic tools or ambient light kits.



Image 5.1: A visual representation of the CB6's dual Bluetooth capabilities, showing Bluetooth 1 for phone connectivity and Bluetooth 2 for internet access and connecting accessories like OBD-II scanners or footwell lights.

5.2 4G LTE and Wi-Fi

The device supports internet access via a built-in 4G LTE module (requires an IoT SIM card) or through Wi-Fi (2.4GHz & 5.0GHz). Bluetooth tethering is also an option for internet connectivity.

Important Note:

When using wireless CarPlay or wireless Android Auto, Wi-Fi is occupied for the wireless connection. Therefore, internet access during these modes must be provided via the built-in 4G LTE or Bluetooth tethering (using Bluetooth 2).



Image 5.2: An overview of the CB6's internet connectivity options, including 4G LTE via a Micro SIM card, Bluetooth tethering, and dual-band 2.4GHz & 5.0GHz Wi-Fi.

6. SOFTWARE FEATURES

6.1 DriveChat AI Assistant

The CB6 AI Box includes DriveChat, a voice assistant powered by ChatGPT. This feature allows for AI conversations and chatbot interactions, enhancing your in-car experience.

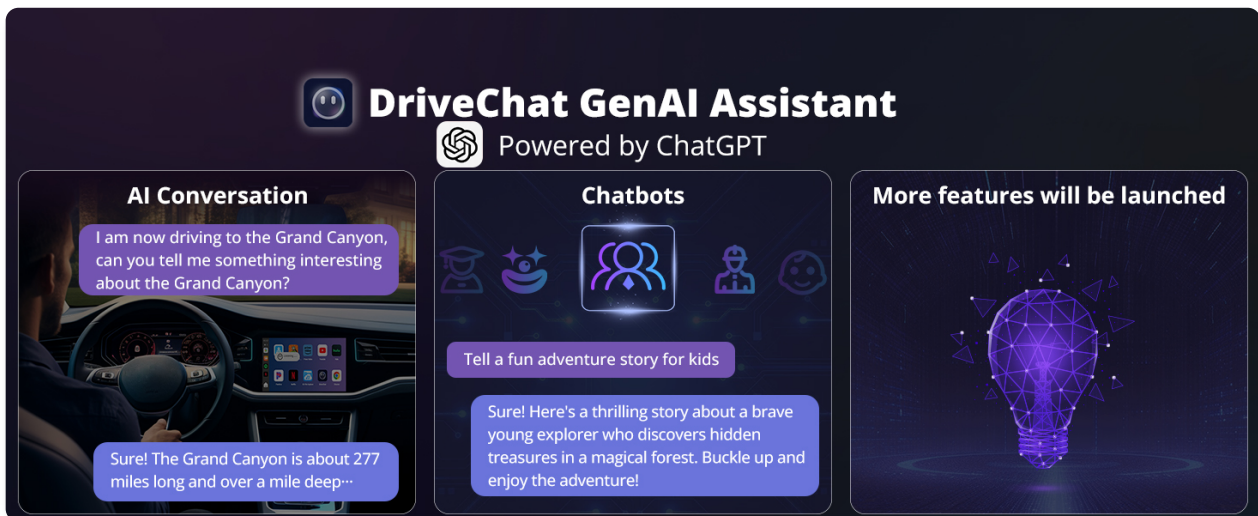

Image 6.1: A demonstration of the DriveChat GenAI Assistant, powered by ChatGPT, illustrating its capabilities for AI conversations and various chatbot functions.

6.2 TrackHU GPS Tracking App

The device comes with the TrackHU GPS tracking app, which utilizes the built-in GPS. This app provides features such as geofencing, real-time tracking, instant alerts, and route playback without the need for external GPS trackers.

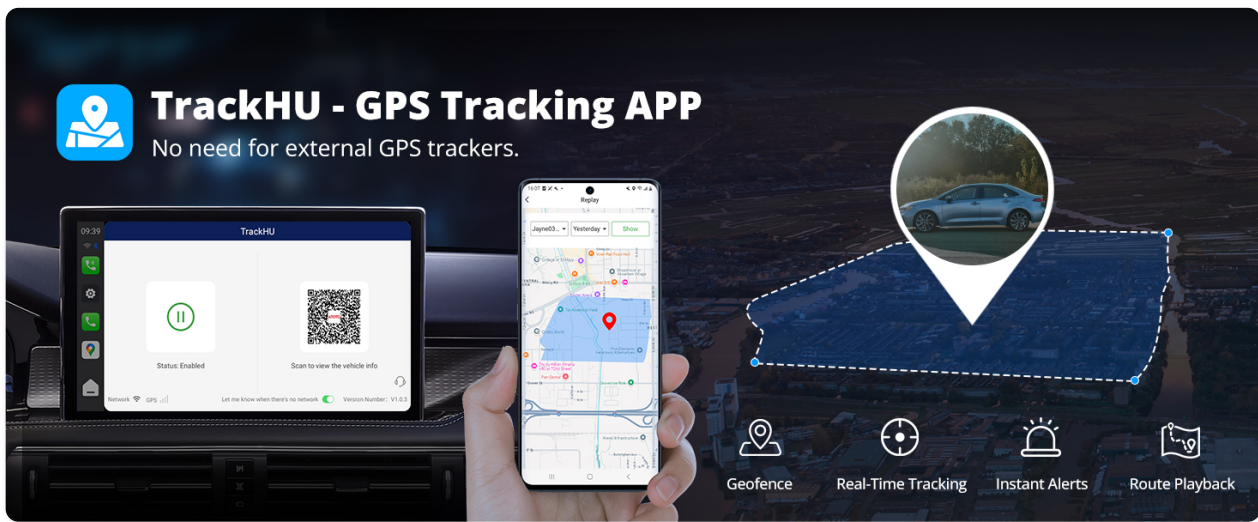

Image 6.2: The TrackHU GPS Tracking App interface, displaying its core functionalities including geofencing, real-time tracking, instant alerts, and route playback.

6.3 OTA Updates

The CB6 AI Box supports Over-The-Air (OTA) updates. These updates continuously add new features, improve system stability, and optimize performance. It is recommended to check for and install updates regularly to ensure optimal device functionality.



Image 6.3: The OTA Update screen on a car stereo, displaying the current system version and providing an option to check for and download new updates.

7. COMPATIBILITY

7.1 Compatible Car Stereos

The CB6 AI Box is compatible with both factory-installed and aftermarket car stereos that feature wired CarPlay or wired Android Auto. This includes stereos that:

- Only have Wired CarPlay & Wired CarPlay and Wireless CarPlay
- Only have Wired Android Auto & Wired Android Auto and Wireless Android Auto (requires pressing and holding 'Reset' button to switch to Android Auto)
- Have Wired CarPlay and Wired Android Auto
- Have Wired CarPlay and Wireless Android Auto
- Have Wireless CarPlay and Wired Android Auto (requires pressing and holding 'Reset' button to switch to)

7.2 Compatible Phones

- **iPhone:** Compatible with iPhone 5 or newer (iOS 9.0+).
- **Android:** Compatible with Android 11.0+. Also useful for Google/Samsung phones with Android 10.0+, Galaxy S8/S8+/Note 8 with Android 9.0+.

7.3 Incompatible Scenarios

The CB6 AI Box is **NOT** compatible with:

- Car stereos that only support Wireless CarPlay or only Wireless Android Auto.
- BMW models.
- Most Subaru models.

For specific car models like Nissan (2016-2020), Isuzu, Camry, 2023 Toyota Crown, 2023 Lexus NX, and certain Volkswagen models, a power supply cable connection may be required. An appropriate USB A to Y-Cable is included in the package.

CB6 Wireless CP & AA Android AI BOX

with DriveChat AI Voice Assistant and Wireless CarPlay & Wireless Android Auto

98%
Compatibility





Compatible with iPhone 5 or newer(iOS9.0+)



Android 11.0+;
Also useful for Google/Samsung phones with Android 10.0+,
Galaxy S8/S8+/Note 8 with Android 9.0+

Car Stereos that Comes with:

- ✓ Only Wired CarPlay & Wired CarPlay and Wireless CarPlay
- ✓ Only Wired Android Auto & Wired Android Auto and Wireless Android Auto
(You must press and hold the 'Reset' button to switch to Android Auto)
- ✓ Wired CarPlay and Wired Android Auto
- ✓ Wired CarPlay and Wireless Android Auto
- ✓ Wireless CarPlay and Wired Android Auto
(You must press and hold the 'Reset' button to switch to Android Auto)
- ✗ Only Wireless CarPlay or Only Wireless Android Auto

Note: To ensure that your cars are compatible, please read the product details or con-tact product-care team

Image 7.1: A detailed compatibility chart for the CB6 AI Box, outlining supported car stereo types and phone operating systems, as well as specific incompatible vehicle models.

8. MAINTENANCE

8.1 Preventing Overheating

Some heat generation during use is normal. To ensure the device runs smoothly and to reduce the risk of overheating:

- Avoid placing the device in direct sunlight.
- Ensure there is sufficient space around the device for proper airflow.
- Do not block any air vents on the device.

8.2 General Care

- Keep the device clean and free from dust.
- Avoid exposing the device to extreme temperatures or moisture.
- Handle cables carefully to prevent damage to connectors.

9. TROUBLESHOOTING

This section addresses common questions and issues you might encounter.

9.1 Frequently Asked Questions

- **How can I download apps to the system?**

Apps can be downloaded via Google Play Store or the pre-installed FindApps app store. Note that only apps designed for in-car systems are supported; some phone/tablet specific apps may not be available.

- **How can I access video apps like YouTube?**

Video apps are available when using the built-in Android system or Android Auto. They are not supported in iPhone connection mode due to system restrictions. For safety, avoid watching videos while driving.

- **Can I play local videos from a TF card?**

Yes, the device supports TF cards up to 256GB. Ensure the TF card is working properly. Supported video formats include TS, 3G2, AVI, MKV, WEBM, MPG, MOV, and 3GP.

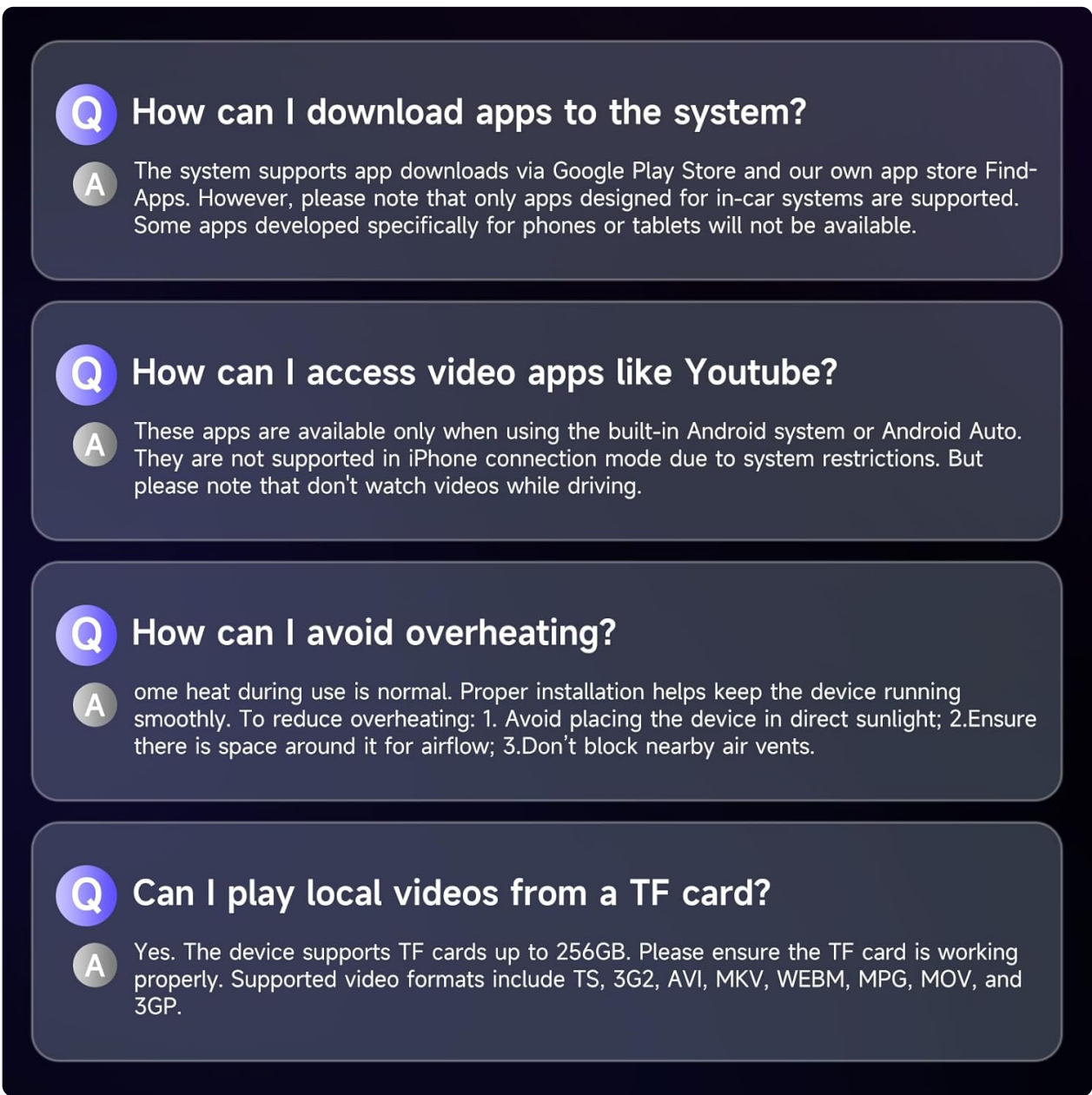

Image 9.1: A visual representation of frequently asked questions regarding the CB6 AI Box, covering topics such as app installation, video playback, overheating prevention, and TF card compatibility.

10. SPECIFICATIONS

Feature	Specification
Product Dimensions (L x W x H)	3.67 x 3.25 x 0.65 inches
Item Weight	8.4 ounces
Item Model Number	CB6
Operating System	Android 13
RAM	4GB
Internal Storage	64GB
Expandable Storage	Supports TF card up to 256GB

Connectivity	4G LTE, Dual Bluetooth, 2.4/5.0 GHz Wi-Fi
GPS	Built-in GPS
Connector Type	Micro USB

11. WARRANTY AND SUPPORT

ATOTOZONE provides a **12-month warranty** for the CB6 AI Box, with an additional **6 months** upon product registration. For any issues or inquiries, online self-service support is available. Product care experts aim to respond to all issues within 24 hours.

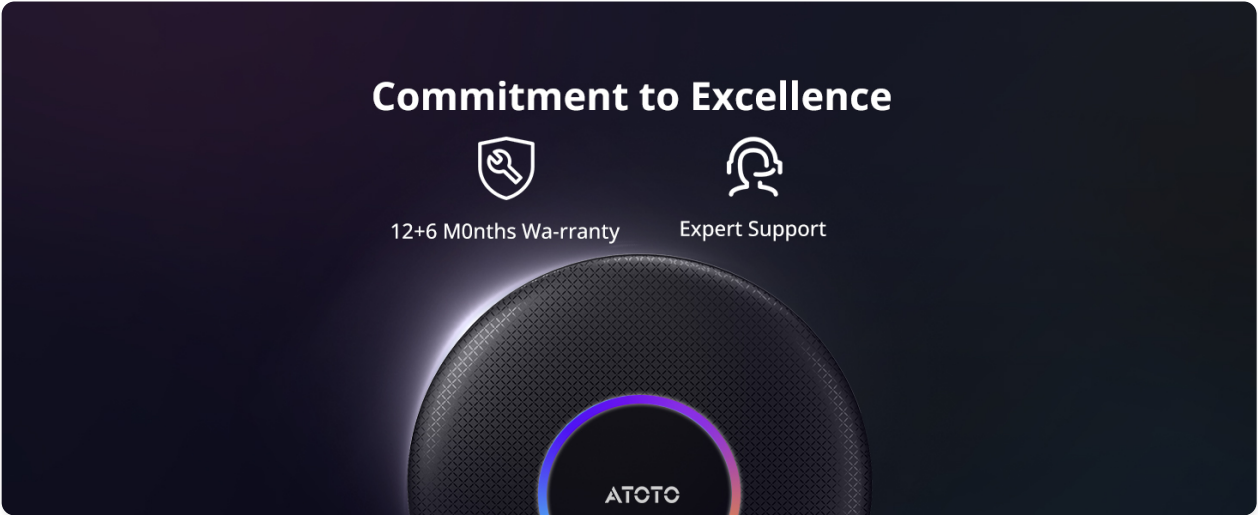

Image 11.1: A graphic illustrating the commitment to excellence, featuring a 12+6 months warranty and expert support services.

© 2025 ATOTOZONE. All rights reserved.

Related Documents - CB6

	<p>LINAK LA27 Linear Actuator Datasheet and Specifications</p> <p>Detailed information on the LINAK LA27 linear actuator, including features, technical specifications, usage guidelines, dimensions, and ordering information. Suitable for furniture and home care bed applications.</p>
	<p>Multipure Aquaversa User Guide: Installation, Features, and Maintenance</p> <p>This user guide provides comprehensive information on the Multipure Aquaversa drinking water system (MP750), including installation instructions, system features, maintenance procedures, specifications, contaminant reduction performance, troubleshooting tips, frequently asked questions, and available accessories.</p>

