

[Manuals.plus](#) /

> [Roinvou](#) /

> Roinvou Car Radio for Suzuki SX4 2006-2013 Instruction Manual

## Roinvou B0DYN4NP4D

# Roinvou Car Radio Instruction Manual

Model: B0DYN4NP4D

## INTRODUCTION

This manual provides detailed instructions for the installation, operation, and maintenance of your Roinvou 9-inch IPS Touch Screen Car Stereo. This unit is designed to enhance your driving experience with features such as Wireless CarPlay, Android Auto, GPS Navigation, Bluetooth 5.0, FM RDS radio, and WiFi connectivity.

**Applicable Models:** This car stereo is compatible with Suzuki SX4 models manufactured between 2006 and 2013. It is designed for seamless integration with the original dash panel without requiring wiring modifications.



Image: Comparison of the Suzuki SX4 dashboard before and after the Roinvou car radio installation.

## SETUP AND INSTALLATION

### Package Contents

Before beginning installation, please verify that all components are present in the package:

- Roinvou Car Stereo for Suzuki SX4
- Power Cable
- USB Adapter Cable
- RCA Harness
- GPS Antenna
- AHD Backup Camera
- External Microphone
- Rear Camera Input Cable
- Dual USB Cable
- Installation Tool

## Package List

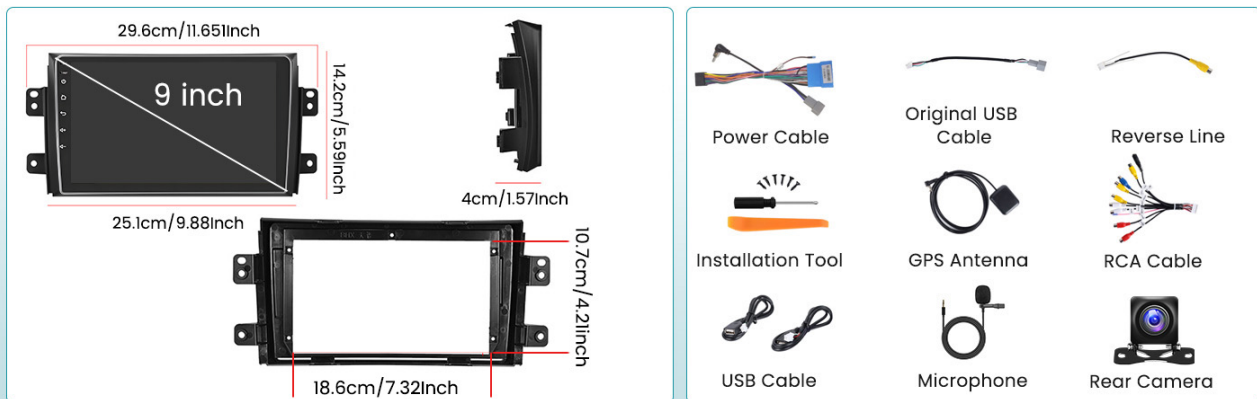

Image: Detailed view of the package contents, including the 9-inch head unit, various cables, GPS antenna, and backup camera.

## Wiring Port Overview

Familiarize yourself with the main wiring ports on the back of the car stereo unit:

1. **Power Cable:** Connects to the vehicle's power supply.
2. **RCA Cable:** For audio/video input and output connections.
3. **USB Cable:** For connecting USB devices.
4. **Camera Input:** Dedicated port for the backup camera.
5. **GPS Antenna:** Connects the GPS antenna for navigation.

## Wiring Port

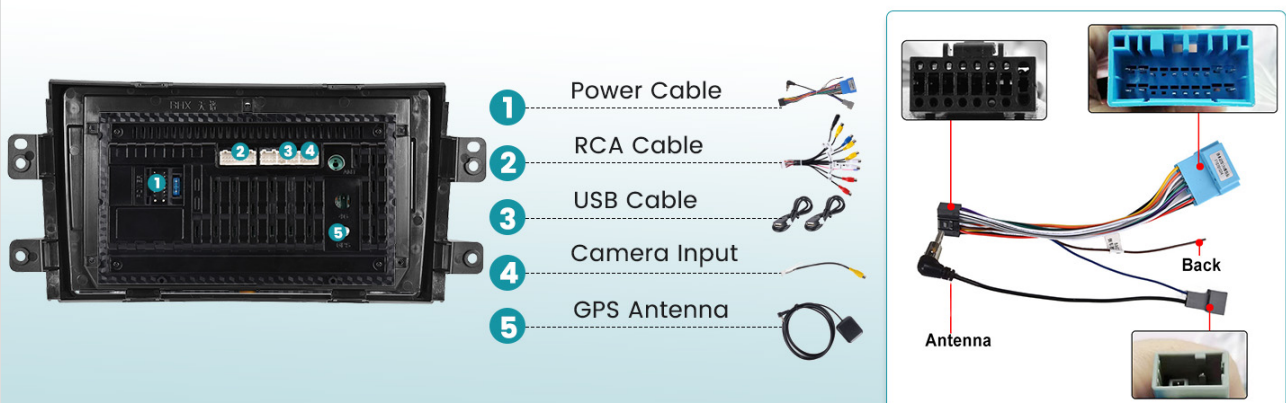

Image: Diagram showing the rear wiring ports of the car stereo and their corresponding cable connections.

## Backup Camera Connection

To connect the AHD backup camera, follow these steps:

- The **Red Cable** (labeled ① in the diagram) connects to the positive terminal of your car's reverse light cable.
- The **Black Cable** (labeled ② in the diagram) connects to the negative terminal of your car's reverse light cable.
- The other two red extension cables (③ and ④) do not need to be connected.

**Important: The reverse input cable must be plugged in even if the reverse camera is not being used. Otherwise, it may affect Bluetooth and WiFi signal reception.**

## How to Connect the Backup Camera ?

**Tip: The reverse input cable must be plugged in even if the reverse camera is not being used. Otherwise it will affect Bluetooth and WiFi signal reception.**

### Reversing Camera Wiring

**Red Cable ①:** Connects to the positive terminal of the car's reverse light cable.

**Black Cable ②:** Connects to the negative terminal of the car's reverse light cable.

There is no need to connect the other two red extension cables ③ and ④.

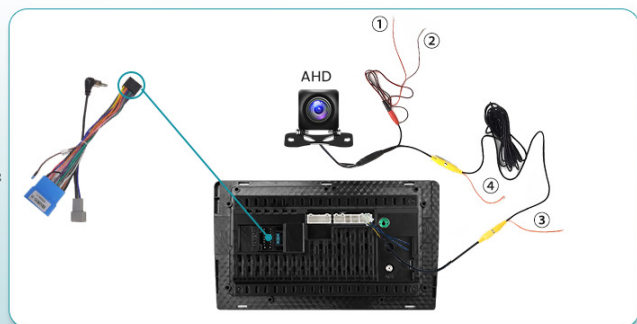

Image: Step-by-step diagram for connecting the AHD backup camera to the car stereo system.

## CANBUS Decoder Information

Depending on your vehicle's configuration, you may or may not have a CANBUS decoder:

### Without CANBUS Decoder:

Connect the plugs or the steering wheel control wires (Key1/Key2) in the power cable to the corresponding port or wire of your original car. Then, navigate to **Settings > Car Settings > General** (Enter SWC setting interface) and manually match to activate the button functions.

### With CANBUS Decoder:

Connect the CANBUS before powering on the machine. Then, navigate to **Settings > Car Settings > Factory (000000) > CarType Setting** to ensure SWC works properly. First, select the brand of the CANBUS decoder, then select the matching model and year according to your specific vehicle.

## CANBUS NOTE

### Without CANBUS Decoder:

Please connect the plugs or the steering wheel control wires (Key1/Key2) in the power cable to the corresponding port or wire of your original car, and then follow this path (Settings - Car Settings - General (Enter SWC setting interface) ) manual match to activate the button function.

### Contain CANBUS Decoder:

Please connect the canbus before powering on the machine, and then follow this path (Settings - Car Settings - Factory (000000) - CarType Setting) to make SWC work properly. First select the brand of the canbus decoder, then select the matching model and year according to the actual situation.

Image: Instructions for connecting and configuring the CANBUS decoder for steering wheel controls.

## OPERATING INSTRUCTIONS

### Wireless CarPlay & Android Auto

The unit supports both wired and wireless CarPlay and Android Auto. It prioritizes wireless connection and uses wired as a backup, automatically switching if the wireless signal is weak. CarPlay/Android Auto activates automatically when you start your car, allowing access to navigation, music, and calls. Siri and Google Assistant are supported for hands-free operation.

### Wireless Carplay / Android Auto



Image: Visual representation of CarPlay and Android Auto functionality on the car stereo.

### GPS Navigation & WiFi Connectivity

The system supports online maps and includes pre-loaded offline North American maps. Connect to WiFi for fast, stable internet access, enabling you to download apps from the app store and stream online videos from platforms like YouTube or TikTok.

# GPS Navigation & WiFi Connection

You can purchase directly from play store for offline navigation. With wifi connected, Google Maps can be used perfectly, you can go anywhere you want and never get lost again.



Image: The car stereo screen showing GPS navigation in action, with a car icon on a map.

## FM/RDS Radio & Bluetooth Handsfree

The integrated FM/RDS radio provides automatic reception of radio station names, traffic conditions, and news. It features intelligent channel memory for frequently listened-to stations. Bluetooth 5.0 supports hands-free calling, music playback, and automatic phone book loading. The wireless headset allows for multi-device switching, balancing music and phone calls simultaneously.

# Hands-free Bluetooth & FM/RDS Radio

Support Bluetooth hands-free calling, Bluetooth music playback and auto-loading phone book. Stable FM/RDS radio provides channel broadcasting, weather forecasts, and real-time traffic conditions.



Image: The car stereo showing the FM radio interface and a smartphone connected via Bluetooth for calls.

## Mirror Link Functionality

Seamless screen mirroring projects your mobile phone's interface to the car screen in real-time. This feature supports touch reverse operation, allowing synchronized display of navigation, music, and apps with one click.

## Steering Wheel Control

The unit supports learning original steering wheel control buttons, providing convenient control over the car radio. This allows you to manage functions like volume, track changes, and calls directly from your steering wheel.

# Steering Wheel Control & AHD Rear View Camera

Upgrade your driving with steering wheel control and AHD reversing screen display with precision and safety in your hands.

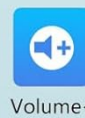
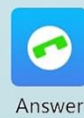
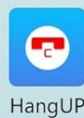
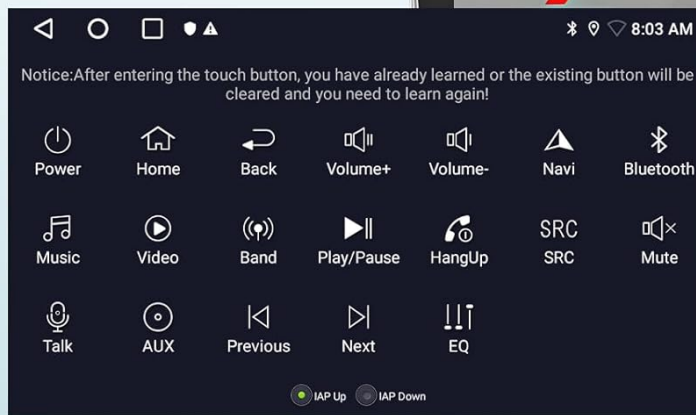
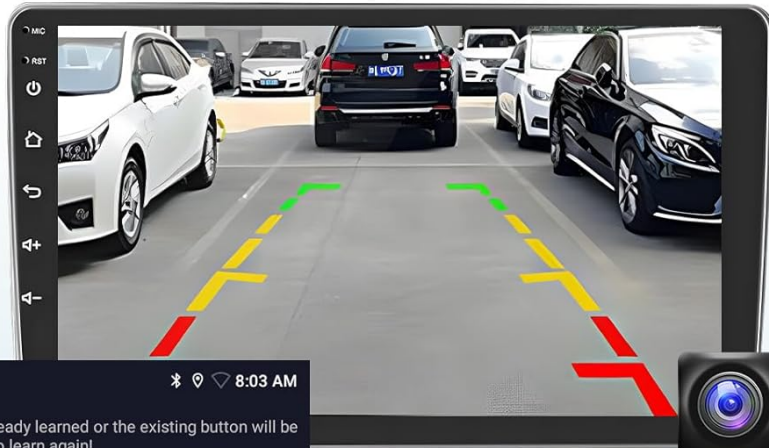

Image: The car stereo displaying the steering wheel control learning interface, alongside a steering wheel.

## DSP & EQ Settings and UI Themes

The Digital Sound Processor (DSP) technology restores the true quality of sound. The Equalizer (EQ) offers multi-mode one-key switching and supports manual adjustment of high, medium, and low-frequency bands. Additionally, the system supports 26 desktop themes, allowing you to customize the user interface style.

# 26UI Themes & EQ Settings

Support multiple EQ options and 26 desktop themes, allows you to enjoy a superior music listening experience and switch your favorite user interface style.



Image: Various user interface themes and sound equalizer settings displayed on the car stereo screen.

## MAINTENANCE

To ensure the longevity and optimal performance of your Roinvou car stereo, follow these maintenance guidelines:

- **Screen Cleaning:** Use a soft, lint-free cloth slightly dampened with water or a screen cleaner specifically designed for electronics. Avoid harsh chemicals or abrasive materials.
- **Software Updates:** Periodically check for available software updates through the system settings or the manufacturer's website to ensure you have the latest features and bug fixes.
- **Cable Connections:** Ensure all cables are securely connected. Loose connections can lead to intermittent functionality or signal loss.
- **Environmental Conditions:** Avoid exposing the unit to extreme temperatures, direct sunlight for prolonged periods, or excessive moisture.
- **Ventilation:** Ensure the unit's ventilation areas are not blocked to prevent overheating.

## TROUBLESHOOTING

If you encounter issues with your car stereo, refer to the following common troubleshooting steps:

- **No Power:**

- Check all power cable connections to ensure they are secure.
- Verify the vehicle's fuse for the stereo system.

- **No Sound:**

- Check speaker wire connections.
- Ensure the volume is not muted or set too low.
- Verify audio output settings in the system menu.

- **GPS Signal Loss:**

- Ensure the GPS antenna is properly connected and has a clear view of the sky.
- Check GPS settings in the system menu.

- **Bluetooth Connection Issues:**

- Ensure Bluetooth is enabled on both the car stereo and your mobile device.
- Delete previous pairings and attempt to re-pair the devices.
- Move your mobile device closer to the stereo.

- **CarPlay/Android Auto Not Connecting:**

- Ensure your phone's operating system is up to date.
- Try connecting with a different USB cable if using a wired connection.
- Restart both the car stereo and your mobile device.

- **Steering Wheel Controls Not Working:**

- Refer to the "CANBUS Decoder Information" section for proper setup and configuration.
- Ensure the steering wheel control wires are correctly connected.

If problems persist after attempting these steps, please contact customer support.

## SPECIFICATIONS

---

<b>Brand</b>	Roinvou
<b>Model Number</b>	B0DYN4NP4D
<b>Screen Size</b>	9 Inches
<b>Resolution</b>	1024 x 600
<b>Operating System</b>	Android
<b>Memory Storage Capacity</b>	64 GB
<b>Connectivity Technology</b>	Bluetooth, USB, Wi-Fi
<b>Bluetooth Version</b>	5.0

<b>Supported Navigation System</b>	GPS (North America maps included)
<b>Special Features</b>	CarPlay, Android Auto, Touchscreen, FM RDS Radio, Mirror Link, DSP, EQ, SWC, 26 Desktop Themes
<b>Compatible Devices</b>	iPhone, Android
<b>Item Weight</b>	1.38 Kilograms

## WARRANTY AND SUPPORT

---

### Warranty Information

This Roinvou car stereo comes with a **1 Year Warranty** from the date of purchase. This warranty covers manufacturing defects and malfunctions under normal use. Please retain your proof of purchase for warranty claims. For detailed warranty terms and conditions, please refer to the documentation included with your product or contact Roinvou customer service.

### Customer Support

If you require technical assistance, have questions about installation, or need to report a product issue, please contact Roinvou customer support. You can typically find contact information on the manufacturer's official website or through the retailer where you purchased the product.

When contacting support, please have your product model number (B0DYN4NP4D) and purchase details readily available to expedite assistance.