

## Karlsson KA6061BK

# Karlsson LED Cuckoo Alarm Clock (KA6061BK) Instruction Manual

Model: KA6061BK

## 1. INTRODUCTION

Thank you for purchasing the Karlsson LED Cuckoo Alarm Clock, model KA6061BK. This manual provides comprehensive instructions for the proper setup, operation, and maintenance of your new alarm clock. Please read this manual thoroughly before use and retain it for future reference.

## 2. SAFETY INFORMATION

- Keep the device away from water and moisture.
- Do not expose the device to extreme temperatures or direct sunlight.
- Use only the specified battery type (CO32) and ensure correct polarity during installation.
- Do not attempt to disassemble or repair the device yourself. Contact qualified service personnel.
- Keep batteries out of reach of children.

## 3. PACKAGE CONTENTS

Please check the package for the following items:

- Karlsson LED Cuckoo Alarm Clock (KA6061BK)
- Instruction Manual

*Note: One CO32 battery is required and is not included in the package.*

## 4. PRODUCT OVERVIEW

The Karlsson LED Cuckoo Alarm Clock features a modern design with a digital LED display and a charming cuckoo alarm function. Its house-shaped wooden veneer casing adds a touch of nature to your interior.



**Figure 1: Front View.** This image displays the front of the Karlsson LED Cuckoo Alarm Clock. The digital LED display shows '12:00', and above it, a circular opening reveals a white cuckoo bird. The brand name 'KARLSSON' is visible below the display. A white power cord extends from the right side.



**Figure 2: Side View.** This image shows the side profile of the Karlsson LED Cuckoo Alarm Clock. It emphasizes the distinct house-like silhouette and the dark wooden veneer texture of the casing. The design is sleek and minimalist.



**Figure 3: Top-Down View.** This image provides a view from the top of the Karlsson LED Cuckoo Alarm Clock. It clearly shows the circular opening where the cuckoo bird emerges, with the white bird visible inside. The wooden texture of the clock's roof is also prominent.

## 5. SETUP

---

### 5.1. Battery Installation

1. Locate the battery compartment on the back or bottom of the clock.
2. Open the battery compartment cover.
3. Insert one CO32 battery, ensuring the correct polarity (+ and -) as indicated inside the compartment.
4. Close the battery compartment cover securely.

### 5.2. Initial Power On

Once the battery is installed, the LED display should light up, typically showing a default time or flashing digits. The clock is now ready for time setting.

## 6. OPERATING INSTRUCTIONS

---

## 6.1. Setting the Time

Specific buttons for time setting are usually located on the back or bottom of the clock. Look for buttons labeled 'SET', 'TIME', 'HOUR', 'MINUTE', or similar.

1. Press the 'SET' or 'TIME' button once to enter time setting mode. The hour digits may start flashing.
2. Use the 'HOUR' or '+' / '-' buttons to adjust the hour.
3. Press 'SET' again to move to minute setting. The minute digits may start flashing.
4. Use the 'MINUTE' or '+' / '-' buttons to adjust the minute.
5. Press 'SET' one more time to confirm and exit time setting mode.

## 6.2. Setting the Alarm

Look for buttons labeled 'ALARM', 'ALARM SET', or an alarm icon.

1. Press the 'ALARM SET' button once to enter alarm setting mode. The alarm hour digits may start flashing.
2. Use the 'HOUR' or '+' / '-' buttons to adjust the alarm hour.
3. Press 'ALARM SET' again to move to alarm minute setting. The alarm minute digits may start flashing.
4. Use the 'MINUTE' or '+' / '-' buttons to adjust the alarm minute.
5. Press 'ALARM SET' one more time to confirm and exit alarm setting mode.

## 6.3. Activating/Deactivating the Alarm

There is usually a dedicated switch or button to turn the alarm ON or OFF. This might be labeled 'ALARM ON/OFF' or have an alarm icon. When the alarm is active, an indicator (e.g., a small icon or LED) may appear on the display.

## 6.4. Cuckoo Function

The cuckoo alarm clock is designed to emit a cuckoo sound at the set alarm time. Some models may also feature an hourly cuckoo chime. Refer to the specific controls on your device for options to enable/disable the cuckoo sound or adjust its volume, if available.

# 7. MAINTENANCE

## 7.1. Cleaning

- Wipe the clock surface with a soft, dry cloth.
- Do not use abrasive cleaners, solvents, or chemical sprays, as these can damage the finish.

## 7.2. Battery Replacement

When the display dims or the clock functions become erratic, it's time to replace the battery. Follow the battery installation steps (Section 5.1) to replace the CO32 battery.

# 8. TROUBLESHOOTING

Problem	Possible Cause	Solution
---------	----------------	----------

Problem	Possible Cause	Solution
Clock display is blank or dim.	Battery is dead or incorrectly installed.	Replace the CO32 battery, ensuring correct polarity.
Alarm does not sound.	Alarm is not activated or set incorrectly.	Ensure the alarm is turned ON and the alarm time is set correctly.
Cuckoo sound is not working.	Cuckoo function is disabled or battery is low.	Check if the cuckoo function is enabled. Replace battery if necessary.
Time is incorrect.	Time was not set correctly or battery is low.	Reset the time according to Section 6.1. Replace battery if needed.



## 9. SPECIFICATIONS

- **Model:** KA6061BK
- **Brand:** Karlsson
- **Material:** Wooden veneer
- **Color:** Black
- **Display Type:** Digital LED
- **Power Source:** 1 x CO32 Battery (not included)
- **Dimensions:** Approximately 9 cm (L) x 3.81 cm (W) x 15.3 cm (H)
- **Weight:** Approximately 260 grams
- **Special Features:** Cuckoo alarm with LED display

## 10. WARRANTY AND SUPPORT

This product is covered by a standard manufacturer's warranty. For specific warranty terms and conditions, please refer to the documentation provided at the time of purchase or contact your retailer. For technical support or service inquiries, please contact Karlsson customer service through their official website or your point of purchase.

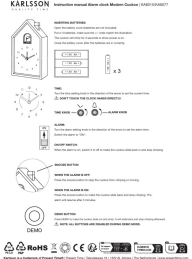
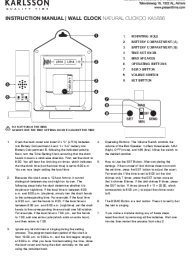
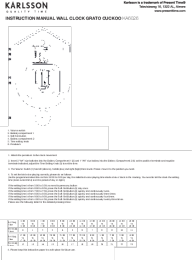
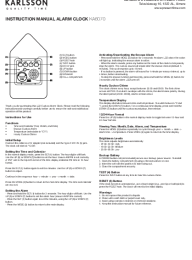
### Related Documents - KA6061BK

 <p>KARLSSON INSTRUCTION MANUAL ALARM CLOCK MODERN CUCKOO KA6015/KA6077</p>	<p><a href="#">Karlsson Modern Cuckoo Alarm Clock KA6015/KA6077: Instruction Manual</a></p> <p>User guide for the Karlsson Modern Cuckoo Alarm Clock (Model KA6015/KA6077). Learn how to insert batteries, set the time and alarm, use snooze, and understand its features. Includes warranty and maintenance information.</p>
 <p>KARLSSON INSTRUCTION MANUAL WALL CLOCK NATURAL CUCKOO KA5886</p>	<p><a href="#">Karlsson Natural Cuckoo Wall Clock KA5886: Instruction Manual &amp; Setup Guide</a></p> <p>Comprehensive guide for the Karlsson Natural Cuckoo Wall Clock, model KA5886. This manual provides detailed instructions on setup, time setting, operation of buttons, volume control, and maintenance. Learn how to correctly set the time, understand the day/night setting, and utilize the demo and set functions. Includes warranty information and disposal guidelines.</p>
 <p>KARLSSON INSTRUCTION MANUAL WALL CLOCK GRATO CUCKOO KA6026</p>	<p><a href="#">Karlsson Grato Cuckoo Wall Clock KA6026 Instruction Manual</a></p> <p>Detailed instructions for setting up and operating the Karlsson Grato Cuckoo Wall Clock model KA6026, including battery installation, time setting, volume control, and bird voice activation. Includes warranty and maintenance information.</p>
 <p>KARLSSON INSTRUCTION MANUAL ALARM CLOCK KA6070</p>	<p><a href="#">Karlsson KA6070 LED Cuckoo Alarm Clock Instruction Manual</a></p> <p>Detailed instructions and warnings for the Karlsson KA6070 LED Cuckoo Alarm Clock, covering setup, functions, alarm settings, temperature, and maintenance.</p>
 <p>KARLSSON INSTRUCTION MANUAL ALARM CLOCK KA6061</p>	<p><a href="#">Karlsson KA6061 LED Cuckoo Alarm Clock Instruction Manual</a></p> <p>Comprehensive instructions for setting up and operating the Karlsson KA6061 LED Cuckoo Alarm Clock, including functions, time and calendar settings, alarm, snooze, temperature display, and warnings.</p>

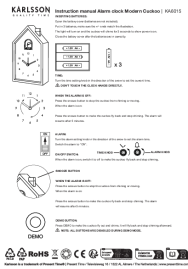

## Karlsson Modern Cuckoo Alarm Clock KA6015 Instruction Manual

Learn how to set up and use the Karlsson Modern Cuckoo Alarm Clock KA6015, including battery installation, time and alarm setting, snooze function, and demo mode.