

Manuals+

[Q & A](#) | [Deep Search](#) | [Upload](#)

[manuals.plus](#) /

- › [Karlsson](#) /
- › [Karlsson 'Alarm' LED Cuckoo Clock - White \(KA6061WH\) User Manual](#)

Karlsson KA6061WH

Karlsson 'Alarm' LED Cuckoo Clock User Manual

MODEL: KA6061WH

INTRODUCTION

Thank you for purchasing the Karlsson 'Alarm' LED Cuckoo Clock. This modern and stylish alarm clock is designed to bring a unique touch to your home, featuring a clear LED time display and a charming cuckoo sound. This manual provides essential information for setting up, operating, and maintaining your new clock.



Image: Front view of the Karlsson 'Alarm' LED Cuckoo Clock, showcasing its minimalist design and digital time display.

SETUP

1. Unpacking

- Carefully remove the clock from its packaging.
- Check for any visible damage. If damaged, contact your retailer.
- Ensure all components are present: the clock unit and any included accessories.

2. Battery Installation

The Karlsson 'Alarm' LED Cuckoo Clock requires **1 CR2032 battery** (not included) for operation.

1. Locate the battery compartment on the back or bottom of the clock.
2. Open the battery compartment cover.
3. Insert one CR2032 battery, ensuring the correct polarity (+ and -) as indicated inside the compartment.
4. Close the battery compartment cover securely.



Image: Another perspective of the Karlsson 'Alarm' LED Cuckoo Clock, showing its compact size and design.

OPERATING INSTRUCTIONS

1. Setting the Time

Refer to the buttons on the back or side of the clock. Typically, there will be buttons labeled 'SET', 'UP', and 'DOWN' or similar.

1. Press the 'SET' button to enter time setting mode. The hour digits will likely flash.
2. Use the 'UP' or 'DOWN' buttons to adjust the hour.
3. Press 'SET' again to move to minute setting. Adjust minutes using 'UP' or 'DOWN'.
4. Press 'SET' one more time to confirm and exit time setting mode.

2. Cuckoo Feature

The Karlsson 'Alarm' LED Cuckoo Clock features an integrated cuckoo sound that activates hourly. Please note the following characteristics of this feature:

- The cuckoo sound will play once every hour.
- The cuckoo feature automatically silences between **10:00 PM (22:00) and 6:00 AM (06:00)** to ensure undisturbed sleep.
- **This hourly cuckoo sound cannot be manually turned off or disabled.** It is an integral part of the clock's design and functionality.



Image: Detailed view of the cuckoo bird mechanism within the clock's housing.

MAINTENANCE

- **Cleaning:** Wipe the clock surface with a soft, dry cloth. Do not use abrasive cleaners or solvents, as they may damage the wood veneer finish.
- **Battery Replacement:** Replace the CR2032 battery when the LED display dims or the clock stops functioning correctly.
- **Placement:** Place the clock on a stable, flat surface away from direct sunlight, extreme temperatures, and high humidity.

TROUBLESHOOTING

Problem	Possible Cause	Solution
---------	----------------	----------

Problem	Possible Cause	Solution
Clock display is dim or blank.	Low or dead battery.	Replace the CR2032 battery. Ensure correct polarity.
Cuckoo sound does not play.	It is between 10:00 PM and 6:00 AM.	The cuckoo feature is designed to be silent during these hours. It will resume at 6:00 AM.
Cuckoo sound plays too often or at unexpected times.	This is normal operation.	The cuckoo sound plays hourly, except during the night silence period (10 PM - 6 AM). This feature cannot be disabled.
Time is incorrect.	Time not set correctly or battery issue.	Re-set the time following the 'Setting the Time' instructions. Check or replace the battery.

SPECIFICATIONS

Feature	Detail
Model	KA6061WH
Dimensions (L x W x H)	9 x 3.81 x 15.3 cm (approximately 3.54 x 1.5 x 6.02 inches)
Weight	200 grams (approximately 0.44 lbs)
Material	Wood veneer
Color	White
Power Source	1 x CR2032 battery (not included)



WARRANTY AND SUPPORT

Karlsson products are manufactured to high quality standards. For warranty information or technical support, please refer to the documentation provided with your purchase or visit the official Karlsson website. You may also contact your retailer for assistance.

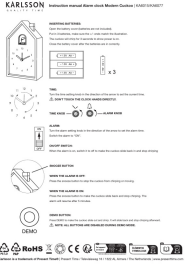
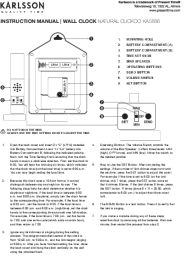
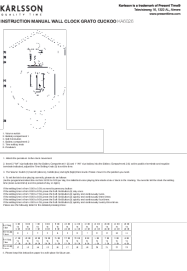
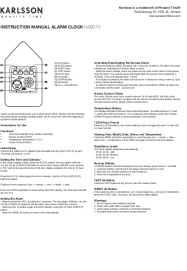

Image: The Karlsson 'Alarm' LED Cuckoo Clock integrated into a modern home environment.

Related Documents - KA6061WH

	<p>Karlsson Modern Cuckoo Alarm Clock KA6015/KA6077: Instruction Manual</p> <p>User guide for the Karlsson Modern Cuckoo Alarm Clock (Model KA6015/KA6077). Learn how to insert batteries, set the time and alarm, use snooze, and understand its features. Includes warranty and maintenance information.</p>
	<p>Karlsson Natural Cuckoo Wall Clock KA5886: Instruction Manual & Setup Guide</p> <p>Comprehensive guide for the Karlsson Natural Cuckoo Wall Clock, model KA5886. This manual provides detailed instructions on setup, time setting, operation of buttons, volume control, and maintenance. Learn how to correctly set the time, understand the day/night setting, and utilize the demo and set functions. Includes warranty information and disposal guidelines.</p>
	<p>Karlsson Grato Cuckoo Wall Clock KA6026 Instruction Manual</p> <p>Detailed instructions for setting up and operating the Karlsson Grato Cuckoo Wall Clock model KA6026, including battery installation, time setting, volume control, and bird voice activation. Includes warranty and maintenance information.</p>
	<p>Karlsson KA6070 LED Cuckoo Alarm Clock Instruction Manual</p> <p>Detailed instructions and warnings for the Karlsson KA6070 LED Cuckoo Alarm Clock, covering setup, functions, alarm settings, temperature, and maintenance.</p>
	<p>Karlsson KA6061 LED Cuckoo Alarm Clock Instruction Manual</p> <p>Comprehensive instructions for setting up and operating the Karlsson KA6061 LED Cuckoo Alarm Clock, including functions, time and calendar settings, alarm, snooze, temperature display, and warnings.</p>

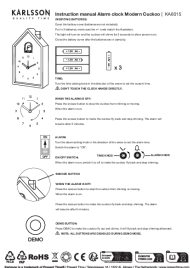

[Karlsson Modern Cuckoo Alarm Clock KA6015 Instruction Manual](#)

Learn how to set up and use the Karlsson Modern Cuckoo Alarm Clock KA6015, including battery installation, time and alarm setting, snooze function, and demo mode.