



**B0DYDFW42L**

# Generic Wearable Breastfeeding Pump Instruction Manual

Model: B0DYDFW42L

## 1. INTRODUCTION

---

This manual provides detailed instructions for the safe and effective use of your Generic Wearable Breastfeeding Pump. Please read this manual thoroughly before first use and retain it for future reference. This electric, hands-free breast pump is designed to assist breastfeeding mothers with milk expression.



Image: Two complete wearable breast pumps, ready for use.

## 2. SAFETY INFORMATION

---

Always follow basic safety precautions when using electrical products, especially when children are present. This device is intended for personal use only. Do not share the pump with other users.

- Ensure all components are clean and dry before assembly and use.
- Do not immerse the pump motor unit in water or other liquids.
- Keep out of reach of children.
- Do not use while bathing or showering.
- Statements regarding dietary supplements have not been evaluated by the FDA and are not intended to diagnose, treat, cure, or prevent any disease or health condition.

## 3. PRODUCT OVERVIEW

---

The Generic Wearable Breastfeeding Pump is designed for discreet and comfortable milk expression. It features multiple modes and suction levels, a leakproof design, and quiet operation.

### Key Features:

- **Hands-Free Design:** Allows for discreet pumping while performing other activities.
- **3 Modes & 10 Levels:** Customizable settings to mimic a baby's natural nursing pattern.
- **Leakproof System:** Double-sealed design to prevent spills and backflow.
- **Quiet Operation:** Advanced pumping technology for minimal noise.
- **Food-Grade Material:** Made with soft, BPA-free silicone for safety and comfort.
- **Portable:** Compact and lightweight for easy transport.
- **Memory Function:** Automatically recalls your last used settings.



Image: Explanation of the three pumping modes (Massage, Pump, Mix) and 10 intensity levels.

# Mute Design

Adopt advanced pumping technology to solve the traditional noise problem.



 Pumping at night without disturbing your baby's sweet dreams.

20dB	35dB	40dB	60dB
			
Whisper	Breast Pump Working	Other Breast Pumps	Air Condition Sound



Image: Detailed view of the pump's leakproof features, including anti-overflow and anti-backflow mechanisms.

# Food-Grade Material, BPA Free

Made of soft food-grade silicone, the pump accessories bring you safe, comforting touch.



Food Grade  
Silicone



BPA Free



They're also easy to remove and clean, get you rid of annoying clean-ups!



Image: Illustration of the pump's quiet operation, allowing for use without disturbing a sleeping baby.

## 4. SETUP AND ASSEMBLY

Follow these steps to assemble your breast pump before first use and after each cleaning.

1. Install the silicone diaphragm and valve into the milk collector.
2. Assemble the linker into the milk collector.
3. Install the silicone flange onto the milk collector.
4. Assemble the pump motor onto the milk collector, ensuring a secure fit.

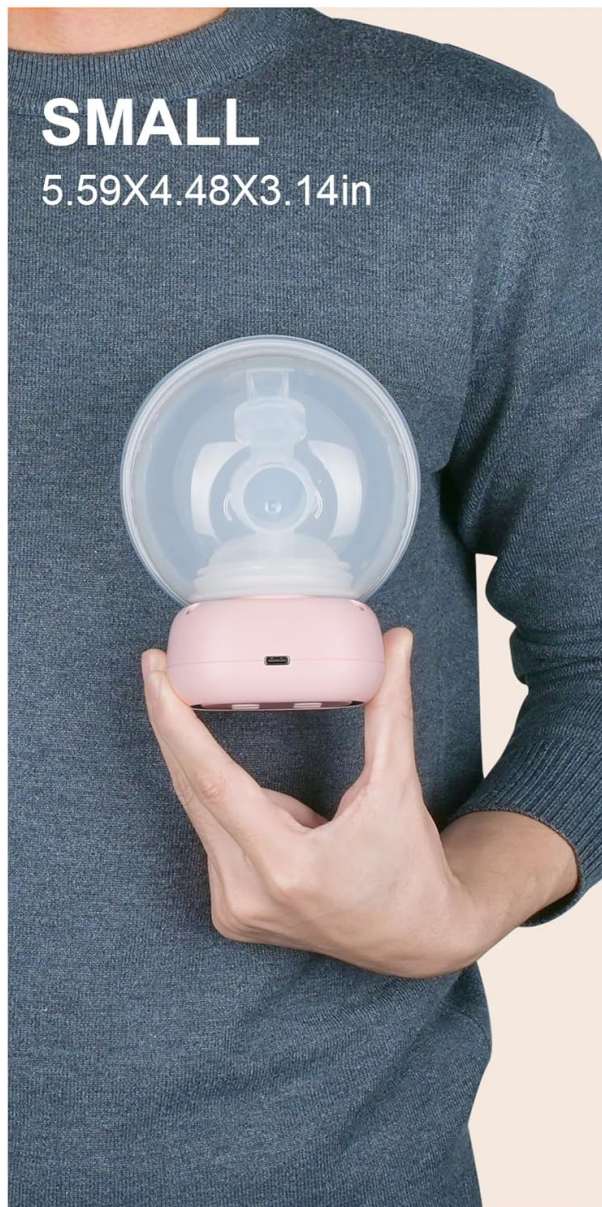

Image: Step-by-step visual instructions for assembling the breast pump.

## 5. OPERATING INSTRUCTIONS

### Charging the Pump:

- Connect the provided USB charging cable to the pump motor unit and a suitable power source.
- A full charge takes approximately 2.5 hours and provides power for up to 90 minutes of pumping (approximately 6 sessions).

### Using the Pump:

1. Ensure the pump is fully assembled and charged.
2. Position the silicone flange securely against your breast, ensuring a comfortable and airtight seal.
3. Press the power button to turn on the pump.
4. Select your desired mode (Massage, Pump, or Mix) using the mode button.
5. Adjust the suction intensity using the '+' and '-' buttons. There are 10 levels available for each mode.
6. The pump will automatically shut off after 30 minutes of continuous operation.
7. After pumping, carefully remove the pump from your breast and disassemble for cleaning.

# Portable & Hand-Free Breast Pump

Enables Moms to pump at anytime and anywhere.



Image: Examples of the pump's portable and hands-free use in various daily activities.

## 6. CLEANING AND MAINTENANCE

Proper cleaning and maintenance are essential for hygiene and the longevity of your breast pump. All parts that come into contact with breast milk must be cleaned after each use.

### Cleaning Steps:

1. Disassemble all parts that come into contact with milk (flange, valve, diaphragm, milk collector, linker).
2. Wash these parts immediately in warm, soapy water. Use a soft brush if necessary.
3. Rinse thoroughly with clean water.
4. Air dry on a clean drying rack or use a clean cloth. Ensure all parts are completely dry before reassembly.
5. The pump motor unit should be wiped clean with a damp cloth; do not submerge it in water.

# PRODUCT DIMENSIONS

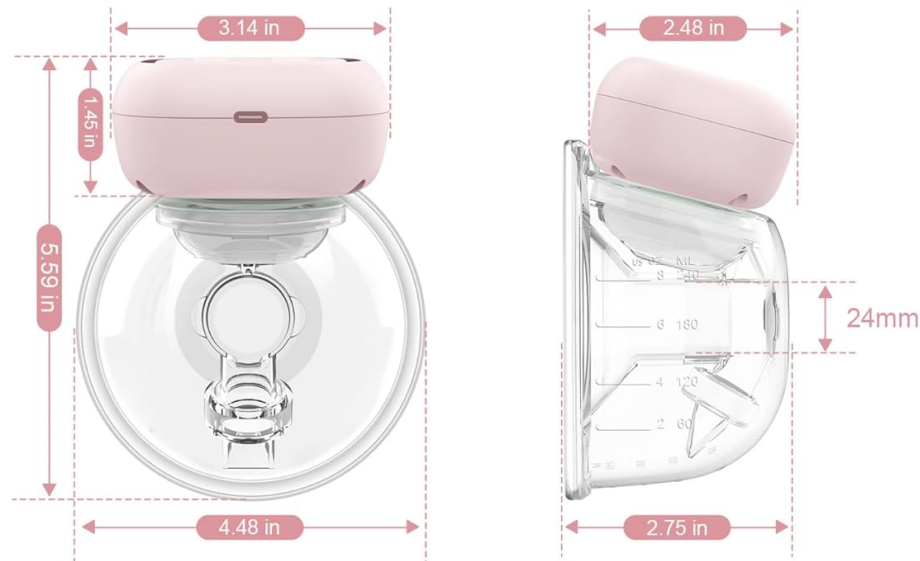

# PRODUCT LIST

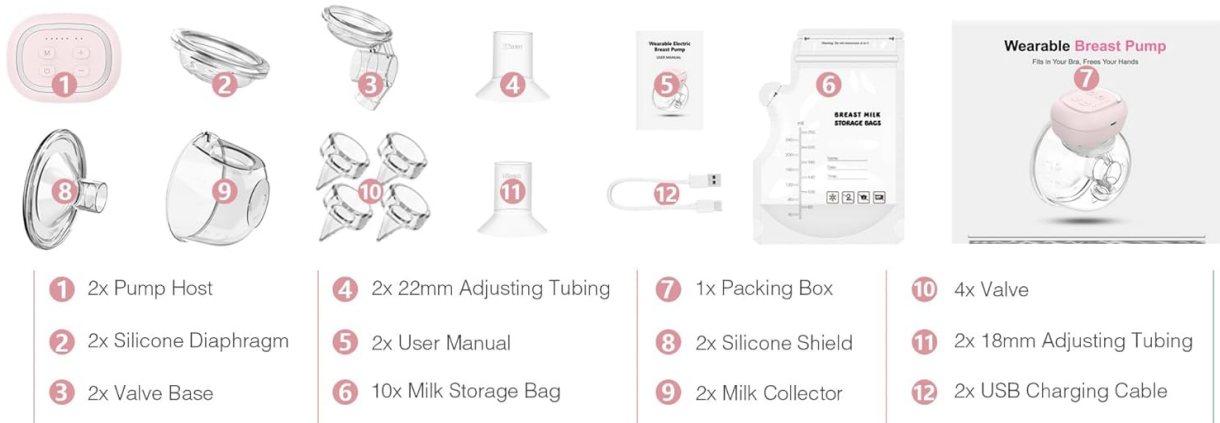

Image: Visual representation of cleaning the pump components, highlighting the food-grade and BPA-free silicone material.

## 7. TROUBLESHOOTING

If you encounter issues with your breast pump, refer to the following common solutions:

### • No Suction or Weak Suction:

- Check that all pump components are correctly assembled and securely sealed.
- Ensure the silicone diaphragm and valve are not damaged or torn.
- Verify the flange size is appropriate for your breast to ensure a proper seal.
- Check if the battery is sufficiently charged.

### • Pump Not Turning On:

- Ensure the pump is fully charged.
- Press and hold the power button for a few seconds.

### • Milk Leaking:

- Confirm all parts are correctly assembled and tightly sealed.

- Check for any damage to the silicone parts.
- Ensure the milk collector is not overfilled.

## 8. SPECIFICATIONS

Feature	Detail
Brand	Generic
Model	B0DYDFW42L
Material	Silicone
Power Source	Battery Powered
Special Features	Adjustable Suction, Hands Free Usage, Memory Function, Portable, Wearable
Included Components	Breast Flange (18mm, 22mm, 24mm), Milk Storage Bag, Power Cable, Valve, Pump Host, Silicone Diaphragm, Valve Base, User Manual, Adjusting Tubing, Milk Collector
Dimensions (approx.)	5.59 x 4.48 x 3.14 inches
Weight (approx.)	8.5 oz (240g)

# Quick Installation



- 1 Install silicone diaphragm and valve.



- 2 Assemble linker into the milk collector.



- 3 Install the silicone flange on the milk collector.



- 4 Assemble pump motor onto the milk collector.

Image: Visual representation of product dimensions and a comprehensive list of all included parts.

## 9. WARRANTY AND SUPPORT

For warranty information or technical support, please refer to the contact details provided with your purchase documentation. Keep your proof of purchase for any warranty claims.