

Manuals+

[Q & A](#) | [Deep Search](#) | [Upload](#)

Manuals.plus /

> [Inefala](#) /

> Inefala Android 15 Car Radio User Manual for Suzuki SX4 (2006-2013) and Fiat Sedici (2005-2014)

Inefala 2ba21f87-18ff-4355-ad45-79b956fcb744

Inefala Android 15 Car Radio User Manual

Model: 2ba21f87-18ff-4355-ad45-79b956fcb744

Brand: Inefala

1. INTRODUCTION

Thank you for choosing the Inefala Android 15 Car Radio. This device is designed to enhance your driving experience with advanced features such as Wireless Carplay, Android Auto, GPS navigation, Bluetooth connectivity, and a 9-inch touchscreen display. This manual provides essential information for proper installation, operation, and maintenance of your new car radio. Please read it thoroughly before use.

2. SAFETY INFORMATION

- Always ensure the vehicle is parked safely before operating the car radio's advanced features.
- Do not attempt to install or repair the unit if you are not qualified. Improper installation can lead to damage or injury.
- Consult a professional for electrical wiring if you are unsure.
- Keep the volume at a safe level to remain aware of road conditions and traffic.
- Avoid exposing the unit to extreme temperatures, direct sunlight for prolonged periods, or excessive moisture.

3. PACKAGE CONTENTS

Please check the box for the following items:

- Inefala Android 15 Car Radio for Suzuki SX4 / Fiat Sedici
- Power Cable
- RCA Cable
- GPS Antenna
- Reverse Camera Input Cable
- AHD Emergency Camera
- External Microphone
- 2 x USB Cables
- USB Cable Adapter

- Mounting Bracket
- Installation Tool

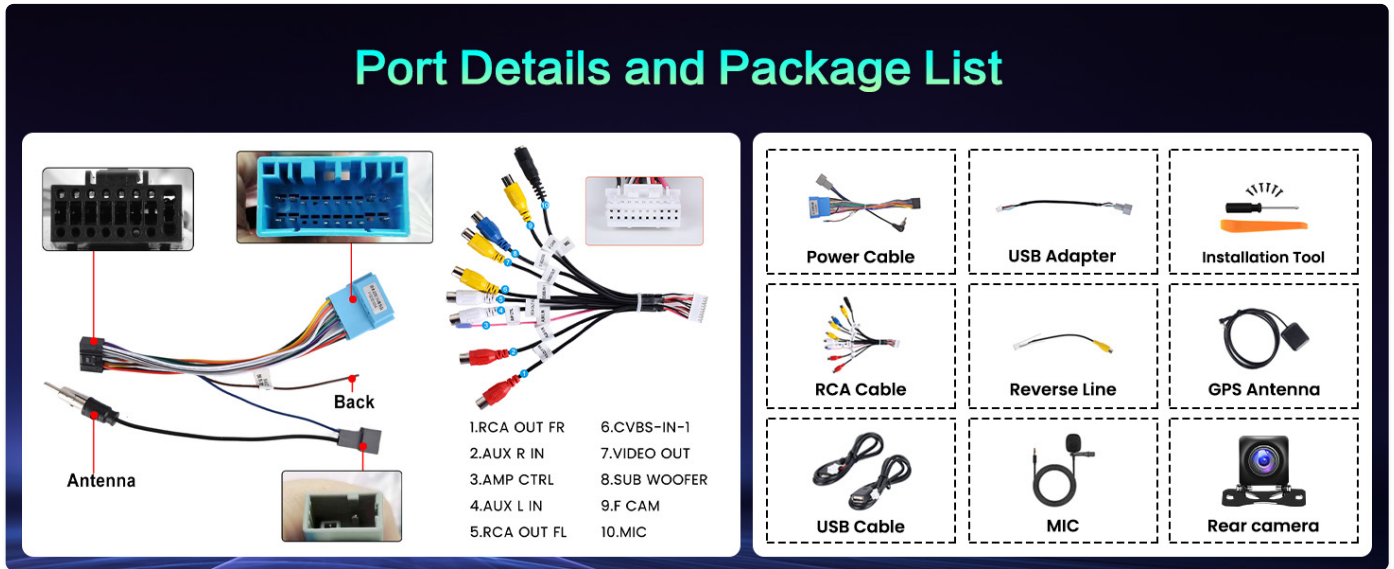

Image: Detailed view of the wiring harness and included accessories in the package.

4. SETUP AND INSTALLATION

4.1. General Installation Overview

The Inefala Android 15 Car Radio is designed for direct fitment in Suzuki SX4 (2006-2013) and Fiat Sedici (2005-2014) models. Professional installation is recommended. Ensure the vehicle's power is disconnected before starting installation.

For Suzuki SX4 2006–2013 Fiat Sedici 2005–2014



Before



After

Image: Comparison of the vehicle dashboard before and after the installation of the Inefala car radio.

4.2. Wiring Diagram

Connect the power cable, RCA cables, GPS antenna, and USB cables to their respective ports on the car radio. Refer to the detailed wiring diagram for correct connections.

Port Details and Package List

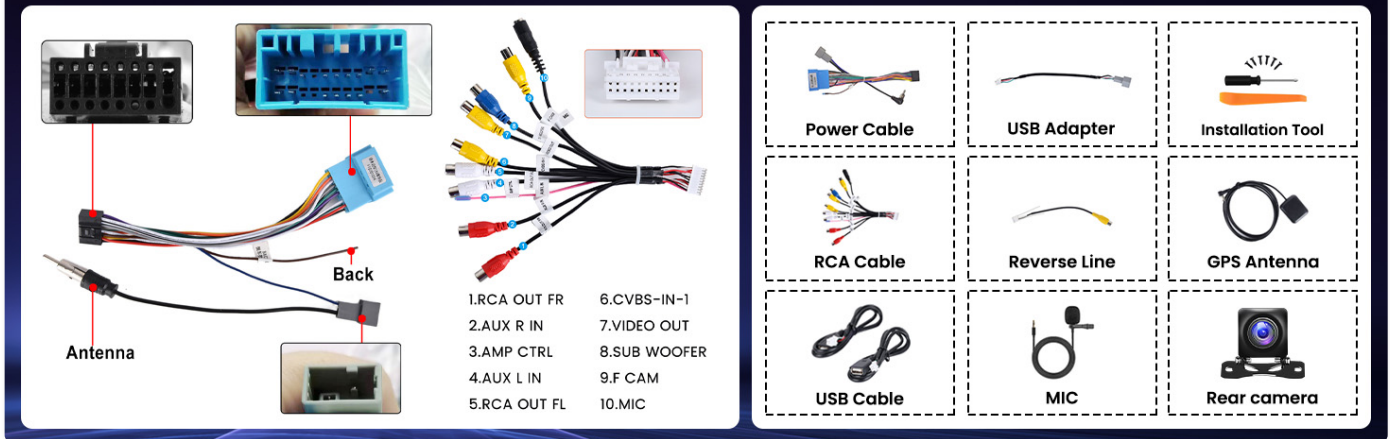

Image: Close-up of the car radio's rear ports and corresponding cable connections, including power, RCA, USB, and antenna inputs.

4.3. Backup Camera Connection

The unit supports an AHD backup camera. Connect the red cable of the reverse input cable to the positive terminal of the car's reverse light cable. Connect the black cable to the negative terminal of the car's reverse light cable. The other two red extension cables (if present) do not need to be connected.

Important Note:

The reverse input cable must be plugged in even if the reverse camera is not being used. Otherwise, it may affect Bluetooth and Wi-Fi signal reception.

How to Connect the Backup Camera?

Tips: The reverse input cable must be plugged in even if the reverse camera is not being used. Otherwise it will affect Bluetooth and WiFi signal reception.

Reversing Camera Wiring

Red Cable ①: Connects to the positive terminal of the car's reverse light cable

Black Cable ②: Connects to the negative terminal of the car's reverse light cable

There is no need to connect the other two red extension cables ③ and ④.

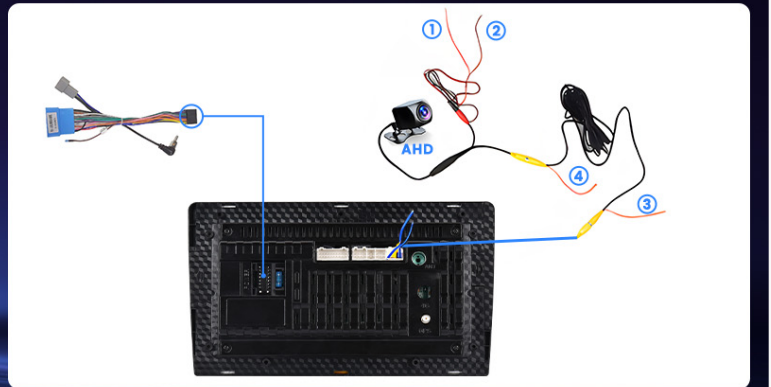

Image: Visual guide for connecting the AHD backup camera, illustrating the wiring to the car's reverse lights and the radio unit.

4.4. Steering Wheel Control (SWC)

To enable steering wheel controls, follow these steps:

- **Without CANBUS Decoder:** Connect the plugs or the steering wheel control wires (Key1/Key2) in the power cable to the corresponding port or wire of your original car. Then, go to "SWC manual match" in the radio settings to activate the button function.
- **With CANBUS Decoder:** Connect the CANBUS before powering on the radio. Then, follow this path: [Car Settings > Factory \(000000\) > CarType Setting](#) to make SWC work properly. First, select the brand of the CANBUS decoder, then select the matching model and year according to the actual situation.

Steering Wheel Control



Without CANBUS Decoder

Please connect the plugs or the steering wheel control wires(Key1/Key2) in the power cable to the corresponding port or wire of your original car, and then go to "SWC" manual match to activate the button function.

Contain CANBUS Decoder

Please connect the canbus before powering on the radio, and then follow this path (**Car Settings – Factory (000000) – CarType Setting**) to make SWC work properly. First select the brand of the canbus decoder, then select the matching model and year according to the actual situation.

Image: Diagram illustrating the connection points for steering wheel controls and a screenshot of the on-screen SWC configuration interface.

5. OPERATING INSTRUCTIONS

5.1. Power On/Off and Basic Navigation

Press the power button to turn the unit on or off. The 9-inch touchscreen allows for intuitive navigation through menus and applications. Swipe, tap, and pinch gestures are supported.

5.2. Android System and Applications

The car radio runs on Android 15 with 2GB RAM and 64GB internal storage. This allows for smooth operation and the ability to download various applications from the Google Play Store (requires Wi-Fi connection).

5.3. Wireless CarPlay and Android Auto

Connect your smartphone wirelessly via Bluetooth to access Apple CarPlay or Android Auto. This feature allows you to use navigation, make calls, send messages, and listen to music directly from your phone's interface displayed on the car radio screen.

Wireless Carplay & Android Auto



Image: Display of the car radio screen showing various applications accessible through Wireless Carplay and Android Auto, including navigation, music, and communication apps.

5.4. Mirror Link

Project your smartphone screen onto the car radio display via Wi-Fi or USB cable using the Mirror Link function. This allows you to view your phone's content directly on the larger screen.

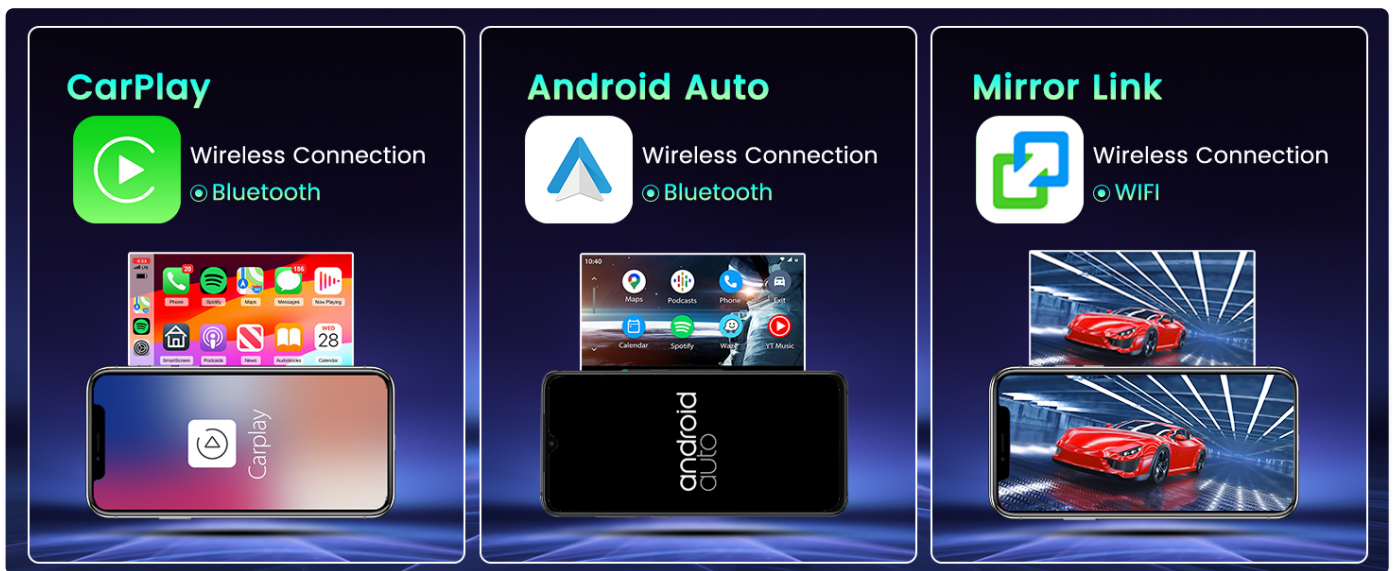
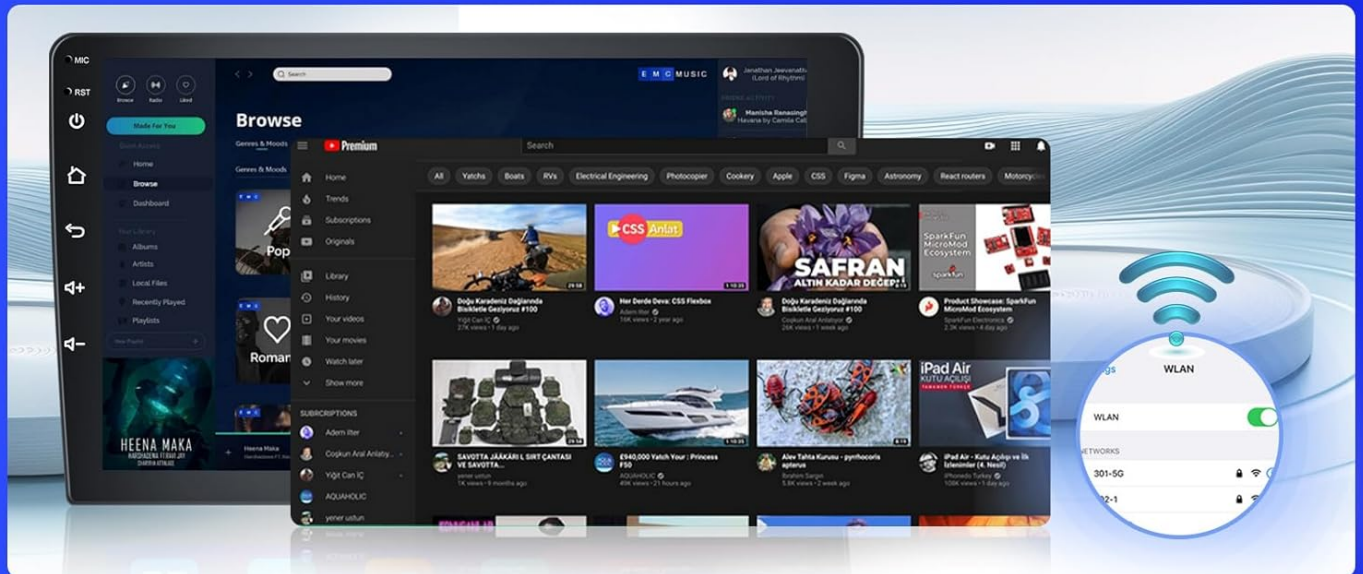

Image: Visual representation of the Carplay, Android Auto, and Mirror Link functionalities, showing how each projects phone content to the car radio screen.

5.5. GPS Navigation

The unit supports both online and offline GPS navigation. Connect to Wi-Fi to download maps or use real-time traffic information. The included GPS antenna ensures accurate positioning.

WiFi Connection



GPS Navigation



Image: The car radio screen displaying a navigation map with route information, alongside an illustration of Wi-Fi connectivity.

5.6. FM/RDS Radio

Tune into your favorite radio stations using the built-in FM/RDS tuner. RDS (Radio Data System) provides additional information such as station name and program type.

FM/RDS Radio



Built-in Bluetooth

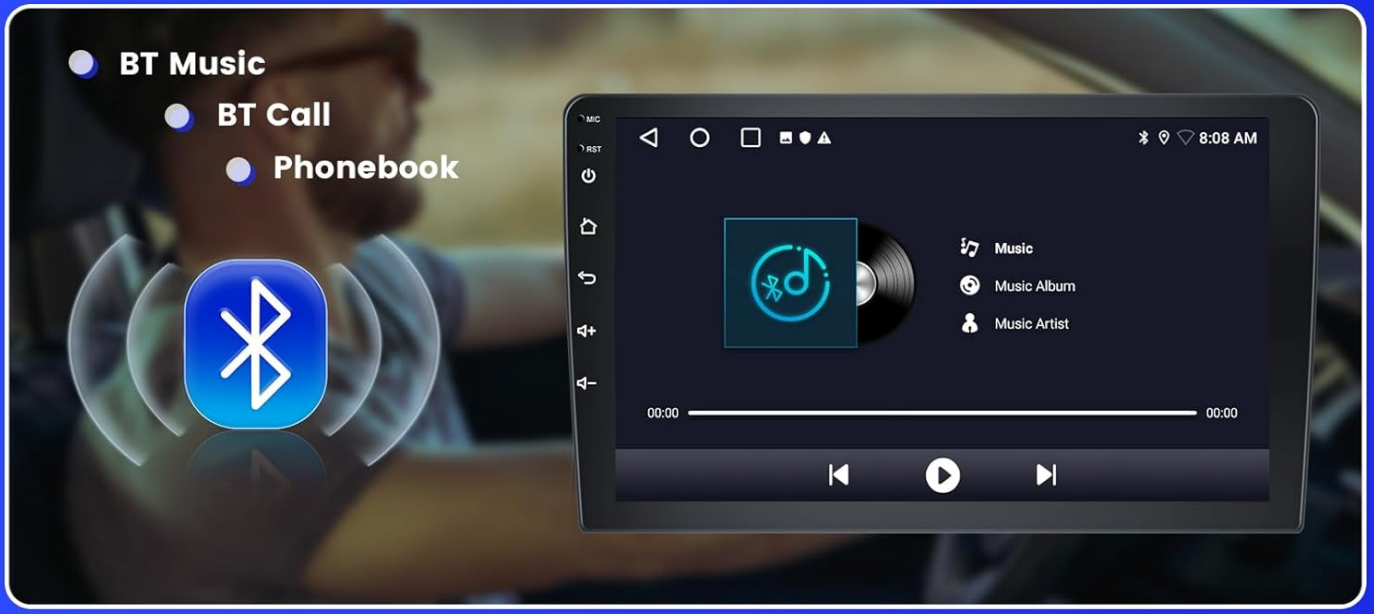

Image: The car radio screen displaying the FM radio interface with frequency selection and an illustration of Bluetooth music streaming.

5.7. Bluetooth Connectivity

Connect your phone via Bluetooth for hands-free calling, music streaming, and file transfer. Access your phonebook directly from the car radio display.

5.8. Wi-Fi Connection

Connect the car radio to a Wi-Fi hotspot (e.g., from your smartphone) to access online features, download apps, stream videos, and update maps.

5.9. Split Screen Function

The split-screen feature allows you to run and view two applications simultaneously on the 9-inch display, such as navigation and music playback.

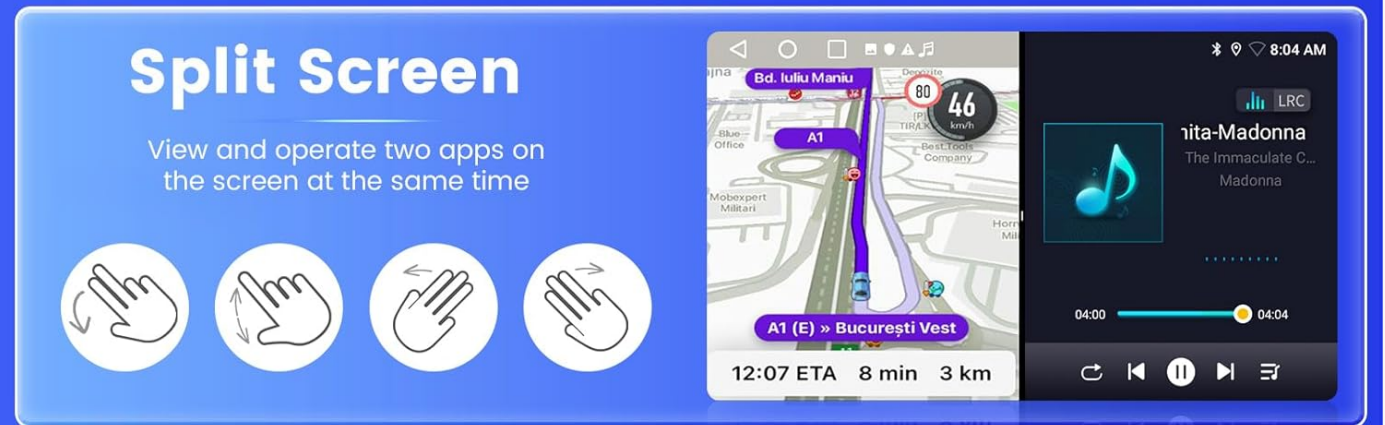

Image: The car radio screen demonstrating the Digital Sound Processor (DSP) settings, the split-screen functionality with two apps running, and a selection of 26 user interface themes.

5.10. Sound Settings (EQ & DSP)

Utilize the built-in EQ (Equalizer) and DSP (Digital Sound Processor) to customize your audio experience. Adjust sound output, balance, and various sound effects to match your preferences.

5.11. UI Themes

The car radio offers 26 different user interface themes. You can change the theme to personalize the look and feel of your display.

5.12. Backup Camera Display

When the vehicle is in reverse gear, the screen will automatically display the high-definition image from the AHD backup camera, providing a clear view for safer parking and maneuvering.

Steering Wheel Control



Backup Camera



Image: The car radio screen displaying the view from the backup camera, along with an illustration of steering wheel controls.

6. MAINTENANCE

- **Cleaning the Screen:** Use a soft, lint-free cloth to gently wipe the touchscreen. Do not use abrasive cleaners or solvents.
- **General Cleaning:** Keep the unit free from dust and debris. Use a dry cloth for cleaning the exterior.
- **Software Updates:** Periodically check for software updates via Wi-Fi to ensure optimal performance and access to new features.

7. TROUBLESHOOTING

Problem	Possible Cause	Solution
---------	----------------	----------

Problem	Possible Cause	Solution
Unit does not power on.	Loose power connection, blown fuse.	Check power cables and vehicle fuses. Ensure proper wiring.
No sound.	Volume too low, incorrect audio source, loose speaker wires.	Increase volume. Select correct audio source. Check speaker connections.
GPS signal lost or inaccurate.	GPS antenna obstructed or improperly connected.	Ensure GPS antenna is mounted in a clear location and securely connected.
Bluetooth/Wi-Fi issues.	Reverse input cable not connected (even if camera not used).	Ensure the reverse input cable is plugged into the unit.
Steering wheel controls not working.	Incorrect wiring or software configuration.	Verify SWC wiring. Follow configuration steps in Section 4.4.

8. SPECIFICATIONS

Feature	Detail
Model Name	2ba21f87-18ff-4355-ad45-79b956fcb744
Operating System	Android 15
RAM + ROM	2GB RAM + 64GB ROM
Screen Size	9 Inches
Screen Type	Touchscreen
Connectivity	Bluetooth, USB, Wi-Fi
Special Features	Wireless Carplay, Android Auto, Mirror Link, FM RDS Radio, EQ, DSP, GPS, 26 UI Themes, SWC (Steering Wheel Control), Double USB Input
Compatible Vehicles	Suzuki SX4 (2006-2013), Fiat Sedici (2005-2014)
Audio Output Mode	Stereo
Control Method	Touch
Product Weight	1.29 kg
Country of Origin	China

9. WARRANTY INFORMATION

This product comes with a [24-month warranty](#). Inefala provides lifetime online assistance for inquiries and aims to

respond within 24 hours.

10. CUSTOMER SUPPORT

If you encounter any difficulties during installation or use, or have any questions regarding your Inefala car radio, please contact our customer support team.

You can reach us through the Amazon platform by clicking on the seller name "Inefala" and then selecting "Ask a question". Alternatively, you may contact our customer service team via email at inefalaservices@163.com.

We strive to respond to all inquiries within 24 hours, regardless of holidays.

The image is a screenshot of an Amazon product page for Inefala. At the top, a large green heading asks "¿Cómo podemos ayudarte rápidamente?". Below this, the page is divided into two main sections: "Step1" and "Step2".

Step1 contains several key elements:

- A yellow button labeled "Añadir a la cesta" (Add to cart).
- An orange button labeled "Comprar ya" (Buy now).
- Logistics information: "Envío desde Amazon" (Shipping from Amazon), "Vendido por Inefala" (Sold by Inefala), and "Devoluciones" (Returns).
- Payment and service: "Pago Transacción segura Amazon" (Payment Secure Transaction Amazon) and "Atención al cliente" (Customer service).

Step2 provides detailed information about the seller and their support:

- A heading "Acerca del [seller name]" followed by "Bienvenidos a la tienda Inefala" (Welcome to the Inefala store).
- A sub-heading "¿Por qué elegirnos?" (Why choose us?).
- A description of their support: "Equipo de soporte técnico profesional y equipo de servicio al cliente para su experiencia de compra." (Professional technical support team and customer service team for your shopping experience).
- A note that if a customer has any difficulty or doubt during installation or use, they can contact the seller (Inefala) through the Amazon platform or via email at inefalaservices@163.com.
- A promise of response time: "Todos los mensajes serán respondidos dentro de las 24 HORAS independientemente de los días festivos" (All messages will be responded to within 24 HOURS regardless of holidays).
- A warranty statement: "de un año, desde el principio hasta el final desde el punto de vista del cliente para resolver el problema." (one year, from start to finish from the customer's perspective to solve the problem).
- A closing message: "Por último, por supuesto, ¡te deseo un Feliz Shopping! ❤️❤️" (Finally, of course, I wish you a Happy Shopping!).
- A link to "Ver menos" (View less).

In the top right corner of the Step2 section, there is a red-bordered box containing the text "¿Tiene alguna pregunta para Inefala?" (Do you have any questions for Inefala?) and a button labeled "Hacer una pregunta" (Ask a question).

Image: Guide showing how to locate the "Ask a question" option on Amazon to contact Inefala customer support.