

SSUPD Meshroom S V2 No PCIe

SSUPD Meshroom S V2 Mini-ITX Gaming PC Case Instruction Manual

Model: Meshroom S V2 No PCIe

1. INTRODUCTION

The SSUPD Meshroom S V2 is an ultra-compact 15L Mini-ITX gaming PC case designed for maximizing performance within minimal space. This manual provides essential information for the proper setup, operation, and maintenance of your Meshroom S V2 PC case, ensuring optimal performance and longevity.

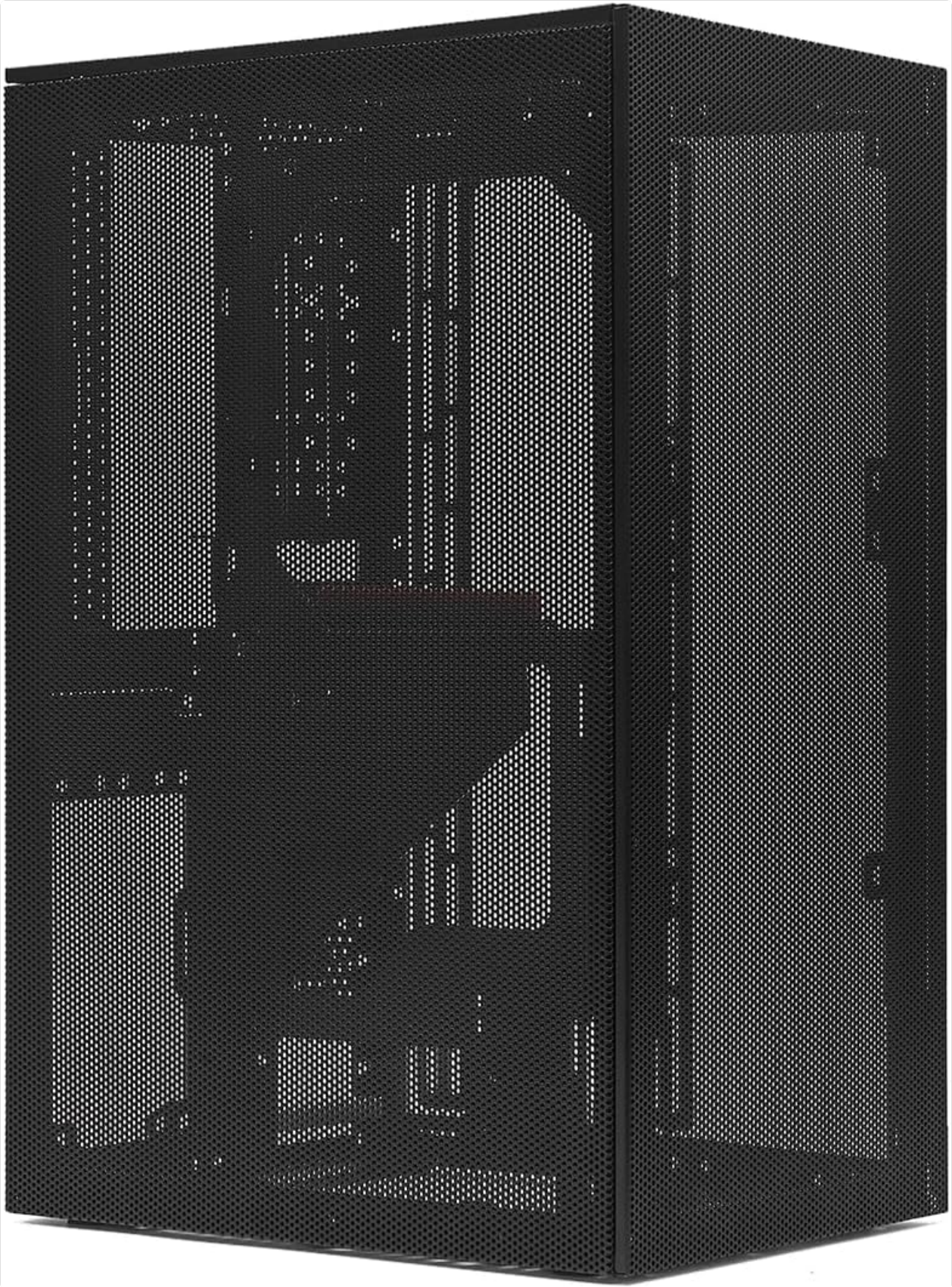

Figure 1.1: Front view of the SSUPD Meshroom S V2 Mini-ITX PC Case, showcasing its full mesh design.

2. KEY FEATURES

The Meshroom S V2 offers a range of features designed for high-performance small form factor builds:

- **Ultra-Compact 15L Design:** Maximizes performance in minimal space with flexible motherboard support.

- **Flexible Motherboard Compatibility:** Features an adjustable internal motherboard tray that supports ITX, MATX, and ATX motherboards (requires extra length PCIe riser cable for MATX and ATX setup).
- **Extensive GPU Compatibility:** Supports 4-slot GPUs up to 152mm width and, with optional 30–50mm aluminum feet, fits GPU lengths up to 353mm, suitable for high-end RTX 5090 and Radeon builds.
- **Advanced Cooling Support:** Compatible with a 240/280mm AIO on the front mounting bracket. Supports dual-radiator custom loop designs and accommodates a DDC pump. CPU cooler max height is 74mm.
- **Versatile PSU Support:** Accommodates SFX, SFX-L, or ATX power supplies up to 170mm in length.
- **Superior Airflow:** Fully breathable mesh panels on all sides provide excellent ventilation.
- **Tool-less Assembly:** External panels are tool-less for easy assembly and maintenance.
- **High-Quality Construction:** Made from powder-coated SGCC steel for durability.
- **Front I/O Ports (Variant B):** Includes 1x USB 3.2 Gen 2 Type-C (20 Gbps), 1x USB 3.0 Type-A (5 Gbps), and 1x Power Button.



Figure 2.1: The Meshroom S V2 with internal fans, demonstrating its cooling capabilities.



Figure 2.2: Internal view showing an All-in-One (AIO) liquid cooling solution installed.

3. SETUP AND INSTALLATION

Follow these general steps for assembling your PC within the Meshroom S V2 case. Refer to your component manuals for specific installation details.

1. **Unpacking and Inspection:** Carefully remove the case from its packaging. Inspect for any shipping damage.
2. **Panel Removal:** The external mesh panels are tool-less. Gently pull them off to access the internal frame.
3. **Motherboard Installation:** Install your Mini-ITX, Micro-ATX, or ATX motherboard onto the adjustable motherboard tray. Secure it with screws. Adjust the tray position as needed for larger motherboards.
4. **CPU and Cooler Installation:** Install your CPU and CPU cooler onto the motherboard before placing it in the case, if possible. Ensure the CPU cooler height does not exceed 74mm.
5. **GPU Installation:** Install your graphics card. The case supports 4-slot GPUs. If using a riser cable (required for MATX/ATX motherboards or vertical GPU mounting), connect it securely.
6. **Power Supply Installation:** Mount your SFX, SFX-L, or ATX power supply (up to 170mm) in its designated position.
7. **Storage Installation:** Install any 2.5-inch or 3.5-inch storage drives into the available bays.
8. **Cable Management:** Route all power and data cables neatly to ensure optimal airflow and a clean build. Utilize cable ties or straps.
9. **Cooling System Installation:** Install any additional case fans or AIO liquid coolers. The front bracket supports 240/280mm AIOs.

10. **Panel Reinstallation:** Once all components are installed and cables are managed, reattach the mesh panels.

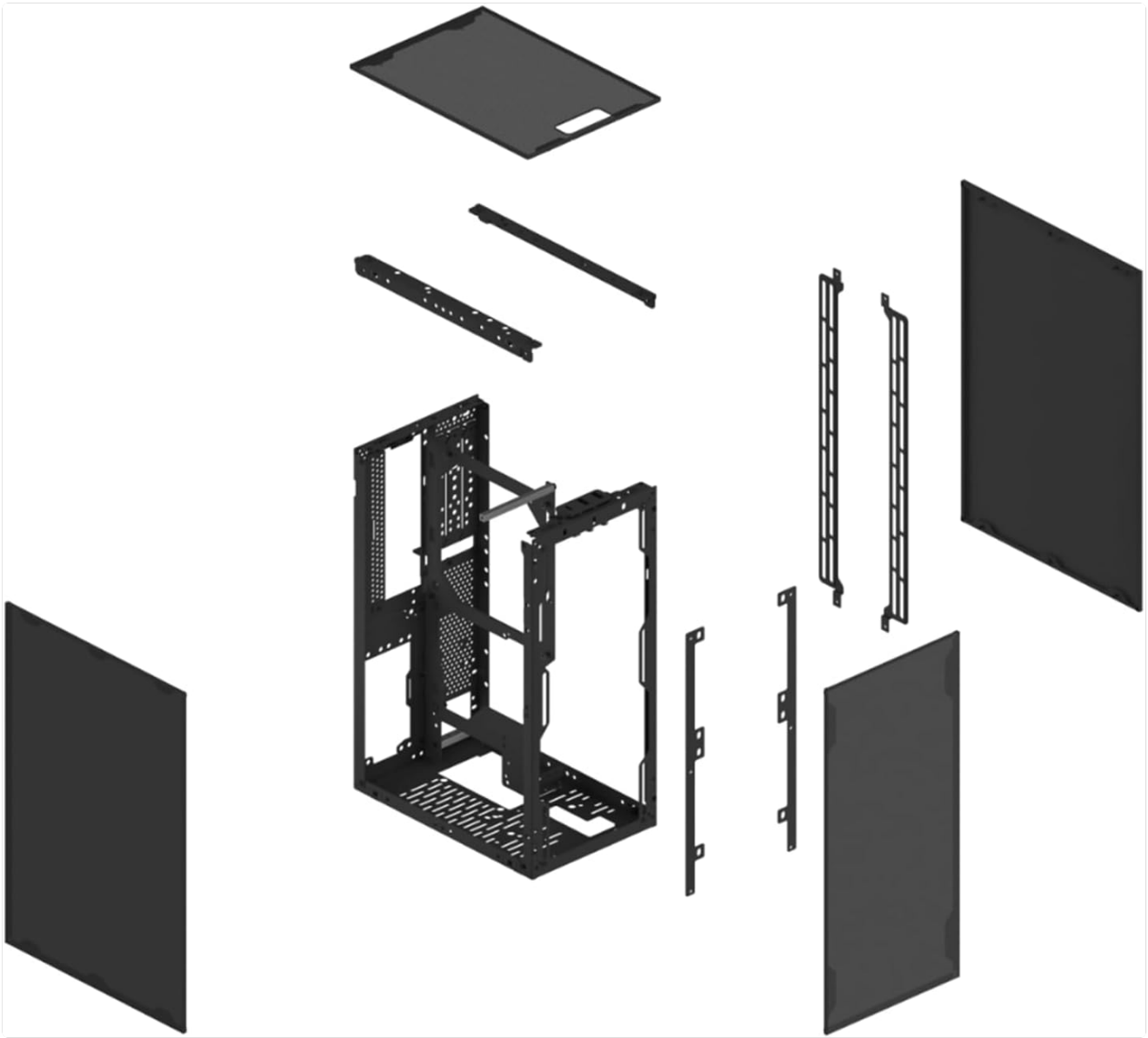

Figure 3.1: Exploded view illustrating the various components of the Meshroom S V2 case.



Figure 3.2: Various internal configurations demonstrating component placement flexibility.

4. OPERATING PRINCIPLES

The SSUPD Meshroom S V2 is designed for efficient thermal performance in a small form factor. Its full mesh panels allow for unrestricted airflow, which is crucial for cooling high-performance components.

- **Airflow:** Ensure that intake and exhaust fans are properly oriented to create a positive or neutral pressure system, preventing dust buildup and optimizing cooling.
- **Component Compatibility:** Always verify component dimensions (GPU length/width, PSU length, CPU cooler height, radiator size) against the case specifications to ensure proper fit and avoid clearance issues.
- **Cable Management:** Proper cable routing is essential not only for aesthetics but also for maintaining unobstructed airflow within the compact chassis.



Figure 4.1: Internal view showing a graphics card and cooling fans installed, highlighting internal layout.

5. MAINTENANCE

Regular maintenance helps preserve the performance and appearance of your Meshroom S V2 PC case.

- **Dust Cleaning:** Periodically clean the mesh panels and internal components to prevent dust accumulation, which can impede airflow and cooling efficiency. Use compressed air or a soft brush.
- **Exterior Cleaning:** Wipe the exterior surfaces with a soft, damp cloth. Avoid abrasive cleaners or solvents.
- **Component Checks:** Occasionally check all internal connections (power, data, fan headers) to ensure they are

secure.

6. TROUBLESHOOTING

This section addresses common issues you might encounter.

6.1. Power Issues

- **No Power:** Ensure the power supply is properly connected to the wall outlet and the motherboard. Check the power button cable connection to the motherboard's front panel header.
- **Intermittent Power:** Verify all internal power connections (24-pin ATX, CPU, GPU, storage) are seated firmly.

6.2. Component Fit Issues

- **GPU Not Fitting:** Confirm the GPU length and width are within the case's specifications. Ensure the motherboard tray is adjusted correctly if using a larger motherboard.
- **Cooler Clearance:** Double-check CPU cooler height against the 74mm maximum. For AIOs, ensure radiator and fan thickness do not cause interference.

6.3. Overheating

- **High Temperatures:** Verify that all fans are spinning and oriented correctly for optimal airflow. Ensure CPU cooler and GPU fans are functioning. Clean any dust buildup from mesh panels and components.
- **AIO Not Cooling:** Check pump and fan connections for your AIO. Ensure the radiator is not obstructed.

7. SPECIFICATIONS

Feature	Specification
Brand	SSUPD
Model Name	Meshroom S V2 No PCIe
Item Weight	9.79 pounds (4.45 Kilograms)
Package Dimensions	17.13 x 12.4 x 7.68 inches
Color	Black 2
Motherboard Compatibility	Mini ITX, Micro ATX, ATX
Case Type	Mini-Tower
Power Supply Mounting Type	Bottom Mount



Feature	Specification
Cooling Method	Air, Water
Total Internal Bays	2
Compatible Devices	Full-size GPU, ATX PSU, 280 AIO cooler, Mini-ITX, Mini-DTX, Micro-ATX, ATX motherboards

8. WARRANTY AND SUPPORT

For warranty information and technical support, please refer to the official SSUPD website or contact their customer service directly. Keep your proof of purchase for warranty claims.

- **Online Resources:** Visit the SSUPD official website for the latest drivers, FAQs, and support documentation.
- **Customer Service:** Contact SSUPD customer support for assistance with product issues or technical inquiries.

Related Documents

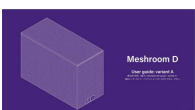
	<p>SSUPD Meshroom S V2 PC Case User Guide</p> <p>User guide for the SSUPD Meshroom S V2 PC case. Features detailed specifications, component compatibility, and step-by-step build instructions for ITX and ATX/MATX configurations. Includes model numbers CS-MRS-P5-BK and CS-MRS-P5-WT.</p>
	<p>Meshroom S V2 Advance User Guide: Variant B</p> <p>Detailed installation and customization guide for the ssupd Meshroom S V2 PC case. Learn how to build high-performance PCs with custom water cooling, ATX/ITX motherboards, and various component configurations.</p>
	<p>SSUPD Meshroom D PC Case: User Guide & Build Instructions</p> <p>Explore the SSUPD Meshroom D PC case with this comprehensive user guide. Discover detailed specifications, compatibility, case overview, and build instructions for ITX and MATX systems, including air and water cooling setups.</p>
	<p>Meshroom D PC Case: User Guide for Variant A</p> <p>This user guide provides comprehensive information on the ssupd Meshroom D PC case, including detailed specifications, step-by-step build guides for ITX and MATX configurations with air or water cooling, case component overview, and accessory contents.</p>