

[Manuals.plus](#) /

> [Inefala](#) /

> Inefala 4+64G Android Car Stereo User Manual for Toyota Yaris/Vizi (2005-2011)

Inefala Inefala-A4071A4MI2IT53-C490

Inefala 4+64G Android Car Stereo User Manual

For Toyota Yaris/Vizi (2005-2011) - Model: Inefala-A4071A4MI2IT53-C490

1. INTRODUCTION

Thank you for choosing the Inefala 4+64G Android Car Stereo. This manual provides essential information for the proper installation, operation, and maintenance of your new car stereo system. Please read this manual thoroughly before use to ensure optimal performance and safety.

Package Contents

Verify that all items listed below are included in your package:

- Inefala Android Car Stereo Unit
- Power Cable
- RCA Cable Set
- GPS Antenna
- Rear Camera Input Cable
- AHD Emergency Camera
- External Microphone
- 2 x USB Cables
- Mounting Accessories
- Installation Tool

For Toyota Yaris/Vizi 2005-2011



After Installation



Before Installation

Figure 1.1: Comparison of the dashboard before and after the Inefala car stereo installation. The top image displays the new 9-inch Android screen seamlessly integrated, while the bottom image shows the original factory radio.

2. SAFETY INFORMATION

Please observe the following safety guidelines to prevent injury or damage to the device:

- **Professional Installation Recommended:** Due to the complexity of car electrical systems, professional installation is highly recommended.
- **Power Source:** Connect the unit only to a 12V DC power supply with a negative ground.
- **Wiring:** Ensure all wiring is correctly connected according to the wiring diagram. Incorrect wiring can cause damage or fire.
- **Driving Safety:** Do not operate the unit in a way that distracts you from driving. Always prioritize road safety.
- **Temperature:** Avoid exposing the unit to extreme temperatures or direct sunlight for prolonged periods.

3. SETUP & INSTALLATION

This section provides general guidance for installing your Inefala car stereo. For detailed vehicle-specific instructions, consult a professional installer or your vehicle's service manual.

Installation Steps Overview:

1. **Disconnect Battery:** Before starting, disconnect the vehicle's negative battery terminal to prevent electrical shorts.
2. **Remove Old Unit:** Carefully remove the factory radio and trim panels.
3. **Connect Wiring:** Connect the power cable, RCA cables, GPS antenna, USB cables, external microphone, and rear camera input cable to the corresponding ports on the new unit and the vehicle's harness. Ensure secure connections.
4. **Mount Unit:** Secure the Inefala car stereo into the dashboard using the provided mounting accessories.
5. **Reconnect Battery:** Reconnect the vehicle's negative battery terminal.
6. **Test Functionality:** Turn on the vehicle and test all functions of the car stereo.

Connecting the AHD Rear Camera:

Connect the AHD emergency camera to the dedicated rear camera input cable. Ensure the camera is mounted securely at the rear of the vehicle for optimal visibility. The system is designed to automatically display the rear view when the vehicle is shifted into reverse gear.

4. OPERATING INSTRUCTIONS

Your Inefala car stereo runs on an Android operating system, offering a wide range of features and customization options.

4.1 Android System (4GB+64GB)

The unit features 4GB of RAM and 64GB of internal storage, providing a fast and stable operating environment. You can download and install various applications from the Google Play Store via Wi-Fi.

4.2 Wireless Carplay / Android Auto & Mirror Link

Connect your smartphone wirelessly or via USB to access Carplay or Android Auto. This allows you to use navigation, make calls, send messages, and listen to music directly from your phone's interface on the car stereo screen. The Mirror Link function allows you to mirror your phone's screen onto the car stereo display.

Wireless Carplay & Android Auto



Bluetooth



USB

Mirror Link

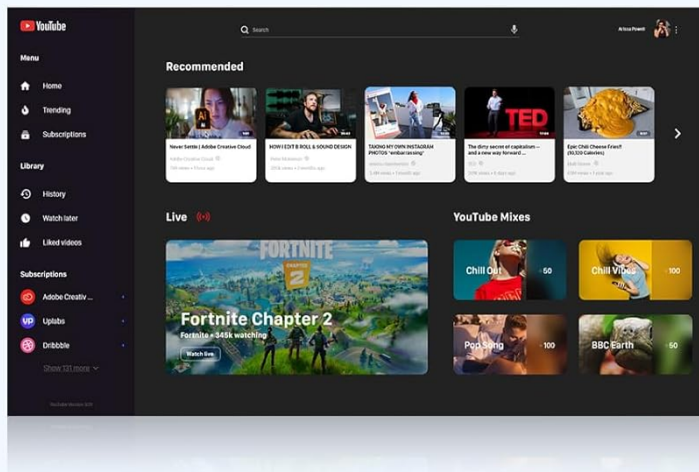

Figure 4.1: Overview of wireless connectivity features including Carplay, Android Auto, Bluetooth, USB, and Mirror Link. The image demonstrates how a smartphone's display can be mirrored onto the car stereo screen.

4.3 GPS Navigation & Wi-Fi

The unit supports both online and offline GPS navigation. You can download offline maps for areas without internet access or use online navigation apps via Wi-Fi. Connect to a Wi-Fi hotspot to access online services, download apps, stream music, and watch videos.

WiFi Connection



GPS Navigation

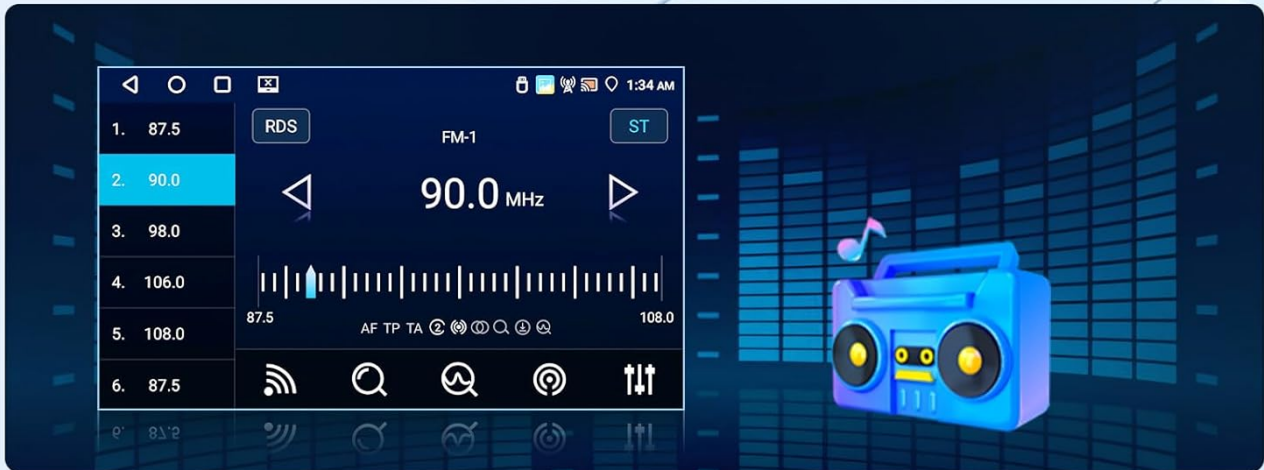

Figure 4.2: Displays the Wi-Fi connection interface, showing access to online content like YouTube, and a detailed GPS navigation map with route information and street names.

4.4 FM/RDS Radio & Bluetooth

Tune into your favorite FM radio stations with RDS (Radio Data System) support for displaying station information. The built-in Bluetooth allows for hands-free calling, phonebook synchronization, and wireless audio streaming from your smartphone.

FM/RDS Radio



Built-in Bluetooth



Figure 4.3: Illustrates the FM/RDS radio interface, displaying frequency and station information, alongside the Bluetooth interface for hands-free calling and phonebook access.

4.5 Split Screen Function

Utilize the split-screen feature to run two applications simultaneously. For example, you can have navigation open on one side and music playback on the other, enhancing multitasking capabilities.

4.6 DSP (Digital Sound Processor) with 32 EQ

The integrated DSP with a 32-band equalizer allows for precise audio customization. Adjust sound frequencies to match your preferences and optimize the audio output for your vehicle's acoustics.

Split Screen Function



32 EQ Function

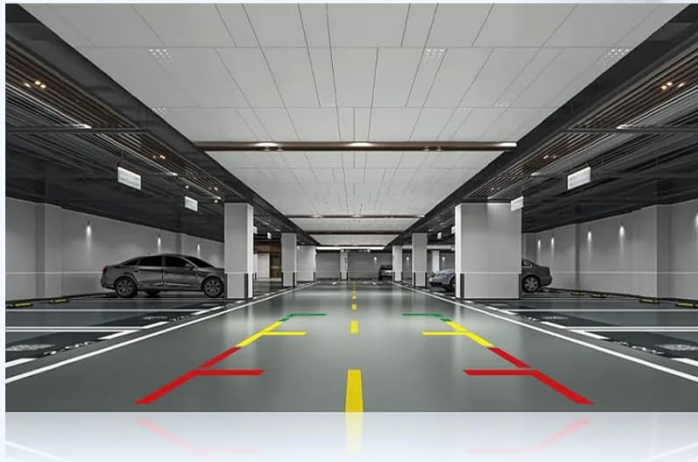

Figure 4.4: Demonstrates the split-screen feature, allowing two applications to run concurrently, and the 32-band equalizer interface for detailed audio tuning.

4.7 Rear View Camera & Steering Wheel Control (SWC)

The included AHD rear camera provides a clear view behind your vehicle, automatically activating when reverse gear is engaged. The unit supports steering wheel controls, allowing you to manage volume, change tracks, answer calls, and more without taking your hands off the wheel.

Rear View Camera



Steering Wheel Control

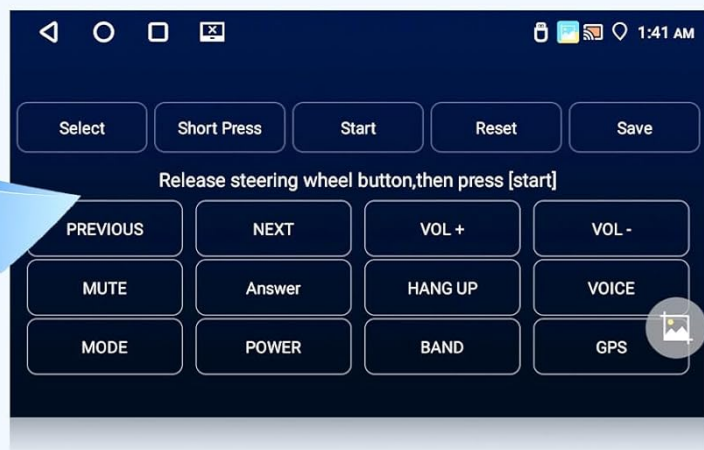

Figure 4.5: Illustrates the rear view camera display with dynamic parking guidelines and the user interface for programming steering wheel control buttons.

5. MAINTENANCE

Proper maintenance ensures the longevity and optimal performance of your car stereo.

- **Cleaning:** Use a soft, dry cloth to clean the screen and unit. Avoid abrasive cleaners or solvents.
- **Software Updates:** Periodically check for software updates via the system settings to ensure you have the latest features and bug fixes.
- **Avoid Liquids:** Do not expose the unit to water or other liquids.

6. TROUBLESHOOTING

If you encounter issues, refer to the following common problems and solutions:

- **No Power:**

- Check all power cable connections.
- Verify the vehicle's fuse for the radio.

- **No Sound:**

- Ensure speaker wires are correctly connected.
- Check volume levels and mute settings.
- Verify audio output settings.

- **GPS Signal Issues:**

- Ensure the GPS antenna is properly connected and has a clear view of the sky.
- Update GPS maps if necessary.

- **Bluetooth Connection Problems:**

- Ensure Bluetooth is enabled on both the car stereo and your smartphone.
- Delete previous pairings and try reconnecting.

- **Touch Screen Unresponsive:**

- Restart the unit.
- Ensure the screen is clean and free of debris.

If problems persist, contact customer support for assistance.

7. SPECIFICATIONS

Feature	Specification
Model Number	Inefala-A4071A4MI2IT53-C490
Operating System	Android
RAM + ROM	4GB + 64GB
Screen Size	9 inches
Connectivity Technology	Bluetooth, USB, Wi-Fi
Special Features	Wireless Carplay, Android Auto, Mirror Link, FM/RDS Radio, 32-band EQ (DSP), GPS, SWC (Steering Wheel Control)
Compatible Devices	Smartphone
Connector Type	RCA audio, RCA video
Audio Output Mode	APE/FLAC/WAV/MP3/WMA

Feature	Specification
Surround Sound Channels	4
Video Encoding	MKV/RMVB/AVI/MP4/MDV
Output Power	45 Watts
Internet Applications	YouTube, Pandora, iTunes (via smartphone)
Control Method	Touch
Country of Origin	China

8. WARRANTY & SUPPORT

Warranty Information:

This Inefala car stereo comes with a **24-month warranty** from the date of purchase, covering manufacturing defects. Please retain your proof of purchase for warranty claims.

Technical Support:

For any technical inquiries or assistance, Inefala offers **lifetime online support**. Our support team aims to respond to all inquiries within 24 hours.

To contact support, please refer to the seller's contact information on your purchase platform or visit the official Inefala website.