

[Manuals.plus](#) /

> [Inefala](#) /

> Inefala 9-inch Android Car Stereo User Manual for Renault Dacia SANDERO 2014-2017

Inefala Inefala-A7105A3662H1MI2IT53-C490

Inefala 9-inch Android Car Stereo User Manual

Model: Inefala-A7105A3662H1MI2IT53-C490 for Renault Dacia SANDERO (2014-2017)

INTRODUCTION

This manual provides detailed instructions for the installation, operation, and maintenance of your Inefala 9-inch Android Car Stereo. Please read this manual thoroughly before using the product to ensure proper function and safety. This unit is designed for Renault Dacia SANDERO models manufactured between 2014 and 2017.

PACKAGE CONTENTS

Verify that all items listed below are included in your package. If any items are missing or damaged, please contact customer support.

- Inefala Android Car Stereo Unit
- Power Cable
- Canbus Box
- RCA Cable
- GPS Antenna
- Rear Camera Input Cable
- AHD Rear View Camera
- External Microphone
- 2 USB Cables
- Radio Antenna
- Mounting Bracket
- Installation Tool

Port Details & Package List

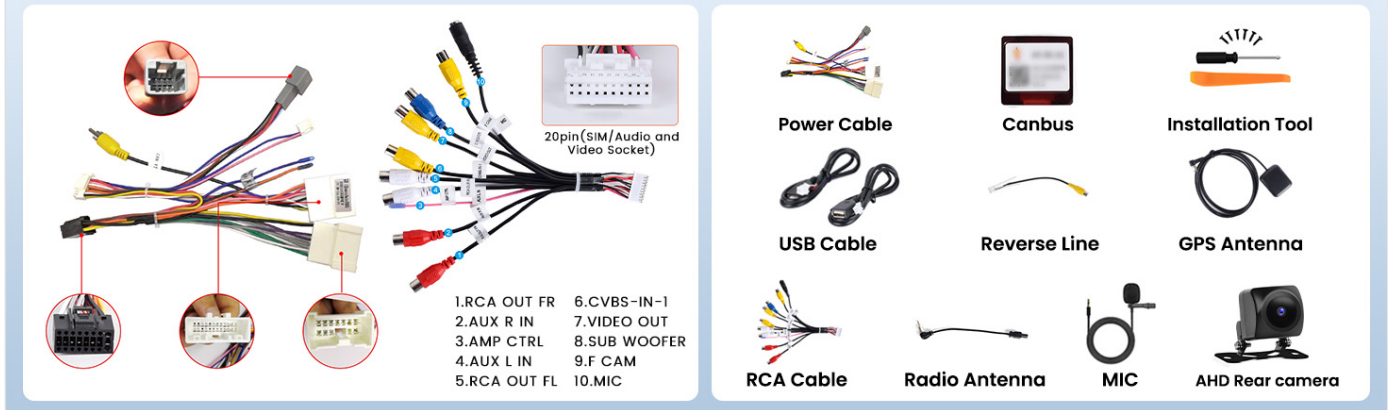

Image: Port Details & Package List. This image illustrates the various cables and components included in the package, such as the power cable, RCA cables, USB cables, GPS antenna, and the AHD rear camera.

SETUP AND INSTALLATION

Professional installation is recommended. Ensure the vehicle's power is disconnected before beginning installation.

1. General Wiring Connections

Connect the main power cable harness to the vehicle's wiring. Ensure all connections are secure. Refer to the vehicle's wiring diagram if necessary.

2. Rear View Camera Wiring

Proper connection of the rear view camera is crucial for its functionality and to avoid interference with Bluetooth and Wi-Fi signals.

- **Red Cable (1):** Connect to the positive terminal of the car's reverse light cable.
- **Black Cable (2):** Connect to the negative terminal of the car's reverse light cable.
- The two red extension cables (3) and (4) are typically not required for standard installations.

Rear View Camera & Canbus Wiring

Tips: The reverse input cable must be plugged in even if the reverse camera is not being used. Otherwise it will affect Bluetooth and WiFi signal reception.

Reversing Camera Wiring

Red Cable ①: Connects to the positive terminal of the car's reverse light cable

Black Cable ②: Connects to the negative terminal of the car's reverse light cable

There is no need to connect the other two red extension cables ③ and ④.

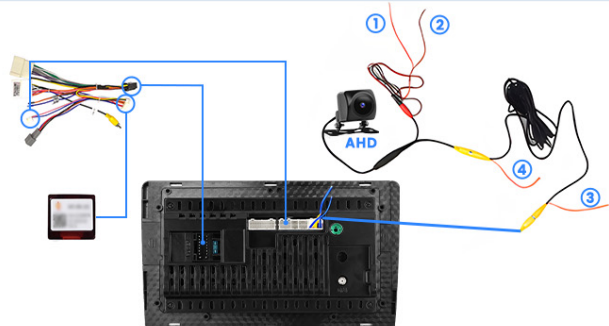

Image: Reversing Camera & Canbus Wiring. This diagram illustrates how to connect the reversing camera's red and black cables to the vehicle's reverse light system.

Tip: The reverse input cable must be plugged in even if the reverse camera is not being used. Otherwise, it may affect

3. Steering Wheel Control (SWC) Setup

The unit supports steering wheel controls for convenience. The setup method depends on whether your vehicle has a CANBUS decoder.

- **Without CANBUS Decoder:** Connect the plugs or the steering wheel control wires (Key1/Key2) in the power cable to the corresponding port or wire of your original car. Then, go to the "SWC" manual match settings to activate the button function.
- **With CANBUS Decoder:** Connect the CANBUS decoder. Then, follow this path: **Apps > Settings > Factory Settings (password: 8888) > Vehicle > Automotive type** to make SWC work properly. First, select the brand of the CANBUS, then select the matching model and year according to your vehicle's specifications.

Steering Wheel Control





Without CANBUS Decoder

Please connect the plugs or the steering wheel control wires(Key1/Key2) in the power cable to the corresponding port or wire of your original car, and then go to "SWC" manual match to activate the button function.

Contain CANBUS Decoder

Please connect the canbus before powering on the radio, and then follow this path (Apps – Settings – Factory Settings(8888) – Vehicle – Automotive type) to make SWC work properly. First select the brand of the canbus decoder, then select the matching model and year according to the situation.

Image: Steering Wheel Control. This image displays the car stereo's interface for programming steering wheel buttons and provides instructions for CANBUS and non-CANBUS setups.

For Renault Dacia SANDERO 2014-2017



After Installation



Before Installation

Image: Before and After Installation. This image shows the vehicle's dashboard before and after the Inefala car stereo has been installed, demonstrating the integrated look.

OPERATING INSTRUCTIONS

1. Android System Overview

Your car stereo runs on an Android system (version 15 or later), offering a fast and smooth interface with access to millions of applications. Navigate the system using the 9-inch touch screen.

2. Wireless CarPlay and Android Auto

Connect your smartphone to the car stereo wirelessly or via USB to use Wireless CarPlay or Android Auto. This allows you to access navigation, make calls, send messages, and listen to music directly from your phone's interface on the car stereo screen, controlled by voice or touch.

Wireless Carplay & Android Auto



Bluetooth



USB

Mirror Link



Image: Wireless CarPlay & Android Auto. This graphic demonstrates the connectivity options including CarPlay, Android Auto, Bluetooth, USB, and Mirror Link, showing how a phone screen can be mirrored to the stereo.

3. Mirror Link Function

Mirror Link allows you to display your smartphone's screen directly onto the car stereo. Connect your device via USB cable or Wi-Fi to activate this feature.

4. GPS and Wi-Fi Navigation

The unit supports both online and offline GPS navigation. You can download offline maps or use online navigation applications via Wi-Fi. Connect to a Wi-Fi hotspot to access online services, download apps, music, and videos.

WiFi Connection

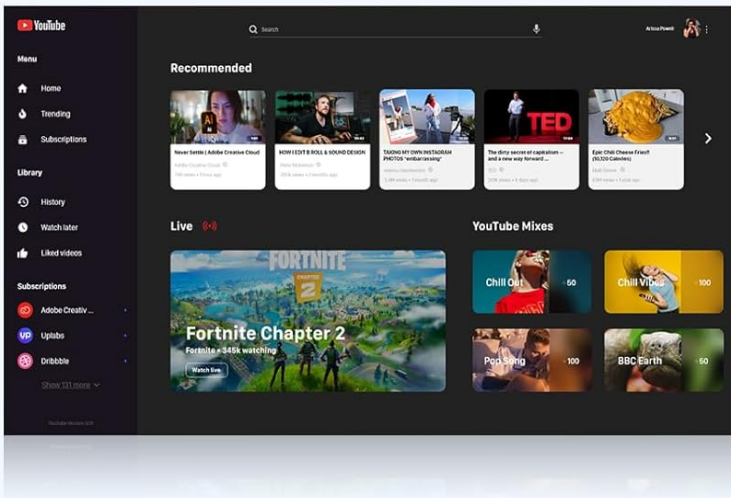

GPS Navigation



Image: WiFi Connection and GPS Navigation. This image displays the car stereo's interface for Wi-Fi connectivity and a map showing GPS navigation in action.

5. Bluetooth Connectivity

Pair your Bluetooth-enabled devices for hands-free calling, music streaming, and wireless file transfer. Access your phonebook directly from the stereo screen.

FM/RDS Radio



Built-in Bluetooth



Image: FM/RDS Radio and Built-in Bluetooth. This image illustrates the radio tuning interface and the Bluetooth hands-free calling screen, including a virtual dial pad.

6. FM/RDS Radio

Tune into your favorite radio stations with the built-in FM/RDS tuner. RDS (Radio Data System) provides additional information such as station name and program type.

7. 32-Band Equalizer (32EQ)

Customize your audio experience with the 32-band equalizer. Adjust frequency levels to match your preferences and optimize sound quality within your vehicle.

Split Screen Function



32 EQ Function



Image: Split Screen Function and 32 EQ Function. This image demonstrates the ability to run two applications simultaneously on the screen and the detailed controls of the 32-band equalizer.

8. Split Screen Function

Utilize the split-screen feature to run two applications simultaneously, such as navigation and music playback, enhancing multitasking capabilities.

9. Rear View Camera Display

When the vehicle is shifted into reverse, the screen will automatically display the image from the AHD rear view camera, providing a safer parking and reversing experience.

Rear View Camera

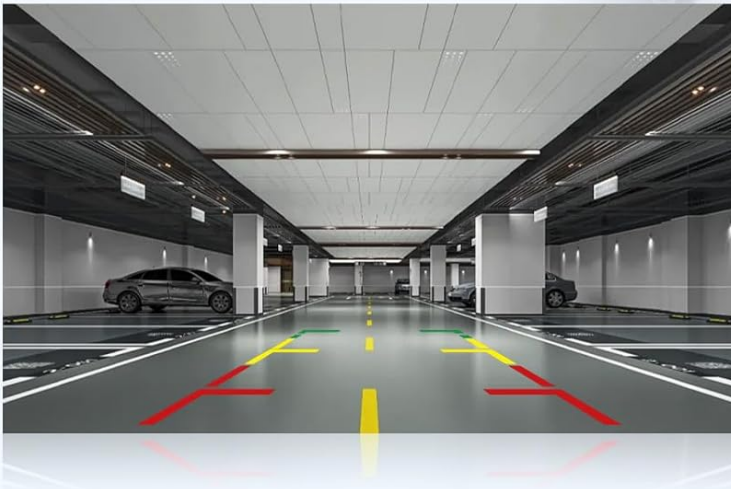

Steering Wheel Control

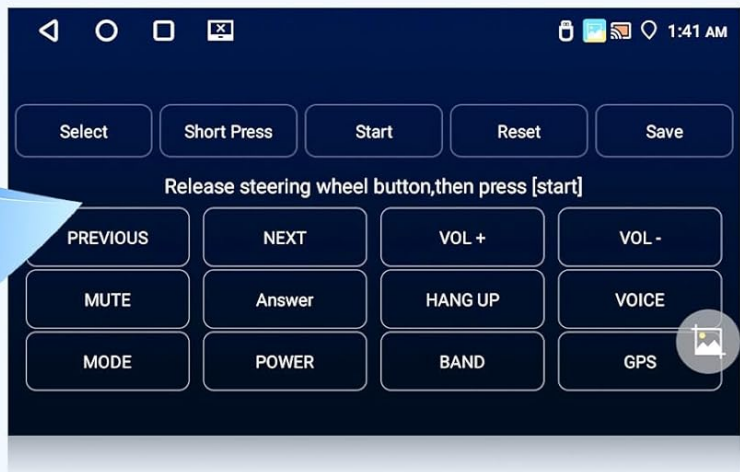

Image: Rear View Camera and Steering Wheel Control. This image shows the automatic display of the rear camera feed with parking guidelines when reversing, alongside the steering wheel control programming screen.

MAINTENANCE

- **Cleaning:** Use a soft, dry cloth to clean the screen and unit. Avoid abrasive cleaners or solvents.
- **Software Updates:** Periodically check for software updates to ensure optimal performance and access to new features. Updates can typically be performed via Wi-Fi.
- **Environmental Conditions:** Avoid exposing the unit to extreme temperatures, direct sunlight for prolonged periods, or excessive moisture.

TROUBLESHOOTING

Problem	Possible Cause	Solution
---------	----------------	----------

Problem	Possible Cause	Solution
Unit does not power on.	Incorrect power wiring; Blown fuse; Vehicle battery low.	Check all power connections. Verify vehicle fuses and battery charge. Consult a professional if unsure.
Rear camera not working or displaying.	Incorrect camera wiring; Reverse input cable not connected; Faulty camera.	Ensure the red and black camera wires are correctly connected to the reverse light. Verify the reverse input cable is plugged into the stereo. Test with another camera if possible.
Bluetooth/Wi-Fi signal issues.	Reverse input cable not connected; Antenna issues; Interference.	Ensure the reverse input cable is connected even if the camera is not in use. Check antenna connections. Move away from sources of interference.
Steering Wheel Controls not responding.	Incorrect wiring; Incorrect CANBUS settings; SWC not programmed.	Verify SWC wiring (Key1/Key2). If using CANBUS, ensure correct vehicle type is selected in Factory Settings. Manually program SWC buttons if no CANBUS.
Touch screen unresponsive.	Software glitch; Physical damage.	Restart the unit. If the problem persists, contact customer support.

SPECIFICATIONS

- **Brand:** Inefala
- **Model:** Inefala-A7105A3662H1MI2IT53-C490
- **Compatible Vehicles:** Renault Dacia SANDERO (2014-2017)
- **Operating System:** Android (version 15 or later)
- **Memory/Storage:** 4GB RAM + 64GB ROM
- **Screen Size:** 9 inches
- **Connectivity:** Bluetooth, USB, Wi-Fi
- **Special Features:** Wireless CarPlay, Android Auto, Mirror Link, GPS, FM/RDS Radio, 32-band Equalizer (32EQ), Steering Wheel Control (SWC), AHD Rear View Camera support
- **Audio Output Mode:** APE/FLAC/WAV/MP3/WMA
- **Video Encoding:** MKV/RMVB/AVI/MP4/MDV
- **Audio Output Type:** RCA, AHD, Bluetooth, HDMI/Optical
- **Speaker Surround Sound Channel Configuration:** 4
- **Electrical Power:** 45 Watts
- **Product Weight:** 1.72 kg
- **Package Dimensions:** 33.4 x 30.5 x 11.5 cm

WARRANTY AND SUPPORT

Warranty Information

This Inefala product comes with a **24-month quality assurance** period. Please retain your proof of purchase for warranty claims.

Return Policy

A **30-day free return** policy is available from the date of purchase. Refer to the retailer's return policy for detailed terms and conditions.

Technical Support

For any technical assistance or inquiries, Inefala offers **24/7 technical support**. You can expect an online reply within 24 hours. Please visit the Inefala store on Amazon or use the "Ask a question" feature on the product page to contact support.

[Visit the Inefala Store](#)