



Manuals.plus /

› Graywind /

› Graywind Smart Blackout Roller Shades (Model: GW-ARS-STQZ) Instruction Manual

Graywind GW-ARS-STQZ

Graywind Smart Blackout Roller Shades

MODEL: GW-ARS-STQZ

[Overview](#) [Installation](#) [Operation](#) [Maintenance](#) [Troubleshooting](#) [Specifications](#) [Warranty & Support](#)

1. Overview

The Graywind Smart Blackout Roller Shades provide complete light blockage and enhanced privacy, making them suitable for bedrooms, living rooms, media rooms, and offices. These shades feature a 100% blackout textured fabric with a waterproof back layer, contributing to energy efficiency. Designed with a cordless style for safety around children and pets, they are also RoHS certified for environmental friendliness. The shades come with a valance and a designed bottom bar for a customized appearance.

Key Features:

- **100% Blackout Fabric:** Textured fabric with waterproof backing for complete light control and privacy.
- **Zigbee Motor Solutions:** Direct compatibility with select Alexa devices (Echo Show 8 (3rd Gen), Echo Plus (2nd Gen), Echo Studio, Echo Show 10 (3rd Gen), Echo Show (2nd Gen), Echo (4th Gen), Echo Hub) without requiring an additional hub.
- **Smart Control:** Manage shades via app from anywhere, voice commands, group control, and percentage adjustments.
- **15-Channel Timing Remote:** Ergonomic remote with removable silicone case, supporting handheld or wall-mounted use. Controls up to 15 shades individually or in groups, with 20 date-time groups for automatic timing control.
- **Cordless Design:** Ensures safety for children and pets.
- **Customizable Options:** Valance and designed bottom bar for personalized aesthetics.

Zigbee Solution

Smart blinds can directly compatible with 7 Alexa devices, no hub required

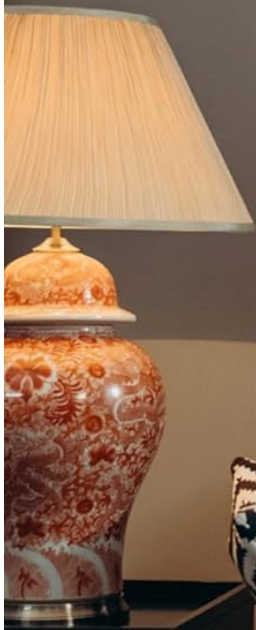

Echo Show 8(3.Gen) · Echo Plus (2.Gen) · Echo Studio
Echo Show 10(3.Gen) · Echo Show(2.Gen) · Echo(4.Gen) · Echo Hub

Figure 1: Graywind Smart Roller Shade featuring Zigbee Solution and compatible Alexa devices.

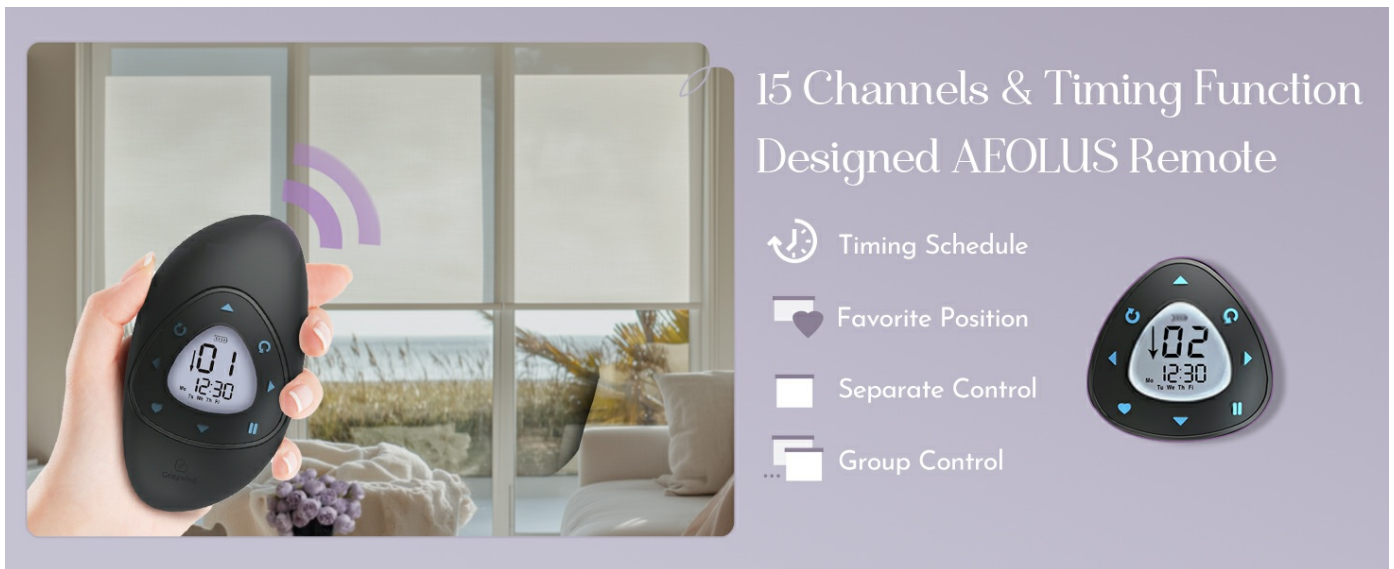

Figure 2: Overview of Graywind Smart Blackout Roller Shades and their compatibility with Alexa devices.

2. Installation

Proper measurement and installation are crucial for the optimal performance and appearance of your Graywind Smart Roller Shades. Please follow these guidelines carefully.

2.1. Measuring Your Window

Before installation, accurately measure your window for either an inside mount or an outside mount. Always measure at three points (top, middle, bottom for width; left, middle, right for height) and use the smallest measurement to ensure a proper fit.

MEASUREMENT

⚠ IMPORTANT

INSIDE MOUNT

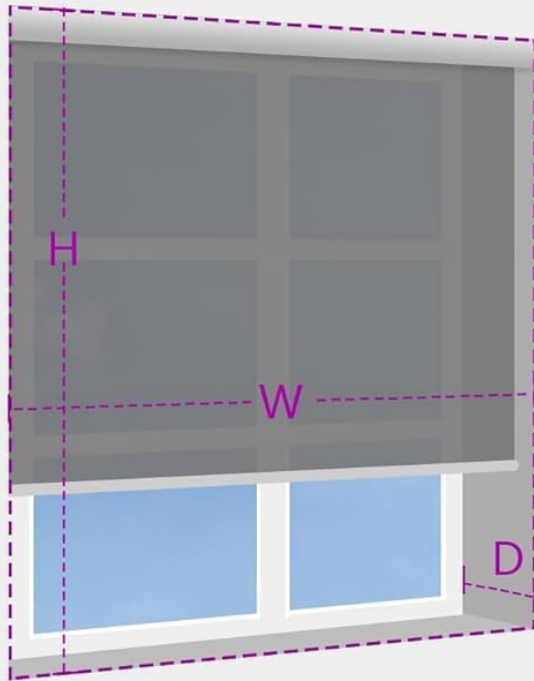

product Width (**W**) = Order Width-0.1"
Order Height (**H**) = product Height
window depth (**D**) ≥ 1.87 "/4.7cm

* When the depth of window frame is less than 2 3/4", the valance will extend beyond the window frame.

OUTSIDE MOUNT

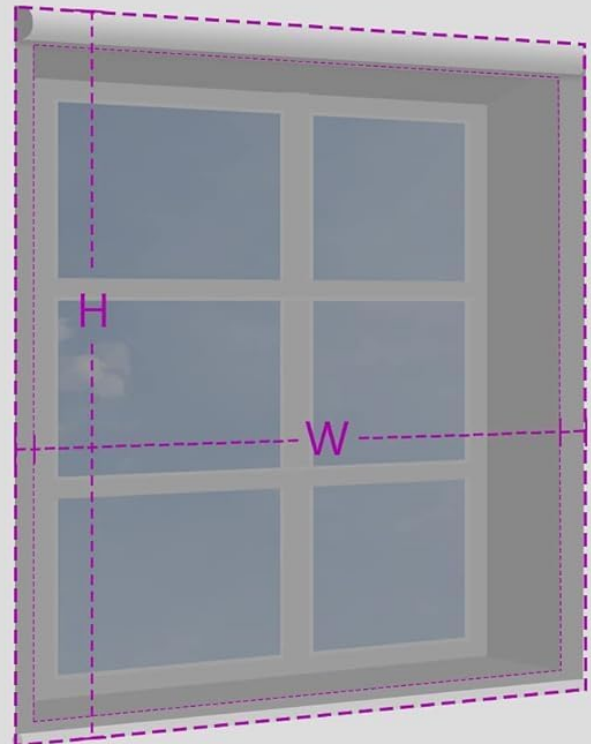

Order Width (**W**) = Window Width + 1-6"
Order Height (**H**) = Window Height + 1-6"

* Please increase the width and height of the window based on your use environment and shading requirements.

NOTE: Please DO NOT measure the size of fabric!



59" Extension Cords
(Extension Cord Optional)



Figure 3: Detailed instructions for measuring window dimensions for both inside and outside mount installations.

Inside Mount:

- Measure the exact width of the window opening at the top, middle, and bottom. Record the smallest measurement.
- Measure the exact height of the window opening at the left, middle, and right. Record the smallest measurement.
- Measure the frame depth. A minimum depth of 1.87 inches is required for inside mount. If the depth is less than 2.75 inches, the valance may extend beyond the window frame.
- Be aware of any obstructions like window handles or cranks. Ensure sufficient clearance.

- Note that for inside mount, there will be a 0.6-inch light gap on the motor side and a 0.4-inch gap on the other side due to hardware space.

Outside Mount:

- For outside mount, add 1 to 6 inches to your measured window width and height to ensure full coverage and better blackout.
- Consider the placement of the shades relative to the window frame to avoid light leakage.

2.2. Mounting Hardware

Your Graywind shades come with mounting hardware. Ensure you have all necessary tools, including a tape measure, pencil, drill, hammer, and screwdriver.

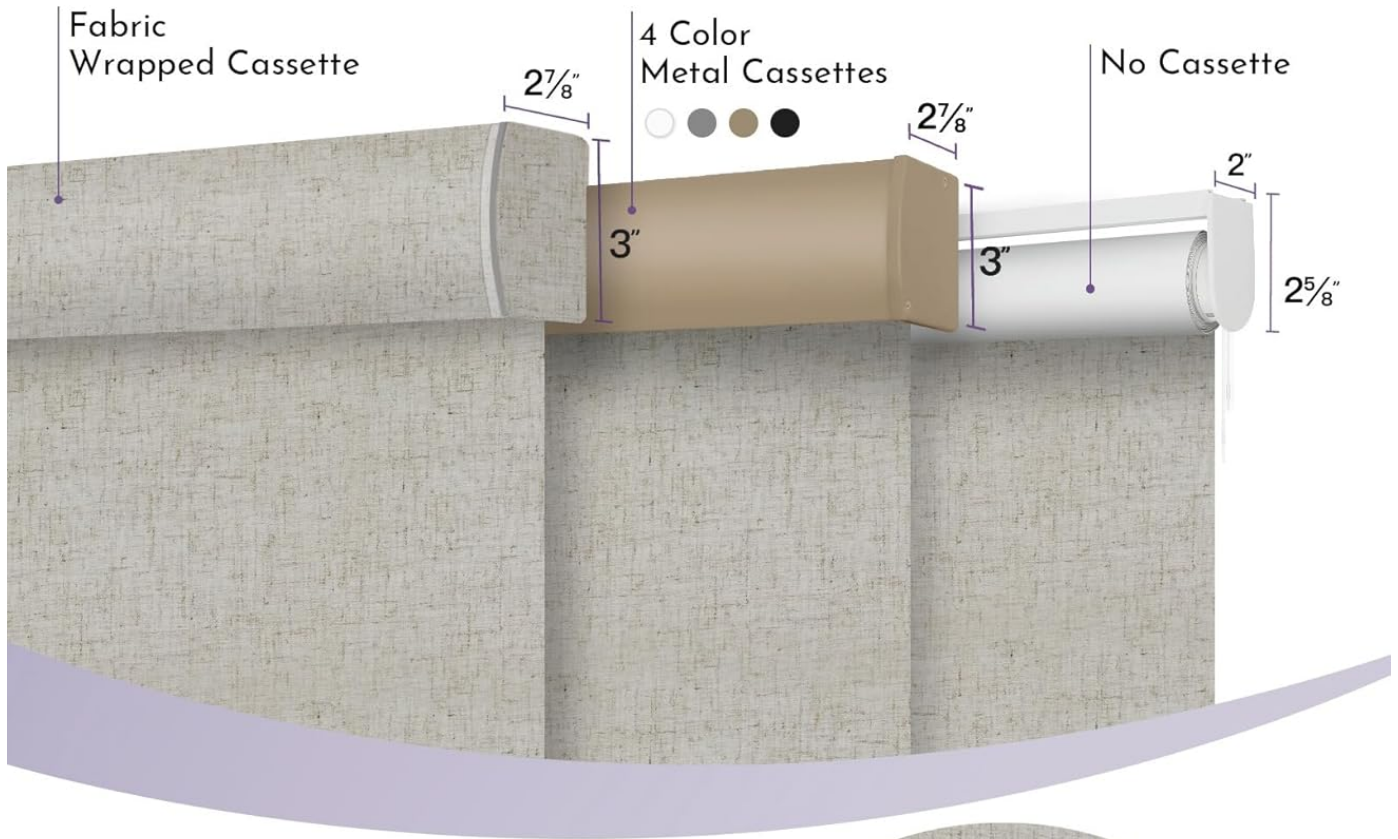

Figure 4: Various cassette and bottom bar designs available for Graywind Roller Shades.

2.3. Installation Steps

Video 1: Official Graywind installation guide for motorized shades and blinds. This video demonstrates the step-by-step process for mounting your shades.

1. **Prepare the Shades:** Before installation, check that the program button and charging hole on the motor are facing the ground.
2. **Mark Positions:** Use your shades to determine the punch positions for the brackets. Mark these positions accurately with a pencil.
3. **Drill Holes:** Drill pilot holes at the marked positions.
4. **Insert Anchors:** Insert wall anchors (if necessary) into the drilled holes.
5. **Attach Brackets:** Securely attach the mounting brackets using screws.
6. **Mount the Shade:** Carefully attach the shade to the installed brackets. Ensure it clicks securely into place.
7. **Test Operation:** Remove the seal from the remote control and test the motorized shade's up and down movement.

2.4. Measuring for Customization

Video 2: Official Graywind guide on how to measure for roller blinds with a valance. This video provides detailed instructions for accurate measurements.

3. Operation

Your Graywind Smart Roller Shades offer multiple convenient ways to control them, including a remote control, a mobile app, and voice commands.

3.1. Remote Control

The 15-channel timing remote allows for precise control of your shades.

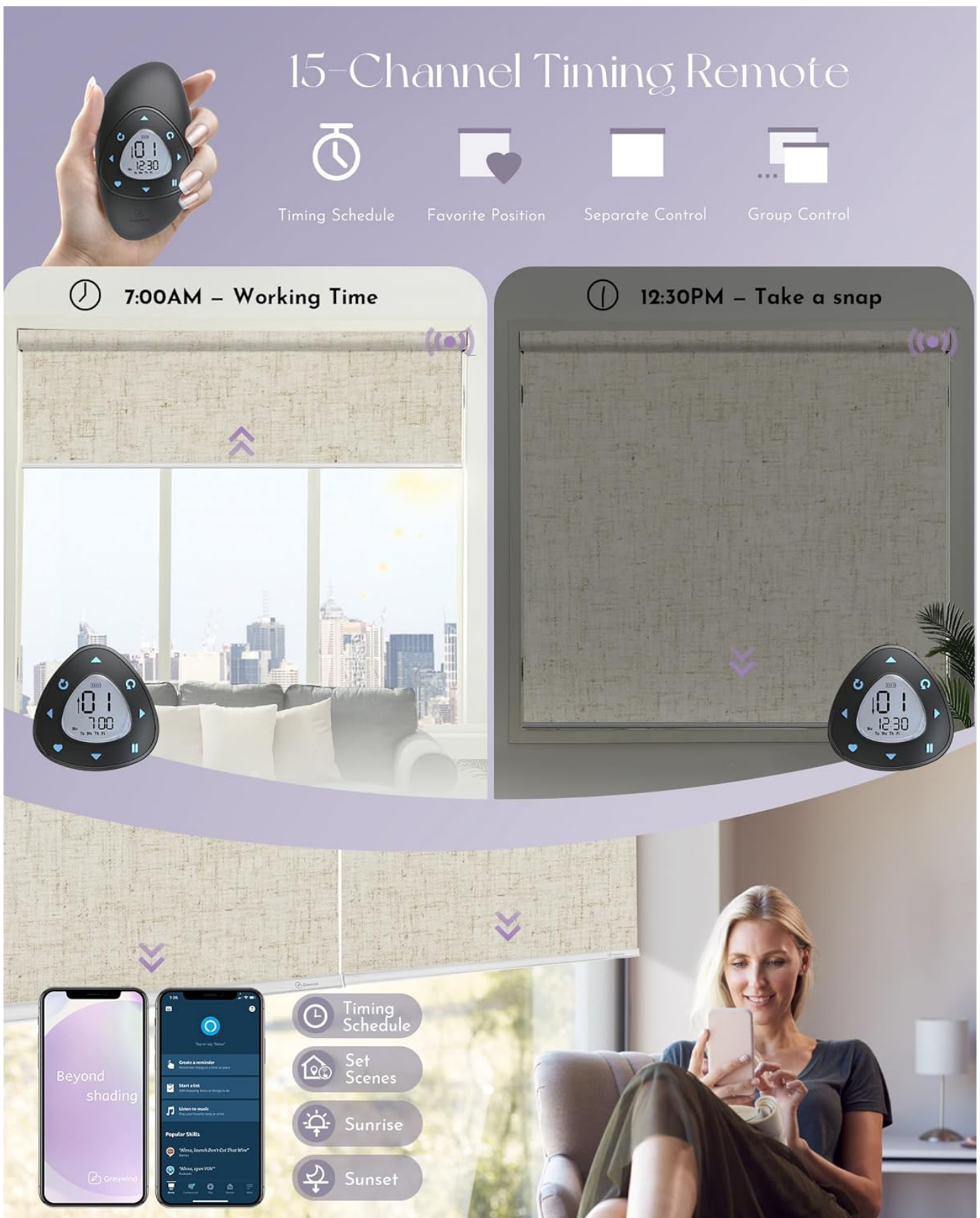

Figure 5: The 15-Channel Timing Remote allows for setting schedules, favorite positions, and controlling shades individually or in groups.

- **Individual Control:** Select a specific channel to control a single shade.
- **Group Control:** Assign multiple shades to a single channel for simultaneous control.
- **Timing Schedules:** Program up to 20 date-time groups to automatically open or close shades at specific times (e.g., sunrise/sunset).
- **Favorite Position:** Set and recall preferred shade positions with a single button press.

3.2. Alexa App Control

Manage your shades from anywhere using the Alexa app on your smartphone.



Figure 6: Control your shades via the Alexa app for setting schedules, percentage control, and creating routines.

- **Set Timing Schedules:** Create custom schedules for your shades to open and close automatically.
- **Percentage Control:** Adjust shades to a specific percentage of openness.
- **Create Routines:** Integrate shades into smart home routines with other Alexa-compatible devices.

3.3. Alexa Voice Control

Use voice commands with your compatible Alexa devices for hands-free control.

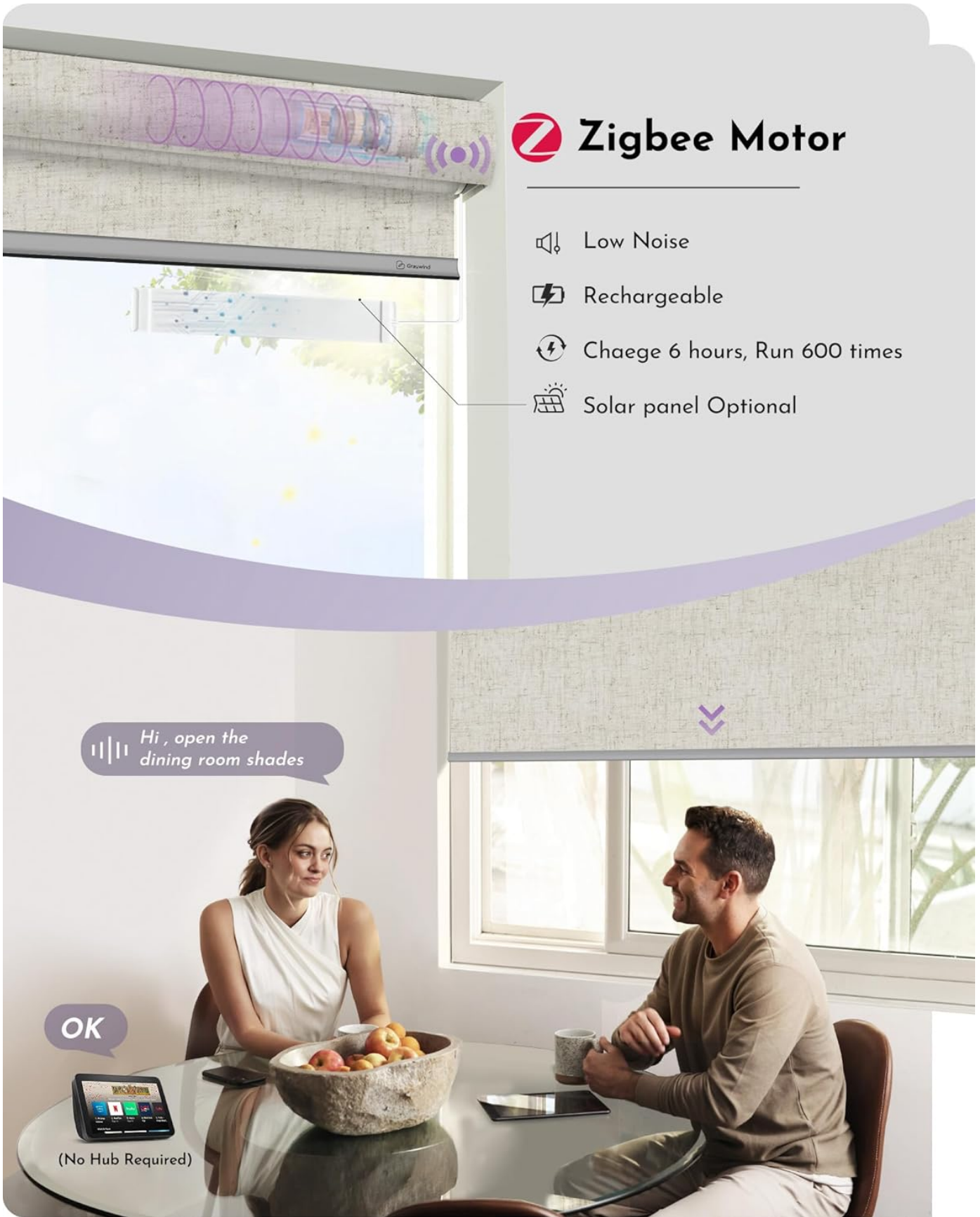

Figure 7: Voice control with Alexa for opening and closing shades.

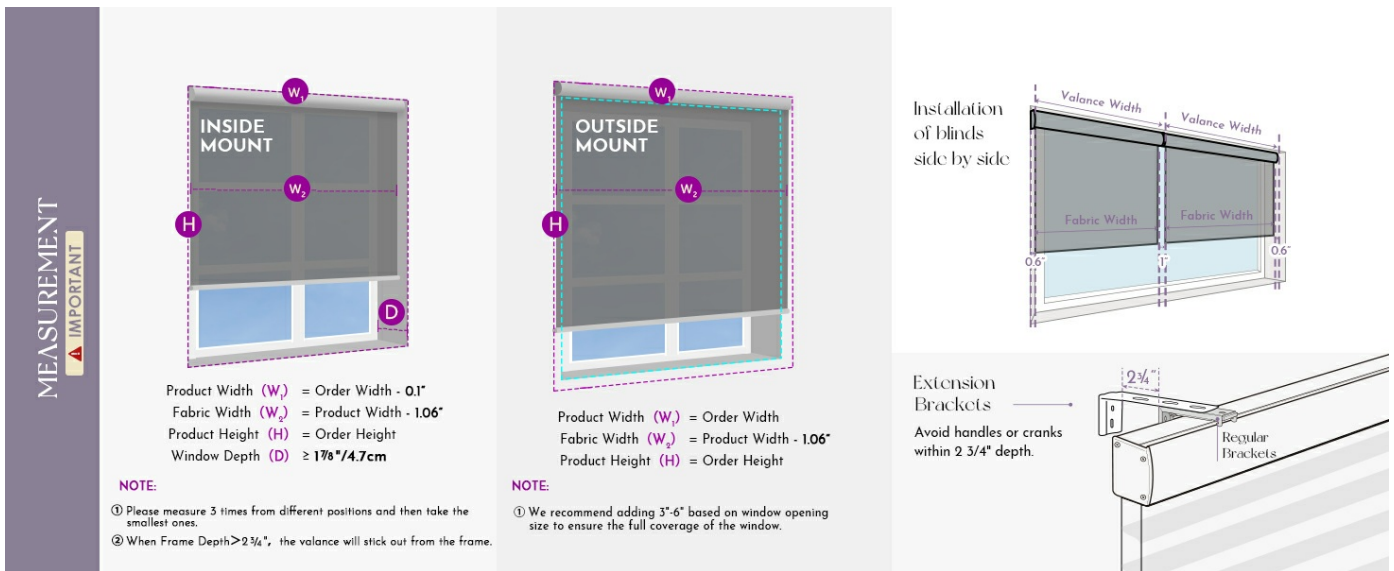

Figure 8: Alexa voice control features including percentage control, separate/group control, and custom voice commands.

- **Direct Compatibility:** Works directly with Echo Show 8 (3rd Gen), Echo Plus (2nd Gen), Echo Studio, Echo Show 10 (3rd Gen), Echo Show (2nd Gen), Echo (4th Gen), Echo Hub. No separate hub required for these devices.
- **Voice Commands:** Use commands like "Alexa, open the dining room shades" or "Alexa, set living room shades to 50%".
- **Zigbee Smart Bridge:** For other Alexa models, Google Assistant, or SmartThings compatibility, a Zigbee Smart Bridge (sold separately) may be required.

Scenario 2 Large Window Solution— Exceed the maximum width and install two blinds next to each other.

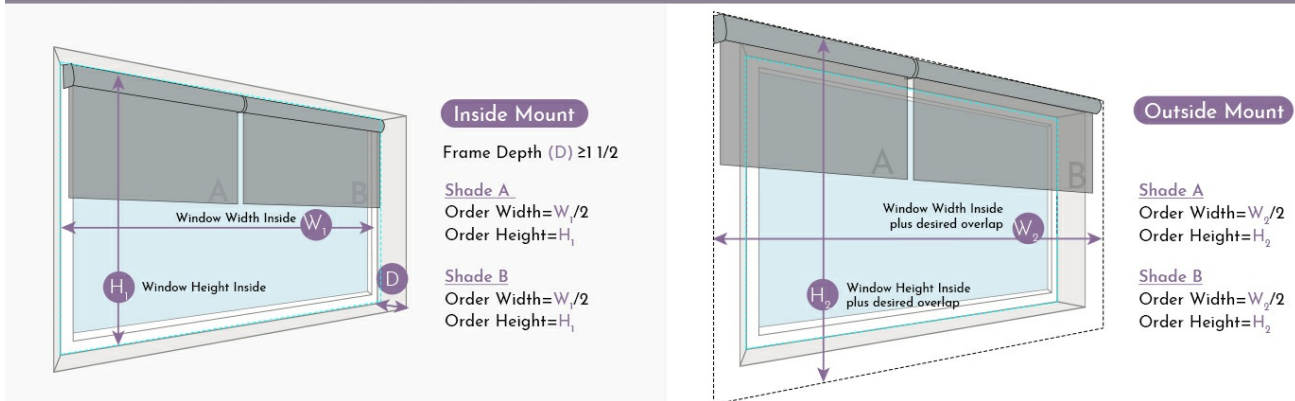

Figure 9: The Zigbee Smart Bridge extends compatibility to other Alexa models, Google Assistant, and SmartThings.

4. Maintenance

Regular maintenance helps prolong the life and functionality of your Graywind Smart Roller Shades.

- **Cleaning:** Gently dust the fabric with a soft cloth or a vacuum cleaner with a brush attachment. For spots, use a damp cloth with mild soap and water, then blot dry. Avoid harsh chemicals or abrasive cleaners.
- **Motor Care:** The Zigbee motor is rechargeable. Charge it as needed using the provided charging cable. Avoid exposing the motor to excessive moisture or extreme temperatures.
- **Remote Control:** Keep the remote control clean and dry. Replace batteries as necessary.
- **Fabric Inspection:** Periodically check the fabric for any signs of wear or damage.

5. Troubleshooting

If you encounter issues with your Graywind Smart Roller Shades, refer to the following common troubleshooting tips.

- **Shade Not Responding to Remote/App:**

- Check if the remote control batteries need replacement.
- Ensure the shade's motor is charged.
- Verify that the remote is paired correctly with the shade. Refer to the pairing instructions in the full manual.
- For app control, ensure your Wi-Fi network is stable and the Alexa device is connected.

- **Shade Not Moving Smoothly:**

- Inspect the fabric for any obstructions or damage.
- Check the mounting brackets to ensure they are securely installed and not impeding movement.

- **Voice Control Issues:**

- Confirm your Alexa device is compatible and properly linked to your Graywind shades.
- Ensure your voice commands are clear and match the device's recognized phrases.
- If using a Zigbee Smart Bridge, verify its connection and setup.

- **Light Leakage:**

- For inside mount, minor light gaps are inherent due to hardware. Consider an outside mount for maximum blackout.
- Ensure the shade is fully extended and properly aligned within the window frame.

If these steps do not resolve the issue, please contact Graywind customer support for further assistance.

6. Specifications

Feature	Detail
Brand	Graywind
Model Number	GW-ARS-STQZ
Material	Blackout Fabric
Color	Linen Beige
Opacity	Blackout
Product Dimensions	120"L x 99"W (Example, customizable)
Operation Mode	Automatic (Motorized)
Special Features	APP Control, Cordless, Light Control, Voice Control
Smart Home Compatibility	Alexa (select devices directly, others via Zigbee Hub), Google Assistant (via Zigbee Hub), SmartThings (via Zigbee Hub)
Included Components	Mounting Hardware, Product Manual, Remote (if ordered), Shade
Mounting Type	Outside Mount, Inside Mount
Recommended Uses	Indoor (Bedroom, Dining Room, Hotels, Media Room, Restaurants)
UPC	766717771182

7. Warranty & Support

Graywind is committed to providing high-quality products and excellent customer service.

- **After-Sales Service:** Graywind smart blinds are designed for easier installation, and comprehensive manuals and video guides are available to assist you.
- **Technical Support:** We provide long-term 24/7 technical support to address any questions or issues you may encounter.
- **Contact Information:** For support, please refer to the contact details provided in your product packaging or visit the official Graywind website.

