

Xhorse HKSK407

Xhorse VVDI BEE Key Tool Lite Instruction Manual

Model: HKSK407 | Brand: Xhorse

1. INTRODUCTION

The Xhorse VVDI BEE Key Tool Lite is a compact and versatile device designed for locksmiths and automotive professionals using Android smartphones. It offers a range of functions for key generation, transponder cloning, and remote control operations, enhancing efficiency in key programming tasks.

2. PRODUCT OVERVIEW

The VVDI BEE Key Tool Lite connects directly to your Android phone via a Type-C interface, providing a user-friendly interface for various key-related functions.

Key Features:

- Remote control generation (supports Toyota XM Smart Key, universal smart key, wireless remote, wire remote, super remote).
- Transponder cloning and identification for most common transponders.
- Generation of transponders for over 850 car models from 80 brands worldwide.
- Support for Xhorse XK wire remote, XN wireless remote, XE super remote, and smart remote generation.
- Remote generation for over 6000 vehicle remotes from 200 car brands worldwide.
- Special functions including ignition switch coil signal detection, unlocking Toyota Smartkey, 8E remote upgrade/unlock, Honda cycle key renewal, and VVDI super chip settings.

Device Components:

-
- The diagram illustrates the connection of the Xhorse KEY TOOL LITE to a phone. It shows two views of the device: a front view on the left and a side view on the right. The front view shows the device with a red dashed line indicating the 'IC card identification' area and a red dot indicating the 'Working status indicator light'. The side view shows the 'Remote programming cable port' and the 'Connect to phone TYPE-C interface'. A red line connects the 'Connect to phone TYPE-C interface' to the 'Remote programming cable'.
- IC card identification
- Working status indicator light
- Flashing upgrade mode
always on: working mode
- Connect to phone
TYPE-C interface
- Remote programming cable port
- Remote programming cable

Figure 1: Key Tool Lite device showing remote frequency detection, chip clone collection, chip and remote reading coil (125KHz/134KHz), IC card identification, working status indicator light, Type-C interface, and remote programming cable port.



Figure 2: Dimensions of the Key Tool Lite device, measuring 78.9 mm in length, 40 mm in width, and 10.3 mm in thickness.

3. WHAT'S IN THE BOX

- Xhorse VVDI BEE Key Tool Lite Device
- 6 Pcs Xhorse XKB501EN Wire Remotes
- USB Type-C Cable
- Remote Programming Cable
- User Manual

4. SETUP

4.1 Connecting to an Android Phone

Connect the Xhorse VVDI BEE Key Tool Lite to your Android smartphone using the provided USB Type-C cable. Ensure your phone's USB debugging mode is enabled if required by the app.

XHORSE VVDI BEE KEY TOOL LITE

Connect to Android phones



Transponder clone and identification

Figure 3: The Key Tool Lite connected to an Android phone, displaying the application interface.

4.2 App Installation and Device Activation

Download and install the official Xhorse application from the Google Play Store. Follow the on-screen instructions within the app to activate your device. This typically involves registering an account and linking your Key Tool Lite.

THE APP USING STEPS

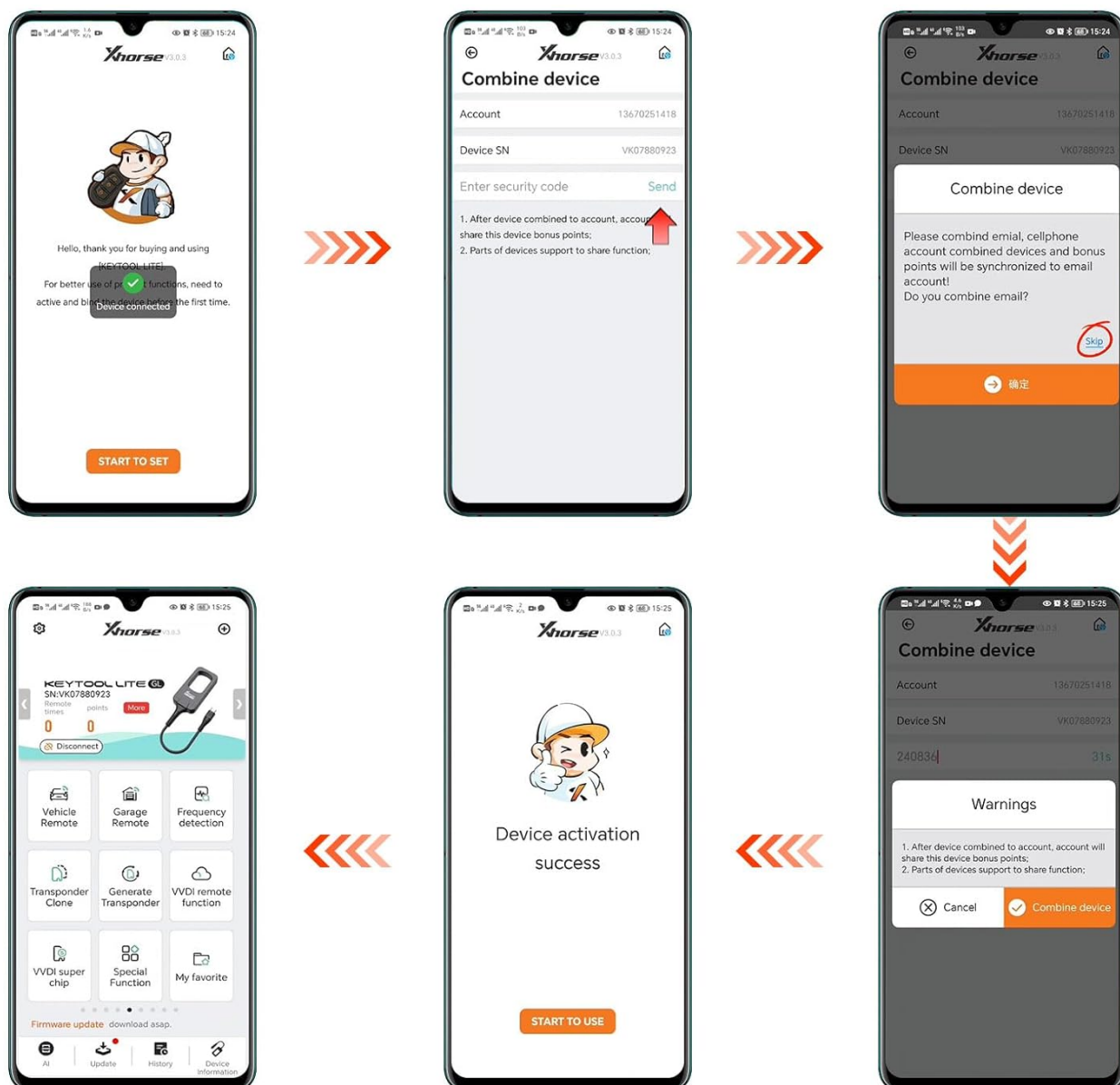

Figure 4: Step-by-step guide for device activation within the Xhorse application, including account login, security code entry, device combination, and successful activation confirmation.

5. OPERATING INSTRUCTIONS

The Xhorse VVDI BEE Key Tool Lite offers a variety of functions accessible through its dedicated Android application. Below are detailed instructions for common operations.

5.1 Remote Control Generation

This function allows you to generate various types of remote controls, including Toyota XM Smart Keys, universal smart keys, wireless remotes, wire remotes, and super remotes. Select the desired remote type from the app menu and follow the prompts to generate the remote.

5.2 Transponder Cloning

The device supports identification, editing, and cloning of most common transponders. Place the transponder in the designated area on the device and select the transponder cloning option in the app. Follow the instructions to complete the cloning process.

5.3 Vehicle Remote Functions

Generate Xhorse XK wire remotes, XN wireless remotes, XE super remotes, and smart remotes. The application provides extensive support for over 6000 vehicle remotes across 200 car brands. Choose your vehicle make and model within the app to find compatible remote options.

5.4 Special Functions

Access advanced features through the 'Special Function' menu in the app.

- **Remote Charge Battery:** Use this function to charge rechargeable keys by placing them in the device's slot and initiating the charge via the app.
- **Leakage Detection:** Connect the leakage detection cable to the device and the key chip to be tested. The app will display the current leakage value.
- **Voltage Detection:** Connect the leakage detection cable to the battery. The app will display the current voltage.
- **IMMO Programming:** The device supports various IMMO programming models. Select 'IMMO Programming' in the app, choose the vehicle brand and model, and follow the specific programming steps.
- **Key Making Process Overview:**

KEY MAKING PROCESS



Figure 5: Diagram illustrating the key making process, including remotes generation, battery installation, installation of remotes, key blade cutting (additional purchase), and final key matching with the vehicle using an OBD device.

6. MAINTENANCE

6.1 Battery Installation/Replacement for Remotes

For remotes that require battery replacement, refer to the following images for guidance on accessing the circuit board and installing the battery.



Figure 6: A typical key remote disassembled, showing the external casing and the internal circuit board.

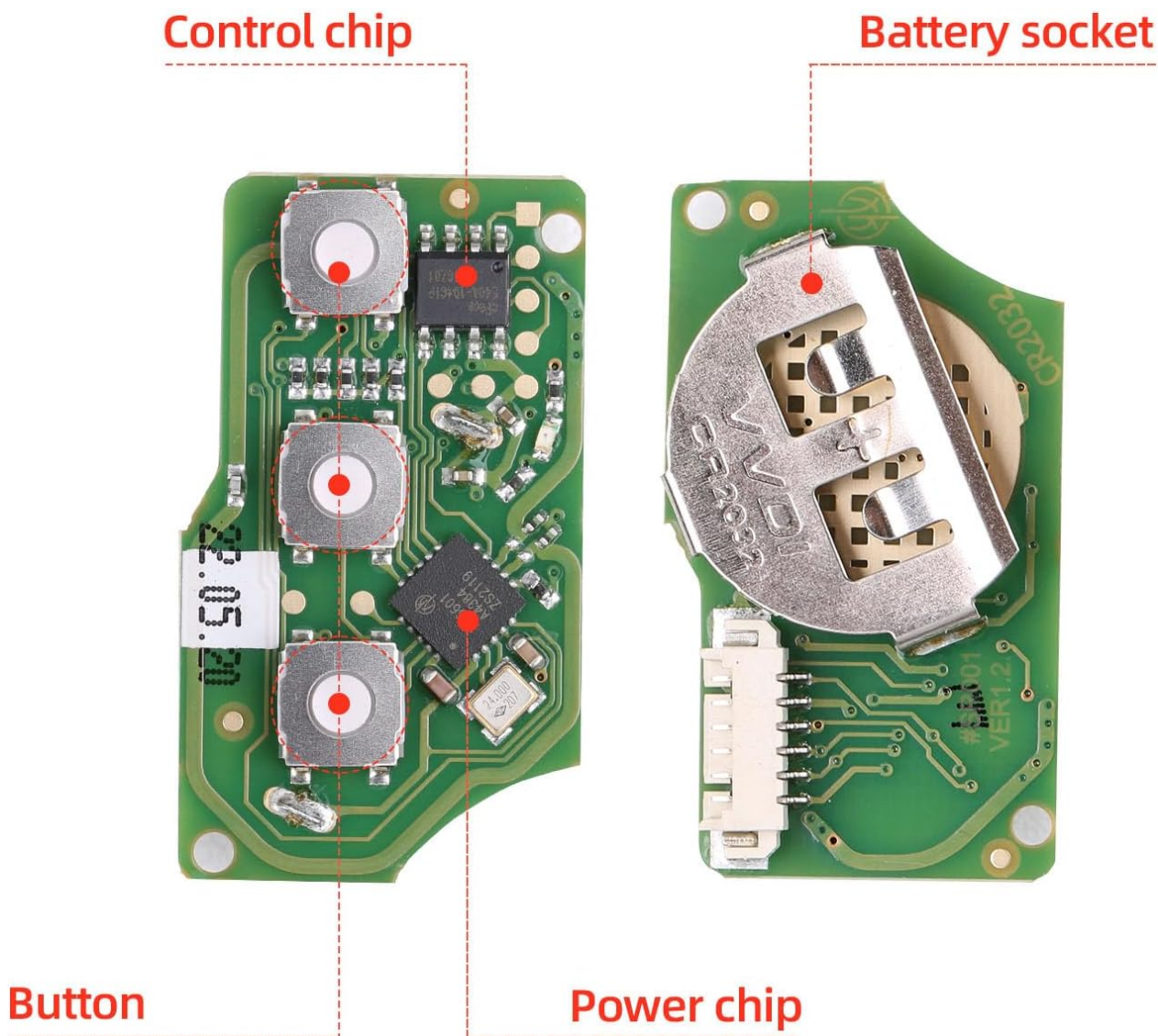

Figure 7: Detailed view of a key remote circuit board, highlighting the control chip, buttons, power chip, and battery socket.

6.2 General Care

- Keep the device clean and free from dust and moisture.
- Avoid dropping the device or subjecting it to strong impacts.
- Store the device in a cool, dry place when not in use.
- Ensure the USB Type-C port is free from debris before connecting.

7. TROUBLESHOOTING

- **Device not connecting to phone:** Ensure the USB Type-C cable is securely connected and your Android phone's USB debugging (if applicable) is enabled. Check for any loose connections.
- **App not recognizing device:** Restart the app and reconnect the device. Ensure the app is updated to the latest version.
- **Function failure:** Verify that the selected function is compatible with your specific vehicle make/model and the type of key/transponder being used. Consult the app's help section for specific error codes.
- **Firmware update issues:** Ensure a stable internet connection during firmware updates. Do not disconnect the device during the update process.



8. SPECIFICATIONS



Feature	Specification
Model Number	HKSK407
Brand	Xhorse
Compatible Devices	Android Systems (Smartphones)
Max Number of Supported Devices	9
Color	Black
Item Weight	12.8 ounces
Package Dimensions	10 x 7 x 1 inches
Special Feature	Universal

9. WARRANTY AND SUPPORT

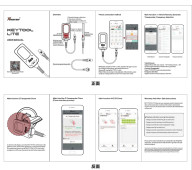
For warranty information, technical support, or service inquiries, please refer to the official Xhorse website or contact their customer service directly. Keep your purchase receipt for warranty claims.

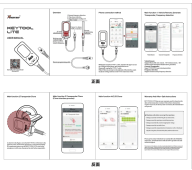
Related Documents - HKSK407

	Xhorse Key Tool Lite User Manual User manual for the Xhorse Key Tool Lite, detailing its functions including remote frequency detection, transponder cloning, and IC/ID cloning.
	Xhorse VVDI Key Tool Max Quick Manual - Professional Key Programming Device Explore the Xhorse VVDI Key Tool Max, a professional smart device for automotive key programming and diagnostics. This guide details its multi-functionality, Bluetooth/Wi-Fi connectivity, performance specifications, and essential setup for efficient operation.
	Xhorse VVDI Mini Key Tool User Manual and Guide Comprehensive user manual for the Xhorse VVDI Mini Key Tool, covering device overview, connection to smartphones, transponder cloning and generation, and remote generation. Includes contact information for sales, support, and location.
	Xhorse KEYTOOL LITE User Manual - Car Key Programmer Guide Detailed user manual for the Xhorse KEYTOOL LITE, covering vehicle remote generation, transponder cloning, IC/ID cloning, frequency detection, and after-sale support. Learn how to use this advanced automotive key programming tool.

	<p>Xhorse VVDI PROG User Manual: Automotive Chip Programming and Diagnostics</p> <p>Comprehensive user manual for the Xhorse VVDI PROG device, detailing hardware, software, supported chips, ECUs, immobilizers, dashboards, and remote systems for automotive maintenance and programming.</p>
	<p>Xhorse Mini Key Tool User Manual</p> <p>User manual for the Xhorse Mini Key Tool, detailing its overview, device components, and pairing instructions with a smartphone via Bluetooth.</p>