

## LENRUE A39PRO

# LENRUE A39PRO Computer Speakers Instruction Manual

Model: A39PRO | Brand: LENRUE

## 1. INTRODUCTION

Thank you for choosing the LENRUE A39PRO Computer Speakers. This wired USB-powered soundbar is designed to deliver clear 10W stereo sound for your PC desktop, laptops, and other compatible devices. Its plug-and-play functionality and convenient controls make it an ideal audio solution for various computing environments. Please read this manual carefully to ensure proper setup, operation, and maintenance of your new speakers.



Figure 1.1: LENRUE A39PRO Computer Speaker (White)

## 2. KEY FEATURES

- **Wide Compatibility:** Works with any device featuring a standard 3.5mm headphone jack (PC, laptops, tablets, phones, MP3 players). The USB plug is solely for power.
- **Stereo and Noiseless Sound:** Utilizes upgraded 2x5W technology to provide clear and crystal-clear audio, enhancing your experience for movies, videos, music, and games.

- **Easy Volume Control:** Features a conveniently located volume knob on the top of the speaker for instant and effortless adjustments.
- **Colorful Breathlight Design:** Integrated RGB LED lights create an enhanced atmosphere for your home or office. The lights can be turned on or off via a dedicated control button on the soundbar.
- **Plug and Play:** No drivers are needed, ensuring a hassle-free setup without sound delay. The 3.5mm audio interface and 47-inch (1.2m) cable provide ample connectivity.

**UPGRADED**

## HIFI STEREO SOUND TECH

Quality DUAL 5W Speakers and Independent Bass Diaphragm



Noise reduction



2 Drivers



HiFi stereo

Figure 2.1: Internal components highlighting HiFi Stereo Sound Technology



Figure 2.2: Wide compatibility with various devices and operating systems

## 3. SETUP GUIDE

### 3.1 Unpacking

Carefully remove the speaker from its packaging. Ensure all components listed in the 'Included Components' section (see Specifications) are present and undamaged.

### 3.2 Connecting the Speaker

1. Locate the USB power cable and the 3.5mm audio cable attached to the speaker.
2. Plug the USB cable into a powered USB-A port on your computer, laptop, power bank, or a 5V 2A USB adapter (recommended for optimal performance). This cable provides power to the speaker.
3. Plug the 3.5mm audio jack into the headphone or audio output port of your computer, laptop, tablet, or other audio source.
4. Ensure both cables are securely connected.



# INTRODUCTION TO PLUGS

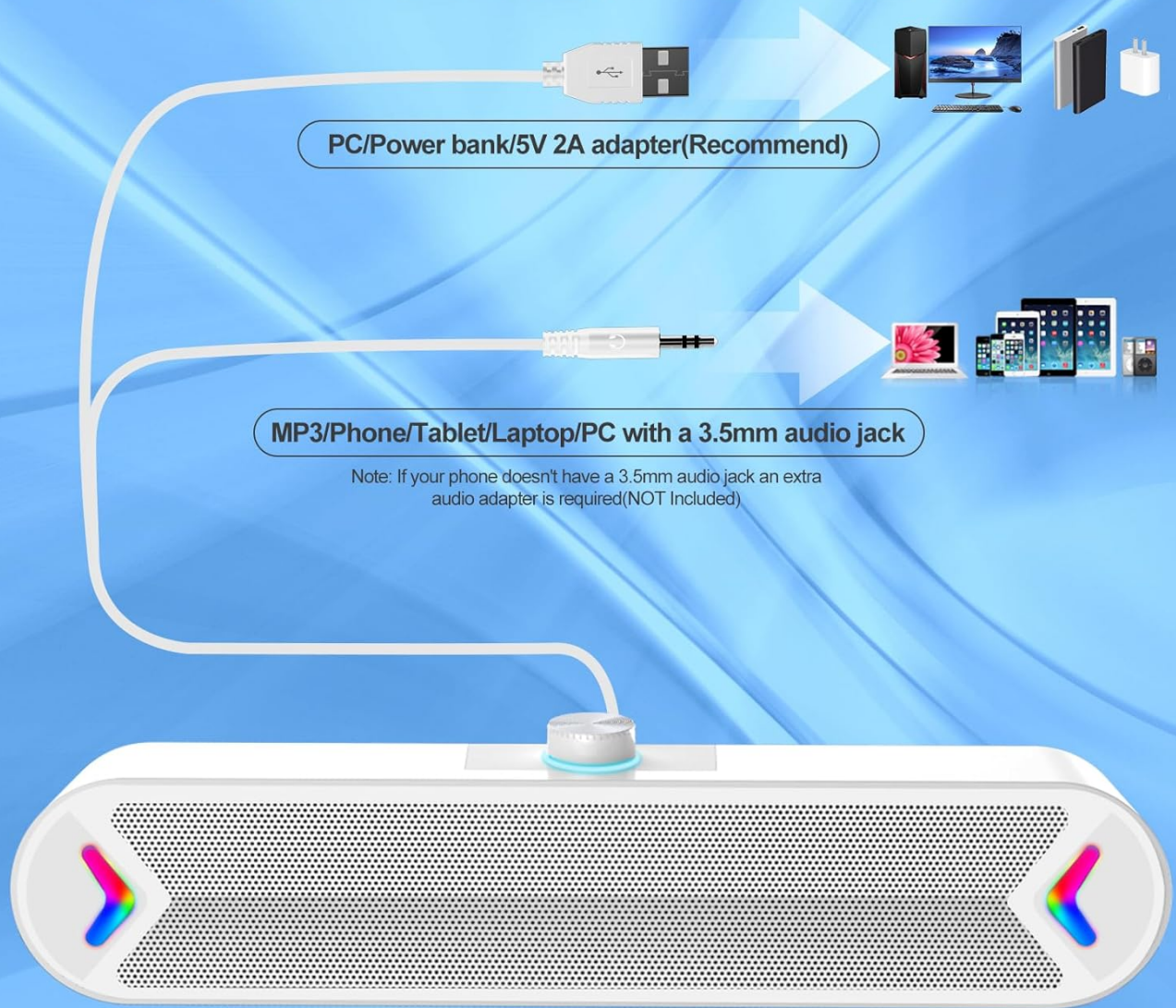

Figure 3.1: Connection Diagram for Power and Audio

# PLUG AND PLAY

No Need Drives and Software



Figure 3.2: Speaker in a typical desktop setup, ready for use

## 4. OPERATING INSTRUCTIONS

### 4.1 Power On/Off and LED Control

The speaker features a multi-function switch on the back for power and LED light control:

- **LIGHT:** Turns on both the speaker power and the colorful RGB LED lights.
- **ON:** Powers on the speaker, but keeps the LED lights off.
- **OFF:** Completely powers off both the speaker and the LED lights.

# POWER/LIGHT BUTTONS & RICHDEVICE JACKS



Figure 4.1: Power/Light Button and Volume Knob Location

## 4.2 Adjusting Volume

The volume knob is located on the top of the speaker for easy access:

- Rotate the knob clockwise to increase the volume.
- Rotate the knob counter-clockwise to decrease the volume.



# CONVIENT TO CONTROL THE VOLUME

Just Rotate the Volume Knob On the Top



Figure 4.2: Adjusting the Volume Knob

## 5. MAINTENANCE

To ensure the longevity and optimal performance of your LENRUE A39PRO speakers, follow these simple maintenance guidelines:

- **Cleaning:** Use a soft, dry cloth to wipe down the speaker's exterior. Avoid using abrasive cleaners, solvents, or strong chemicals, as these can damage the surface.
- **Dust Removal:** Gently use a soft brush or compressed air to remove dust from the speaker grille and around the volume knob.
- **Storage:** When not in use for extended periods, store the speaker in a cool, dry place away from direct sunlight and extreme temperatures.
- **Handling:** Avoid dropping the speaker or subjecting it to strong impacts, which can damage internal components.

## 6. TROUBLESHOOTING

If you encounter any issues with your LENRUE A39PRO speakers, please refer to the following common problems and solutions:

Problem	Possible Cause	Solution
No sound or low volume	<ul style="list-style-type: none"><li>• Speaker not powered on.</li><li>• Volume too low on speaker or computer.</li><li>• Incorrect audio output selected on computer.</li><li>• Loose 3.5mm audio connection.</li></ul>	<ul style="list-style-type: none"><li>• Ensure the power/light switch is set to 'LIGHT' or 'ON'.</li><li>• Increase volume using the speaker's knob and your computer's volume control.</li><li>• Verify the correct audio output device is selected in your computer's sound settings.</li><li>• Check that the 3.5mm audio jack is fully inserted into the audio source.</li></ul>
LED lights not working	<ul style="list-style-type: none"><li>• Power/light switch set to 'ON' or 'OFF'.</li><li>• Speaker not receiving power.</li></ul>	<ul style="list-style-type: none"><li>• Set the power/light switch to 'LIGHT'.</li><li>• Ensure the USB power cable is securely connected and receiving power.</li></ul>
Distorted sound	<ul style="list-style-type: none"><li>• Volume too high.</li><li>• Poor audio source quality.</li><li>• Loose connection.</li></ul>	<ul style="list-style-type: none"><li>• Decrease the volume.</li><li>• Try a different audio source or file.</li><li>• Check all cable connections.</li></ul>



**Easy to Use**  
If no sound out, please check the right device is selected

Figure 6.1: Checking Audio Output Settings on Your Computer

7. SPECIFICATIONS



Feature	Detail
Brand	LENRUE
Model Name	A39PRO
Speaker Type	Computer Speaker
Connectivity Technology	USB (for power), 3.5mm Audio Jack (for sound)
Audio Output Mode	Stereo
Speaker Maximum Output Power	10 Watts (2x5W)
Frequency Response	20 Hz
Controller Type	Knob control
Color	White
Product Dimensions	2.17"D x 12.6"W x 2.56"H
Item Weight	1.37 pounds
Mounting Type	Tabletop Mount
Recommended Uses	For Computers (PC, Laptops, Tablets)
Included Components	A39PRO Computer Speaker

## 8. WARRANTY AND SUPPORT

### 8.1 Warranty Information

The LENRUE A39PRO Computer Speakers come with a limited warranty. Please refer to the product packaging or contact your retailer for specific details regarding the warranty period and terms.

### 8.2 Customer Support

For any questions, technical assistance, or support inquiries not covered in this manual, please contact LENRUE customer service through the retailer's platform or the official LENRUE website. Please have your product model number (A39PRO) and purchase information ready when contacting support.

