

## UNIWA F41

# UNIWA F41 Zello Walkie Talkie User Manual

Model: F41

*Your comprehensive guide to operating and maintaining your UNIWA F41 device.*

## 1. PRODUCT OVERVIEW

The UNIWA F41 is a rugged 4G Android mobile phone designed with walkie-talkie capabilities, featuring a durable build, long-lasting battery, and support for various communication applications like Zello. It combines smartphone functionality with push-to-talk (PTT) features, making it suitable for professional and outdoor use.



Figure 1: Front and rear view of the UNIWA F41 device, showing the display, keypad, PTT button, and rear clip.

### Key Features:

- **Operating System:** Android 8.1
- **Processor:** MT6739 Quad Core

- **Memory:** 1GB RAM + 8GB ROM (expandable up to 64GB with Micro SD)
- **Display:** 2.4-inch IPS capacitive touch screen (320x240 resolution)
- **Battery:** Removable 4600mAh Li-Polymer battery with 10W fast charging
- **Durability:** IP54 waterproof, drop, and shockproof
- **Connectivity:** 2G/3G/4G global network bands, Wi-Fi (2.4GHz/5GHz), Bluetooth 4.2, GPS/BeiDou/GLONASS
- **Cameras:** 5MP front, 8MP rear
- **Audio:** Front  $\Phi$ 36/3 Watt BOX Speaker
- **Special Features:** Zello intercom, Smart PTT, Posstar support, NFC for patrolling, SOS button, Dual SIM

## 2. PACKAGE CONTENTS

---

Verify that all items are present in the package:

- UNIWA F41 Talkie Walkie Smartphone (x1)
- Power Adapter (5V/2A) (x1)
- USB Cable (x1)
- Clip (x1)
- Antenna (x1)
- User Manual (x1)

# Package Listing



Figure 2: Contents of the UNIWA F41 retail package.

## 3. SETUP

### 3.1. Battery Installation and Initial Charge

1. Remove the back cover of the device.
2. Insert the 4600mAh Li-Polymer battery into the battery compartment, ensuring the contacts align.
3. Replace the back cover securely.
4. Connect the provided USB cable to the device's USB Type-C port and the power adapter.
5. Plug the power adapter into a wall outlet.

6. Charge the device for at least 1 hour before initial use. The charging indicator will show progress.



Figure 3: The UNIWA F41 device with its high-capacity 4600mAh removable battery.

### 3.2. SIM Card and Micro SD Card Installation

The device supports dual SIM cards and one TF (Micro SD) card.

1. With the device powered off, remove the back cover and battery.
2. Locate the SIM card slots (SIM Card Slot \*2) and TF Card Slot \*1.
3. Carefully insert your SIM card(s) into the designated slots with the gold contacts facing down.
4. Insert your Micro SD card (up to 64GB) into the TF card slot.
5. Reinstall the battery and back cover.

### 3.3. Antenna Attachment

Screw the provided antenna onto the top of the device until it is finger-tight. Ensure it is securely attached for optimal signal reception.



## 4. OPERATING INSTRUCTIONS

### 4.1. Power On/Off

- **Power On:** Press and hold the Power button (usually on the side) until the screen lights up.
- **Power Off:** Press and hold the Power button, then select "Power off" from the options on the screen.

### 4.2. Basic Navigation

The UNIWA F41 features a 2.4-inch IPS capacitive touch screen and a T9 keypad for navigation.

- **Touch Screen:** Tap to select, swipe to scroll.
- **Keypad:** Use the directional keys for menu navigation and the central button to confirm selections.
- **Back Button:** Returns to the previous screen.
- **Home Button:** Returns to the home screen.



Figure 4: The 2.4-inch IPS capacitive touch screen of the UNIWA F41, displaying various application icons.

### 4.3. Using Walkie-Talkie (Zello/PTT) Functionality

The UNIWA F41 is pre-adapted for popular PTT applications like Zello, Real PTT, and Pocstar.

1. Ensure you have an active internet connection (Wi-Fi or 4G).
2. Open your preferred PTT application (e.g., Zello).
3. Log in or create an account.
4. Join a channel or contact.
5. Press and hold the dedicated PTT Intercom Button (located on the side) to transmit your voice. Release to listen.
6. Use the Group Switching Knob (if available on your model) to quickly switch between talk groups.

## 2.4-inch IPS Capacitive Touch Screen

IPS screen delivers clearer colors and more responsive touch operations



Figure 5: The UNIWA F41 showcasing its integration with Zello and other PTT applications, highlighting the ergonomic PTT button.

### 4.4. Network Connectivity (4G, Wi-Fi, Bluetooth)

- **4G Network:** Ensure your SIM card supports the device's network bands (2G: GSM850/900/1800/1900MHz; 3G: WCDMA B1/B2/B5/B8, TD-SCDMA B34/B39; 4G: FDD-LTE:B1/B3/B7/B8/B20; TDD-LTE:B38/B39/B40/B41). The device will automatically connect to available cellular networks.



- **Wi-Fi:** Go to Settings > Network & Internet > Wi-Fi to connect to available Wi-Fi networks.
- **Bluetooth:** Go to Settings > Connected devices > Bluetooth to pair with Bluetooth accessories.



**Figure 6:** The UNIWA F41's capability to support global 2G/3G/4G network bands for seamless communication.



## Supports WiFi & GPS

WiFi enables faster data transfer, while GPS provides precise positioning for clear command and dispatch

# GPS WIFI



**Figure 7:** Illustration of the UNIWA F41's integrated WiFi for faster data and GPS for precise positioning.

### 4.5. Camera Usage

The device features a 5MP front camera and an 8MP rear camera.

- Open the Camera application from the home screen or app drawer.
- Tap the shutter button to take a photo.
- Switch between front and rear cameras using the camera toggle icon.
- Select video mode to record videos.



Figure 8: The UNIWA F41's dual camera system, featuring a 5MP front camera and an 8MP rear camera for high-definition capture.

#### 4.6. NFC Functionality

The built-in NFC can be used for applications such as patrolling clock-in.

- Ensure NFC is enabled in Settings.
- Open the relevant NFC-enabled application.
- Tap the device near an NFC tag or reader to perform the desired action (e.g., clock-in).

## Front 3W High Volume Speaker

Ensures clearer communication, suitable for various noisy working environments



Figure 9: The UNIWA F41 utilizing its NFC feature for applications like patrolling clock-in, ideal for various industries.

### 4.7. SOS Emergency Call

The device includes a dedicated SOS button for emergency situations.

- Configure emergency contacts in the device settings.
- In an emergency, press the SOS Button (usually on the side) to initiate an emergency call or send an SOS message to pre-set contacts.

## 5. MAINTENANCE

### 5.1. Cleaning the Device

- Use a soft, lint-free cloth to wipe the screen and body of the device.
- For stubborn dirt, slightly dampen the cloth with water or a mild screen cleaner.
- Avoid using harsh chemicals, abrasive cleaners, or aerosols.
- Ensure all ports are dry before charging or connecting accessories.

## 5.2. Battery Care

- Charge the battery fully before first use.
- Avoid extreme temperatures, as they can degrade battery performance.
- Do not puncture, disassemble, or short-circuit the battery.
- If the device will not be used for an extended period, charge it to about 50% and store it in a cool, dry place.

## 5.3. Software Updates

**Important Note: Currently, the F41 only supports Android 8.1. Do not upgrade the Android version, otherwise the phone will not work.**

Regularly check for official software updates from UNIWA to ensure optimal performance and security. Follow the instructions provided by the update notification or check in Settings > System > System update.

## 6. TROUBLESHOOTING

Problem	Possible Cause	Solution
Device does not power on.	Low battery; Battery not installed correctly; Software issue.	Charge the device for at least 1 hour. Reinstall the battery. Perform a force restart (refer to device specific instructions if available).
No network signal.	SIM card not inserted correctly; Out of network coverage; Incorrect network settings.	Reinsert SIM card. Move to an area with better coverage. Check APN settings in Network & Internet settings. Ensure antenna is securely attached.
PTT function not working.	No internet connection; PTT app not configured; App permissions.	Verify Wi-Fi or 4G connection. Ensure PTT app is logged in and configured correctly. Check app permissions for microphone and network access.
Battery drains quickly.	High screen brightness; Many apps running in background; Poor network signal.	Reduce screen brightness. Close unused apps. Disable Wi-Fi/Bluetooth when not in use. Use power-saving mode.
Device is slow or unresponsive.	Too many apps open; Low storage; Software glitch.	Close background apps. Clear cache. Free up storage space. Restart the device.
Cannot upgrade Android version.	Device limitation.	The UNIWA F41 is designed to operate on Android 8.1. Attempting to upgrade may cause the device to malfunction. Do not upgrade the Android version.
Speaker volume is low or distorted.	Volume settings; Speaker obstruction; Software issue.	Increase volume using the volume buttons. Ensure speaker is not blocked. Restart the device.
GPS not accurate.	Poor satellite signal; GPS settings.	Ensure you are in an open area with clear sky view. Check location settings and ensure GPS is enabled.
NFC not working.	NFC disabled; Incorrect positioning.	Enable NFC in settings. Ensure the device's NFC area is close to the tag/reader.



## 7. SPECIFICATIONS

Feature	Detail
Brand	UNIWA
Model	F41
Operating System	Android 8.1
CPU	MT6739 Quad Core
Memory (RAM)	1GB
Storage (ROM)	8GB
Expandable Storage	Up to 64GB (Micro SD)
SIM Card Support	Dual SIM
Display Size	2.4 inches
Display Type	IPS Capacitive Touch Screen
Display Resolution	320x240
Rear Camera	8MP
Front Camera	5MP
Battery Capacity	4600mAh Li-Polymer (Removable)
Charging	10W Fast Charging, USB Type-C, Dock charging connectors
Dimensions	135.6 x 60.5 x 26.0 mm
Weight	265g (including battery and clip)
Water/Dust Resistance	IP54 Waterproof, Drop and Shockproof
Network Bands	2G: GSM850/900/1800/1900MHz; 3G: WCDMA B1/B2/B5/B8, TD-SCDMA B34/B39; 4G: FDD-LTE:B1/B3/B7/B8/B20; TDD-LTE:B38/B39/B40/B41
Wi-Fi	2.4GHz / 5GHz
Bluetooth	BT4.2
GNSS	GPS/BeiDou/GLONASS
NFC	Yes

Feature	Detail
Speaker	Front Ø36/3 Watt BOX Speaker
Buttons	PTT Intercom Button, Volume +/-, SOS Button, Customize Button, T9 Keypad
Headphone Jack	M6 Headphone Jack
Operating Temperature	-20°C to +60°C

## 8. SAFETY INFORMATION

- Read all instructions carefully before using the device.
- Do not expose the device to extreme temperatures, direct sunlight, or excessive moisture.
- Use only manufacturer-approved accessories (battery, charger, antenna).
- Do not attempt to disassemble, repair, or modify the device yourself. Refer to qualified service personnel.
- Dispose of the device and battery responsibly according to local regulations.
- Avoid using the device while driving or operating heavy machinery.
- Maintain a safe distance from medical implants (e.g., pacemakers) when using the device.
- The device is IP54 rated for water and dust resistance, but it is not fully submersible. Avoid prolonged exposure to water.



## 9. WARRANTY AND SUPPORT

For warranty information, please refer to the warranty card included with your product or contact UNIWA customer support. Keep your purchase receipt as proof of purchase.

For technical support or service inquiries, please contact your retailer or visit the official UNIWA website for contact details.

© 2025 UNIWA. All rights reserved.  
Information in this manual is subject to change without notice.

### Related Documents - F41

	<p><a href="#">UNIWA F41 Rugged Android Smart Public Network Intercom User Manual</a></p> <p>Comprehensive user manual for the UNIWA F41, a rugged Android smart public network intercom designed for industries requiring instant communication, featuring PoC technology, GPS, and durable construction.</p>
	<p><a href="#">UNIWA F400 User Manual: Smart Handheld Intercom PDA</a></p> <p>Comprehensive user manual for the UNIWA F400, an IP65-rated Android smart handheld intercom PDA. Features include PTT communication, GPS, durable design, 4350mAh battery, and Android 15 OS. Details on setup, functions, maintenance, and specifications. Document metadata: Paper: 100G coated paper, Printing: Double-sided printing, four-color printing, Folding method: Spiral fold, Size: 87*150mm.</p>



## UNIWA V909T 4G Flip Phone User Manual

User manual for the UNIWA V909T 4G flip phone, covering installation, operation, settings, and specifications. This feature phone supports single Nano SIM and offers features like FM radio, SOS, and speed dial.



Thank you for choosing UNIWA V1000 4G senior phone, it mainly support American 4G bands, not support European 4G bands currently. But it supports 2G(GSM)/3G(WCDMA) global bands.

It is unlocked (SIM free) and take single Nano SIM card. If any question during use, please email us, we will try our best to help you.

Our after-sales email:  
2850699288@qq.com

### Safety instructions

This phone is not water-resistant, keep it dry. To prevent possible heating damage, do not listen at high volume level for long time. Exercise caution when holding your device.

### Table of Contents

► External features	01
► Install SIM card	02
► Install the battery	02
► Turn on/off the phone	03
► Unlock keypad	03
► Charging	03
► Save contact	04
► Make call	04
► Answer call	05
► Send and receive SMS	05
► Multimedia Settings	06
► Bluetooth/Application	07
► Settings	07
► Speed Dial	10
► SOS Settings	10
► Torch Light	11
► Product specifications	11

### External features



- |                      |                        |
|----------------------|------------------------|
| ① LED indicator      | ⑩ Charging dock        |
| ② Earpiece           | ⑪ Hang up key          |
| ③ Torch              | ⑫ Keypad unlock button |
| ④ Volume +/-         | ⑬ Return key           |
| ⑤ Torch button       | ⑭ SOS button           |
| ⑥ Menu key           | ⑮ Camera               |
| ⑦ Dot key            | ⑯ Speaker              |
| ⑧ OK key             | ⑰ Headphone port       |
| ⑨ Navigation key     | ⑱ Micro USB            |
| ⑫ Charging indicator | ⑲ Dock connector       |

- 01

### Install SIM card

Open the back cover from the bottom right corner of the phone (see figure 1) and insert your SIM card (see figure 2).



### Install the battery

Before starting up, please tear off the insulating sticker on the battery contacts, then install the battery and cover the back cover, please see the figure below:

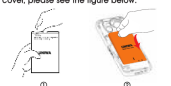

- 02

### Turn on/off the phone

Long press  for 5 seconds, the phone will turn on/off.

### Unlock keypad

Unlock button is on the right side of the phone, you can slide it up to unlock keypad. If the unlock button is already at unlocked state, you can slide it again to unlock.

### Charging

When the battery is low, please charge the phone in time. There are 2 ways for charging:

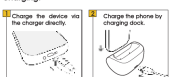

- 03

When charging, the indicator on the dock will get red, if the phone is not placed properly with the dock, the indicator will display green. Please reposition the phone until it is well placed.

### Save contact

For frequent contacts, you can save their phone number in the contact list by step:

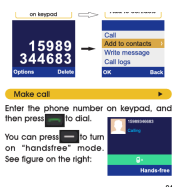

**Make call**

Enter the phone number on keypad, and then press **Call** to dial.

You can press **Call** to turn on "handsfree" mode. See figure on the right:

-04

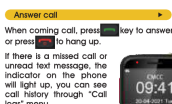

**Answer call**

When coming call, press **Call** key to answer or press **Call** to hang up.

If there is a missed call or unread text message, the indicator on the phone will light up, you can see call history through "Call logs" menu.

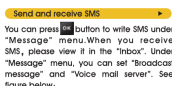

**Send and receive SMS**

You can press **Message** button to write SMS under "Message" menu. When you receive SMS, please view it in the "Inbox". Under "Message" menu, you can set "Broadcast message" and "Voice mail server". See figure below:

-05

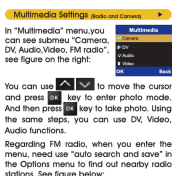

**Multimedia Settings**

In "Multimedia" menu, you can see submenus "Camera", "DV", "Audio", "Video", "FM radio", see figure on the right:

You can use **Left** key to move the cursor and press **OK** key to enter photo mode. And then press **Left** key to take photo. Using the same steps, you can use DV, Video, Audio functions.

Regarding FM radio, when you enter the menu, need use "auto search and save" in the Options menu to find out nearby radio stations. See figure below:

-06



**Bluetooth/ Application**

Under "Application" menu, you can see submenus "Calendar", "Calculator", "Recorder", "Clock", "STK", "Unit conversion", "Bluetooth", "Internet", "My files".

Regarding "Bluetooth" function, you can press **Bluetooth** key to activate it and then select "Paired device" to search for nearby Bluetooth device. See figure below:

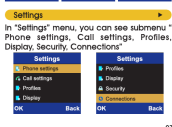

**Settings**

In "Settings" menu, you can see submenus "Phone settings", "Call settings", "Profiles", "Display", "Security", "Connections".

-07

**Phone settings**

Timezone, date, language settings, shortcut settings, auto power on/off, restore factory settings.

In "Phone settings" menu, you can restore the phone to factory settings. Please backup your data before restore factory setting, the data will be lost after restore factory. The default restore factory password is "0000".



**Call settings**

Call divert, Call waiting, Call barred, Hide ID, others. See figure on the right:

**Profiles**

Normal, Silent, Meeting, Indoor, Outdoor. If you want to change "Profile" setting, press **Profile** key to enter "Options" menu, and then press **Profile** key to select "Customize". You will see "Name", "Ring settings", "Adjust volume", "Ring type", "Other alert rings". See figure below:

-08



**Display**

Animation effect, Wallpaper settings, Screen saver settings, Contrast, keypad backlight time, Auto keypad lock.

**Security**

PIN Modify PIN2, Phone locked, Modify the cellphone passwords, Privacy, Fixed Dialing number, blacklist.

In order to avoid forgetting password and lock the phone forever, we do not recommend user to set password. Please set and keep password carefully if you use this function.

**Connections**

Network account, Data service, Data Roaming, Network selection, Network type, VoLTE.

-09



**Speed Dial**

For some frequent contacts, "Speed dial" can dial them quickly. Key 2-9 can be set as speed dial keys. See figure below:

After the frequent contact is set, press the corresponding key for 5 seconds, the phone will call the corresponding person automatically.

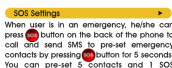

**SOS Settings**

When user is in an emergency, he/she can press **SOS** button on the back of the phone to call and send SMS to pre-set emergency contacts by pressing **SOS** button for 5 seconds. You can pre-set 5 contacts and 1 SOS message. See figure below:

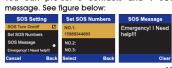

-10

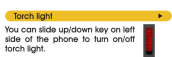

**Torch light**

You can slide up/down key on left side of the phone to turn on/off torch light.

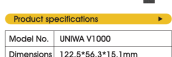

**Product specifications**

Model No.	UNIWA V1000
Dimensions	122.5*56.3*15.1mm

## [UNIWA V1000 4G Senior Phone User Manual](#)

User manual for the UNIWA V1000 4G senior phone, detailing features, setup, operation, and specifications. Supports global 2G/3G bands and US 4G bands.



<table><tr><td>Weight</td><td>114g (include battery)</td></tr><tr><td>Material</td><td>Plastic</td></tr><tr><td>Style</td><td>Bar</td></tr><tr><td>Service</td><td>Unlocked</td></tr><tr><td>SIM</td><td>Single Nano SIM card single standby</td></tr><tr><td rowspan="3">Band</td><td>2G: GSM 850/900/1800/1900MHz</td></tr><tr><td>3G: WCDMA 850/900/1700/1900/2100MHz</td></tr><tr><td>4G: FDD-LTE 820/880/781/2613/817/866</td></tr></table> <p>- 11</p> <table><tr><td>Phonebook Number</td><td>1000</td></tr><tr><td>LED Indicator</td><td>RGB</td></tr><tr><td>Message</td><td>SMS/MMS</td></tr><tr><td>USB Port</td><td>Micro USB</td></tr><tr><td>Earphone Port</td><td>3.5mm audio jack</td></tr><tr><td>Speaker</td><td>2030 BOM loudspeaker</td></tr><tr><td>Screen</td><td>2.31 inch QVGA TFT display screen,320*240px</td></tr><tr><td>Camera</td><td>Single camera, 0.3MP back camera</td></tr><tr><td>Audio formats</td><td>MP3</td></tr><tr><td>Video formats</td><td>MP4 etc.</td></tr><tr><td>Radio</td><td>Wireless radio</td></tr><tr><td>SOS Function</td><td>Support preset 5 SOS emergency contacts and 1 emergency SMS</td></tr><tr><td>Torch</td><td>One key to turn on/off torch</td></tr></table> <p>- 12</p> <table><tr><td>BT</td><td>V3.0</td></tr><tr><td>Battery</td><td>Removable 1700mAh li-ion battery</td></tr><tr><td rowspan="2">Languages</td><td>English, Arabic, French, Hindi, Indonesian, Malay, Portuguese, Russian, Spanish, Thai, Vietnamese, Italian, Turkish, Swedish, Greek, Hebrew, Czech, Polish, Swedish, Ukrainian, Dutch, Simplified/Traditional Chinese.</td></tr><tr><td>1* Battery</td></tr><tr><td rowspan="3">Accessories</td><td>1* Charger</td></tr><tr><td>1* Charging dock</td></tr><tr><td>1* User manual</td></tr></table> <div><div>EC REP</div><div>Proline GmbH Breitenstr. 56,46239 Düsseldorf Germany</div><div>CE FCC RoHS</div></div> <p>- 13</p>	Weight	114g (include battery)	Material	Plastic	Style	Bar	Service	Unlocked	SIM	Single Nano SIM card single standby	Band	2G: GSM 850/900/1800/1900MHz	3G: WCDMA 850/900/1700/1900/2100MHz	4G: FDD-LTE 820/880/781/2613/817/866	Phonebook Number	1000	LED Indicator	RGB	Message	SMS/MMS	USB Port	Micro USB	Earphone Port	3.5mm audio jack	Speaker	2030 BOM loudspeaker	Screen	2.31 inch QVGA TFT display screen,320*240px	Camera	Single camera, 0.3MP back camera	Audio formats	MP3	Video formats	MP4 etc.	Radio	Wireless radio	SOS Function	Support preset 5 SOS emergency contacts and 1 emergency SMS	Torch	One key to turn on/off torch	BT	V3.0	Battery	Removable 1700mAh li-ion battery	Languages	English, Arabic, French, Hindi, Indonesian, Malay, Portuguese, Russian, Spanish, Thai, Vietnamese, Italian, Turkish, Swedish, Greek, Hebrew, Czech, Polish, Swedish, Ukrainian, Dutch, Simplified/Traditional Chinese.	1* Battery	Accessories	1* Charger	1* Charging dock	1* User manual	
Weight	114g (include battery)																																																			
Material	Plastic																																																			
Style	Bar																																																			
Service	Unlocked																																																			
SIM	Single Nano SIM card single standby																																																			
Band	2G: GSM 850/900/1800/1900MHz																																																			
	3G: WCDMA 850/900/1700/1900/2100MHz																																																			
	4G: FDD-LTE 820/880/781/2613/817/866																																																			
Phonebook Number	1000																																																			
LED Indicator	RGB																																																			
Message	SMS/MMS																																																			
USB Port	Micro USB																																																			
Earphone Port	3.5mm audio jack																																																			
Speaker	2030 BOM loudspeaker																																																			
Screen	2.31 inch QVGA TFT display screen,320*240px																																																			
Camera	Single camera, 0.3MP back camera																																																			
Audio formats	MP3																																																			
Video formats	MP4 etc.																																																			
Radio	Wireless radio																																																			
SOS Function	Support preset 5 SOS emergency contacts and 1 emergency SMS																																																			
Torch	One key to turn on/off torch																																																			
BT	V3.0																																																			
Battery	Removable 1700mAh li-ion battery																																																			
Languages	English, Arabic, French, Hindi, Indonesian, Malay, Portuguese, Russian, Spanish, Thai, Vietnamese, Italian, Turkish, Swedish, Greek, Hebrew, Czech, Polish, Swedish, Ukrainian, Dutch, Simplified/Traditional Chinese.																																																			
	1* Battery																																																			
Accessories	1* Charger																																																			
	1* Charging dock																																																			
	1* User manual																																																			
	<p><a href="#">UNIWA V202T 4G Flip Feature Phone User Manual</a></p> <p>User manual for the UNIWA V202T 4G flip feature phone, covering unboxing, basic functions, contact management, settings, SOS emergency calls, product specifications, and technical support.</p>																																																			
 <p>MANUAL DE USUARIO</p> <p>Este manual de usuario describe el funcionamiento básico del teléfono plegable UNIWA V909T. Lea este manual detenidamente antes de utilizar el teléfono para evitar daños o lesiones. Guarde este manual en un lugar seguro para consultar en cualquier momento.</p> <p>Contenido del manual:</p> <ul style="list-style-type: none"><li>1. Introducción</li><li>2. Características</li><li>3. Instalación</li><li>4. Llamadas</li><li>5. Mensajes</li><li>6. Configuración</li><li>7. Especificaciones técnicas</li></ul>	<p><a href="#">UNIWA V909T Manual de Usuario: Guía Completa del Teléfono Plegable</a></p> <p>Descubre el manual de usuario del UNIWA V909T, un teléfono plegable 2G/3G/4G fácil de usar. Aprende sobre sus características, instalación, llamadas, mensajes, configuraciones y especificaciones técnicas.</p>																																																			