

[Manuals.plus](#) /

› [BANDAI SPIRITS](#) /

› BANDAI SPIRITS MGSD Gundam Aerial Model Kit Instruction Manual

## BANDAI SPIRITS MGSD Gundam Aerial

# BANDAI SPIRITS MGSD Gundam Aerial Model Kit Instruction Manual

Model Number: 2773803

## 1. INTRODUCTION

---

This manual provides detailed instructions for assembling and operating your BANDAI SPIRITS MGSD Gundam Aerial Model Kit. Please read all instructions carefully before beginning assembly to ensure proper construction and functionality. This model kit is designed for enthusiasts aged 15 and above.



Figure 1.1: Fully assembled MGSD Gundam Aerial model kit.

## 2. SAFETY INFORMATION

---

**WARNING: CHOKING HAZARD - Small parts. Not for children under 3 years.**

- Keep small parts away from young children.
- Exercise caution when using hobby knives or other sharp tools during assembly.
- Avoid placing parts in your mouth.
- Dispose of plastic runners and waste materials responsibly.

## 3. PACKAGE CONTENTS

---

Verify that all components are present before starting assembly. The kit includes:

- Multiple plastic runners (frames of parts)
- Instruction manual
- Sticker sheet (if applicable)
- Beam Rifle
- Shield (Escutcheon)
- Two types of shell units for Permet Score Six recreation

※画像は開発中の設計データを使用したCGです  
※画像はイメージです



©SOTSU・SUNRISE・MBS

Figure 3.1: Included weapon and effect parts.

## 4. SETUP AND ASSEMBLY

Follow the numbered steps in the included instruction booklet for detailed assembly. The following sections highlight key assembly points.

### 4.1. Core Frame Assembly

Begin by assembling the internal frame of the Gundam Aerial. This forms the skeleton of the model, providing articulation and stability.

※画像は開発中の設計データを使用したCGです  
※画像はイメージです



©SOTSU・SUNRISE・MBS

Figure 4.1: Core internal frame structure.

## 4.2. Shell Unit Installation

The kit includes two types of shell units. Carefully install the desired shell units onto the head, chest, shoulders, and legs. These parts are crucial for recreating different visual states of the Gundam Aerial.

※画像は開発中の設計データを使用したCGです  
※画像はイメージです

**シェルユニットは2種付属。**  
**パーツの差し替えにより**  
**パーメットスコア・シックスを再現可能**

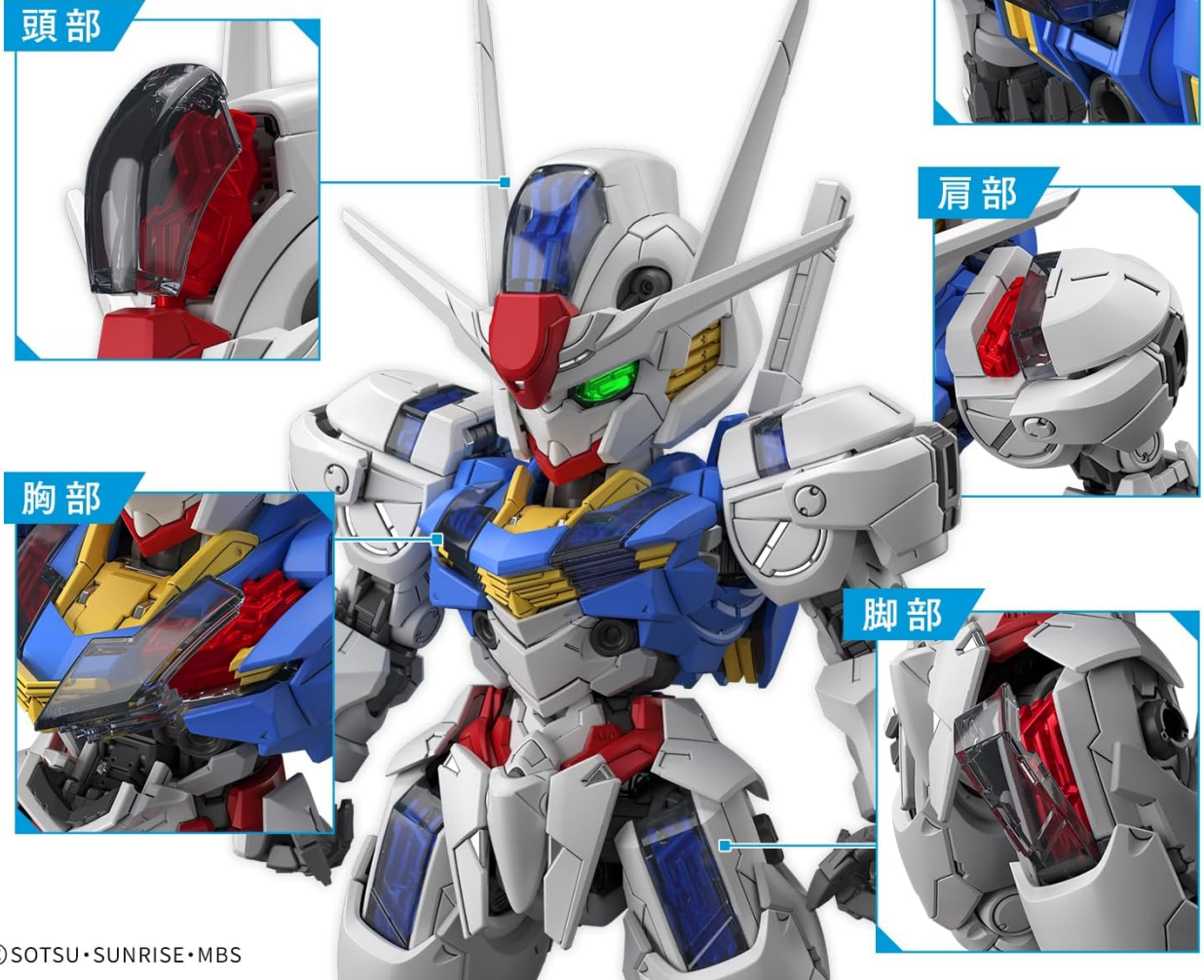

©SOTSU・SUNRISE・MBS

Figure 4.2: Detailed view of shell unit placement on the model.

### 4.3. Bit-on Form Assembly

Assemble the individual bit staves. These can be attached to the main body to recreate the Bit-on Form. Ensure each bit staff is securely connected.

※画像は開発中の設計データを使用したCGです  
※画像はイメージです

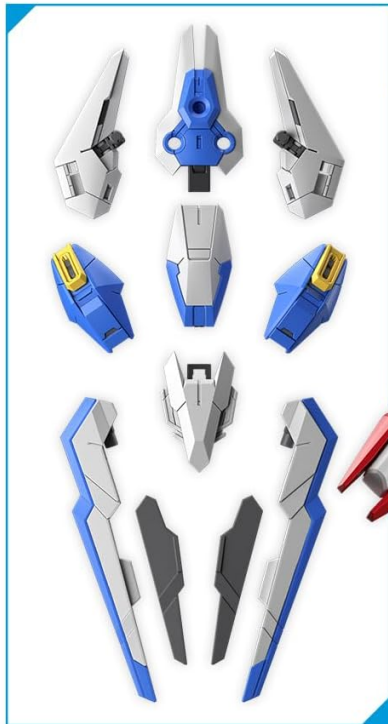

ビットステイヴを  
全身に装備した  
ビットオンフォームを  
再現

©SOTSU・SUNRISE・MBS

Figure 4.3: Components for Bit-on Form assembly.

## 5. OPERATING FEATURES

### 5.1. Permet Score Six Recreation

By replacing the shell units with the alternative set provided, you can recreate the Permet Score Six state of the Gundam Aerial. Refer to the assembly instructions for specific part replacement details.

### 5.2. Articulation and Posing

The MGSD Gundam Aerial features high-density articulation. The front armor moves upwards to ensure a wide range of motion for the legs, allowing for natural poses such as kneeling. The camera eye uses clear parts to create a mechanical multi-layer structure, enhancing visual detail.

※画像は開発中の設計データを使用したCGです  
※画像はイメージです

**フロントアーマーは  
上方へ可動し、  
脚部の可動域を確保。  
立てヒザなどの動きを  
自然に再現**

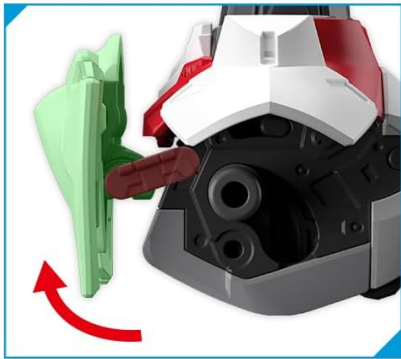

©SOTSU・SUNRISE・MBS

Figure 5.1: Front armor articulation for enhanced leg movement.

※画像は開発中の設計データを使用したCGです  
※画像はイメージです

## カメラアイはクリアパーツを使用し メカニカルな多層構造を演出



©SOTSU・SUNRISE・MBS

Figure 5.2: Detail of the camera eye with clear parts.

### 5.3. Bit Stave Deployment

The model can reproduce the Bit-on form with bit staves equipped across the body. For a dynamic display of the Bit Stave deployment state, combine the model with separately sold Action Base 7 and two sets of the Mercury Witch Weapon Display Base.

※画像は開発中の設計データを使用したCGです  
※画像はイメージです

## 別売りのウェポンディスプレイベースを 組み合わせることでビットステイヴ展開状態を再現

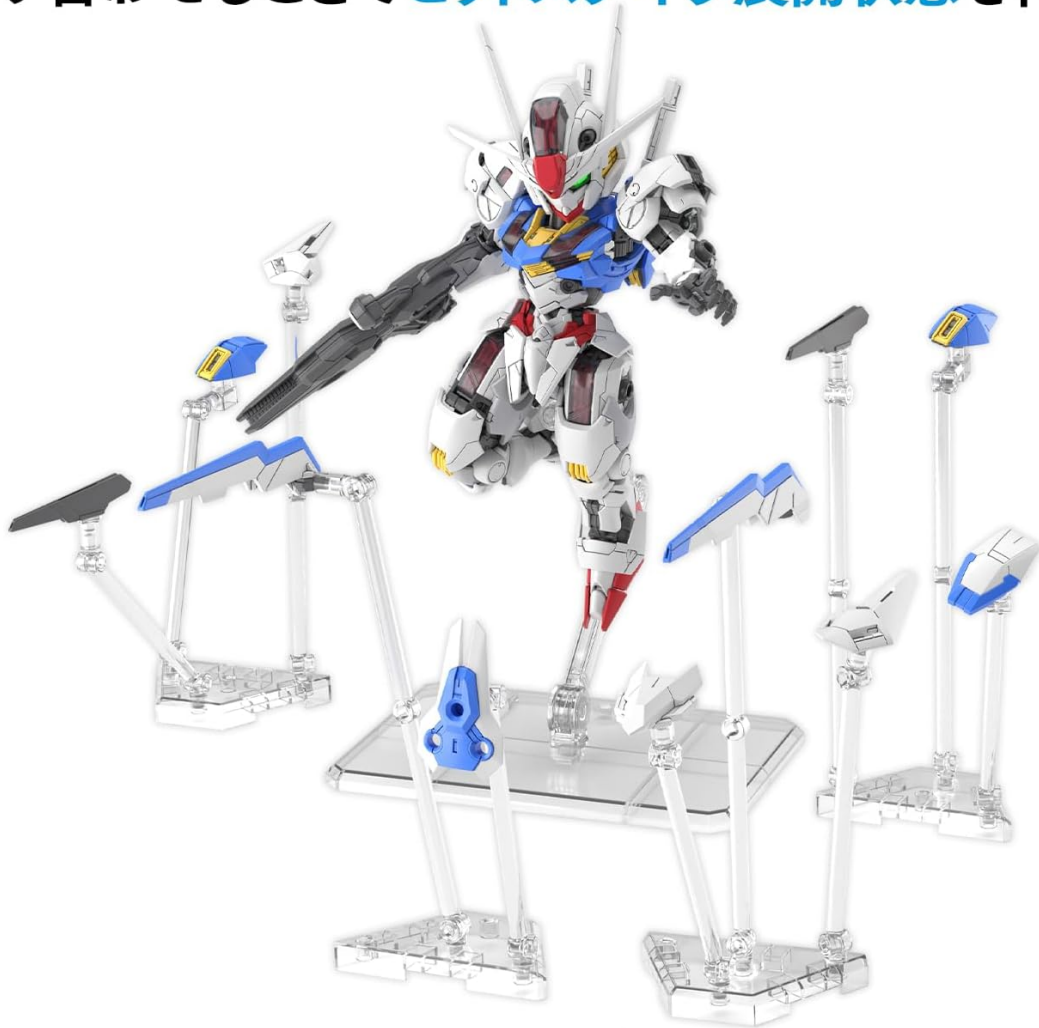

©SOTSU・SUNRISE・MBS

※画像を再現する場合は、別売りの「アクションベース7」に加え、「水星の魔女 ウェポンディスプレイベース」が2セット必要になります。

Figure 5.3: Bit Stave deployment using optional display bases.

### 5.4. Action Base Compatibility

The model is compatible with action bases for aerial posing. A connection point is provided for secure attachment.

※画像は開発中の設計データを使用したCGです  
※画像はイメージです  
※「MGSD ガンダムエアリアル」以外は別売りです

## アクションベースの 接続が可能



©SOTSU・SUNRISE・MBS

Figure 5.4: Action base connection point.

## 6. MAINTENANCE

- **Cleaning:** Use a soft, dry cloth or a soft brush to remove dust. Avoid using harsh chemicals or abrasive materials.
- **Storage:** Store the model in a cool, dry place away from direct sunlight to prevent discoloration or material degradation.
- **Joint Care:** If joints become loose over time, a small amount of clear nail polish or hobby cement applied to the ball joint and allowed to dry can increase friction.

## 7. TROUBLESHOOTING

Issue	Possible Cause	Solution
Parts do not fit together	Incorrect part orientation or excess plastic (nubs)	Verify part orientation with the manual. Carefully trim any remaining plastic nubs from the parts.

Issue	Possible Cause	Solution
Joints are too loose	Normal wear or manufacturing tolerance	Apply a thin layer of clear nail polish or hobby cement to the male part of the joint and let it dry completely before reassembling.
Stickers do not adhere	Dust or oil on the surface	Clean the surface with a soft, dry cloth before applying stickers.

## 8. SPECIFICATIONS

---

**Brand:** BANDAI SPIRITS

**Model Name:** Mobile Suit Gundam: Witch From Mercury - Gundam Aerial MGSD

**Item Model Number:** 2773803

**Material:** Plastic

**Item Dimensions (L x W x H):** 9.7 x 2.83 x 6.37 inches

**Item Weight:** 1.1 pounds (0.5 Kilograms)

**Recommended Age:** 15+ (Manufacturer recommended age: 0 - 8 years, but product complexity suggests 15+)

**First Available:** August 11, 2025

## 9. WARRANTY AND SUPPORT

---

This product is an officially licensed BANDAI SPIRITS item. For support regarding missing parts or manufacturing defects, please contact BANDAI SPIRITS customer service. The product box includes a Bandai Namco warning label, which serves as proof of an officially licensed product.

Please retain your proof of purchase for any warranty claims or support inquiries.