

## Manuals+

[Q & A](#) | [Deep Search](#) | [Upload](#)

[manuals.plus](#) /

- › [Bostitch](#) /
- › [Bostitch Titan Heavy Duty Metal Stapler Instruction Manual](#)

### Bostitch B615-BLK-VP

# Bostitch Titan Heavy Duty Metal Stapler Instruction Manual

Model: B615-BLK-VP

## INTRODUCTION

This manual provides instructions for the safe and efficient use of your Bostitch Titan Heavy Duty Metal Stapler. Please read this manual thoroughly before operating the stapler and retain it for future reference.



Image: The Bostitch Titan Heavy Duty Metal Stapler in black, accompanied by an ergonomic staple remover and stacks of both standard and extended staples.

## SAFETY INFORMATION

- Keep fingers clear of the stapling mechanism during operation.
- Do not attempt to staple materials thicker than the recommended capacity.
- Use only recommended staple sizes for optimal performance and to prevent jams.
- Store the stapler and staples out of reach of children.

## PACKAGE CONTENTS

Verify that all items are present in your package:

- 1 x Bostitch Titan Heavy Duty Metal Stapler (Black)
- 1 x Ergonomic Push-Style Staple Remover
- 1250 x 1/4" (6mm) Standard Staples
- 500 x 5/16" (8mm) Extended Staples

### 4-Part Value Pack Includes 1,752 Pieces



Image: A visual representation of the package contents, including the stapler, staple remover, and both standard and extended staples.

## PRODUCT FEATURES

- **Heavy-Duty Construction:** Durable metal design for lasting performance.
- **High Capacity:** Staples up to 50 sheets using appropriate staples.
- **Jam-Free Technology:** Engineered to prevent staple jams and misfires.
- **Versatile Use:** Opens 180 degrees for tacking onto bulletin boards or crafting.
- **Ergonomic Staple Remover:** Included for comfortable and efficient staple removal.



Image: The stapler with callouts indicating its reliable performance (jam-free with reload indicator), durable metal construction, and 180-degree opening for tacking.

## SETUP: LOADING STAPLES

1. **Open the Stapler:** Lift the top cover of the stapler until it locks into an open position.
2. **Insert Staples:** Place a full strip of Bostitch B8 PowerCrown 1/4" (6mm) standard staples for 2-25 sheets, or 5/16" (8mm) extended staples for 26-50 sheets, into the staple channel. Ensure the staples are facing downwards.
3. **Close the Stapler:** Gently push the top cover down until it clicks securely into place.

### Note on Staple Selection:

- For 2-25 sheets: Use 1/4" (6mm) standard staples.
- For 26-50 sheets: Use 5/16" (8mm) extended staples.



**2X THE POWER**

## **Staples up to 50 Sheets**

Easily staples twice as many pages as standard staplers using two staple sizes (included)



Image: A visual guide demonstrating the use of 1/4" (6mm) standard staples for 2-25 sheets and 5/16" (8mm) extended staples for 26-50 sheets.

## **OPERATING INSTRUCTIONS**

### **Standard Stapling**

1. Place the papers to be stapled under the stapler head, aligning them as desired.
2. Press down firmly on the stapler's top cover until the staple penetrates the paper and clinches underneath.
3. Release the stapler.

### **Tacking (Bulletin Board Use)**

1. Open the stapler 180 degrees by lifting the top cover until it lies flat.
2. Position the paper against the surface (e.g., bulletin board) where you wish to tack it.
3. Press the stapler down, allowing the staple to penetrate the paper and the surface. The staple will not clinch, allowing for easy removal from the surface.

### **Using the Ergonomic Staple Remover**

1. Position the staple remover's metal tip underneath one side of the staple.
2. Gently push the remover forward, sliding the tip under the staple.
3. Lift the remover upwards to dislodge the staple. The push-style design minimizes paper tearing.

## Easy Push-Style Removal

Simply slide the staple grabber end underneath the staple, and gently push forward and pull up for a clean removal



Image: A sequential visual guide illustrating the four steps for effectively using the push-style staple remover to remove staples without damaging paper or corkboards.



Image: Close-up of the ergonomic staple remover, highlighting the finger pad for pressure reduction and the handle pad for

comfortable grip.

## MAINTENANCE

- Keep the stapler clean and free of dust and debris. Use a soft, dry cloth for cleaning.
- Do not use abrasive cleaners or solvents.
- Ensure staples are stored in a dry environment to prevent rust.

## TROUBLESHOOTING

Problem	Possible Cause	Solution
Staples jam or bend	Incorrect staple size for paper thickness, low-quality staples, or stapler not fully closed.	Ensure correct staple size is used (1/4" for 2-25 sheets, 5/16" for 26-50 sheets). Use Bostitch brand staples. Check that the stapler is fully closed after loading.
Staples do not penetrate paper	Paper stack too thick, incorrect staple size, or insufficient force applied.	Reduce paper stack to within 50-sheet capacity. Use 5/16" extended staples for thicker stacks. Apply firm, even pressure.
Stapler does not open for reloading	Mechanism stuck or debris.	Apply gentle, firm pressure to lift the top cover. Check for any obstructions in the hinge area.

## SPECIFICATIONS

- **Model:** B615-BLK-VP
- **Brand:** Bostitch
- **Stapling Capacity:** Up to 50 sheets
- **Staple Compatibility:** Bostitch B8 PowerCrown 1/4" (6mm) Standard Staples (2-25 sheets), Bostitch B8 PowerCrown 5/16" (8mm) Extended Staples (26-50 sheets)
- **Construction:** Metal
- **Operation Mode:** Manual
- **Item Weight:** 14.8 ounces
- **Dimensions:** Approximately 5.94" (151mm) L x 1.57" (40mm) W x 3.26" (83mm) H





Image: A diagram showing the key dimensions of the Bostitch Titan stapler and its accompanying staple remover, along with staple sizes, for storage and reference.

## WARRANTY AND SUPPORT

For warranty information or product support, please refer to the official Bostitch website or contact their customer service department. Keep your purchase receipt as proof of purchase.

**Bostitch Official Website:** [www.bostitch.com](http://www.bostitch.com)

© 2025 Bostitch. All rights reserved.

**Related Documents - B615-BLK-VP**

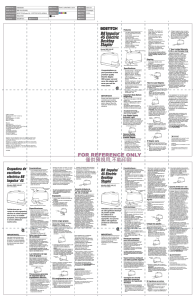

[BOSTITCH B8 Impulse 45 Electric Desktop Stapler User Manual](#)

Comprehensive user manual for the BOSTITCH B8 Impulse 45 Electric Desktop Stapler. Details features, specifications, operation, maintenance, and safety guidelines for this heavy-duty, no-jam electric stapler.

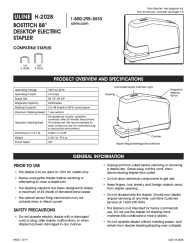

[Bostitch B8 Desktop Electric Stapler User Manual and Guide](#)

This document provides comprehensive instructions and troubleshooting for the Bostitch B8 Desktop Electric Stapler. It covers product specifications, operation, staple loading, clearing jams, and safety precautions. Compatible with ULINE stapler models S-17849 and S-14137.

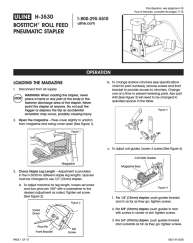

[Bostitch H-3530 Roll Feed Pneumatic Stapler Operation and Maintenance Manual](#)

This manual provides detailed instructions for operating, loading, adjusting, and maintaining the Bostitch H-3530 Roll Feed Pneumatic Stapler. It includes safety warnings, specifications, troubleshooting tips, and replacement parts information.



[BOSTITCH SL1838BC Cap Stapler: Operation and Maintenance Manual](#)

This comprehensive manual provides essential operating, safety, and maintenance instructions for the BOSTITCH SL1838BC Cap Stapler, a high-performance pneumatic fastening tool.



[BOSTITCH Finish Tools Operation and Maintenance Manual](#)

Comprehensive operation and maintenance manual for BOSTITCH SB Series finish tools, including safety instructions, specifications, air supply, lubrication, loading, operation, maintenance, troubleshooting, depth adjustment, accessories, and warranty information.





[BOSTITCH SB Series Finish Tools Operation and Maintenance Manual](#)

This manual provides detailed operation and maintenance instructions for BOSTITCH SB Series finish tools, including safety guidelines, specifications, troubleshooting, and adjustment procedures for models SB-150SX, SB-150SXHD, SB-1664FN, SB-2IN1, SB-1842BN, and SB-1850BN.