

## VEVOR SS-003

# VEVOR Under Sink RO System SS-003 Instruction Manual

Brand: VEVOR | Model: SS-003

## 1. PRODUCT OVERVIEW

---

The VEVOR Under Sink RO System (Model SS-003) is a tankless reverse osmosis water filtration system designed to provide purified water directly from your faucet. This system features an 8-stage filtration process, a 600 GPD (Gallons Per Day) powerful flow rate, and a smart display faucet for real-time TDS monitoring.



Image: VEVOR Under Sink RO System highlighting 600 GPD flow rate, 10-layer RO membrane, >99.99% filtration efficiency, 2:1 pure to drain ratio, 75% space saving, 0.0001µm RO, TDS monitor, BPA free, and low sodium.

## 2. SAFETY INFORMATION

---

- Read all instructions before installation and use.
- Ensure proper electrical grounding for the power supply.
- Turn off the main water supply before performing any installation or maintenance.
- Do not use with water that is microbiologically unsafe or of unknown quality without adequate disinfection before or after the system.
- Keep the system away from direct sunlight and heat sources.
- If the device is not used for more than one week, disconnect the power, turn off the water supply, and turn on the faucet to drain the system. Rinse for 10 minutes before using again.

### 3. INSTALLATION GUIDE

#### 3.1 Pre-Installation Checklist

- Verify all components are present and undamaged.
- Ensure you have the necessary tools (drill, wrench, screwdriver, etc.).
- Confirm compliance with local plumbing codes.

#### 3.2 Installation Requirements

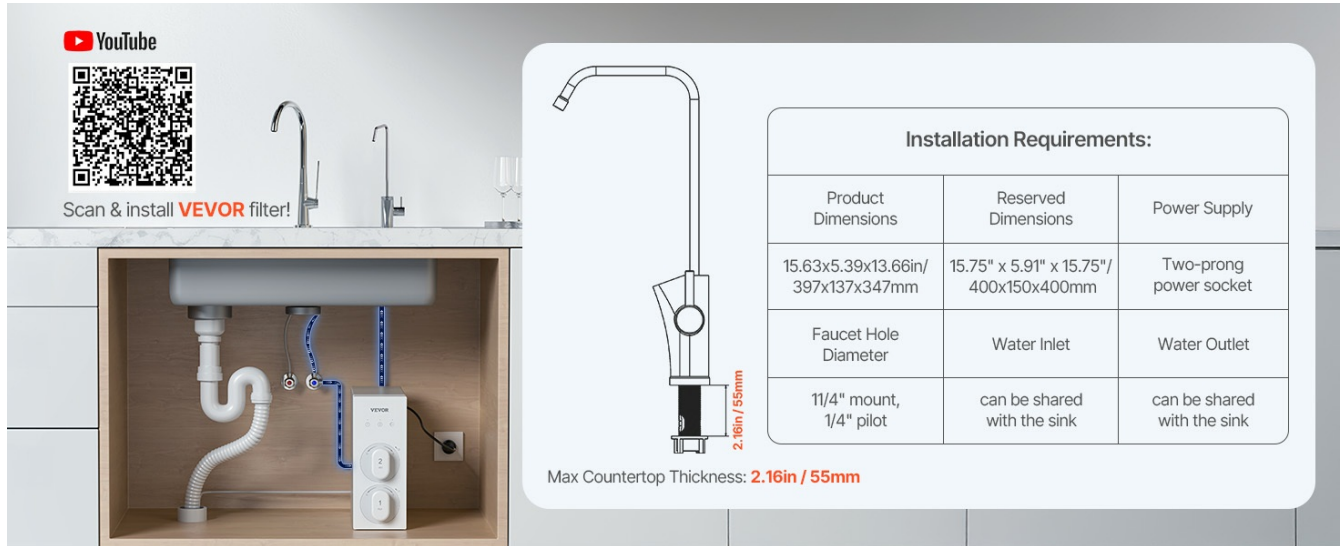

Image: Installation diagram illustrating product dimensions, reserved dimensions, faucet hole diameter, water inlet/outlet connections, and power supply requirements.

#### Installation Requirements

Requirement	Details
Product Dimensions	15.63" x 5.39" x 13.66" (397x137x347mm)
Reserved Dimensions	15.75" x 5.91" x 15.75" (400x150x400mm)
Power Supply	Two-prong power socket
Faucet Hole Diameter	1 1/4" mount, 1/4" pilot
Water Inlet	Can be shared with the sink
Water Outlet	Can be shared with the sink
Max Countertop Thickness	2.16in / 55mm

#### 3.3 Step-by-Step Installation

1. **Prepare the Installation Area:** Clear the under-sink cabinet. Ensure sufficient space for the unit and access for maintenance.
2. **Install the Faucet:** Drill a 1 1/4" hole in the countertop (if not already present) for the dedicated RO faucet. Secure the faucet according to the provided hardware.
3. **Connect Water Inlet:** Turn off the cold water supply. Install the provided adapter to the cold water line under the sink. Connect the input tube from the RO system to this adapter.
4. **Connect Drain Saddle:** Install the drain saddle onto the drain pipe under the sink. Drill a small hole in the drain pipe through the saddle. Connect the waste water tube from the RO system to the drain saddle.

5. **Connect Filtered Water Outlet:** Connect the filtered water tube from the RO system to the dedicated RO faucet.
6. **Install Filters:** Insert the filter cartridges into their respective slots (PCF and RO) on the main unit. Twist to lock them into place.
7. **Power Connection:** Plug the power adapter into a two-prong power socket.
8. **Flush the System:** Turn on the cold water supply. Open the RO faucet and let the water run for at least 30 minutes to flush the system and remove any air bubbles or carbon fines.

For visual guidance, you can refer to the official VEVOR YouTube installation playlist: [VEVOR RO System Installation Playlist](#)

## 4. OPERATING INSTRUCTIONS

---

### 4.1 Initial Startup

- After installation, ensure all connections are secure and leak-free.
- Turn on the main water supply and plug in the system.
- Open the dedicated RO faucet and allow water to flow for approximately 30 minutes to flush the system. This removes air and any initial carbon dust from the filters.

### 4.2 Daily Use

- To dispense purified water, simply open the dedicated RO faucet.
- The smart display on the faucet will show the TDS (Total Dissolved Solids) level of the purified water.
- The system operates automatically, filtering water as needed.

### 4.3 Filter Status Indicators



Image: Front view of the VEVOR RO system showing filter status indicators (1 and 2) and a 'Work' indicator.

The main unit features LED indicators for Filter 1 (PCF) and Filter 2 (RO), along with a 'Work' indicator. These lights provide status updates on filter engagement and system operation.

## 5. MAINTENANCE

---

### 5.1 Filter Replacement

Regular filter replacement is crucial for maintaining water quality and system performance. The system is designed for easy, tool-free filter changes.

- **PCF Filter (Filter 1):** Typically replaced every 12 months.
- **RO Filter (Filter 2):** Typically replaced every 24 months.



Image: VEVOR PCF Composite Water Filter Replacement cartridge.



Image: VEVOR RO Water Filter Replacement cartridge.

### Procedure for Filter Replacement:

1. Turn off the water supply to the RO system.
2. Unplug the power adapter.
3. Rotate the filter cartridge to the unlock position (indicated by an open padlock symbol).
4. Pull the old filter cartridge out.
5. Insert the new filter cartridge, aligning it correctly.
6. Rotate the new filter cartridge to the lock position (indicated by a closed padlock symbol).
7. Plug in the power adapter and turn on the water supply.
8. Flush the system by running water from the RO faucet for several minutes to remove air and any new filter residue.

## 5.2 System Cleaning

Periodically wipe down the exterior of the unit with a clean, damp cloth. Do not use harsh chemicals or abrasive cleaners.

## 6. TROUBLESHOOTING

---

This section provides solutions to common issues. For more complex problems, please contact VEVOR customer support.

- **No Water Flow:** Check if the water supply is turned on, the system is plugged in, and filters are correctly installed and not clogged.
- **Slow Water Flow:** This may indicate clogged filters. Replace the PCF or RO filter as needed. Ensure adequate water pressure.

- **Unusual Taste/Odor:** Flush the system thoroughly. If the problem persists, replace the filters.
- **High TDS Reading:** If the smart faucet displays a high TDS reading, the RO membrane may need replacement.
- **Leaking:** Turn off the water supply immediately. Check all connections and ensure they are tightened properly. Inspect O-rings and replace if damaged.

## 7. SPECIFICATIONS

### Product Specifications

Feature	Detail
Brand	VEVOR
Model	SS-003
Daily Production Capacity	600 GPD
Filtration Stages	8-Stage (PCF, RO)
RO Membrane Filtration	0.0001 µm
Filtration Efficiency	>99.99%
Pure to Drain Ratio	2:1
Water Flow Rate	34 oz/min
Power Rating	DC24V / 4A (Via AC100-240V 50/60Hz adapter)
Water Temperature	40-100°F (5-38°C)
Certifications	SGS Tested (Meets ANSI/42&53 Standards), FCC Compliant

For detailed SGS test reports, scan the QR code on the product packaging or visit: [SGS Report](#)

## 8. WARRANTY AND SUPPORT

VEVOR is committed to delivering reliable and affordable products. Warranty information and technical support are available through official channels.

- Warranty ends automatically if using replacement parts, filters, membranes, or other accessories that are not sold or manufactured by VEVOR.
- When the machine breaks down, please cut off the water and power supply quickly.

For technical support and e-warranty certificates, please visit the VEVOR support page: [www.vevor.com/support](http://www.vevor.com/support)

## 9. OFFICIAL PRODUCT VIDEOS

---

No official product videos from the seller were found in the provided data. Please refer to the VEVOR support website or YouTube channel for any available video guides.