

## YITAMOTOR MAYIMUI6V0

# YITAMOTOR Towing Mirrors User Manual

Compatible with 2007-2014 Silverado Sierra 1500 2500 3500 HD/Suburban/Avalanche

## 1. PRODUCT OVERVIEW

These YITAMOTOR Towing Mirrors are designed as a direct replacement for specific Chevrolet Silverado and GMC Sierra models, as well as compatible Avalanche, Suburban, Tahoe, and Yukon XL vehicles. They enhance visibility when towing, featuring a range of functions for improved safety and convenience.

The mirrors are equipped with power-adjustable plane mirrors, manually adjustable convex lenses, power heating, manual telescoping, manual folding, turn signal lights, and running lights.

## 2. VEHICLE FITMENT

- 2007-2013 Silverado Sierra 1500 / Avalanche / Suburban 2500 / Yukon XL 2500
- 2007-2014 Silverado Sierra 2500 HD 3500 HD / Suburban 1500 / Tahoe / Yukon XL 1500

**Note:** This mirror is engineered as a direct replacement for vehicles with the specified feature set. If your vehicle's mirrors lack any of the listed functions, compatibility may be affected. Professional installation is recommended to ensure proper functionality.

## 3. PACKAGE CONTENTS & DIMENSIONS

The package includes a pair of telescoping trailer tow mirrors: one for the driver side and one for the passenger side.

### Dimensions:

- Side mirror length (closed): 18 inches
- Side mirror length (extended): 20.8 inches
- Side mirror face size: 12 inches × 8.8 inches

# POWER HEATED

Remove moisture to keep the rear view clear



Image: Detailed product dimensions for the YITAMOTOR towing mirrors, illustrating the length when closed (18 inches) and extended (20.8 inches), and the mirror face size (12x8.8 inches).

## 4. FEATURES AND FUNCTIONS

- **Power Adjustable Plane Mirror:** The main mirror glass can be adjusted electronically from inside the vehicle for optimal rear view.
- **Manually Adjustable Convex Lens:** The lower convex mirror provides a wider field of view and can be adjusted manually to minimize blind spots.
- **Power Heated:** Integrated heating elements remove moisture and ice from the mirror surface, ensuring a clear view in adverse weather conditions.
- **Manual Telescoping:** The mirror housing can be manually extended outwards to provide an enhanced view around wide trailers.
- **Manual Folding:** The mirrors can be manually folded inward against the vehicle body to prevent damage in tight spaces or when parked.
- **Turn Signal Light:** Integrated amber LED lights function as turn signals, increasing visibility to other drivers.

- **Running Lights:** White LED lights provide additional illumination and enhance the vehicle's presence.
- **Backup Light:** Dedicated lights assist with visibility when reversing.

# TURN SIGNAL

Excellent color rendering, less optical loss



Image: The mirror features both white running lights and amber dynamic turn signal lights for enhanced visibility.



# POWER HEATED

Remove moisture to keep the rear view clear



Image: The power heated feature effectively removes moisture and keeps the rear view clear in various weather conditions.

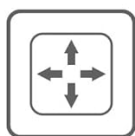

Power-adjustable



Power Heated



Turn singal



Manually Telescoping



Manual-folding



Clearance Lamp



Image: The manual folding function allows the mirror to be folded inward to avoid obstacles or for parking.



Aluminum Base



Pre-installed Studs



ABS Housing

Image: This diagram illustrates the various components of the mirror, including the power-adjustable plane mirror, manually adjustable convex lens, turn signal light, and backup light.

## 5. INSTALLATION GUIDE

Installation of the YITAMOTOR Towing Mirrors is designed to be straightforward, often requiring no drilling or modifications. It involves connecting the mirror's plugs to the corresponding power cord in your vehicle.

1. Carefully remove the plastic plate from the inside of your vehicle's door, typically using a screwdriver.
2. Locate and remove the screws that secure the existing mirror and door panel.
3. Disconnect the old mirror's wiring harness.
4. Install the new YITAMOTOR towing mirror, connecting its wiring harness to the vehicle's power cord. Ensure all connections are secure.
5. Re-secure the mirror with the screws and reattach the door panel and plastic plate.

While designed for simple installation, professional installation is highly recommended to ensure correct wiring and optimal performance.



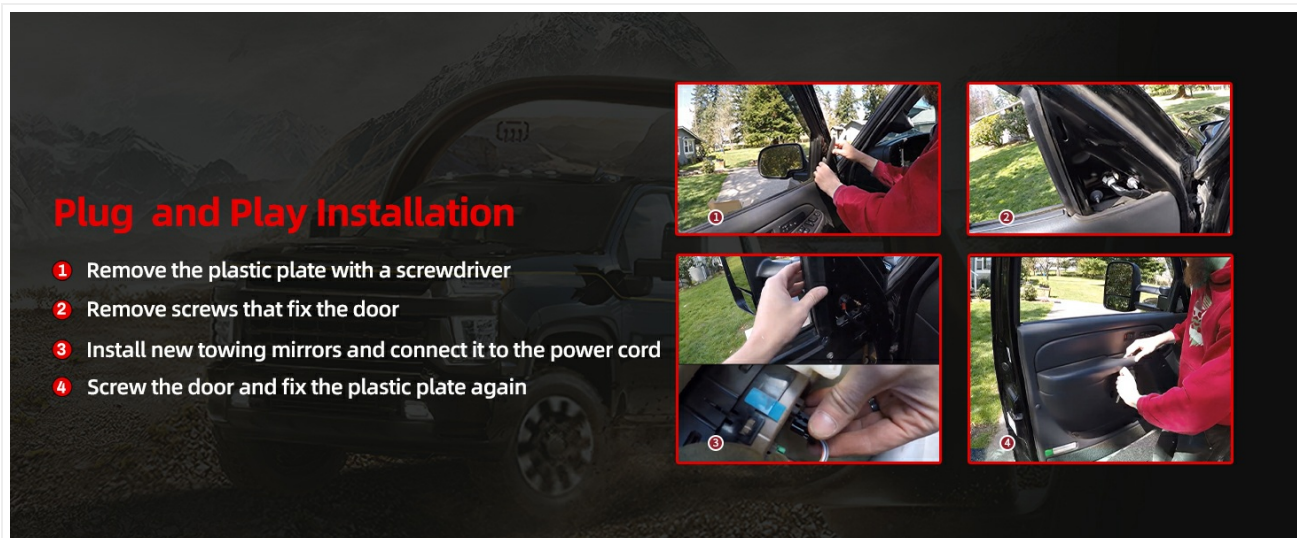

Image: Visual guide demonstrating the plug-and-play installation process, from removing the door panel to connecting the new mirrors.

## 6. OPERATING INSTRUCTIONS

---

- **Power Mirror Adjustment:** Use your vehicle's interior mirror control switch to adjust the angle of the main plane mirror.
- **Convex Lens Adjustment:** The lower convex mirror is adjusted manually by gently pushing on the mirror glass to achieve the desired angle.
- **Manual Telescoping:** To extend the mirrors for towing, grasp the mirror housing firmly and pull it outwards until it locks into the extended position. To retract, push the mirror housing inwards until it locks into the standard position.
- **Manual Folding:** To fold the mirrors, gently push the mirror housing towards the vehicle body. To return to the operating position, pull the mirror housing outwards until it clicks into place.
- **Heated Function:** The heated mirror function is typically activated via a switch inside your vehicle, often integrated with the rear defroster control. Refer to your vehicle's owner's manual for specific activation instructions.
- **Turn Signals and Running Lights:** These functions operate automatically with your vehicle's existing electrical system when the corresponding signals (turn signal, headlights) are activated.

## 7. MAINTENANCE

---

Regular maintenance ensures the longevity and optimal performance of your towing mirrors.

- **Cleaning:** Clean the mirror glass and housing regularly with a mild automotive cleaner and a soft cloth. Avoid abrasive cleaners or harsh chemicals that could damage the finish or mirror surface.
- **Inspection:** Periodically check all electrical connections for corrosion or damage. Ensure the manual folding and telescoping mechanisms operate smoothly.
- **Winter Care:** In freezing conditions, ensure the mirrors are free of ice before attempting to fold or telescope them to prevent damage to the mechanisms.

## 8. TROUBLESHOOTING

---

If you encounter issues with your YITAMOTOR Towing Mirrors, consider the following common troubleshooting steps:

- **Mirror Not Adjusting Electronically:** Check the wiring connections to ensure they are secure and properly seated. Verify that your vehicle's mirror adjustment fuse is intact.

- **Heated Function Not Working:** Confirm that the heated mirror function is activated in your vehicle. Check the fuse associated with the heated mirrors or rear defroster. Ensure all wiring connections are secure.
- **Turn Signal/Running Lights Not Functioning:** Inspect the wiring connections for the lights. Verify that your vehicle's turn signal or running light fuses are not blown.
- **Manual Folding/Telescoping Stiff or Not Working:** Ensure there is no obstruction or debris in the mechanism. Apply a silicone-based lubricant to moving parts if necessary, avoiding petroleum-based products. Do not force the mechanism if it feels stuck.
- **Compatibility Issues:** As noted in the Vehicle Fitment section, if your original vehicle mirrors lacked certain functions (e.g., power heat), the corresponding function on the new mirrors may not operate without additional wiring or vehicle modifications. Consult a professional if you suspect a compatibility issue beyond simple plug-and-play.





## 9. SPECIFICATIONS

| Feature                     | Detail                       |
|-----------------------------|------------------------------|
| Brand                       | YITAMOTOR                    |
| Model                       | MAYIMUI6V0                   |
| Auto Part Position          | Front Outside                |
| Item Dimensions (L x W x H) | 22.44 x 14.17 x 14.76 inches |
| Color                       | Black-Switchback Light       |
| Mounting Type               | Door Mount                   |
| Included Components         | Left + Right Towing Mirrors  |
| Special Feature             | Vehicle Specific Fit         |
| Fit Type                    | Vehicle Specific Fit         |
| Size (closed/extended)      | 18" x 20.8" x 12" x 8.8"     |
| Shape                       | Rectangular                  |
| Item Weight                 | 21.2 pounds                  |
| Material                    | Glass, Plastic               |
| UPC                         | 197839337138                 |

## 10. WARRANTY AND SUPPORT

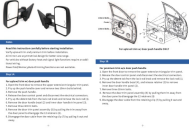
For warranty information or technical support regarding your YITAMOTOR Towing Mirrors, please refer to the documentation included with your purchase or contact YITAMOTOR customer service directly through their official website or the retailer where the product was purchased. Ensure you have your model number (MAYIMUI6V0) and purchase details available when contacting support.



|   |   |
|---|---|
|    | <p><a href="#"><u>YITAMOTOR Extendable Tow Mirror Installation Guide for Chevy Silverado/GMC Sierra (1999-2002)</u></a></p> <p>Detailed installation instructions for YITAMOTOR extendable tow mirrors, designed for 1999-2002 Chevrolet Silverado and GMC Sierra models. Covers step-by-step mounting, electrical connection, and includes important notes and a wire diagram.</p> |
|    | <p><a href="#"><u>YITAMOTOR Towing Mirrors Installation Guide for Chevy Silverado, GMC Sierra, Cadillac Yukon</u></a></p> <p>Detailed installation instructions for YITAMOTOR® towing mirrors compatible with 2007-2013 Chevy Silverado, GMC Sierra, and Cadillac Yukon models. Includes steps for door panel removal, mirror mounting, and wiring.</p>                             |
|    | <p><a href="#"><u>YITAMOTOR Towing Mirrors Installation Guide for Chevy GMC Silverado Sierra Tahoe Yukon</u></a></p> <p>Detailed installation instructions for YITAMOTOR Left and Right Driver Side Towing Mirrors, compatible with 1999-2006 Chevy GMC Silverado, Sierra, Tahoe, Suburban, and Yukon models. Includes step-by-step guidance and wiring diagrams.</p>               |
|    | <p><a href="#"><u>YITAMOTOR 3" Running Boards Installation Guide for Silverado &amp; Sierra (1999-2018)</u></a></p> <p>Step-by-step installation instructions and parts list for YITAMOTOR 3-inch running boards compatible with 1999-2018 Chevrolet Silverado and GMC Sierra pickup trucks.</p>  |
|  | <p><a href="#"><u>YITAMOTOR Towing Mirror Installation Guide for Chevy Silverado &amp; GMC Sierra</u></a></p> <p>Step-by-step installation instructions for YITAMOTOR towing mirrors, compatible with 1999-2007 Chevrolet Silverado, GMC Sierra, Suburban, Tahoe, and Yukon models (including 2007 Classic).</p>  |
|  | <p><a href="#"><u>YITAMOTOR Tow Mirrors Installation Guide for Toyota Tundra (2007-2017)</u></a></p> <p>Step-by-step installation instructions for YITAMOTOR® tow mirrors on 2007-2017 Toyota Tundra models. Includes wiring diagram and important notes.</p>   |