

Waterdrop 10UB, UL12B

Waterdrop 10UB/UL12B Under Sink Water Filter System Instruction Manual

Model: 10UB, UL12B

INTRODUCTION

This manual provides detailed instructions for the installation, operation, and maintenance of your Waterdrop 10UB and UL12B Under Sink Water Filter System. This system is designed to provide clean, filtered water by reducing various contaminants while preserving beneficial minerals. Please read this manual thoroughly before installation and use to ensure proper function and safety.

SAFETY INFORMATION

- Ensure all connections are secure to prevent leaks. Turn off the main water supply before installation or maintenance.
- This system is designed for use with cold water lines only. Do not connect to a hot water supply.
- Do not expose the filter system to freezing temperatures.
- The activated carbon in the filter is made from natural coconut shells. If you have a known allergy to coconut products, please consult a healthcare professional before using this product.
- Do not use with water that is microbiologically unsafe or of unknown quality without adequate disinfection before or after the system.
- Maintain appropriate water pressure as specified in the product specifications.

PACKAGE CONTENTS

Verify that all components are present before beginning installation.



Image: Overview of the Waterdrop under sink water filter system components, including the main filter unit, a dedicated faucet, water tubing, and various connection fittings.

- Water Filter Unit (10UB/UL12B)
- Dedicated Faucet
- Water Tubing (3/8")
- 3/8" to 1/2" Converter
- Connection Fittings and Adapters
- Suction Cup Base
- User Manual

SETUP AND INSTALLATION

The Waterdrop under sink water filtration system is designed for drill-free installation, utilizing a twist-and-

lock setup for convenience. It connects directly to your existing cold water line.

1. **Prepare the Installation Area:** Clear the under-sink cabinet area. Ensure the main water supply to the sink is turned off.
2. **Install the Faucet:** If a dedicated faucet is included and required, install it in a pre-drilled hole on your sink or countertop. Secure it firmly.
3. **Connect to the Filter Unit:** Attach the water tubing to the inlet and outlet ports of the filter unit. The twist-and-lock mechanism ensures a secure connection. The suction cup base helps stabilize the unit.
4. **Connect to Water Supply:**
 - Locate your cold water supply line under the sink.
 - Disconnect the existing faucet's cold water line from the angle stop valve.
 - Install the provided 3/8" line or use the 3/8" to 1/2" converter if necessary, to connect the filter system to the cold water supply valve.
 - Reconnect your existing faucet's cold water line to the new connection point.
5. **Connect to the Faucet:** Connect the filtered water outlet tubing from the filter unit to the dedicated faucet.
6. **Check for Leaks:** Slowly turn on the main water supply. Check all connections for any signs of leaks. Allow water to run through the new faucet for several minutes to flush the system and remove any air.

Easy Installation



1 Connect to the filter

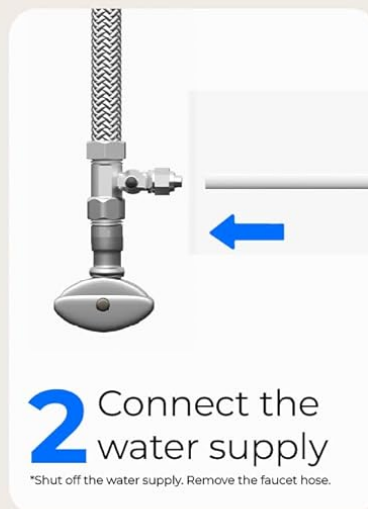

2 Connect the water supply



3 Connect to the faucet

Image: Visual guide illustrating the three main steps for installing the Waterdrop under sink filter: 1. Connect to the filter, 2. Connect the water supply, and 3. Connect to the faucet.

OPERATING INSTRUCTIONS

- Once installed, the system operates automatically when the dedicated faucet is opened.
- The system provides a rapid flow rate of approximately 5.026 liters per minute (L/min).
- The filter is designed to process up to 11,000 gallons of water or last for 12 months, whichever comes first, before requiring replacement.
- This filter system is specifically designed to reduce harmful contaminants while retaining beneficial minerals. It does not reduce Total Dissolved Solids (TDS).

Filter Replacement

The Waterdrop system features an intelligent filter replacement alert to ensure continuous access to clean water.

- **Red Light Flashing and Beep:** This indicates it is time to replace the filter cartridge.
- **Green Light Flashing:** This indicates it is time to replace the battery for the indicator.
- If there is no light or a steady green light, the filter and battery are functioning correctly. Tap the indicator to check the status and save power.

Filter Life Reminder

Helping your filter stay fresh



Image: Illustration of the filter life reminder system, showing a green flashing light for battery replacement and a red

flashing light with a beep for filter replacement.

Replacing the Filter Cartridge:

1. Turn off the cold water supply to the filter system.
2. Twist the old filter cartridge counter-clockwise to unlock and remove it.
3. Insert the new filter cartridge into the housing and twist clockwise until it locks securely into place.
4. Turn on the cold water supply and flush the new filter for several minutes to remove any carbon fines and air.
5. Reset the filter indicator if applicable, following the instructions provided with the replacement filter.

FILTRATION PERFORMANCE AND CERTIFICATIONS

The Waterdrop 10UB/UL12B system employs advanced filtration technology to deliver high-quality drinking water.

Certified Deep Filter

Convenient Water Choice

NSF/ANSI 372 certified

Lead-free materials

NSF/ANSI 42 certified

Reduce Chlorine, Taste & Odor



PFOA*



PFOS*



VOC*



Rust*



Heavy
metals*



Chemical
impurities*

*Tested by a third-party lab.

Note: This product does not remove TDS and can only be connected to cold water lines.



Image: Visual representation of the filter's capabilities, highlighting its effectiveness in reducing PFOA, PFOS, VOCs, rust, heavy metals, and chemical impurities. Certified to NSF/ANSI 372 (lead-free) and NSF/ANSI 42 (chlorine, taste, odor reduction).

- **Advanced Filtration:** Reduces PFAS, PFOA/PFOS, rust, lead, chlorine, heavy metals, chemical contaminants, and sand. It also improves taste and odor.
- **IAPMO Certified:** The filter element is certified by IAPMO R&T against NSF/ANSI Standard 42 for the reduction of chlorine, taste, and odor, and against NSF/ANSI 372 for lead-free materials ($\leq 0.25\%$ lead).
- **Material Safety:** Made with BPA-free and lead-free materials, ensuring safety for all users.
- **Note on TDS:** This system is designed to retain beneficial minerals and therefore does not reduce Total Dissolved Solids (TDS). A TDS meter is not an accurate tool for measuring the effectiveness of this specific filtration system.

NSF/ANSI 42 & 372 Certified



The filter element is certified by IAPMO R&T against NSF/ANSI Standard 42 in Model **WD-UL12B** for the reduction of the claims specified on the Performance Data Sheet, and to NSF/ANSI 372 ($\leq 0.25\%$ lead).



Image: Close-up view of IAPMO Research and Testing, Inc. certificates, confirming compliance with NSF/ANSI 42 and 372 standards for the WD-UL12B model.

High Performance Filtration

Chlorine

Taste & Odor

Heavy metals*

Sand*

VOC*



Chloroform*

Turbidity*

Rust*

Chloro-
benzenz*

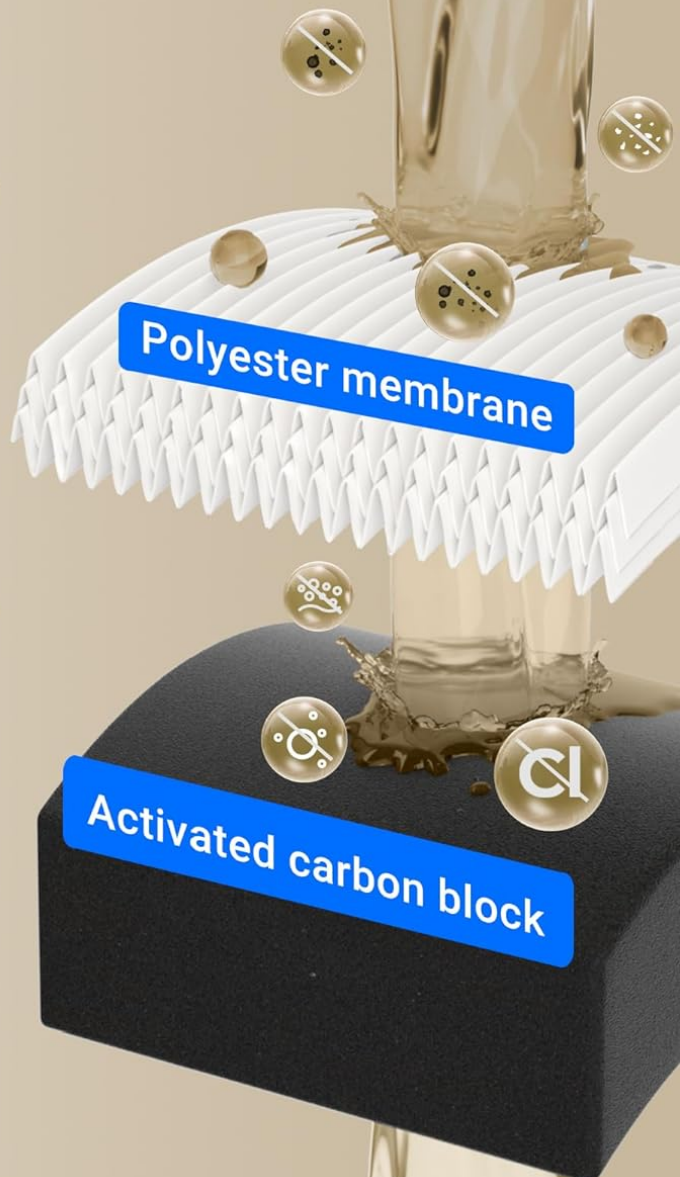
More*



*Tested by a third-party lab.

Image: Cross-section diagram showing the high-performance filtration layers, including a polyester membrane and an activated carbon block, designed to remove various impurities like chlorine, taste & odor, heavy metals, sand, VOCs, chloroform, turbidity, and rust.

Larger Filtration Surface Better-Tasting Water

Waterdrop

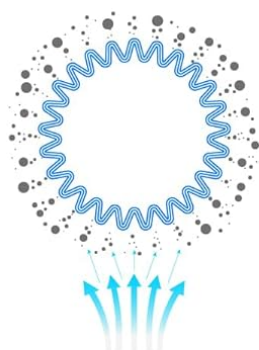

- 3 Layers
- 20X Filtration Efficiency



Other

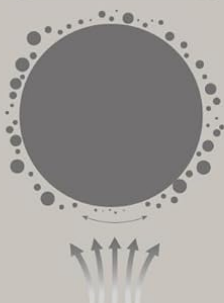

Single layer
Thin paper



Image: Comparative illustration highlighting Waterdrop's larger filtration surface and 3-layer design, offering 20 times greater filtration efficiency compared to a standard single-layer thin paper filter.

TROUBLESHOOTING

• Low Water Flow:

- Check if the filter cartridge needs replacement (refer to filter life indicator).
- Ensure the water supply valve is fully open.
- Inspect tubing for kinks or blockages.

• Leaks at Connections:

- Turn off water supply immediately.

- Verify all fittings are tightened securely.
- Ensure O-rings or gaskets are properly seated and not damaged.
- **Bad Taste or Odor After Installation:**
 - Flush the system for a longer period (e.g., 10-15 minutes) to remove any residual carbon fines or air.
 - Ensure the filter cartridge is correctly installed and not expired.
- **Filter Indicator Not Working:**
 - Check if the battery needs replacement (green flashing light).
 - Ensure the battery is inserted correctly.

SPECIFICATIONS

Model Numbers	10UB, UL12B
Filtration Capacity	11,000 Gallons
Filter Lifespan	Up to 12 Months (or 11,000 gallons, whichever comes first)
Flow Rate	5.026 L/min
Operating Temperature	40-100°F (4.4-37.8°C)
Operating Pressure	15-100 psi (103-689 kPa)
Certifications	NSF/ANSI 42 & 372, IAPMO Certified
Materials	BPA-free, Lead-free
ASIN	B0DWSFPT5J
Date First Available	February 11, 2025

WARRANTY AND SUPPORT

Waterdrop provides customer support for its products. For warranty information, technical assistance, or to purchase replacement filters, please contact Waterdrop customer service through the official website or your retailer.

Please have your model number (10UB or UL12B) and purchase date available when contacting support.