

Manuals+

[Q & A](#) | [Deep Search](#) | [Upload](#)

manuals.plus /

› [MOREGAX](#) /

› [MOREGAX M10 Pro+ Bluetooth Receiver Transmitter User Manual](#)

MOREGAX M10 Pro+

MOREGAX M10 Pro+ Bluetooth Receiver Transmitter User Manual

Model: M10 Pro+

INTRODUCTION

The MOREGAX M10 Pro+ is a versatile 2-in-1 Bluetooth 5.2 audio adapter designed to enhance your audio experience. It functions as both a Bluetooth transmitter (TX) and a Bluetooth receiver (RX), allowing you to add wireless audio capabilities to a wide range of devices, including TVs, home stereos, vintage speakers, and music streaming systems. This manual provides detailed instructions for setup, operation, and troubleshooting to ensure optimal performance of your device.

SAFETY INFORMATION

Battery Handling: Keep the battery out of reach of children. Do not expose the battery to excessive heat or humidity. Dispose of the battery in accordance with local regulations.

Interference Warning: This device may interfere with other wireless devices. Follow manufacturer's instructions to minimize interference.

PACKAGE CONTENTS

Verify that all items are present in the box:

- 1x M10 Pro+ Bluetooth Adapter
- 1x AUX 3.5mm Audio Cable
- 1x RCA Audio Cable
- 1x Type-C Charging Cable
- 1x User Manual

PRODUCT OVERVIEW

The MOREGAX M10 Pro+ features a compact design with multiple input/output options and an intuitive digital display.

Device Layout and Ports



This image shows the various ports and controls on the MOREGAX M10 Pro+ device. On the left side, from top to bottom, are a Type-C (battery) port, RCA (Input/Output) ports, and an AUX (Input/Output) port. On the right side, from top to bottom, are a Mode Switch (TX/RX), a USB Disk Port, and another Type-C (battery) port. The device also features a circular digital display in the center.

- **Type-C (DC 5V):** Power input and charging port.
- **Mode Switch (TX/RX):** Toggle between Transmitter and Receiver modes.
- **RCA (Input/Output):** Red and white audio jacks for RCA cable connection.
- **USB Disk Port:** For USB drive audio playback or transmission.
- **AUX (3.5mm Input/Output):** Standard 3.5mm audio jack for AUX cable connection.
- **Digital Display:** Shows current mode, decoding format, and working status.
- **Control Buttons:** Power ON/OFF/Search, Volume Reduction/Previous, Pause/Play/Answer/Hang Up, Volume Plus/Next.

Key Features

- **2-in-1 Functionality:** Easily switch between Transmitter (TX) and Receiver (RX) modes.
- **Bluetooth 5.2 with Qualcomm Chip:** Ensures stable connection, superior decoding, and high-fidelity stereo sound. Supports SBC, AAC, aptX, aptX-LL, and aptX-HD.
- **Low Latency:** Minimizes audio delay for a synchronized experience.
- **Broad Compatibility:** Connects to a wide range of audio devices via 3.5mm AUX, RCA, and USB.
- **Upgraded Digital Display + RGB Design:** Provides clear status indication and customizable ambient lighting effects.
- **Dual Connection:** Connects two Bluetooth headphones/speakers in TX mode or two smartphones in RX mode simultaneously.
- **400mAh Lithium Battery:** Offers 8-10 hours of continuous listening, 1.5 hours charging time, and 30 days standby time.

SETUP AND INITIAL USE

Powering On/Off

Press and hold the Power button (labeled with a power symbol and 'Q') for 3 seconds to turn the device ON or OFF.

Charging the Device

Connect the provided Type-C charging cable to the Type-C port on the device and to a 5V USB power adapter (not included). The digital display will indicate charging status. A full charge takes approximately 1.5 hours.

OPERATING MODES

The M10 Pro+ supports two main operating modes: Receiver (RX) and Transmitter (TX). Use the TX/RX mode switch on the side of the device to select the desired mode.

Receiver (RX) Mode

In RX mode, the M10 Pro+ receives audio wirelessly from your smartphone or other Bluetooth-enabled devices and outputs it to non-Bluetooth wired speakers, car stereos, or home audio systems.

1. Set the mode switch to **RX**. The "RX" lamp on the display will rapidly flash.
2. Connect the M10 Pro+ to your non-Bluetooth audio system (e.g., speakers, amplifier) using the 3.5mm AUX or RCA audio cable.
3. On your smartphone or Bluetooth-enabled device, search for "M10 Pro+" in the Bluetooth settings and pair.
4. Once paired, the "RX" light will illuminate steadily. You can now stream audio from your device to your connected audio system.

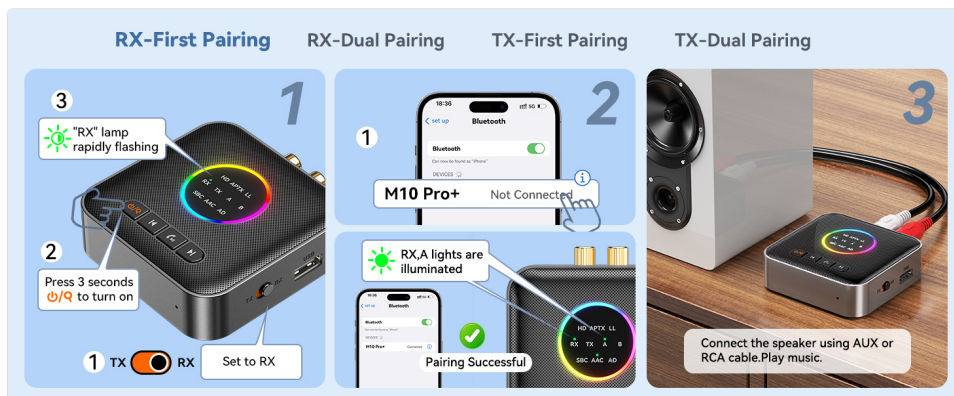

This image illustrates the first pairing process in Receiver (RX) mode. Step 1 shows setting the switch to RX and the "RX" lamp flashing. Step 2 shows pairing with "M10 Pro+" on a smartphone. Step 3 shows connecting the device to a speaker via AUX or RCA cable and playing music after successful pairing.

RX Dual Pairing

To connect a second smartphone in RX mode:

1. After the first device (Device A) is paired, double-click the Power button. The "RX" lamp will rapidly flash again.
2. On the second smartphone (Device B), search for "M10 Pro+" in the Bluetooth settings and pair.
3. Both devices A and B will now be connected. To switch audio playback, pause audio on the currently playing phone before starting playback on the other.

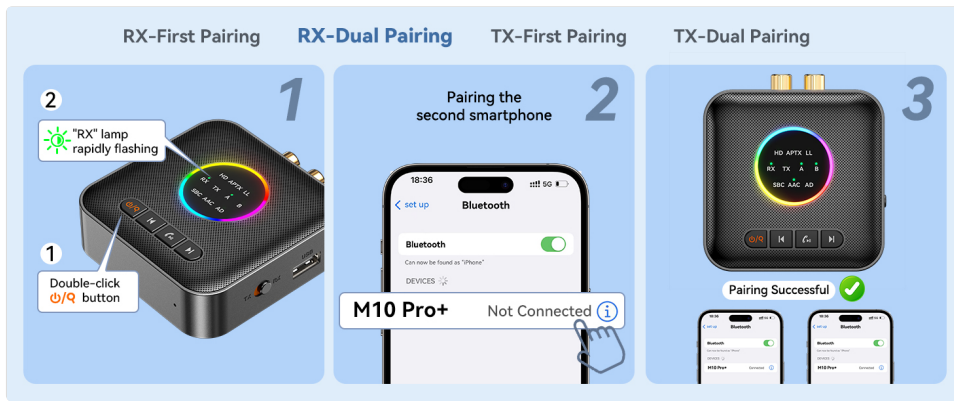

This image demonstrates dual pairing in RX mode. Step 1 shows double-clicking the power button after the first phone is connected. Step 2 shows pairing the second smartphone. Step 3 confirms successful pairing of both phones.

Transmitter (TX) Mode

In TX mode, the M10 Pro+ takes audio from a non-Bluetooth device (like a TV or laptop) and transmits it wirelessly to Bluetooth headphones or speakers.

1. Set the mode switch to **TX**. The "TX" lamp on the display will rapidly flash.
2. Connect the M10 Pro+ to your non-Bluetooth audio source (e.g., TV, laptop) using the 3.5mm AUX or RCA audio cable.
3. Put your Bluetooth headphones or speakers into pairing mode.
4. The M10 Pro+ will automatically search for and connect to nearby Bluetooth audio devices. Once paired, the "TX" light will illuminate steadily.

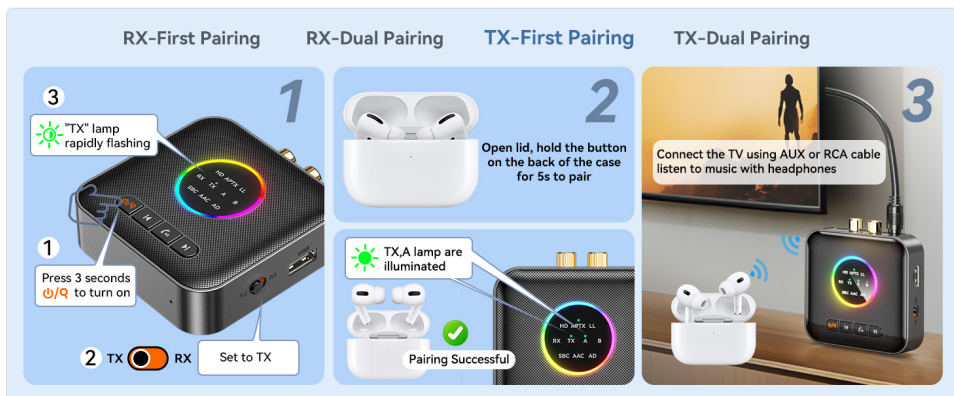

This image illustrates the first pairing process in Transmitter (TX) mode. Step 1 shows setting the switch to TX and the "TX" lamp flashing. Step 2 shows putting Bluetooth headphones into pairing mode. Step 3 shows connecting the device to a TV via AUX or RCA cable and listening with headphones after successful pairing.

TX Dual Pairing

To connect a second pair of Bluetooth headphones/speakers in TX mode:

1. After the first device (Device A) is paired, double-click the Power button. The "TX" lamp will rapidly flash again.
2. Put the second pair of Bluetooth headphones/speakers (Device B) into pairing mode.
3. The M10 Pro+ will automatically search for and connect to the second device.
4. Both devices A and B will now be connected, allowing two users to listen simultaneously.

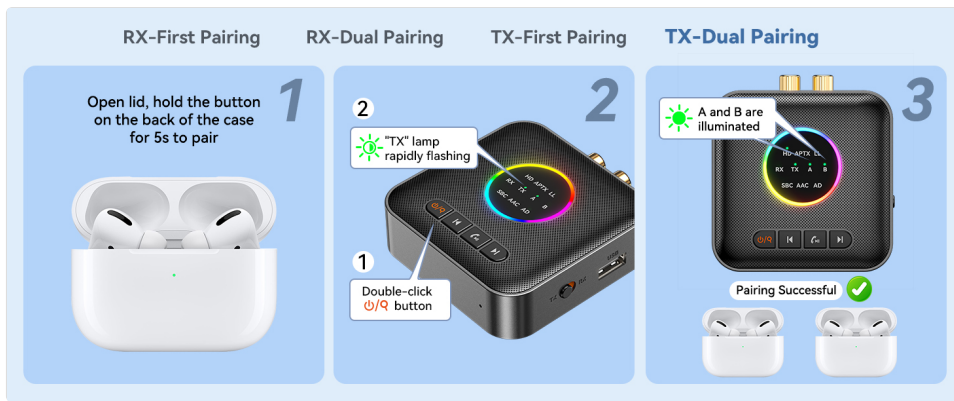

This image demonstrates dual pairing in TX mode. Step 1 shows putting the second pair of headphones into pairing mode. Step 2 shows double-clicking the power button. Step 3 confirms successful pairing of both headphones.

USB Drive Playback/Transmission

The M10 Pro+ supports audio playback directly from a USB drive or transmitting audio from a USB drive to Bluetooth devices.



This image shows two scenarios for USB drive use. On the left, a USB drive is inserted into the M10 Pro+ which is connected to an active speaker for wired transmission. On the right, a USB drive is inserted into the M10 Pro+ which is transmitting wirelessly to Bluetooth headphones/speakers.

CONTROLS AND DISPLAY

The M10 Pro+ features a digital display and several control buttons for easy operation.



This image details the device's buttons and RGB lamp modes. The buttons include Power ON/OFF/Search, Volume Reduction/Previous Song, Pause/Play/Answer/Hang Up, and Volume Plus/Next Song. The RGB lamp offers Dazzle Mode, Bounce Mode, Breathing Pattern, and Streaming Mode, which can be switched

with a three-key press.

- **Power Button (Q):** Press and hold for 3 seconds to power on/off. Double-click to initiate pairing for a second device.
- **Volume - / Previous Song:** Short press for volume down, long press for previous track.
- **Play/Pause / Answer/Hang Up:** Short press to play/pause, answer/end calls.
- **Volume + / Next Song:** Short press for volume up, long press for next track.
- **RGB Lamp Modes:** The RGB lighting can be cycled through different effects (Dazzle, Bounce, Breathing, Streaming) or turned off.

SPECIFICATIONS

Feature	Detail
Model	M10 Pro+
Bluetooth Version	5.2
Supported Protocols	SBC, AAC, aptX, aptX-LL, aptX-HD
Connectivity	3.5mm AUX, RCA, USB
Battery Capacity	400mAh Lithium Battery
Listening Time	8-10 hours
Charging Time	Approximately 1.5 hours
Standby Time	Approximately 30 days
Transmission Range	Up to 66 feet (20 meters)
Item Weight	8.1 ounces (0.23 Kilograms)
Package Dimensions	6.57 x 5.28 x 1.73 inches

TROUBLESHOOTING

Device does not power on.

Ensure the device is fully charged. Connect it to a power source using the Type-C cable and allow it to charge for at least 1.5 hours.

Unable to pair with a Bluetooth device.

1. Ensure the M10 Pro+ is in the correct mode (TX for transmitting, RX for receiving).
2. Make sure your target Bluetooth device (headphones, speakers, smartphone) is in pairing mode.
3. Ensure the M10 Pro+ is within the effective range (up to 66 feet) of the target device.
4. Try restarting both the M10 Pro+ and the target Bluetooth device.
5. If connecting a second device, double-click the power button on the M10 Pro+ to re-enter pairing mode.

No sound or poor audio quality.

1. Check all audio cable connections (AUX, RCA) to ensure they are securely plugged into the correct input/output ports on both the M10 Pro+ and your audio system/source.
2. Verify that the volume levels are adjusted appropriately on both the M10 Pro+ and the connected audio devices.
3. Ensure the M10 Pro+ is in the correct TX/RX mode for your setup.
4. If using aptX-LL, ensure both the M10 Pro+ and your Bluetooth headphones/speakers support aptX-LL for the lowest latency.
5. Reduce interference by moving the device away from other wireless electronics.

Device loses settings or connection.

This could indicate a firmware issue or a faulty unit. Ensure the device is fully charged. If the problem persists after restarting and re-pairing, contact customer support.

MAINTENANCE

- Keep the device dry and away from moisture.
- Clean the device with a soft, dry cloth. Do not use harsh chemicals or abrasive cleaners.
- Avoid extreme temperatures.
- Do not attempt to disassemble or repair the device yourself, as this will void the warranty.

WARRANTY AND SUPPORT

The MOREGAX M10 Pro+ comes with a standard manufacturer's warranty. For warranty claims, technical support, or further assistance, please refer to the contact information provided in the physical user manual or visit the official MOREGAX website.