

Autel IKEYBW004AL

Autel MaxiIM IKEYBW004AL Programmable Key Fob Instruction Manual

Keyless Entry for BMW Vehicles

1. INTRODUCTION

This manual provides comprehensive instructions for the installation, programming, and maintenance of your Autel MaxiIM IKEYBW004AL Programmable Key Fob. This key fob is designed as an OE-quality replacement for select BMW vehicles, offering keyless entry and remote functions. Proper use of this device requires an Autel MaxiIM programming tool (e.g., KM100, IM508S, IM608 PRO II).

2. SAFETY INFORMATION

- **Professional Programming Required:** This key fob is a blank device and requires programming with compatible Autel MaxiIM tools. Attempting to program without the correct tools or knowledge may result in damage to the key fob or vehicle's immobilizer system.
- **Battery Handling:** Use only the specified CR2032 battery. Ensure correct polarity during installation. Keep batteries out of reach of children.
- **Compatibility:** Verify vehicle compatibility with Autel support before attempting programming. The key's functionality depends on the vehicle's system and the programming tool used.
- **Water Resistance:** While designed to be durable, avoid prolonged exposure to water or extreme temperatures to prevent damage.

3. PACKAGE CONTENTS

Ensure all items are present before proceeding with installation and programming:

- 1 x Autel MaxiIM IKEYBW004AL Key Fob Shell
- 1 x Circuit Board (pre-installed)
- 1 x Uncut Key Blade (for BMW)
- *Note: CR2032 battery is NOT included and must be purchased separately.*

ACCESSORIES INCLUDED



Figure 3.1: Included Components of the IKEYBW004AL Key Fob. The image displays the key fob shell, the internal circuit board, and an uncut key blade. A CR2032 battery is pictured with a red 'X' to indicate it is not supplied with the product.

4. SETUP

4.1. Battery Installation (CR2032)

The Autel IKEYBW004AL requires a CR2032 coin cell battery (not included) for operation. Follow these steps to install the battery:

1. Locate the small black button on the bottom edge of the key fob, beneath the main buttons.
2. Press this button and use a small tool (like a flathead screwdriver or thumbnail) to gently pry off the metal end cap.
3. Rotate the key fob so the buttons are facing downwards. This prevents the internal buttons from falling out.
4. Carefully separate the two halves of the key fob by inserting a small screwdriver into the seam and gently rocking it.
5. Insert the CR2032 battery into the designated slot in one half of the key fob, ensuring the positive (+) side faces down.

6. Rejoin the two halves of the key fob, ensuring they snap securely together.
7. Reattach the metal end cap.

Your browser does not support the video tag.

Video 4.1: Autel Tech Tip Battery Installation for Basic Ikey Smart Key. This video demonstrates the step-by-step process of opening the key fob, inserting a CR2032 battery, and reassembling the device.

4.2. Key Blade Installation

The included key blade is uncut and designed for BMW vehicles. It must be cut by a professional locksmith or mechanic to match your vehicle's existing key blade.

1. Take the uncut key blade to a qualified professional for cutting.
2. Once cut, insert the key blade into the designated slot on the key fob until it clicks securely into place.



Figure 4.2: Key Making Process. This diagram visually outlines the stages of preparing the key fob, including battery and key blade integration, and the subsequent programming steps.

4.3. Compatibility Confirmation

Before programming, it is crucial to confirm the compatibility of the IKEYBW004AL with your specific vehicle. This key is not universally compatible with all vehicles, and compatibility depends on the programming tool used and your vehicle's specifications.

- Contact Autel support with your vehicle's make, model, year, and VIN (Vehicle Identification Number).
- Specify the functions you require from the key fob.
- Autel support will provide an available solution and confirm compatibility.

NOTICE!

Our Product is just a **Blank Key** which needs to work with extra Autel KM100/ IM508/ IM608 together! And our package does **NOT Include** the KM100, IM508, IM608.

How to Confirm Compatibility before Ordering?

1. Contact US via Amazon

2. Provide Your Car Information

- Car Model
- Car Year
- Car VIN(Important)
- What Functions You Need

3. You Will Get the Available Solution in 24 Hours

Figure 4.3: Important Compatibility Notice. This image highlights the necessity of using an Autel programming tool and the steps to confirm vehicle compatibility before purchase or programming.

5. OPERATING INSTRUCTIONS

5.1. Programming the Key Fob

The Autel MaxiIM IKEYBW004AL is a blank key that requires programming using a compatible Autel MaxiIM tool (e.g., KM100, IM508S, IM608 PRO II). This process links the key fob to your vehicle's immobilizer system.

1. Ensure your Autel MaxiIM programming tool is updated to the latest software version.

2. Connect the programming tool to your vehicle's OBD-II port.
3. On the programming tool, navigate to the "Universal Key" or "IMMO" function.
4. Select your vehicle's make, model, and year from the menu.
5. Follow the on-screen instructions to generate the universal key. This typically involves placing the IKEYBW004AL into the programming tool's slot.
6. Once the key is generated, proceed with the "IMMO Learning" or "Key Learning" procedure as guided by the Autel tool to synchronize the key fob with your vehicle.
7. Test all functions (Lock, Unlock, Trunk, Panic) to ensure successful programming.

Your browser does not support the video tag.

Video 5.1: How to Program Ikey with KM100. This video demonstrates the process of generating and programming an Autel Ikey using the Autel KM100 programming tool, including vehicle selection and key generation steps.



Figure 5.1: Key Fob Programming. This image shows the Autel IKEYBW004AL key fob being placed into an Autel programming device, ready for the generation process.

5.2. Key Fob Functions

The IKEYBW004AL key fob features four buttons that replicate the functions of your original equipment manufacturer (OEM) key:

- **Lock:** Press to lock all vehicle doors.
- **Unlock:** Press to unlock all vehicle doors.
- **Trunk:** Press to open the vehicle's trunk.
- **Panic:** Press and hold to activate the vehicle's alarm system.

HIGH SENSITIVITY BUTTONS

Functions Just Like Your Original K-ey!





Un.lock



Lock



Trunk



Panic

Buttons	4	Weight	69.3g (With Blades)
Frequency	315/433 MHz	Battery Life	>1 year
Battery	CR2032 (Not included)	Warranty	1 year
Operating Temp	-10 to 60°C (14 to 140°F)	Storage Temp	-20 to 70°C (-4 to 158°F)
Key Functions	Un.lock, Lock, Trunk, Panic (U,L,T,P)		

Figure 5.2: Key Fob Buttons and Basic Specifications. This image details the four functional buttons on the key fob and provides a summary of its physical and operational characteristics.

5.3. Ultra-Long Range Transmission

The IKEYBW004AL features a dual-band, multi-frequency transmitter (315MHz/434MHz or 868MHz/915MHz) that supports ultra-long range frequency transmission up to 40 meters (130 feet). This allows for reliable remote operation from a greater distance.

ULTRA-LONG TRANSMISSION

Supports 40m/130ft Range of Frequency Transmission



Figure 5.3: Remote Transmission Range. This image illustrates the extended range capability of the key fob, showing it can operate a vehicle from up to 130 feet away.

6. MAINTENANCE

6.1. Battery Replacement

When the key fob's remote functions become unreliable or stop working, it may be time to replace the CR2032 battery. Refer to Section 4.1 for detailed instructions on battery installation.

6.2. Care and Cleaning

- Keep the key fob clean by wiping it with a soft, dry cloth.
- Avoid using harsh chemicals or abrasive cleaners.
- Protect the key fob from drops, impacts, and extreme temperatures.
- Ensure the key fob remains dry to prevent internal damage.

7. TROUBLESHOOTING

If you encounter issues with your Autel MaxiIM IKEYBW004AL, consider the following troubleshooting steps:

- **Key Fob Not Responding:**
 - Check the battery: Ensure the CR2032 battery is correctly installed and has sufficient charge. Replace if necessary (refer to Section 4.1).
 - Reprogramming: The key fob may have lost its programming. Attempt to reprogram it using your Autel MaxiIM tool (refer to Section 5.1).
 - Vehicle Battery: Ensure your vehicle's battery is not depleted, as this can affect key fob communication.
- **Reduced Remote Range:**
 - Replace the battery: A weak battery can significantly reduce the remote's effective range.
 - Environmental Interference: Strong radio interference or physical obstructions can affect signal range.
- **Key Blade Not Working:**
 - Ensure the key blade was cut accurately by a professional to match your vehicle's lock.
- **Compatibility Issues:**
 - If you did not confirm compatibility prior to purchase, contact Autel support immediately with your vehicle details.

For persistent issues or advanced troubleshooting, please contact Autel customer support.

8. SPECIFICATIONS

Feature	Specification
Model Number	IKEYBW004AL
Brand	Autel
Number of Buttons	4 (Lock, Unlock, Trunk, Panic)
Frequency	Dual-Band (315MHz/434MHz or 868MHz/915MHz)
Remote Range	Up to 40 meters (130 feet)
Battery Type	CR2032 (Not Included)
Compatible Autel Tools	KM100, IM508S, IM508S PRO, IM608 II, IM608S II, IM608 PRO II
Item Weight	2.39 ounces
Package Dimensions	4.65 x 2.32 x 0.63 inches
Color	Silver and Red

9. WARRANTY AND SUPPORT

Autel provides a 1-year warranty for the MaxiIM IKEYBW004AL key fob. For technical support, warranty claims, or any questions regarding product operation or compatibility, please contact Autel customer support.

- **Email Support:** Autelonline @ outlook . com
- **Lifetime Technical Support:** Available for registered products.
- **30-Day Return & Replacement:** Refer to your purchase platform's policy for details.

© 2025 Autel. All rights reserved.

This manual is subject to change without notice.

- Autel provides a 1-year warranty for the MaxiIM IKEYBW004AL key fob. For technical support, warranty claims, or any questions regarding product operation or compatibility, please contact Autel customer support.
- **Email Support:** Autelonline @ outlook . com
 - **Lifetime Technical Support:** Available for registered products.
 - **30-Day Return & Replacement:** Refer to your purchase platform's policy for details.
- © 2025 Autel. All rights reserved.
- This manual is subject to change without notice.

Autel provides a 1-year warranty for the MaxiIM IKEYBW004AL key fob. For technical support, warranty claims, or any questions regarding product operation or compatibility, please contact Autel customer support.

- **Email Support:** Autelonline @ outlook . com
- **Lifetime Technical Support:** Available for registered products.
- **30-Day Return & Replacement:** Refer to your purchase platform's policy for details.

© 2025 Autel. All rights reserved.

This manual is subject to change without notice.



Autel provides a 1-year warranty for the MaxiIM IKEYBW004AL key fob. For technical support, warranty claims, or any questions regarding product operation or compatibility, please contact Autel customer support.

- **Email Support:** Autelonline @ outlook . com
- **Lifetime Technical Support:** Available for registered products.
- **30-Day Return & Replacement:** Refer to your purchase platform's policy for details.

© 2025 Autel. All rights reserved.

This manual is subject to change without notice.

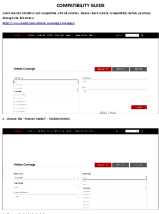
Related Documents - IKEYBW004AL

	<h2 style="color: #007bff; text-decoration: underline;">Autel MaxiIM KM100 Vehicle Compatibility Guide</h2> <p>Check vehicle compatibility for the Autel MaxiIM KM100 key programmer and immobilizer tool. This guide provides step-by-step instructions to ensure your vehicle is supported using the Autel online tool.</p>
<p>Trademarks</p> <p>Audi®, BMW®, Ford®, GM®, Honda®, Hyundai®, Infiniti®, Isuzu®, Jaguar®, Jeep®, KIA®, Land Rover®, Lexus®, Lincoln®, Lotus®, Maserati®, Mercedes-Benz®, Mini®, Mitsubishi®, Nissan®, Oldsmobile®, Opel®, Peugeot®, Porsche®, Ram®, Renault®, Saab®, Saturn®, Subaru®, Suzuki®, Toyota®, Volkswagen®, Volvo®, and other trademarks are the property of their respective owners.</p> <p>Copyright Information</p> <p>All rights reserved. No part of this manual may be reproduced without written permission from Autel Intelligent Technology Co., Ltd. All other marks are trademarks or registered trademarks of their respective holders.</p> <p>Disclaimer of Warranties and Limitation of Liability</p> <p>The information contained herein is provided as a reference only. It does not constitute a warranty or guarantee of performance. The user assumes all responsibility for the use of the product. The manufacturer disclaims any liability for damages, loss, injury, or death resulting from the use of the product. The manufacturer shall not be held responsible for any consequences arising from the use of the product. The user agrees to hold the manufacturer harmless for any claims, damages, losses, or injuries resulting from the use of the product.</p> <p>For Services and Support:</p> <ul style="list-style-type: none"> USA: 1-800-828-6886 Canada: 1-800-828-6886 UK: +44 (0)1235 8634 7779 (China) Germany: +49 (0)2102 8634 7779 (China) <p>For technical assistance in all other markets, please refer to Technical Support in this manual.</p>	<h2 style="color: #007bff; text-decoration: underline;">Autel MaxiIM KM100 User Manual: Professional Key Generation and IMMO Tool</h2> <p>Explore the Autel MaxiIM KM100, a professional intelligent key tool for universal key generation, transponder reading/cloning, and IMMO learning. This manual provides comprehensive instructions, safety guidelines, and technical specifications for automotive locksmiths and technicians.</p>
<p>Trademarks</p> <p>Audi®, BMW®, Ford®, GM®, Honda®, Hyundai®, Infiniti®, Isuzu®, Jaguar®, Jeep®, KIA®, Land Rover®, Lexus®, Lincoln®, Lotus®, Maserati®, Mercedes-Benz®, Mini®, Mitsubishi®, Nissan®, Oldsmobile®, Opel®, Peugeot®, Porsche®, Ram®, Renault®, Saab®, Saturn®, Subaru®, Suzuki®, Toyota®, Volkswagen®, Volvo®, and other trademarks are the property of their respective owners.</p> <p>Copyright Information</p> <p>All rights reserved. No part of this manual may be reproduced without written permission from Autel Intelligent Technology Co., Ltd. All other marks are trademarks or registered trademarks of their respective holders.</p> <p>Disclaimer of Warranties and Limitation of Liability</p> <p>The information contained herein is provided as a reference only. It does not constitute a warranty or guarantee of performance. The user assumes all responsibility for the use of the product. The manufacturer disclaims any liability for damages, loss, injury, or death resulting from the use of the product. The manufacturer shall not be held responsible for any consequences arising from the use of the product. The user agrees to hold the manufacturer harmless for any claims, damages, losses, or injuries resulting from the use of the product.</p> <p>For Services and Support:</p> <ul style="list-style-type: none"> USA: 1-800-828-6886 Canada: 1-800-828-6886 UK: +44 (0)1235 8634 7779 (China) Germany: +49 (0)2102 8634 7779 (China) <p>For technical assistance in all other markets, please refer to Technical Support in this manual.</p>	<h2 style="color: #007bff; text-decoration: underline;">Autel MaxiIM IM608 II/Pro II User Manual: Key Programming and Diagnostics</h2> <p>Comprehensive user manual for the Autel MaxiIM IM608 II and IM608 Pro II, detailing key programming, IMMO functions, OE-level diagnostics, and advanced service operations for automotive technicians.</p>
	<h2 style="color: #007bff; text-decoration: underline;">Autel MaxiIM IMMO & Key Programming Tools Catalog KM100, IM608PROIIKPA, IM508S</h2> <p>Explore Autel's MaxiIM series of advanced IMMO and key programming tools, including the KM100, IM608PROIIKPA, and IM508S. Discover features, specifications, and accessories for professional automotive locksmiths.</p>
	<h2 style="color: #007bff; text-decoration: underline;">Autel MaxiIM IMMO & Key Programming Tools Catalog KM100, IM608PROIIKPA, IM508S</h2> <p>Explore Autel's MaxiIM line of advanced IMMO and key programming tools, including KM100, IM608PROIIKPA, IM508S, XP400 PRO, and accessories. Professional automotive key solutions with extensive vehicle coverage and features.</p>

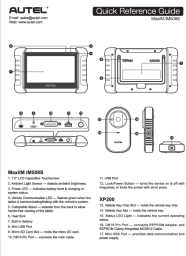

Autel MaxiIM IM508S Quick Reference Guide

A concise guide to the Autel MaxiIM IM508S key programming tool, detailing its components, LED indicators, and initial setup for immobilizer and programming functions.