



[Manuals.plus](#) /

> [HP](#) /

> HP LaserJet M207dw Laser Wireless Printer User Manual

HP 8J9K9F#A62

HP LaserJet M207dw Laser Wireless Printer User Manual

Model: 8J9K9F#A62 | Brand: HP

1. INTRODUCTION

This manual provides instructions for the HP LaserJet M207dw Laser Wireless Printer. The HP LaserJet M207dw is designed for fast 2-sided laser printing, offering easy setup and reliable connectivity through dual-band Wi-Fi, Ethernet, and USB 2.0. It features strong security measures and time-saving functionalities, including mobile printing via the HP app. The printer incorporates Auto-On/Auto-Off technology for energy efficiency. This monochrome duplex printer produces precision laser quality pages and is suitable for various office environments, particularly for printing everyday black-and-white documents.



Image: The HP LaserJet M207dw printer in operation, printing a document with charts.

2. WHAT'S IN THE BOX

Verify that all components are present in the packaging:

- HP LaserJet M207dw Printer
- Preinstalled HP Black Original LaserJet Toner Cartridge
- Dust cover
- Power Cord
- Reference Guide
- Setup Poster
- Regulatory Flyer

In the box

HP LaserJet M207dw



Power cord



Original HP 134A
Black Toner Cartridge

Image: The HP LaserJet M207dw printer, power cord, and an Original HP 134A Black Toner Cartridge, illustrating the typical contents of the product box.

3. SETUP GUIDE

3.1 Unpacking and Placement

1. Remove the printer from its packaging and remove all protective materials.
2. Place the printer on a stable, flat surface with adequate ventilation. Ensure easy access to power outlets and network connections.

3.2 Connecting the Printer

- **Power Connection:** Connect the power cord to the printer and then to a grounded electrical outlet.
- **USB Connection:** For a direct connection, use a USB cable to connect the printer to your computer. The Hi-Speed USB 2.0 port is located at the rear.
- **Ethernet Connection:** For wired network printing, connect an Ethernet cable from the printer's Ethernet port to your network router or switch.

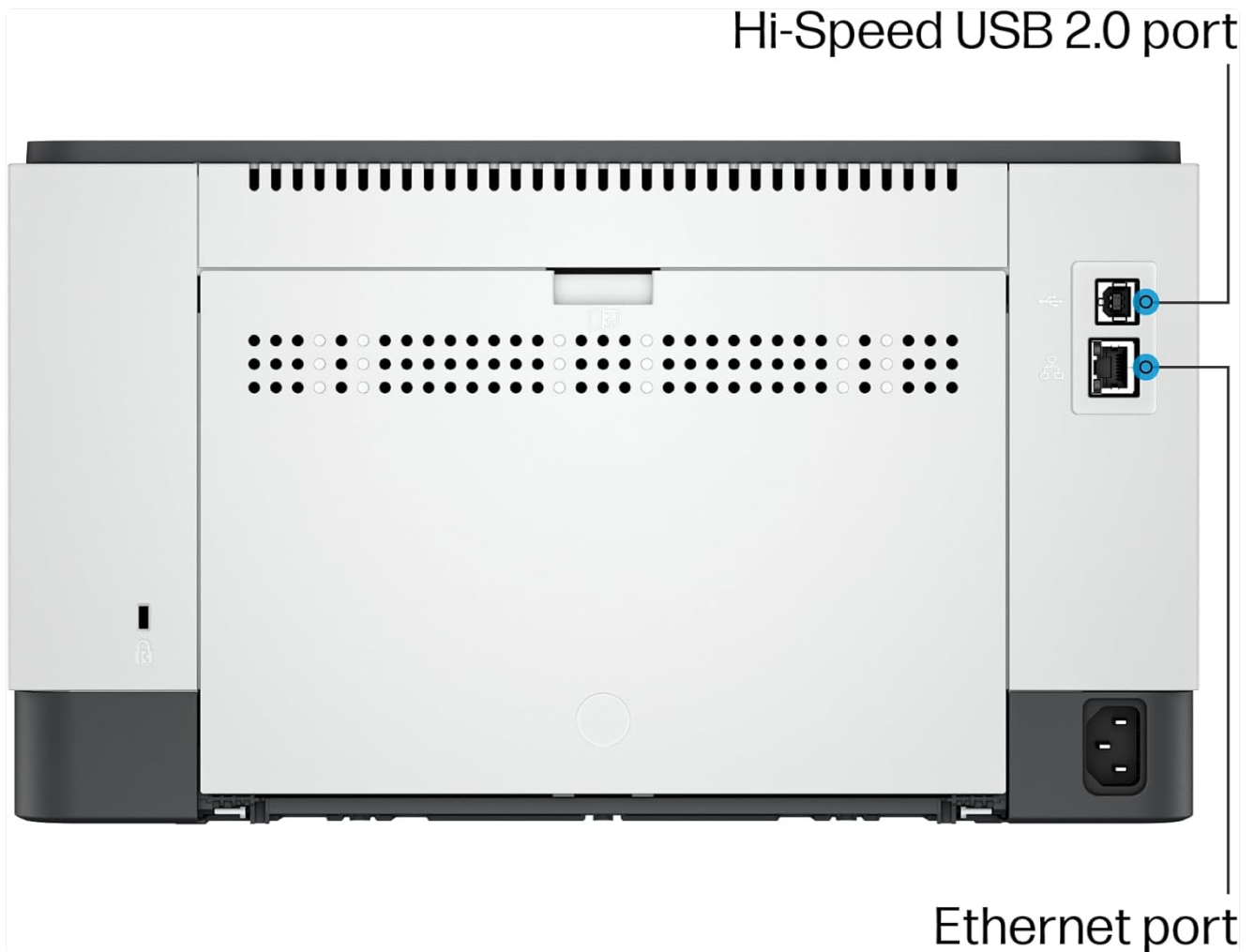

Image: The rear panel of the HP LaserJet M207dw printer, highlighting the Hi-Speed USB 2.0 port and the Ethernet port for connectivity.

3.3 Wireless Setup (Wi-Fi)

1. Turn on the printer.
2. Follow the instructions on the printer's control panel or refer to the Setup Poster for initial Wi-Fi connection.
3. The printer supports dual-band Wi-Fi with self-reset capabilities to automatically detect and resolve connectivity issues.



Dual-band Wi-Fi® automatically reconnects to stay online



Image: A user working with a laptop and smartphone, with the HP LaserJet M207dw printer visible, emphasizing its dual-band Wi-Fi capability for seamless connection.

3.4 Software Installation

1. Visit the official HP support website for your printer model to download the latest drivers and software.
2. Install the HP Smart app on your computer or mobile device for enhanced printer management and mobile printing features.

4. OPERATING INSTRUCTIONS

4.1 Loading Paper

1. Open the 150-sheet input tray.
2. Adjust the paper guides to fit the paper size.
3. Load paper into the tray. The printer supports various paper sizes including 8.5 x 11, 8.27 x 11.7, and 8.5 x 14 inches.
4. The 100-sheet output tray will collect printed documents.

Smart-guided buttons

100-sheet output tray



Print from any device

150-sheet input tray

Image: The HP LaserJet M207dw printer with its input and output trays labeled, alongside a smartphone demonstrating the 'Print from any device' functionality via the HP Smart app.

4.2 Basic Printing

1. From your computer or mobile device, open the document you wish to print.
2. Select the print option (usually File > Print).
3. Choose the HP LaserJet M207dw from the list of available printers.
4. Adjust print settings as needed (e.g., number of copies, paper size).
5. Click 'Print'. The printer can achieve speeds of up to 28 black-and-white pages per minute.



Exceptional-quality prints, page after page



Image: The HP LaserJet M207dw printer delivering exceptional quality black and white prints, page after page.

4.3 Duplex (Two-Sided) Printing

The HP LaserJet M207dw supports automatic two-sided printing. To utilize this feature:

1. In your application's print dialog, look for a 'Two-sided' or 'Duplex' printing option.
2. Select the desired binding option (e.g., long-edge binding for portrait, short-edge binding for landscape).
3. Proceed with printing. This feature allows for efficient use of paper.



Fastest 2-sided printing in class



Image: An office setting with multiple individuals working, featuring the HP LaserJet M207dw printer, emphasizing its fast two-sided printing capability.

4.4 Mobile Printing with HP Smart App

The HP Smart app enables wireless printing from various mobile devices, PCs, or tablets.

1. Ensure your mobile device is connected to the same Wi-Fi network as the printer.
2. Open the HP Smart app.
3. Select the document or photo you wish to print.
4. Follow the app's prompts to send the print job to your HP LaserJet M207dw. The app also allows for toner level monitoring and secure mobile fax.



Remote printing with HP app

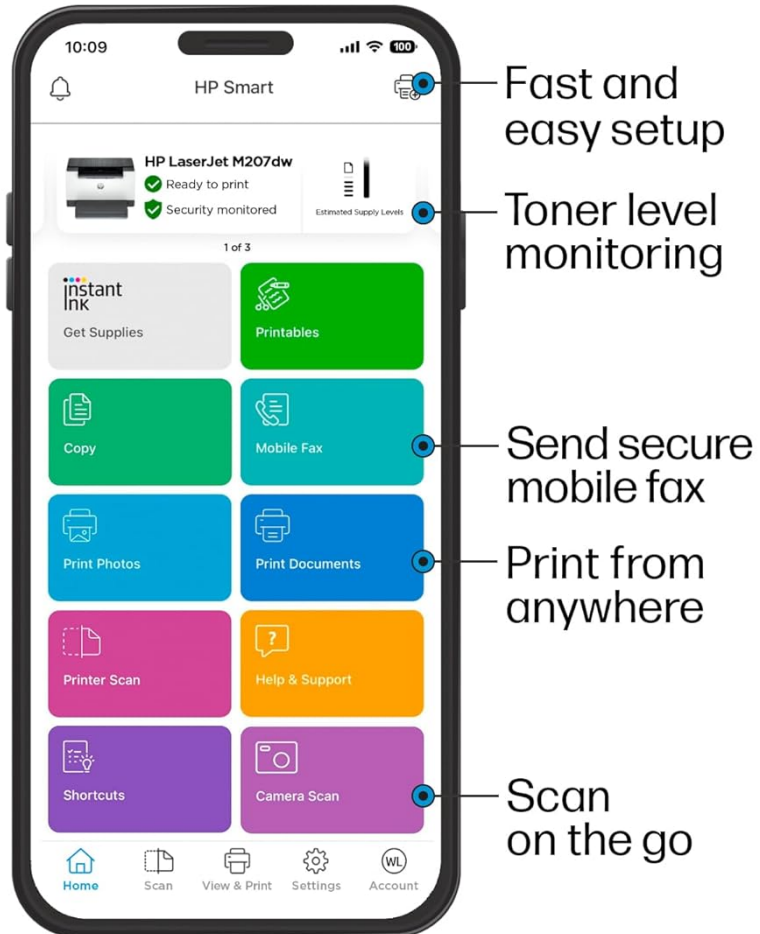

Image: A smartphone displaying the HP Smart app, illustrating features like fast setup, toner level monitoring, sending secure mobile faxes, printing from anywhere, and scanning on the go.

4.5 Using Smart-Guided Buttons

The printer features smart-guided buttons on its control panel for easy task management.

- Refer to the printer's control panel for intuitive icons and indicators that guide you through common operations.
- These buttons simplify tasks such as canceling print jobs or checking printer status.



Easily manage tasks with smart-guided buttons



Image: A hand interacting with the smart-guided buttons on the HP LaserJet M207dw printer's control panel, demonstrating ease of task management.

5. MAINTENANCE

5.1 Toner Cartridge Replacement

The printer comes with a preinstalled HP Black Original LaserJet Toner Cartridge. When the toner level is low:

1. Open the toner access door on the printer.
2. Remove the old toner cartridge by pulling it out.
3. Unpack the new HP 134A Black Original LaserJet Toner Cartridge.
4. Gently shake the new cartridge to distribute the toner evenly.
5. Insert the new cartridge into the printer until it clicks into place.
6. Close the toner access door.

5.2 Cleaning the Printer

Regular cleaning helps maintain print quality and printer longevity:

- **Exterior:** Wipe the exterior surfaces with a soft, lint-free cloth dampened with water. Avoid abrasive cleaners.
- **Interior:** Refer to the printer's reference guide for instructions on cleaning internal components, such as the paper path or toner area, if necessary. Always power off and unplug the printer before cleaning internal parts.

6. TROUBLESHOOTING

6.1 Common Issues and Solutions

- **Printer Not Responding:**
 - Check power connections and ensure the printer is turned on.
 - Verify USB or Ethernet cable connections.
 - For wireless connections, ensure the printer is connected to the correct Wi-Fi network and the signal is strong. Restart your router if necessary.
 - Restart both the printer and your computer/device.
- **Poor Print Quality:**
 - Check the toner cartridge level and replace if low.
 - Ensure you are using genuine HP toner cartridges.
 - Clean the printer's internal components as per the maintenance section.
 - Verify that the paper type loaded matches the print settings.
- **Paper Jams:**
 - Carefully open all access doors and remove any jammed paper. Avoid tearing the paper.
 - Ensure paper is loaded correctly in the input tray and not overfilled.
 - Use paper that meets the printer's specifications.
- **Connectivity Issues (Wi-Fi):**
 - The dual-band Wi-Fi with self-reset feature should automatically resolve many issues.
 - If problems persist, try reconnecting the printer to the Wi-Fi network through the control panel or HP Smart app.
 - Ensure your router's firmware is up to date.

7. SPECIFICATIONS

Feature	Detail
Model Name	HP LaserJet M207dw Printer
Printing Technology	Laser
Printer Output	Monochrome
Max Print Speed (Monochrome)	28 ppm
Max Black and White Print Resolution	Up to 600 x 600 dpi
Duplex Printing	Automatic (standard)

Feature	Detail
Connectivity Technology	USB, Ethernet, Wi-Fi (Dual-band)
Hardware Interface	Ethernet, USB
Compatible Devices	Laptops, PC, Smartphones
Max Input Sheet Capacity	150 sheets
Output Sheet Capacity	150 sheets
Maximum Media Size	4 x 6 to 8.5 x 14 in
Product Dimensions (D x W x H)	11"D x 13.98"W x 8.07"H
Item Weight	12.35 pounds
Power Consumption (On-mode)	420 Watts
Memory Storage Capacity	64 MB
Special Features	Mercury free, Two-sided printing, Auto-On/Auto-Off technology



Image: The HP LaserJet M207dw printer with its physical dimensions clearly indicated: 13.98 inches width, 11 inches depth, and 8.07 inches height.

8. WARRANTY AND SUPPORT

8.1 Warranty Information

The HP LaserJet M207dw Printer comes with a **One-year limited warranty**. Please refer to the regulatory flyer included in the box or visit the official HP website for detailed warranty terms and conditions.

8.2 Customer Support

For technical assistance, driver downloads, or further support, please visit the official HP support website or contact HP customer service. Keep your printer's model number (8J9K9F#A62) and serial number ready when contacting support.

