

OKIBB ZZB-NL-US

OKIBB

OKIBB Keyless Entry Door Lock

Model: ZZB-NL-US

INTRODUCTION

Thank you for choosing the OKIBB Keyless Entry Door Lock. This manual provides detailed instructions for the installation, operation, and maintenance of your new lock. Designed for convenience and security, this keypad lock offers a reliable solution for managing access to your property. Please read this manual thoroughly before installation and use to ensure proper function and longevity of the product.



Image: The OKIBB Keyless Entry Door Lock provides convenient and secure access for your home.

SAFETY INFORMATION

- Read all instructions completely before installing and operating the lock.
- Do not attempt to disassemble or modify the lock. This may cause damage and void the warranty.
- Keep all components out of reach of children.
- Use only the specified battery type (if applicable, though this model states no batteries included/required, general safety applies).
- Protect the keypad from excessive moisture or direct water exposure.

- Ensure proper installation to prevent accidental lockout or security breaches.

PACKAGE CONTENTS

Please verify that all the following components are included in your package:

- Exterior Keypad Assembly
- Interior Assembly
- Latch Bolt
- Strike Plate
- Mounting Screws
- Installation Template
- User Manual



Image: Overview of the OKIBB Keyless Entry Door Lock components.

INSTALLATION

Before beginning installation, ensure your door is prepared according to the provided template. This lock is designed

for both left and right-handed doors.

Step-by-Step Installation:

1. **Prepare the Door:** Use the provided template to mark and drill holes on your door if necessary. Ensure the door thickness and backset are compatible.
2. **Install the Latch Bolt:** Insert the latch bolt into the door edge, ensuring the 'UP' arrow (if present) faces upwards. Secure it with screws.
3. **Install the Exterior Keypad Assembly:** Feed the cable from the exterior assembly through the door hole and align the assembly with the latch bolt.
4. **Install the Interior Assembly:** Connect the cable from the exterior assembly to the interior assembly. Secure the interior assembly to the door using the mounting screws, ensuring it is flush and stable.
5. **Install Batteries (if applicable):** Open the battery cover on the interior assembly and insert the required batteries, observing polarity. (Note: Product specifications state 'Batteries Included? No' and 'Batteries Required? No' for this model, but general installation steps are provided for typical keypad locks.)
6. **Test Operation:** After installation, test the lock's mechanical and electronic functions before closing the door.



Image: The OKIBB Entry Lock Handle Set, highlighting its steel construction, rust-resistance, durability, and compatibility with left and right-handed doors.



Images: Examples of the OKIBB Keyless Entry Door Lock installed on different door types.

OPERATING INSTRUCTIONS

Setting User Codes:

Refer to the specific programming instructions included with your lock for setting master codes and individual user codes. Typically, this involves entering a programming sequence followed by your desired code.

Locking the Door:

- **Manual Lock:** Press the lock button on the keypad or turn the thumb-turn on the interior assembly.
- **Auto-Lock Feature:** The lock is equipped with an auto-lock feature. After a successful entry, the lock will automatically re-lock after a preset time (e.g., 30 seconds). This time can usually be adjusted in the settings.

Unlocking the Door:

- **Using a Code:** Enter your valid user code on the keypad, followed by the unlock button (if applicable).
- **From Inside:** Turn the thumb-turn on the interior assembly.

MAINTENANCE

- **Cleaning:** Clean the lock's exterior with a soft, damp cloth. Avoid abrasive cleaners or solvents that could damage the finish or keypad.
- **Battery Replacement:** If the lock uses batteries, replace them promptly when the low battery indicator appears. Use high-quality alkaline batteries.
- **Lubrication:** Periodically check the latch bolt and deadbolt for smooth operation. If needed, apply a small amount of silicone-based lubricant to the moving parts.

TROUBLESHOOTING

Problem	Possible Cause	Solution
Lock does not respond to keypad entry.	Incorrect code entered; Low batteries; Keypad malfunction.	Verify code; Replace batteries (if applicable); Contact support.

Problem	Possible Cause	Solution
Lock does not lock/unlock smoothly.	Misalignment; Obstruction; Latch bolt issue.	Check door alignment and strike plate; Clear any obstructions; Lubricate latch bolt.
Auto-lock feature not working.	Feature disabled; Incorrect setting.	Check programming settings to ensure auto-lock is enabled and set to desired time.

SPECIFICATIONS

Feature	Detail
Brand	OKIBB
Model Name	ZZB-NL-US
Lock Type	Keypad
Special Feature	Auto-Lock
Material	Stainless Steel
Color	Black
Item Dimensions (L x W x H)	1 x 1 x 1 inches
Item Weight	1.1 pounds (0.5 Kilograms)
UPC	768383681116

WARRANTY AND SUPPORT

OKIBB products are manufactured to high-quality standards and are backed by a limited warranty. For specific warranty terms and conditions, please refer to the warranty card included with your product or visit the official OKIBB website.

For technical support, troubleshooting assistance, or to inquire about replacement parts, please contact OKIBB customer service:

- **Website:** [Visit the OKIBB Store on Amazon](#)
- **Email:** [Insert Customer Service Email Here]
- **Phone:** [Insert Customer Service Phone Number Here]

Please have your model number (ZZB-NL-US) and purchase date ready when contacting support.

Related Documents

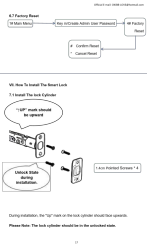

OKIBB DL-08 Smart Lock Installation Guide

Step-by-step installation instructions for the OKIBB DL-08 5-in-1 Smart Lock. Covers cylinder installation, backset conversion, door preparation, exterior assembly, power connection, and final checks for keyless entry. Includes safety precautions and operational details.



[OKIBB Smart Life Wi-Fi Smart Lock DL-08 Installation and User Guide](#)

Comprehensive guide for installing and using the OKIBB Smart Life Wi-Fi Smart Lock DL-08, covering features, setup, app control, and troubleshooting.