

---

[Manuals.plus](#) /

> [Toolsempire](#) /

> Toolsempire Folding Upright Walker User Manual - Model TD10008

## Toolsempire TD10008

# Toolsempire Folding Upright Walker User Manual

Model: TD10008

Brand: Toolsempire

---



## INTRODUCTION

---

This manual provides comprehensive instructions for the safe and effective use of your Toolsempire Folding Upright Walker, Model TD10008. Designed for seniors, individuals with disabilities, and those in recovery, this mobility aid offers two configurations: an upright walker with armrests and a conventional standard walker without arm supports. Please read this manual thoroughly before initial use and retain it for future reference.

## PRODUCT OVERVIEW

---



Image: An overview of the Toolsempire Folding Upright Walker, illustrating its design, folded state, and a user demonstrating its upright posture support.

## PRODUCT FEATURES

- **2-in-1 Design:** Functions as an upright walker with armrests for maintaining a natural standing posture, or converts to a standard walker by removing arm supports.
- **Ergonomic Support:** Features 7-level adjustable height settings (42" to 48") and curved armrests with 4 available positions for personalized comfort.
- **Comfortable Flip-up Seat:** Includes a soft-padded seat for resting, which can be flipped up and secured with hook and loop fasteners to prevent interference during walking.
- **Lightweight & Foldable:** Constructed from robust aluminum alloy, weighing 10 lbs, and supports up to 330 lbs. Folds tool-free with one click into a slim 5.5" width for easy storage and transport.
- **Multi-purpose Aid:** Equipped with 5" front wheels and sled-style rear foot mats for smooth navigation.

Suitable for walking assistance, getting up from a seated position, and as a toilet safety rail.

## SETUP INSTRUCTIONS

---

The Toolsempire Folding Upright Walker requires no assembly. Follow these steps for initial setup:

### 1. Unfolding the Walker:

Place the folded walker on a flat, stable surface. Gently pull the sides apart until the frame locks into place. Ensure all locking mechanisms are securely engaged before use.

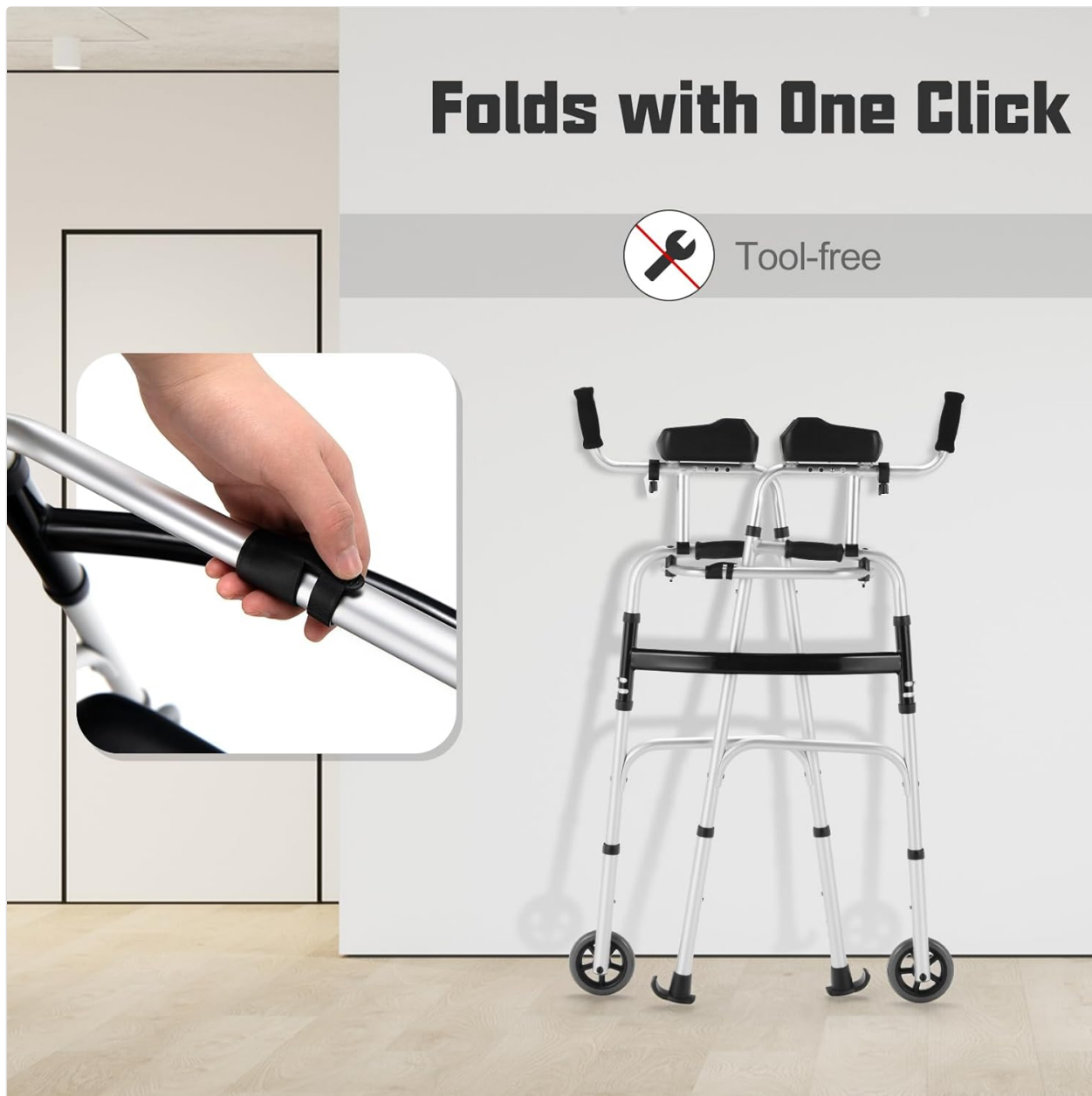

Image: The walker folds with one click. A hand is shown pressing a release button on the frame, and the walker is shown in its compact, folded state leaning against a wall.

### 2. Removing the Seat (if desired for folding):

If you need to fold the walker for storage or transport, please remove the seat first. The seat is designed to flip up and can be detached if necessary for a more compact fold.

## OPERATING INSTRUCTIONS

---

### 1. Adjusting Height

The walker's height can be adjusted to suit individual user statures for optimal comfort and posture.

- a. Locate the height adjustment pins on each leg of the walker.
- b. Press the pin and slide the leg up or down to the desired height. Ensure both sides are adjusted to the same level.
- c. Release the pin, ensuring it securely locks into one of the 7 available height settings.



Image: The walker's height is adjustable from 42" to 48" with 7 distinct levels. An inset highlights the 4 adjustable positions for the armrests.

## 2. Adjusting Armrest Positions

The curved armrests can be adjusted to 4 different positions to fit your preferred posture.

- a. Locate the adjustment mechanism on the armrests.
- b. Adjust the armrest to one of the 4 positions for ergonomic support.
- c. Ensure both armrests are set to the same position for balanced support.

## 3. Using the Flip-up Seat

The integrated seat provides a convenient resting spot. It can be flipped up when not in use.

- To use the seat: Ensure the walker is on a stable, level surface. Carefully turn around and sit on the soft-padded seat.
- To flip up the seat: Lift the seat upwards. Secure it in the upright position using the hook and loop fasteners to prevent it from interfering with walking.



Image: Details of the comfortable flip-up seat, highlighting the secure rotary knob fixation, hook and loop fasteners for securing the seat in the upright position, and the soft-padded surface.

#### 4. Converting to a Standard Walker

The arm supports are removable, allowing the unit to function as a standard walker.

- To remove arm supports: Locate the attachment points for the armrests. Follow the instructions for detaching them, typically involving a release button or lever.
- To reattach arm supports: Align the arm supports with the attachment points and secure them until they click into place.

# Doubles as a Standard Walker



## Without Armrests

Standard Walker for Lower Center of Gravity



## With Armrests

Upright Walker for Standing Straight



Image: The walker shown in two modes: as an upright walker with armrests for standing straight, and as a standard walker without armrests for a lower center of gravity.

## 5. General Usage and Scenarios

This walker is designed to assist with various daily activities:

- **Walking:** Use the walker to support your balance and aid in mobility. Ensure a firm grip on the handles.
- **Getting Up:** Position the walker in front of you, use the handles for support as you transition from a seated to a standing position.
- **Toilet Safety Rail:** The sturdy frame can be positioned around a toilet to provide support when sitting down or standing up.



---

# Reliable Aid

For Multiple Scenarios

• • •

---



Image: The walker serving as a reliable aid for multiple scenarios, including assisting a person in getting up from a chair, supporting an elderly couple during a walk, and functioning as a toilet safety rail.

## MAINTENANCE

---

To ensure the longevity and safe operation of your Toolsempire Folding Upright Walker, regular maintenance is recommended:

- **Cleaning:** Wipe down the frame and seat with a damp cloth and mild soap. Avoid abrasive cleaners.
- **Inspection:** Periodically check all screws, bolts, and locking mechanisms to ensure they are tight and secure. Inspect the wheels and foot mats for wear and tear.
- **Storage:** When not in use, store the walker in a dry place, away from extreme temperatures. The folding feature allows for compact storage.

## TROUBLESHOOTING

---

If you encounter any issues with your Toolsempire Folding Upright Walker, please refer to the following common

solutions:

- **Walker feels unstable:** Ensure all height adjustment pins are fully engaged and locked. Verify that the walker is fully unfolded and the frame is locked into position. Check for any loose components.
- **Difficulty folding:** Ensure the seat is removed or flipped up before attempting to fold the walker. Check for any obstructions.
- **Wheels not rolling smoothly:** Inspect wheels for debris or damage. Clean the wheels if necessary.

If problems persist, please contact Toolsempire customer support for assistance.

## SPECIFICATIONS

Feature	Detail
Model Number	TD10008
Overall Dimensions (Unfolded)	26.5"D x 21.5"W x 42"-48"H
Folding Dimension	42" x 23.5" x 5.5"
Seat Dimensions	16" x 9"
Seat Height from Ground	19"-25"
Net Weight	10 lbs
Weight Capacity	330 lbs
Material	PU, Aluminum Alloy
Wheel Size	5" (front wheels)



Image: Detailed product dimensions are provided, showing the walker's overall size, folded thickness of 5.5 inches, seat dimensions (16"x9"), and wheel size (5"). The maximum weight capacity is indicated as 330 lbs.

## SAFETY INFORMATION

Please observe the following safety guidelines to prevent injury and ensure proper use of the walker:

- Always ensure the walker is fully unfolded and all locking mechanisms are engaged before use.
- Do not exceed the maximum weight capacity of 330 lbs.
- Use on stable, level surfaces. Exercise caution on uneven terrain or inclines.
- Do not use the walker for purposes other than intended mobility assistance.
- Regularly inspect the walker for any signs of wear, damage, or loose components. Discontinue use if any damage is found and contact customer support.
- When using the seat, ensure the walker is stationary and stable.
- Statements regarding dietary supplements have not been evaluated by the FDA and are not intended to diagnose, treat, cure, or prevent any disease or health condition. This product is a mobility aid, not a medical

treatment.

## WARRANTY AND SUPPORT

---

For warranty information or technical support, please contact Toolsempire customer service. Refer to the contact information provided with your purchase or visit the official Toolsempire website.

When contacting support, please have your model number (TD10008) and purchase date available.

