

Manuals.plus /

> lamfurart /

> lamfurart C845 Portable Tire Inflator and Jump Starter User Manual

lamfurart C845

lamfurart C845 Portable Tire Inflator and Jump Starter User Manual

Model: C845

1. INTRODUCTION

Thank you for choosing the lamfurart C845 Portable Tire Inflator and Jump Starter. This device is designed to provide convenient and reliable tire inflation and vehicle jump-starting capabilities. Please read this manual thoroughly before use to ensure safe and optimal operation.

2. PRODUCT OVERVIEW

2.1 Included Components

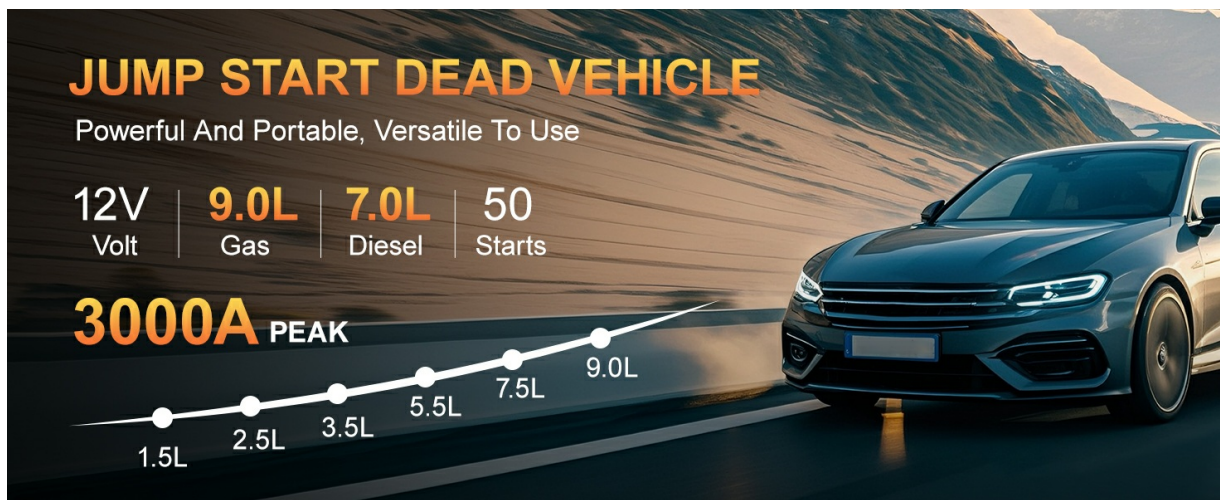

Image: Contents of the lamfurart C845 package.

The lamfurart C845 package typically includes:

- Air Pump (Main Unit)
- Air Hose

- Smart Battery Clamps (for jump starting)
- Long Tapered Nozzle
- Short Tapered Nozzle
- Ball Needle Adapter
- Woods Valve Adaptor
- Type-C USB Cable
- User Manual
- Storage Bag

2.2 Key Features

- **5 Dedicated Inflation Modes:** Pre-set modes for motorcycle, bike, car, ball, and customizable settings.
- **Automatic Stop:** Device automatically stops when target pressure is reached.
- **Powerful 25000mAh Battery:** Provides up to 1.5 hours of continuous operation.
- **Rapid Inflation:** Superior airflow rate of 36 L/min.
- **High-Accuracy Pressure Gauge:** Displays real-time pressure within ± 1 PSI.
- **Dual LEDs with 3 Lighting Modes:** Steady, SOS, and strobe for enhanced illumination.
- **Mobile Power Bank:** USB-C and USB-A ports for charging external devices.
- **Vehicle Jump Starter:** Peak current of 3000A, capable of 50 jumps.
- **10 Safety Protection Technologies:** Includes reverse polarity, short circuit, overcurrent, overcharge, overvoltage, high and low temperature, overload, fireproof flower, and reverse charging protection.

3. SETUP

3.1 Charging the Device

Before initial use, fully charge the lamfurart C845 unit. Connect the provided Type-C USB cable to the device's input port and a suitable power source. A full charge typically takes 4-6 hours.

PRECISE REAL-TIME DISPLAY

UP TO 150PSI



Image: The lamfurart C845 charging a smartphone and showing its dual LED lights.

3.2 Attaching the Air Hose

To prepare for inflation, securely screw the threaded end of the air hose onto the designated port on the lamfurart C845 unit. Ensure it is tightened to prevent air leakage.



Image: lamfurart C845 unit with accessories, including the air hose.

4. OPERATING INSTRUCTIONS

4.1 Tire Inflation

1. **Power On:** Press and hold the power button until the digital display illuminates.
2. **Select Mode:** Use the mode selection button to cycle through the 5 pre-set inflation modes: Car, Motorcycle, Bicycle, Ball, or Custom.
3. **Adjust Pressure:** For Custom mode, use the '+' and '-' buttons to set your desired pressure (up to 150 PSI). For pre-set modes, the target pressure is automatically set.
4. **Connect to Tire:** Attach the air hose nozzle securely to the tire valve. The real-time pressure will be displayed.
5. **Start Inflation:** Press the power button to begin inflation. The device will automatically stop once the target pressure is reached.
6. **Disconnect:** Remove the nozzle from the tire valve.



Image: Step-by-step guide for wireless tire inflation.

Your browser does not support the video tag.

Video: Demonstration of the lamfurart C845's easy operation and quick start for inflation.

4.2 Vehicle Jump Starting

Use the smart battery clamps for jump-starting a vehicle with a dead battery.

1. **Connect Clamps to Device:** Plug the smart battery clamps into the EC5 interface port on the lamfurart C845 unit.
2. **Connect to Car Battery:** Attach the red clamp to the positive (+) terminal of the car battery and the black clamp to the negative (-) terminal. Ensure a secure connection.
3. **Start Engine:** Once connected, start your vehicle's engine.
4. **Remove Clamps:** After the engine starts, immediately remove the clamps from the car battery, then disconnect them from the lamfurart C845 unit.



Image: Step-by-step guide for jump starting a vehicle.

Your browser does not support the video tag.

Video: Detailed introduction and demonstration of the lamfurart C845's jump starting and inflation features.

4.3 Power Bank Function

The lamfurart C845 can serve as a mobile power bank to charge your electronic devices.

- Connect your device (e.g., phone, tablet) to the USB-A or USB-C output port on the lamfurart C845

using a compatible charging cable.

- The device will begin charging automatically.

4.4 LED Lighting

The dual LED lights offer three modes for various situations:

- **Steady Light:** Press the light button once for continuous illumination.
- **SOS Mode:** Press the light button a second time for an SOS flashing pattern.
- **Strobe Mode:** Press the light button a third time for a rapid strobe effect.
- Press the button again to turn off the lights.

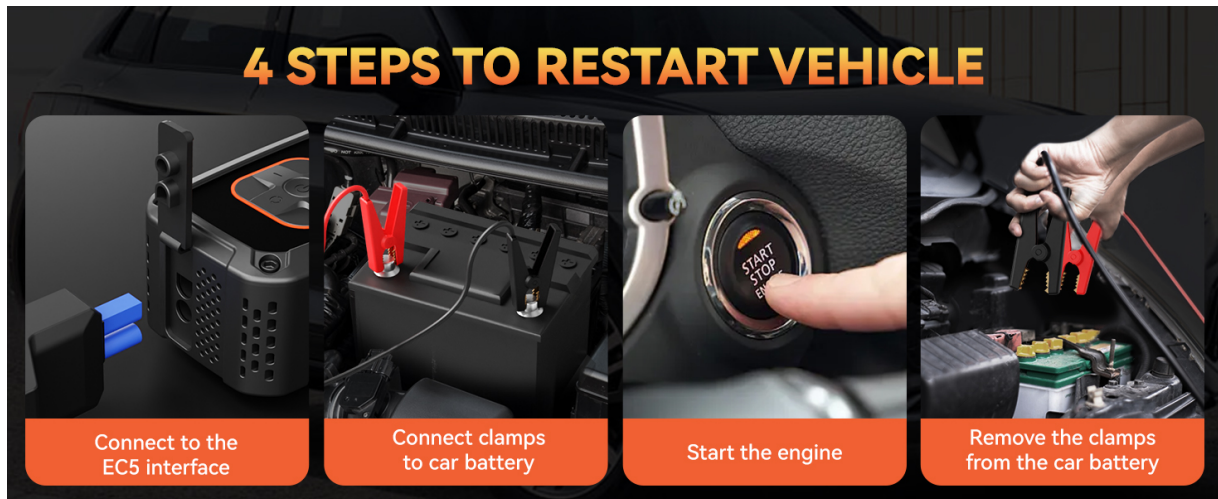

Image: Multi-function LED lights with different modes.

5. MAINTENANCE

- Store the device in a cool, dry place away from direct sunlight and extreme temperatures.
- Recharge the device every 3-6 months if not in regular use to maintain battery health.
- Clean the exterior with a soft, damp cloth. Do not use harsh chemicals or abrasive materials.
- Ensure all ports and connections are free from dust and debris.

6. TROUBLESHOOTING

If you encounter issues with your lamfurart C845, please refer to the following common solutions:

Problem	Possible Cause	Solution
Device does not power on	Low battery; Power button not held long enough	Charge the device; Press and hold the power button for 3-5 seconds
Tire not inflating	Hose not securely attached; Incorrect pressure setting; Damaged hose/nozzle	Ensure hose is tight; Verify pressure setting; Check for damage and replace if necessary
Jump start failure	Clamps incorrectly connected; Device battery low; Vehicle battery severely damaged	Check clamp polarity and connection; Charge device; Consult a professional mechanic
External device not charging	Charging cable faulty; Device battery low; External device incompatible	Try a different cable; Charge the lamfurart C845; Check device compatibility

7. SPECIFICATIONS

Feature	Detail
Brand	lamfurart
Model Name	C845
Power Source	Battery Powered (25000mAh Lithium Ion)
Maximum Operating Pressure	150 PSI (up to 290 for internal components)
Air Flow Capacity	36 Liters Per Minute
Noise Level	40 Decibels
Jump Starter Peak Current	3000A
Product Dimensions	3.01"L x 2.2"W x 6.4"H
Item Weight	2.27 pounds (1.03 Kilograms)
Charging Time	4-6 hours
Continuous Operation Time	Up to 1.5 hours

8. WARRANTY AND SUPPORT

lamfurart is committed to customer satisfaction. Your C845 Portable Tire Inflator and Jump Starter comes with:

- **30-Day Unconditional Return Guarantee:** For any reason, you can return the product within 30 days.
- **180-Day Warranty:** Covers manufacturing defects and malfunctions under normal use.
- **Lifetime Customer and Technical Support:** Our support team is available to assist you with any questions or issues. Please feel free to contact us; we aim to reply within 24 hours.

